



Lyttonsville Station
Future Pedestrian Crossing Concepts

February 27, 2014

Pedestrian Access from Brookville Road

Summary of Alternatives Considered

	Description	Purple Line Design Impacts (Note 1)	Property Impacts (Note 2)	Remarks
n/a	At-grade Crossing	n/a	n/a	Ruled out
Alternative A	Aerial crossing via county-owned property approximately 280' east of platform	<ul style="list-style-type: none"> Relocate crossover, if feasible Adjust OCS pole & downguy locations 	To be verified; county ROW width is in some doubt. Purple Line ROW plans show 15' wide, which would be insufficient. The county staff believe their ROW may be wider than 15;	<ul style="list-style-type: none"> Stair and adjacent walkway width would be very limited. CPTED: View of elevator from platform would be obstructed by stair.
Alternative B	Aerial crossing to Platform via ex-United Therapeutics Corp (UTC) property and new stair east of CCT	<ul style="list-style-type: none"> Adjust OCS pole & downguy locations 	Requires additional property east of CCT	<ul style="list-style-type: none"> Would lend itself to development on Camponaro land east of station. Stair landing could become seating/artwork area for transit and trail users. See sketch. County has concerns re: additional conflicts between transit patrons and cyclists. Consider "bike calming" per sketch.
Alternative C	Aerial crossing to Platform via ex-UTC property	<ul style="list-style-type: none"> Adjust OCS pole & downguy locations 	None; UTC property being acquired anyway.	<ul style="list-style-type: none"> Stair is feasible but constricts platform circulation. CPTED: View of elevator from platform would be obstructed by stair.

Note 1: Refers to changes to Purple Line design so as to accommodate future construction by others.

Note 2: Additional property acquisition, if any would be by others.

TRACTION POWER SUBSTATION

STORAGE AREA

IMPACTOR

EAST YARD ENTRANCE

BROOKVILLE RD

MAINTENANCE ROAD

MINIMUM R.O.W. FM
STAIR & ELEVATOR ~30'
CONT'D TO VENTURE.

SIGNAL BUNGALOW

SAND SILO

Y1 15+00
Y2 12+33
Y3 11+54
Y4 11+00
Y5 12+00
Y6 12+21
Y7 12+00
Y8 12+00
Y9 12+00
Y10 12+00
Y11 12+00
Y12 12+00
Y13 12+00
Y14 12+00
Y15 12+00
Y16 12+00
Y17 12+00
Y18 12+00
Y19 12+00
Y20 12+00
Y21 12+00
Y22 12+00
Y23 12+00
Y24 12+00
Y25 12+00
Y26 12+00
Y27 12+00
Y28 12+00
Y29 12+00
Y30 12+00
Y31 12+00
Y32 12+00
Y33 12+00
Y34 12+00
Y35 12+00
Y36 12+00
Y37 12+00
Y38 12+00
Y39 12+00
Y40 12+00
Y41 12+00
Y42 12+00
Y43 12+00
Y44 12+00
Y45 12+00
Y46 12+00
Y47 12+00
Y48 12+00
Y49 12+00
Y50 12+00
Y51 12+00
Y52 12+00
Y53 12+00
Y54 12+00
Y55 12+00
Y56 12+00
Y57 12+00
Y58 12+00
Y59 12+00
Y60 12+00
Y61 12+00
Y62 12+00
Y63 12+00
Y64 12+00
Y65 12+00
Y66 12+00
Y67 12+00
Y68 12+00
Y69 12+00
Y70 12+00
Y71 12+00
Y72 12+00
Y73 12+00
Y74 12+00
Y75 12+00
Y76 12+00
Y77 12+00
Y78 12+00
Y79 12+00
Y80 12+00
Y81 12+00
Y82 12+00
Y83 12+00
Y84 12+00
Y85 12+00
Y86 12+00
Y87 12+00
Y88 12+00
Y89 12+00
Y90 12+00
Y91 12+00
Y92 12+00
Y93 12+00
Y94 12+00
Y95 12+00
Y96 12+00
Y97 12+00
Y98 12+00
Y99 12+00
Y100 12+00

PLATFORM

PEDESTRIAN WALKWAY

CAPITAL CREST TRAIL

THIS CROSSOVER
MUST BE RELOCATED

PI STA TRK 2 25
19+31'38" DEGR
= PI STA YC 1+

EN C 001.1

A

21 EIT 5/2

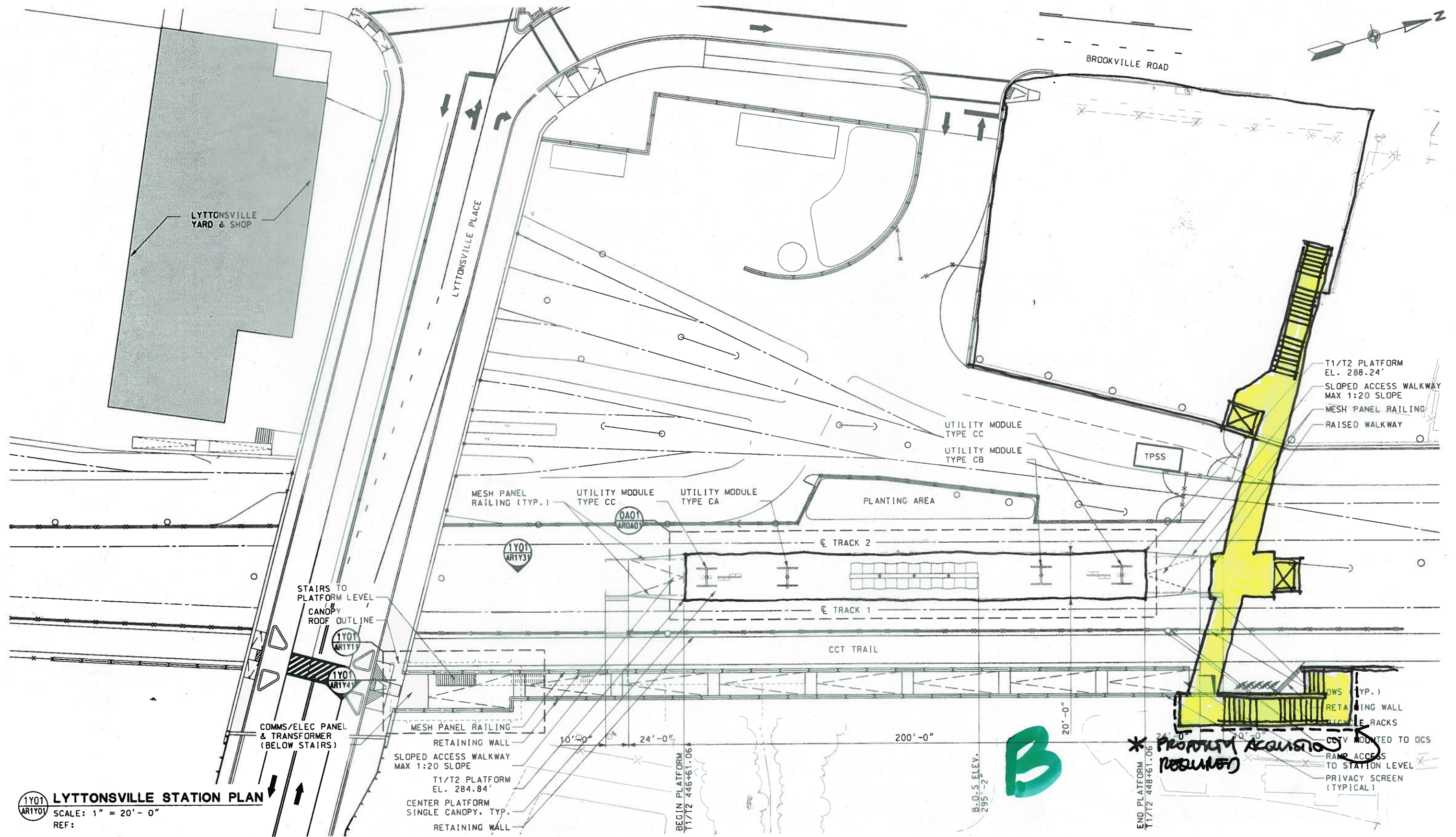

1Y01
AR1Y01
LYTTONSVILLE STATION PLAN
 SCALE: 1" = 20' - 0"
 REF:

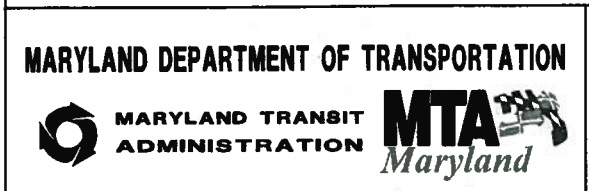

Notice: This record contains confidential and/or proprietary information that is part of the deliberative process for solicitation, evaluation, negotiation, award and negotiation of a public-private partnership agreement in accordance with Ch. 5, Acts of 2013, State Finance and Procurement Article §10A-201.

NO.	DESCRIPTION	BY	DATE
REVISIONS			

PRELIMINARY ENGINEERING
 PURPLE LINE LIGHT RAIL
 LYTTONSVILLE STATION
 STATION PLAN
 DATE: AUGUST 1, 2013
 SCALE: 1" = 20'

CONTRACT NO.
 T-1042-0220
 DRAWING NO.
 AR1Y01
 SHEET NO.
 166R OF 404

c:\pwworking\ymtopw\wra-luis_epeastegu\dms91178\1042pAR1Y10.dgn

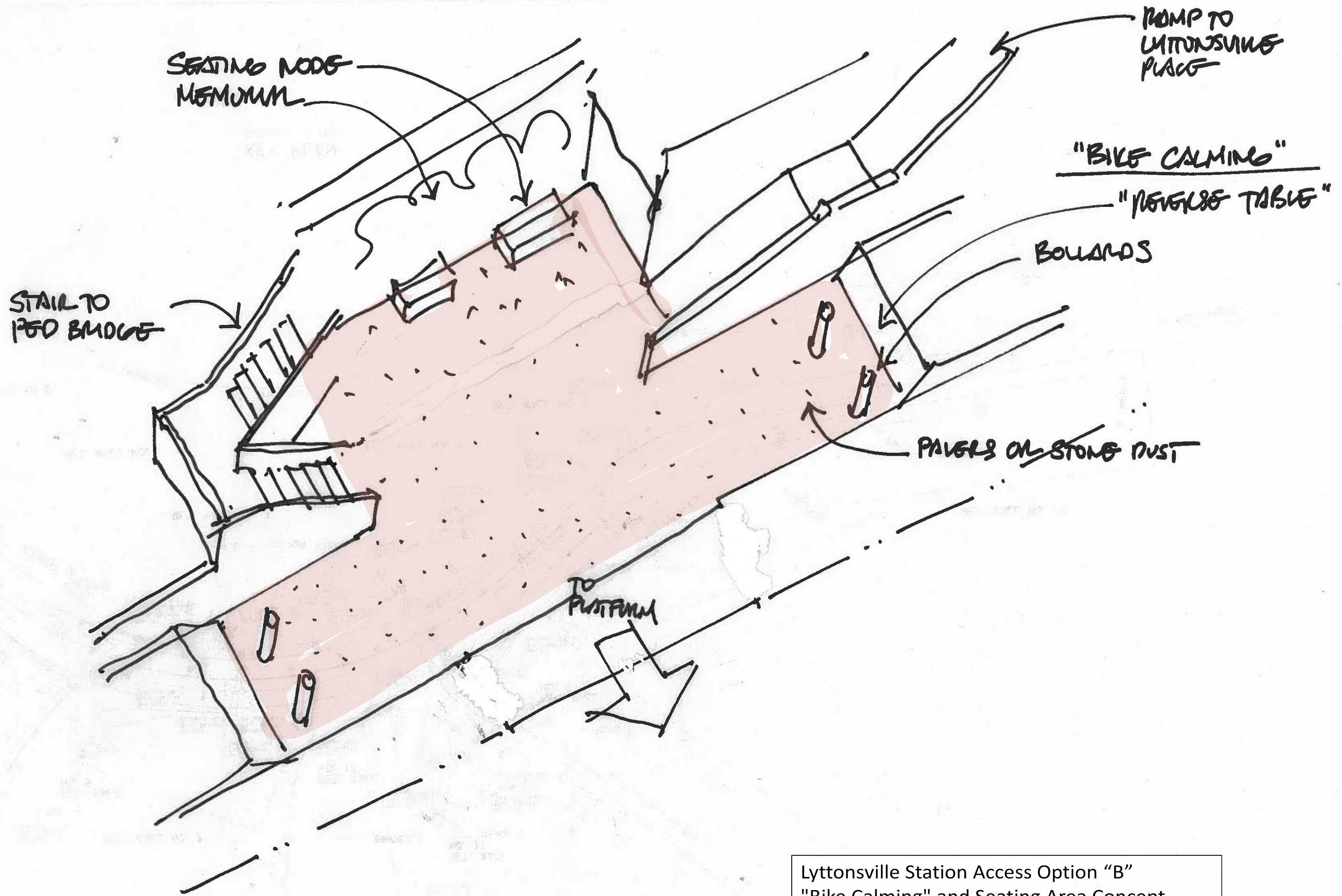

Lyttonsville Station Access Option "B"
"Bike Calming" and Seating Area Concept
February 27, 2014

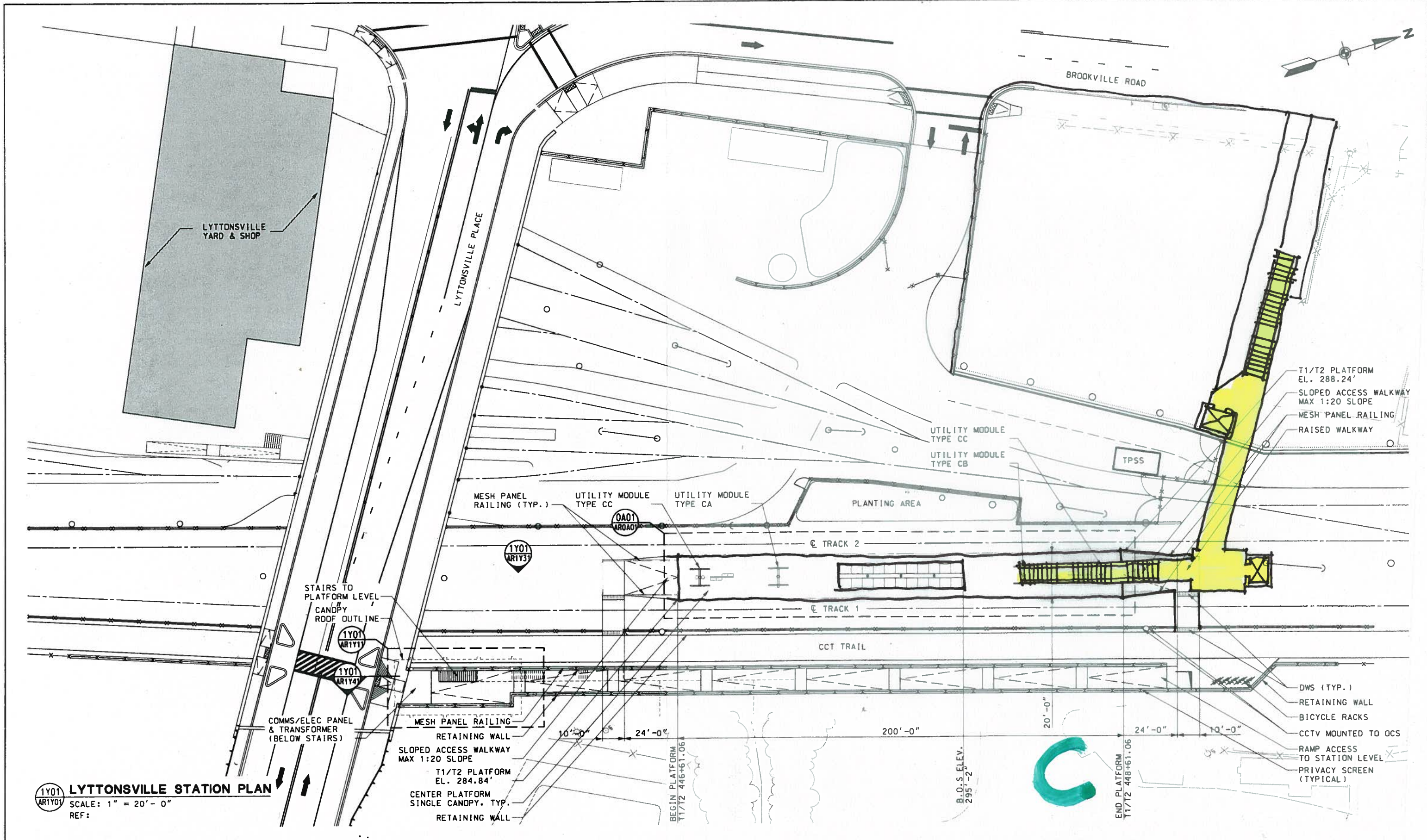

1Y01 LYTTONSVILLE STATION PLAN
 SCALE: 1" = 20' - 0"
 REF:

MARYLAND DEPARTMENT OF TRANSPORTATION
MARYLAND TRANSIT ADMINISTRATION
MTA Maryland

Gannett Fleming
WR&A

Notice: This record contains confidential and/or proprietary information that is part of the deliberative process for solicitation, evaluation, negotiation, award and negotiation of a public-private partnership agreement in accordance with Ch. 5, Acts of 2013, State Finance and Procurement Article §10A-201.

NO.	DESCRIPTION	BY	DATE
REVISIONS			

PRELIMINARY ENGINEERING
 PURPLE LINE LIGHT RAIL
 LYTTONSVILLE STATION
 STATION PLAN
 DATE: AUGUST 1, 2013
 SCALE: 1" = 20'

CONTRACT NO.
 T-1042-0220
 DRAWING NO.
 AR1Y01
 SHEET NO.
 166R OF 404