

Item #7



THE MARYLAND-NATIONAL CAPITAL PARK AND PLANNING COMMISSION

M E M O R A N D U M

DATE: March 14, 2003
TO: Montgomery County Planning Board
FROM: A. Malcolm Shaneman
Development Review Division
(301) 495-4587
SUBJECT: Informational Maps for Subdivision Items on the
Planning Board's Agenda for March 20, 2003.

Attached are copies of plan drawings for Items #07, #08 and #09. These subdivision items are scheduled for Planning Board consideration on March 20, 2003. The items are further identified as follows:

Agenda Item #07 - Pre-Preliminary Plan 7-03028
Horine Property

Agenda Item #08 - Preliminary Plan 1-93039A
Seventh-Day Adventist Property

Agenda Item #09 - Preliminary Plan 1-03043
Aston Manor

Attachment

VICINITY MAP FOR
HORINE PROPERTY (7-03028)



Map compiled on February 12, 2003 at 10:03 AM | Site located on base sheet no - 227NW18

NOTICE

The planimetric, property, and topographic information shown on this map is based on copyrighted Map Products from the Montgomery County Department of Park and Planning of the Maryland -National Capital Park and Planning Commission, and may not be copied or reproduced without written permission from M-NCPPC.

Property lines are compiled by adjusting the property lines to topography created from aerial photography using stereo photogrammetric methods. Planimetric features were compiled from 1:14400 scale aerial photography and should not be interpreted as actual field surveys.

This map is created from a variety of data sources, and may not reflect the most current conditions in any one location and may not be completely accurate or up to date. All map features are approximately within five feet of their true location. This map may not be the same as a map of the same area plotted at an earlier time as the data is continuously updated. Use of this map, other than for general planning purposes is not recommended. - Copyright 1998

Key Map

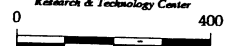
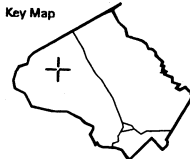

1 : 4800

VICINITY MAP FOR
HORINE PROPERTY (7-03028)

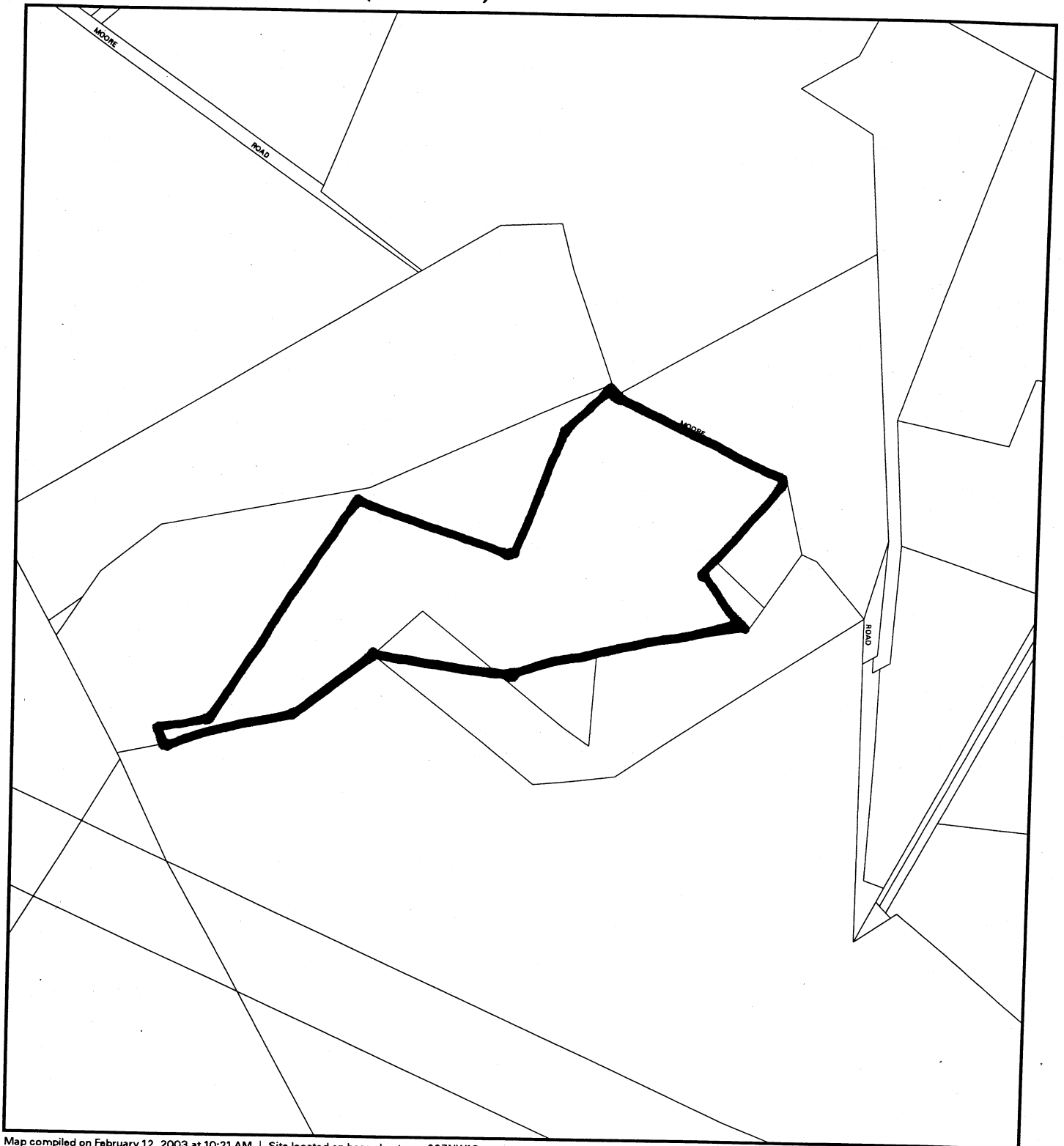

Map compiled on February 12, 2003 at 10:21 AM | Site located on base sheet no - 227NW18

NOTICE

The planimetric, property, and topographic information shown on this map is based on copyrighted Map Products from the Montgomery County Department of Park and Planning of the Maryland-National Capital Park and Planning Commission, and may not be copied or reproduced without written permission from M-NCPPC.

Property lines are compiled by adjusting the property lines to topography created from aerial photography and should not be interpreted as actual field surveys. Planimetric features were compiled from 1:14400 scale aerial photography using stereo photogrammetric methods.

This map is created from a variety of data sources, and may not reflect the most current conditions in any one location and may not be completely accurate or up to date. All map features are approximately within five feet of their true location. This map may not be the same as a map of the same area plotted at an earlier time as the data is continuously updated. Use of this map, other than for general planning purposes is not recommended. - Copyright 1998

MONTGOMERY COUNTY DEPARTMENT OF PARK AND PLANNING
THE MARYLAND-NATIONAL CAPITAL PARK AND PLANNING COMMISSION
8787 Georgia Avenue - Silver Spring, Maryland 20910-3760

