

- LANDSCAPE NOTES:**
1. PROVIDE CANOPY COVER FOR 15% OF SITE AREA.
 2. AREA = 84C
USE CANOPY = 0.94C
PLANT TREES FOR 0.94C CANOPY
EXISTING TREES (VEP) 38
PROPOSED TREES 38
TOTAL TREES 76

LIGHTING NOTE:
LIGHTING ALONG SIDEWALKS AND ROADWAYS SHALL MEET IES-NA STANDARDS

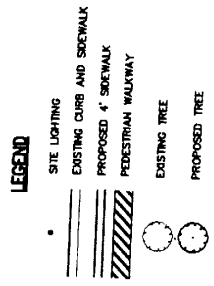

COMMERCIAL OCCUPANCY

INDUSTRIAL PARKWAY

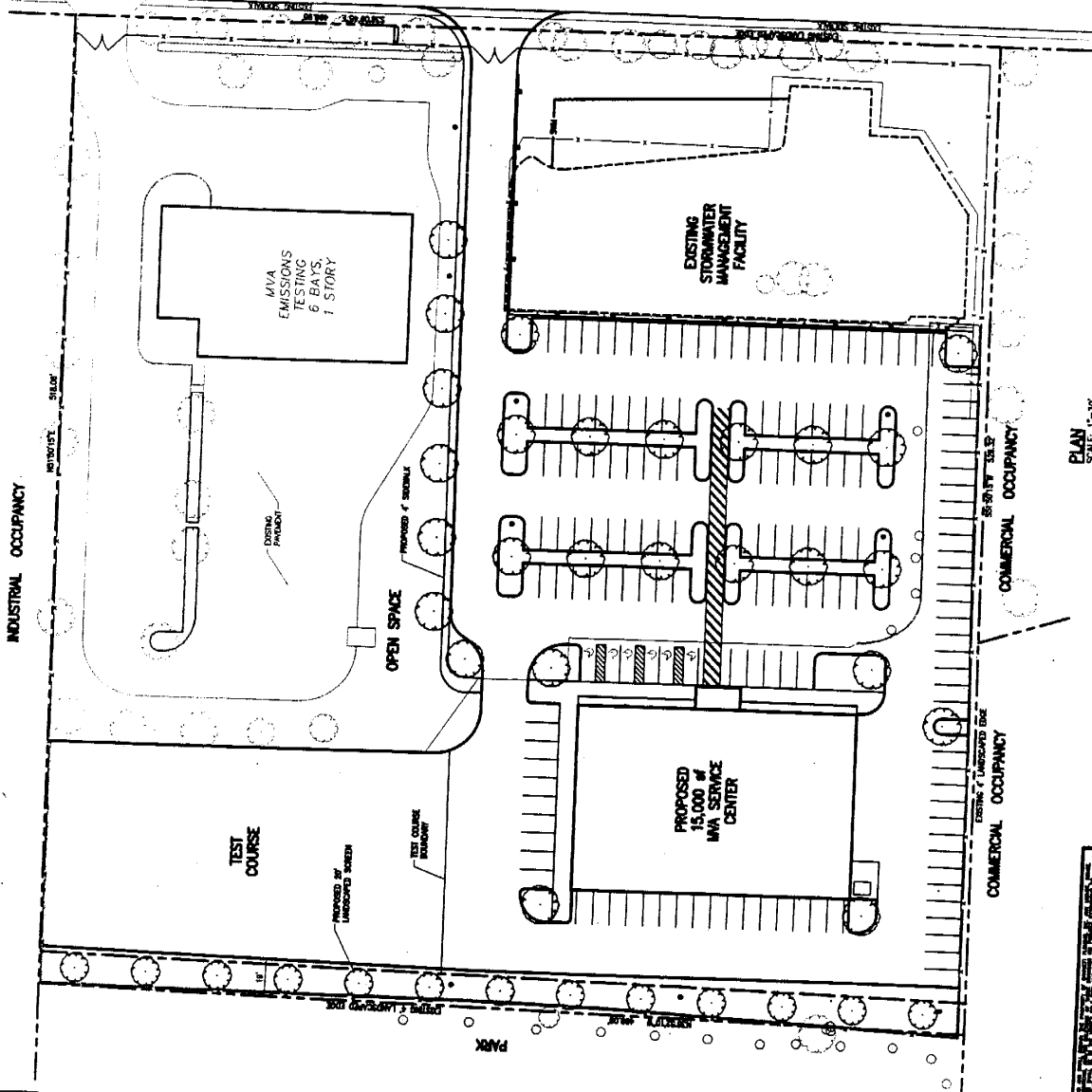

PLAN SCALE: 1"=30'

| | | | |
|------|----------|----------|-------|
| DATE | 4/2/03 | PART NO. | C-3 |
| DATE | 11/20/03 | DATE | 3 0 3 |
| DATE | 4/17/03 | DATE | 3 0 3 |

PROPOSED CONCEPTUAL LANDSCAPE LIGHTING AND SIDEWALK PLAN

MOTOR VEHICLE ADMINISTRATION
PROPOSED WHITE OAK
BRANCH OFFICE



| NO. | REVISIONS | DATE | BY | APPROVED | DATE | BY | SCALE | AS NOTED |
|-----|-----------|------|----|----------|------|----|-------|----------|
| | | | | | | | | |
| | | | | | | | | |
| | | | | | | | | |

