

Item #7

M-NCPPC

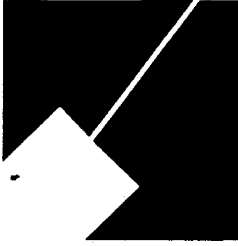

MONTGOMERY COUNTY DEPARTMENT OF PARK AND PLANNING

THE MARYLAND-NATIONAL CAPITAL
PARK AND PLANNING COMMISSION

8787 Georgia Avenue
Silver Spring, Maryland 20910-3760
301-495-4500, www.mncppc.org

M E M O R A N D U M

DATE: July 15, 2005

TO: Montgomery County Planning Board

FROM: Catherine Conlon
Development Review Division
(301) 495-4542

SUBJECT: Informational Maps for Subdivision Items on the
Planning Board's Agenda for July 21, 2005.

Attached are copies of plan drawings for item #07, and #09. These subdivision items are scheduled for Planning Board consideration on July 21, 2005. The items are further identified as follows:

Agenda Item #07 - Preliminary Plan 1-02063B
Fraley Property

Agenda Item #09 - Preliminary Plan 1-05055
Snyder Tract

Attachment

FRALEY PROPERTY (1-02063)

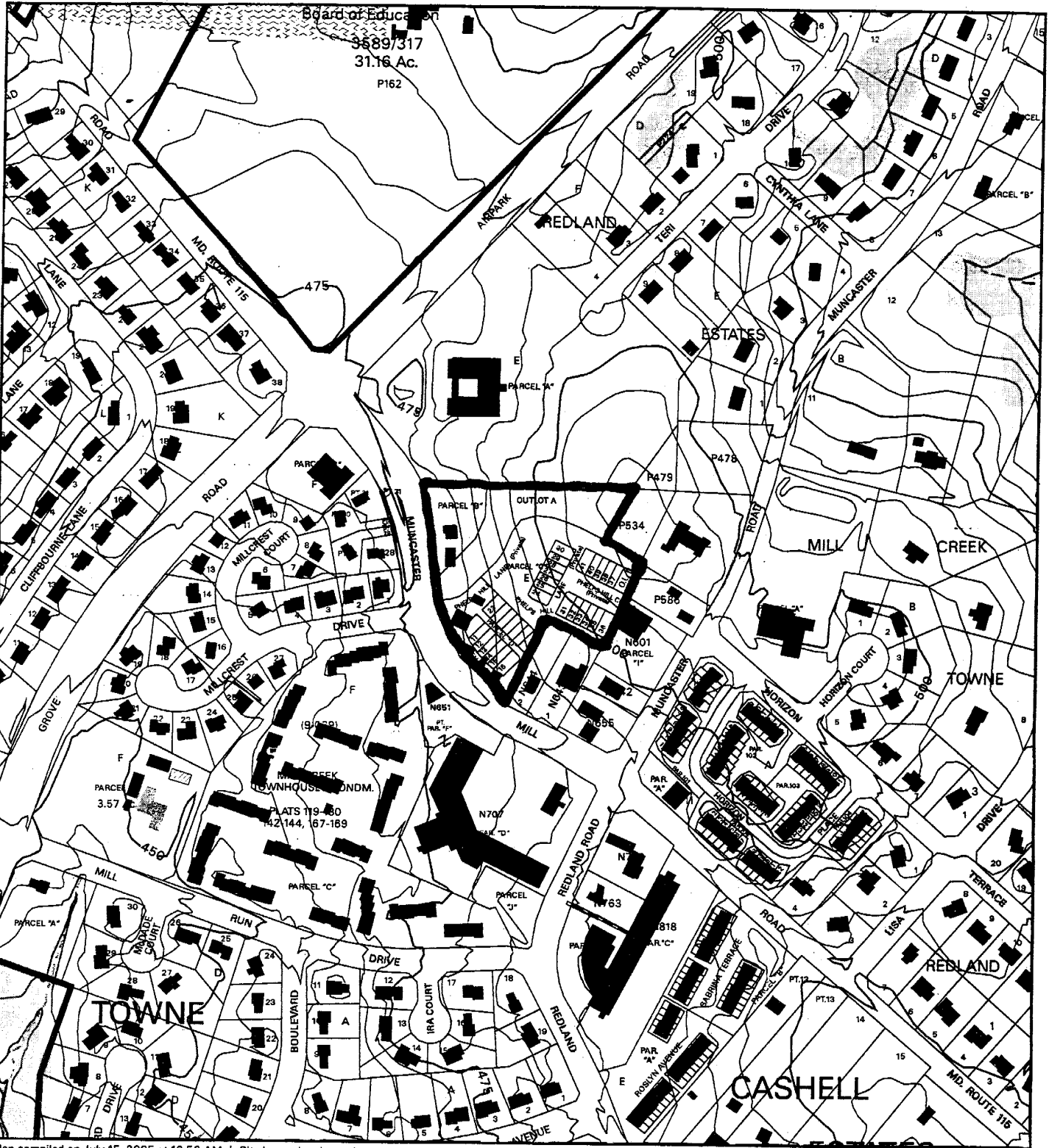

Map compiled on July 15, 2005 at 10:56 AM | Site located on base sheet no - 224NW07

NOTICE

The planimetric, property, and topographic information shown on this map is based on copyrighted Map Products from the Montgomery County Department of Park and Planning of the Maryland-National Capital Park and Planning Commission, and may not be copied or reproduced without written permission from M-NCPPC.

Property lines are compiled by adjusting the property lines to topography created from aerial photography and should not be interpreted as actual field surveys. Planimetric features were compiled from 1:14400 scale aerial photography using stereo photogrammetric methods.

This map is created from a variety of data sources, and may not reflect the most current conditions in any one location and may not be completely accurate or up to date. All map features are approximately within five feet of their true location. This map may not be the same as a map of the same area plotted at an earlier time as the data is continuously updated. Use of this map, other than for general planning purposes is not recommended. - Copyright 1998

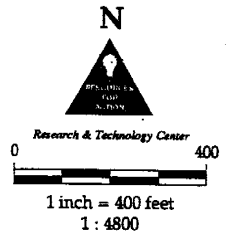
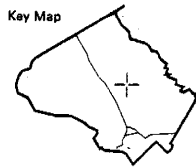

FRALEY PROPERTY (1-02063)

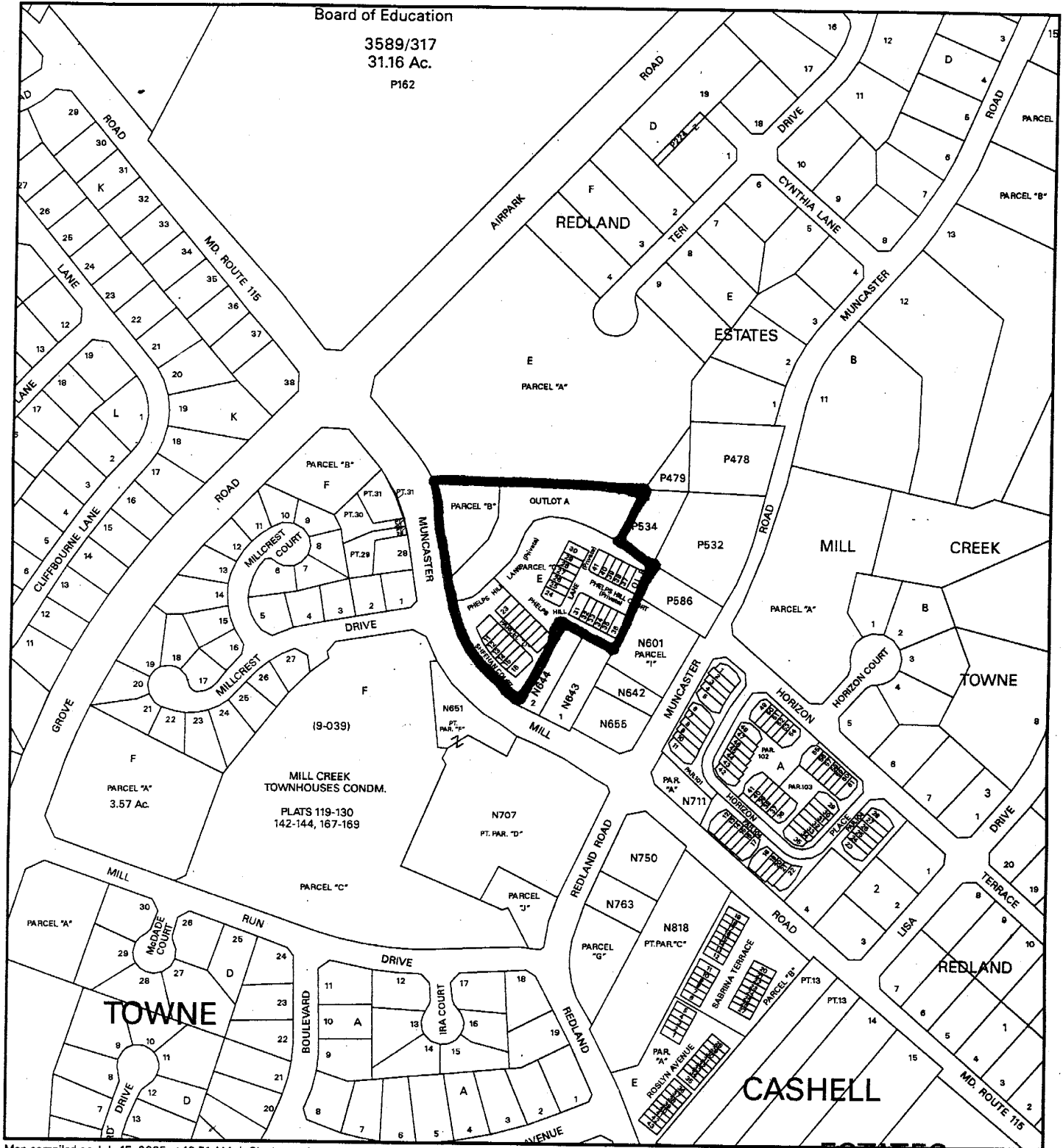

Map compiled on July 15, 2005 at 10:51 AM | Site located on base sheet no - 224NW07

NOTICE

The planimetric, property, and topographic information shown on this map is based on copyrighted Map Products from the Montgomery County Department of Park and Planning of the Maryland - National Capital Park and Planning Commission, and may not be copied or reproduced without written permission from M-NCPPC.

Property lines are compiled by adjusting the property lines to topography created from aerial photography and should not be interpreted as actual field surveys. Planimetric features were compiled from 1:14,400 scale aerial photography using stereo photogrammetric methods.

This map is created from a variety of data sources, and may not reflect the most current conditions in any one location and may not be completely accurate or up to date. All map features are approximately within five feet of their true location. This map may not be the same as a map of the same area plotted at an earlier time as the data is continuously updated. Use of this map, other than for general planning purposes is not recommended. - Copyright 1998

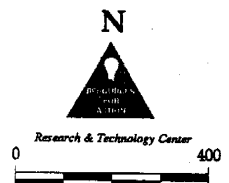

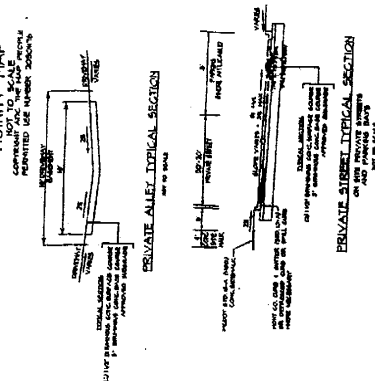
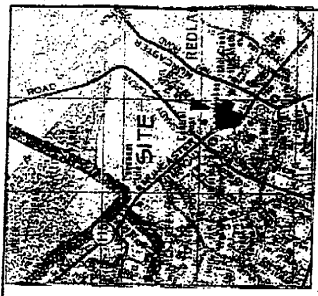

1. EXISTING UTILITIES ARE SHOWN AS DOTTED LINES. ALL UTILITIES SHALL BE DEEPENED TO A MINIMUM OF 48" BELOW FINISHED GRADE. ALL UTILITIES SHALL BE PROTECTED BY CONCRETE SLAB AND PIPE RACKS.

2. EXISTING UTILITIES ARE SHOWN AS DOTTED LINES. ALL UTILITIES SHALL BE DEEPENED TO A MINIMUM OF 48" BELOW FINISHED GRADE. ALL UTILITIES SHALL BE PROTECTED BY CONCRETE SLAB AND PIPE RACKS.

3. EXISTING UTILITIES ARE SHOWN AS DOTTED LINES. ALL UTILITIES SHALL BE DEEPENED TO A MINIMUM OF 48" BELOW FINISHED GRADE. ALL UTILITIES SHALL BE PROTECTED BY CONCRETE SLAB AND PIPE RACKS.

4. EXISTING UTILITIES ARE SHOWN AS DOTTED LINES. ALL UTILITIES SHALL BE DEEPENED TO A MINIMUM OF 48" BELOW FINISHED GRADE. ALL UTILITIES SHALL BE PROTECTED BY CONCRETE SLAB AND PIPE RACKS.

5. EXISTING UTILITIES ARE SHOWN AS DOTTED LINES. ALL UTILITIES SHALL BE DEEPENED TO A MINIMUM OF 48" BELOW FINISHED GRADE. ALL UTILITIES SHALL BE PROTECTED BY CONCRETE SLAB AND PIPE RACKS.

6. EXISTING UTILITIES ARE SHOWN AS DOTTED LINES. ALL UTILITIES SHALL BE DEEPENED TO A MINIMUM OF 48" BELOW FINISHED GRADE. ALL UTILITIES SHALL BE PROTECTED BY CONCRETE SLAB AND PIPE RACKS.

7. EXISTING UTILITIES ARE SHOWN AS DOTTED LINES. ALL UTILITIES SHALL BE DEEPENED TO A MINIMUM OF 48" BELOW FINISHED GRADE. ALL UTILITIES SHALL BE PROTECTED BY CONCRETE SLAB AND PIPE RACKS.

8. EXISTING UTILITIES ARE SHOWN AS DOTTED LINES. ALL UTILITIES SHALL BE DEEPENED TO A MINIMUM OF 48" BELOW FINISHED GRADE. ALL UTILITIES SHALL BE PROTECTED BY CONCRETE SLAB AND PIPE RACKS.

9. EXISTING UTILITIES ARE SHOWN AS DOTTED LINES. ALL UTILITIES SHALL BE DEEPENED TO A MINIMUM OF 48" BELOW FINISHED GRADE. ALL UTILITIES SHALL BE PROTECTED BY CONCRETE SLAB AND PIPE RACKS.

10. EXISTING UTILITIES ARE SHOWN AS DOTTED LINES. ALL UTILITIES SHALL BE DEEPENED TO A MINIMUM OF 48" BELOW FINISHED GRADE. ALL UTILITIES SHALL BE PROTECTED BY CONCRETE SLAB AND PIPE RACKS.

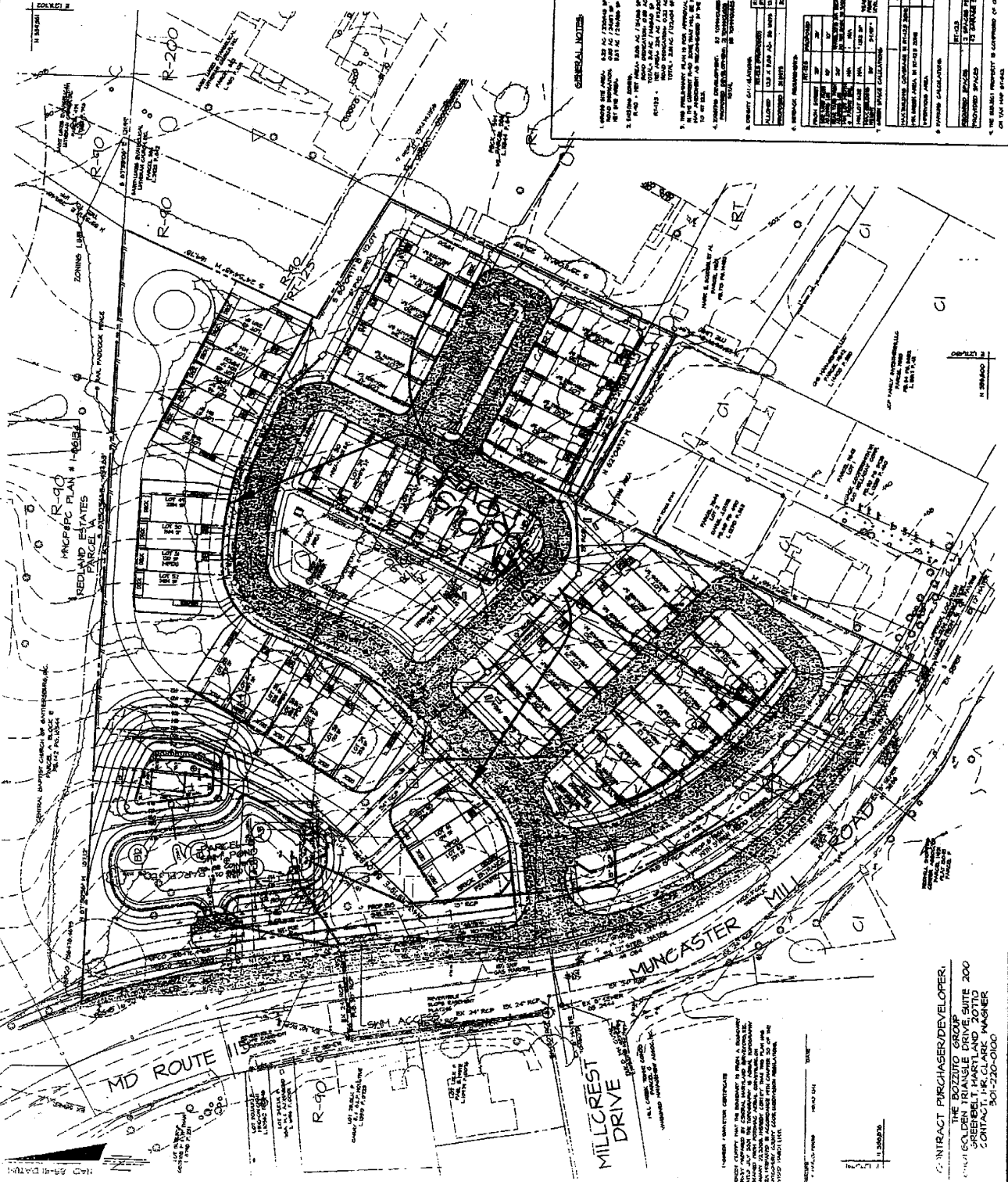

GENERAL NOTES

1. THE PRELIMINARY PLAN IS FOR APPROVAL OF THE BOARD OF SUPERVISORS. THE FINAL PLAN SHALL BE SUBMITTED TO THE BOARD OF SUPERVISORS FOR APPROVAL.

2. THE PRELIMINARY PLAN IS FOR APPROVAL OF THE BOARD OF SUPERVISORS. THE FINAL PLAN SHALL BE SUBMITTED TO THE BOARD OF SUPERVISORS FOR APPROVAL.

3. THE PRELIMINARY PLAN IS FOR APPROVAL OF THE BOARD OF SUPERVISORS. THE FINAL PLAN SHALL BE SUBMITTED TO THE BOARD OF SUPERVISORS FOR APPROVAL.

4. THE PRELIMINARY PLAN IS FOR APPROVAL OF THE BOARD OF SUPERVISORS. THE FINAL PLAN SHALL BE SUBMITTED TO THE BOARD OF SUPERVISORS FOR APPROVAL.

5. THE PRELIMINARY PLAN IS FOR APPROVAL OF THE BOARD OF SUPERVISORS. THE FINAL PLAN SHALL BE SUBMITTED TO THE BOARD OF SUPERVISORS FOR APPROVAL.

6. THE PRELIMINARY PLAN IS FOR APPROVAL OF THE BOARD OF SUPERVISORS. THE FINAL PLAN SHALL BE SUBMITTED TO THE BOARD OF SUPERVISORS FOR APPROVAL.

7. THE PRELIMINARY PLAN IS FOR APPROVAL OF THE BOARD OF SUPERVISORS. THE FINAL PLAN SHALL BE SUBMITTED TO THE BOARD OF SUPERVISORS FOR APPROVAL.

8. THE PRELIMINARY PLAN IS FOR APPROVAL OF THE BOARD OF SUPERVISORS. THE FINAL PLAN SHALL BE SUBMITTED TO THE BOARD OF SUPERVISORS FOR APPROVAL.

9. THE PRELIMINARY PLAN IS FOR APPROVAL OF THE BOARD OF SUPERVISORS. THE FINAL PLAN SHALL BE SUBMITTED TO THE BOARD OF SUPERVISORS FOR APPROVAL.

10. THE PRELIMINARY PLAN IS FOR APPROVAL OF THE BOARD OF SUPERVISORS. THE FINAL PLAN SHALL BE SUBMITTED TO THE BOARD OF SUPERVISORS FOR APPROVAL.

AMENDED PRELIMINARY PLAN
 FRALEY PROPERTY
 BY BLANDIN DISTRICT
 HONOLULU COUNTY, HAWAII

AMENDED PRELIMINARY PLAN

SCALE: 1"=50'
 DATE: APR 10, 2008
 DRAWN BY: ABC
 CHECKED BY: KVC

DATE: APR 2008
 DRAWN BY: ABC
 CHECKED BY: KVC

CONTRACT PURCHASER/DEVELOPER:
 THE BOZZUTO GROUP
 1000 GOLDEN TRIANGLE DRIVE, SUITE 200
 COSTA MESA, CA 92626
 CONTACT: FR. CLARK MAGNER
 501-220-0100

5000
 4000
 3000
 2000
 1000
 0

Apex engineering