

Item #6



THE MARYLAND-NATIONAL CAPITAL PARK AND PLANNING COMMISSION

MEMORANDUM

**DATE:** September 26, 2003  
**TO:** Montgomery County Planning Board  
**FROM:** A. Malcolm Shaneman  
Development Review Division  
(301) 495-4587  
**SUBJECT:** Informational Maps for Subdivision Items on the  
Planning Board's Agenda for October 02, 2003.

-----  
-

Attached are copies of plan drawings for Item #06, #08, #10, #12, #13 and #14. These subdivision items are scheduled for Planning Board consideration on October 02, 2003. The items are further identified as follows:

Agenda Item #06 - Preliminary Plan 1-03102  
Greencastle Towns

Agenda Item #08 - Preliminary Plan 1-03086  
Potomac Country Corner

Agenda Item #10 - Preliminary Plan 1-03058  
Bancroft North

Agenda Item #12 - Preliminary Plan 1-03032  
Jackson's Acres

Agenda Item #13 - Preliminary Plan 1-00076E  
The Independence of Privacy World

Agenda Item #14 - Subdivision Regulation Waiver SRW-04001  
Willerburn Acres

Attachment

VICINITY MAP FOR

# GREENCASTLE TOWNS (8-03038) (1-03102)

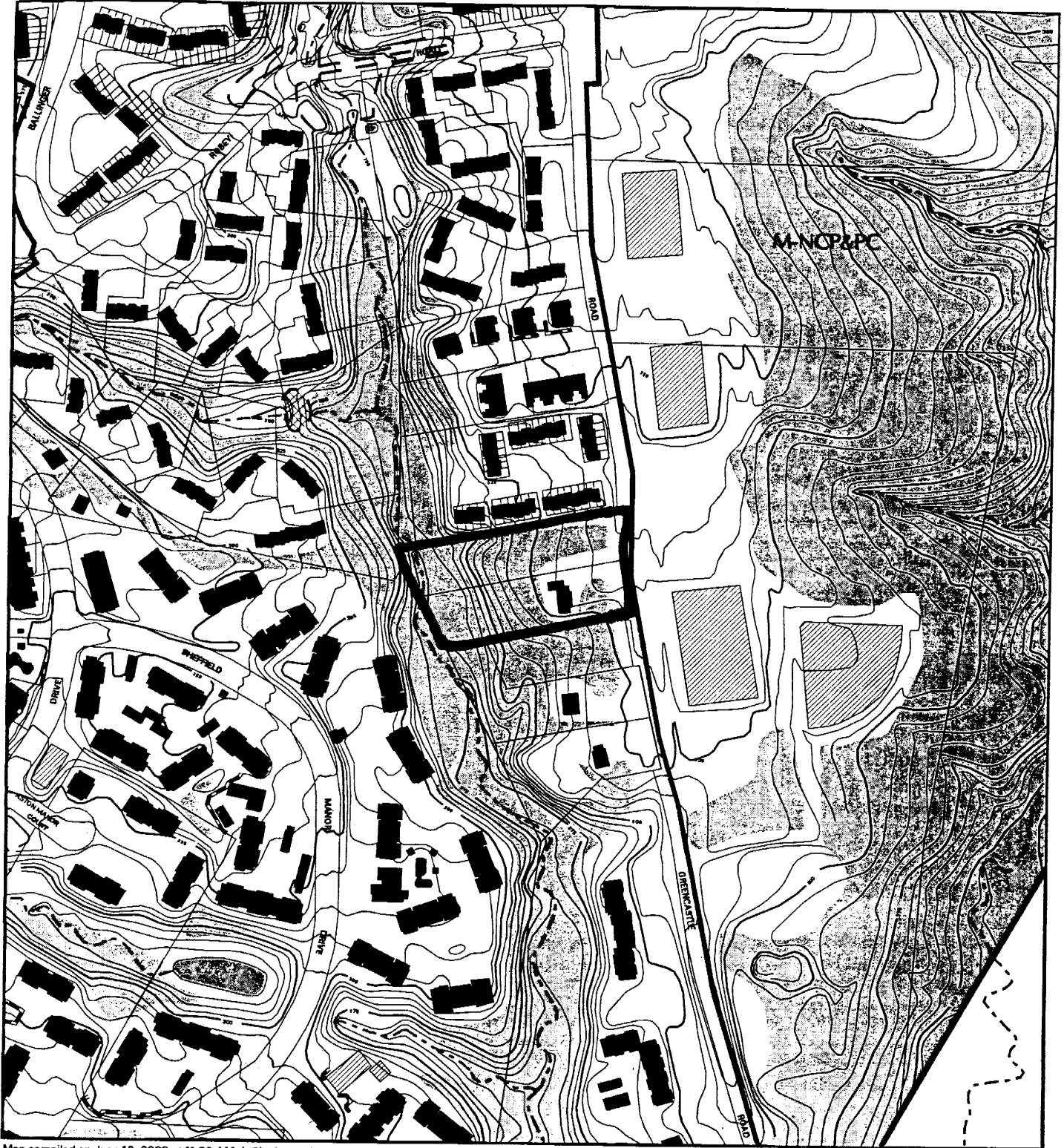

Map compiled on June 19, 2003 at 11:09 AM | Site located on base sheet no - 218NE04

### NOTICE

The planimetric, property, and topographic information shown on this map is based on copyrighted Map Products from the Montgomery County Department of Park and Planning of the Maryland-National Capital Park and Planning Commission, and may not be copied or reproduced without written permission from M-NCPPC.

Property lines are compiled by adjusting the property lines to topography created from aerial photography and should not be interpreted as actual field surveys. Planimetric features were compiled from 1:14400 scale aerial photography using stereo photogrammetric methods.

This map is created from a variety of data sources, and may not reflect the most current conditions in any one location and may not be completely accurate or up to date. All map features are approximately within five feet of their true location. This map may not be the same as a map of the same area plotted at an earlier time as the data is continuously updated. Use of this map, other than for general planning purposes is not recommended. - Copyright 1998

Key Map



Research & Technology Center



1 : 4800

# GREENCASTLE TOWNS (1-03102)

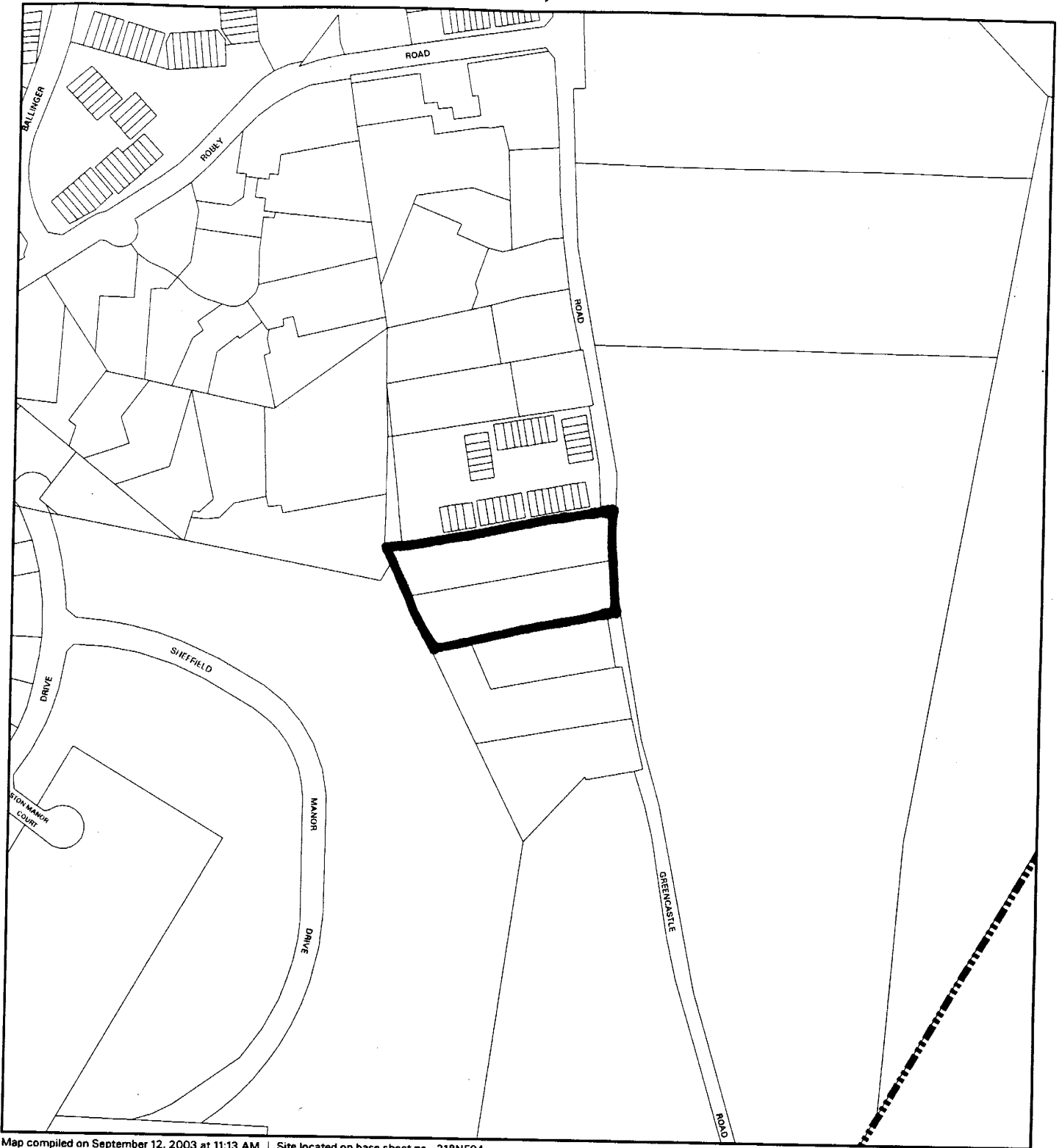

Map compiled on September 12, 2003 at 11:13 AM | Site located on base sheet no - 218NE04

## NOTICE

The planimetric, property, and topographic information shown on this map is based on copyrighted Map Products from the Montgomery County Department of Park and Planning of the Maryland-National Capital Park and Planning Commission, and may not be copied or reproduced without written permission from M-NCPPC.

Property lines are compiled by adjusting the property lines to topography created from aerial photography and should not be interpreted as actual field surveys. Planimetric features were compiled from 1:14400 scale aerial photography using stereo photogrammetric methods.

This map is created from a variety of data sources, and may not reflect the most current conditions in any one location and may not be completely accurate or up to date. All map features are approximately within five feet of their true location. This map may not be the same as a map of the same area plotted at an earlier time as the data is continuously updated. Use of this map, other than for general planning purposes is not recommended. - Copyright 1998

Key Map

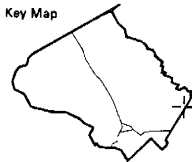

Research & Technology Center



1:4800

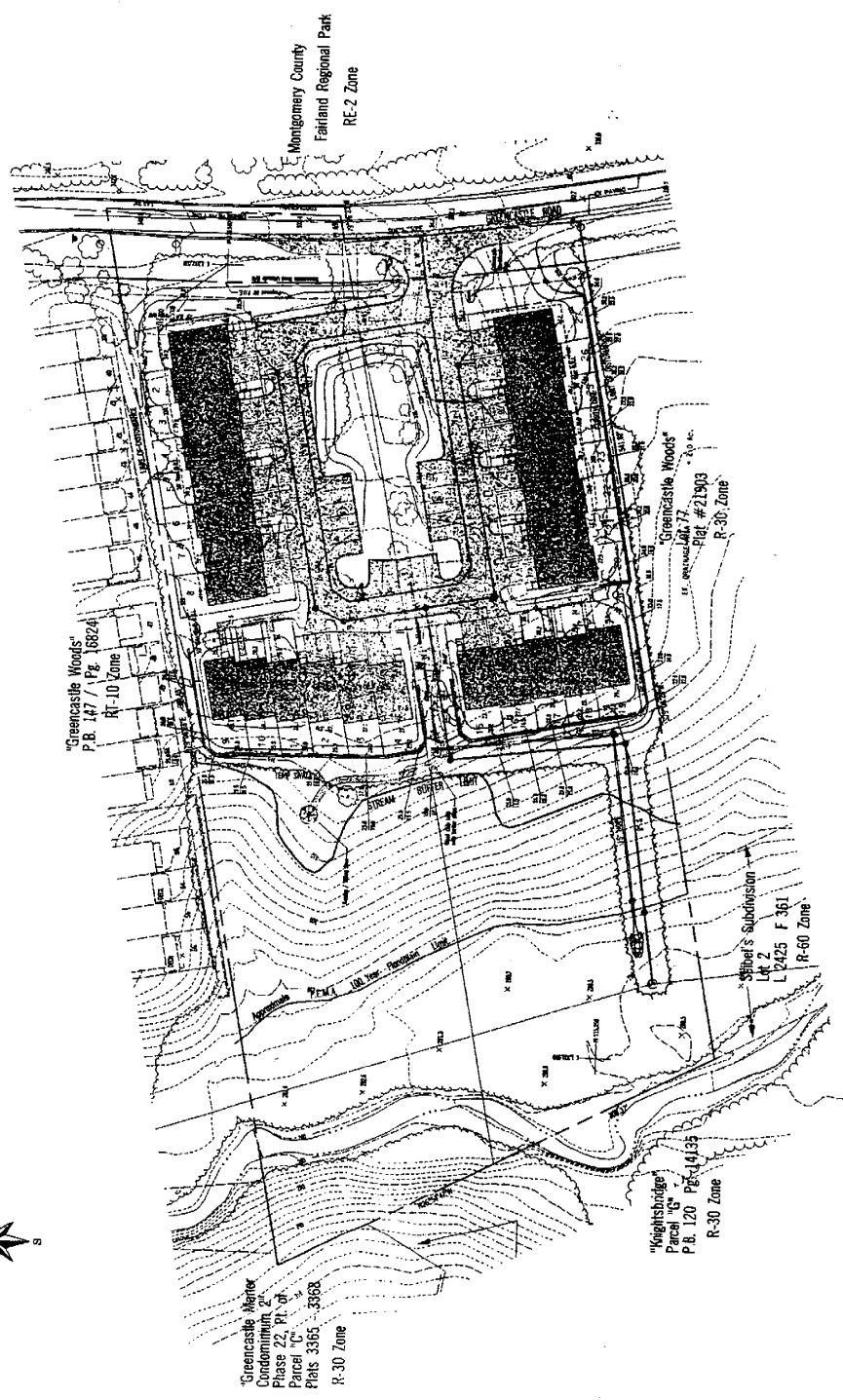
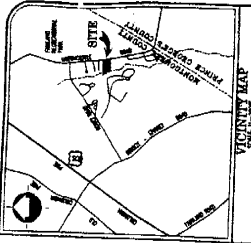

**SITE DATA**

1. Survey: 1874
2. Area: 10.00 Acres (43,560 Sq. Ft.)
3. Area of 100 Year Floodplain: Approximately 20,000 Sq. Ft. (R. 10 Z-2)
4. Property is to be used for Residential purposes.
5. Subject Property is located in the Fairland Regional Park (RE-2 Zone).
6. Subject Property is located in the Fairland Regional Park (RE-2 Zone).
7. Subject Property is located in the Fairland Regional Park (RE-2 Zone).
8. Subject Property is located in the Fairland Regional Park (RE-2 Zone).
9. Subject Property is located in the Fairland Regional Park (RE-2 Zone).
10. Subject Property is located in the Fairland Regional Park (RE-2 Zone).
11. Subject Property is located in the Fairland Regional Park (RE-2 Zone).
12. Subject Property is located in the Fairland Regional Park (RE-2 Zone).
13. Subject Property is located in the Fairland Regional Park (RE-2 Zone).
14. Subject Property is located in the Fairland Regional Park (RE-2 Zone).
15. Subject Property is located in the Fairland Regional Park (RE-2 Zone).
16. Subject Property is located in the Fairland Regional Park (RE-2 Zone).
17. Subject Property is located in the Fairland Regional Park (RE-2 Zone).
18. Subject Property is located in the Fairland Regional Park (RE-2 Zone).
19. Subject Property is located in the Fairland Regional Park (RE-2 Zone).
20. Subject Property is located in the Fairland Regional Park (RE-2 Zone).

**General Notes**

1. Boundary lines are shown for reference only. They do not constitute a survey.
2. All dimensions are in feet and inches.
3. All dimensions are to the center of the line.
4. All dimensions are to the center of the line.

**SITE SOLUTIONS, INC.**  
 18000 Old Branch Road, Suite 100  
 Rockville, MD 20850  
 (301) 715-0010  
 (301) 715-0011  
 www.site-solutions.com

NOTES: See the title block of this plan for a complete list of notes and conditions. All dimensions are to the center of the line.

APPLICANT: TC Greencastle LLC  
 1110 Rockville Pike, Suite 500  
 Rockville, MD 20852  
 301.231.8900

PRELIMINARY PLAN  
**GREENCASCADE TOWNS**  
 PARCEL 147 & 148  
 MONTGOMERY COUNTY, MARYLAND

DATE	11-15-07
SCALE	1" = 1'
PROJECT NO.	1300