

## **APPENDIX B**

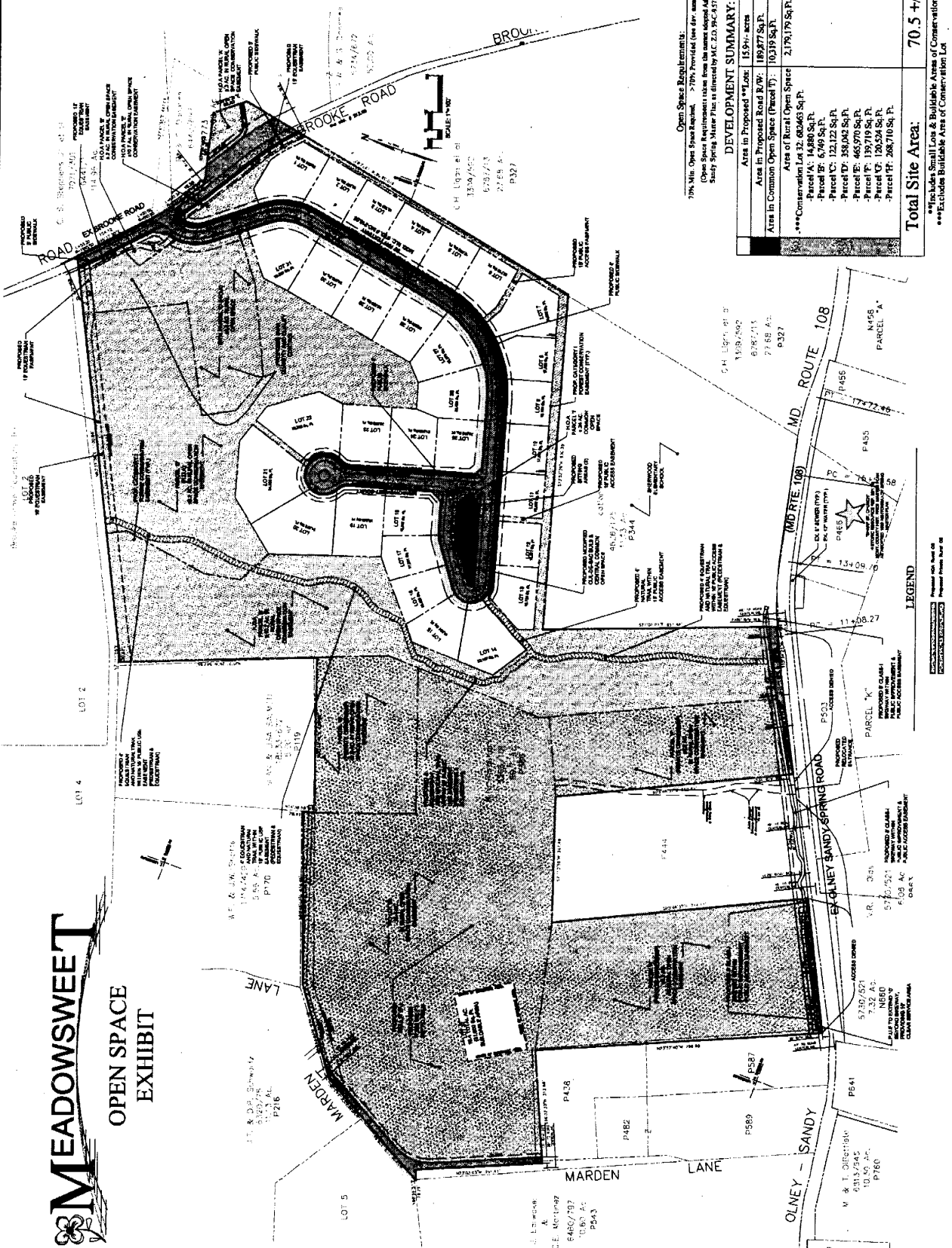

# MEADOWSWEET

## OPEN SPACE EXHIBIT



**Open Space Requirements:**  
 75% Min. Open Space Required. >75% Provided (see Dev. Summary Table)  
 Open Space Requirements taken from the annexed Address Study Report, under the direction of the MDOT (PC-9375)

**DEVELOPMENT SUMMARY:**

Area in Proposed *Lot	15.9 +/- acres
Area in Proposed Road R/W	189,877 Sq. Ft.
Area in Common Open Space (Parcel ID)	103,119 Sq. Ft.
Area of Rural Open Space	2,178,179 Sq. Ft. (79%) (50 AC.)
***Conservation of 103,119 Sq. Ft.	
- Parcel ID: 6348 Sq. Ft.	
- Parcel ID: 121,223 Sq. Ft.	
- Parcel ID: 388,043 Sq. Ft.	
- Parcel ID: 445,970 Sq. Ft.	
- Parcel ID: 1,937,195 Sq. Ft.	
- Parcel ID: 120,524 Sq. Ft.	
- Parcel ID: 268,710 Sq. Ft.	

**Total Site Area: 70.5 +/- acres**  
 \*\*Includes Rural Open Space & Buildable Area of Conservation Lot  
 \*\*\*Excludes Buildable Area of Conservation Lot

**MEADOWSWEET CONSULTING**  
 10600 ARDENFIELD DRIVE  
 SUITE 227  
 GREENBELT, MARYLAND 20818  
 CONTACT: STEVE CONWELL

**MEADOWSWEET**  
 10600 ARDENFIELD DRIVE  
 SUITE 227  
 GREENBELT, MARYLAND 20818  
 CONTACT: STEVE CONWELL

**OPEN SPACE EXHIBIT**

**MEADOWSWEET CONSULTING**  
 10600 ARDENFIELD DRIVE  
 SUITE 227  
 GREENBELT, MARYLAND 20818  
 CONTACT: STEVE CONWELL

**MEADOWSWEET**  
 10600 ARDENFIELD DRIVE  
 SUITE 227  
 GREENBELT, MARYLAND 20818  
 CONTACT: STEVE CONWELL

**MEADOWSWEET**

**MEADOWSWEET CONSULTING**  
 10600 ARDENFIELD DRIVE  
 SUITE 227  
 GREENBELT, MARYLAND 20818  
 CONTACT: STEVE CONWELL

**MEADOWSWEET**  
 10600 ARDENFIELD DRIVE  
 SUITE 227  
 GREENBELT, MARYLAND 20818  
 CONTACT: STEVE CONWELL