

Item # 15

M-NCPPC

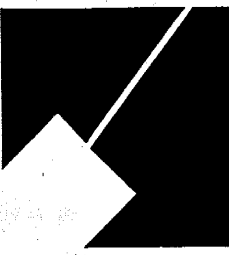

MONTGOMERY COUNTY DEPARTMENT OF PARK AND PLANNING

THE MARYLAND-NATIONAL CAPITAL
PARK AND PLANNING COMMISSION

8787 Georgia Avenue
Silver Spring, Maryland 20910-3760
301-495-4500, www.mncppc.org

MEMORANDUM

DATE: October 22, 2004
TO: Montgomery County Planning Board
FROM: Catherine Conlon
Development Review Division
(301) 495-4542
SUBJECT: Informational Maps for Subdivision Items on the
Planning Board's Agenda for October 28, 2004.

Attached are copies of plan drawings for item #09, #10, #14, #15, #16 #17 and #18. These subdivision items are scheduled for Planning Board consideration on October 28, 2004. The items are further identified as follows:

Agenda Item #09 - Preliminary Plan 1-85245A
Avalon at Decoverly, Phase 2

Agenda Item #10 - Preliminary Plan 1-88264B
Avalon at Decoverly, Phase 2

Agenda Item #14 - Preliminary Plan 1-04031
North Westland Building

Agenda Item #15 - Preliminary Plan 1-05001
Fairland View

Agenda Item #16 - Preliminary Plan 1-04027
Briarcliff Meadows North

Agenda Item #17 - Preliminary Plan 1-04036
Briarcliff Meadows South

Agenda Item #18 - Preliminary Plan 1-00076E
The Independence of Privacy World

Attachment

FAIRLAND VIEW (1-05001)

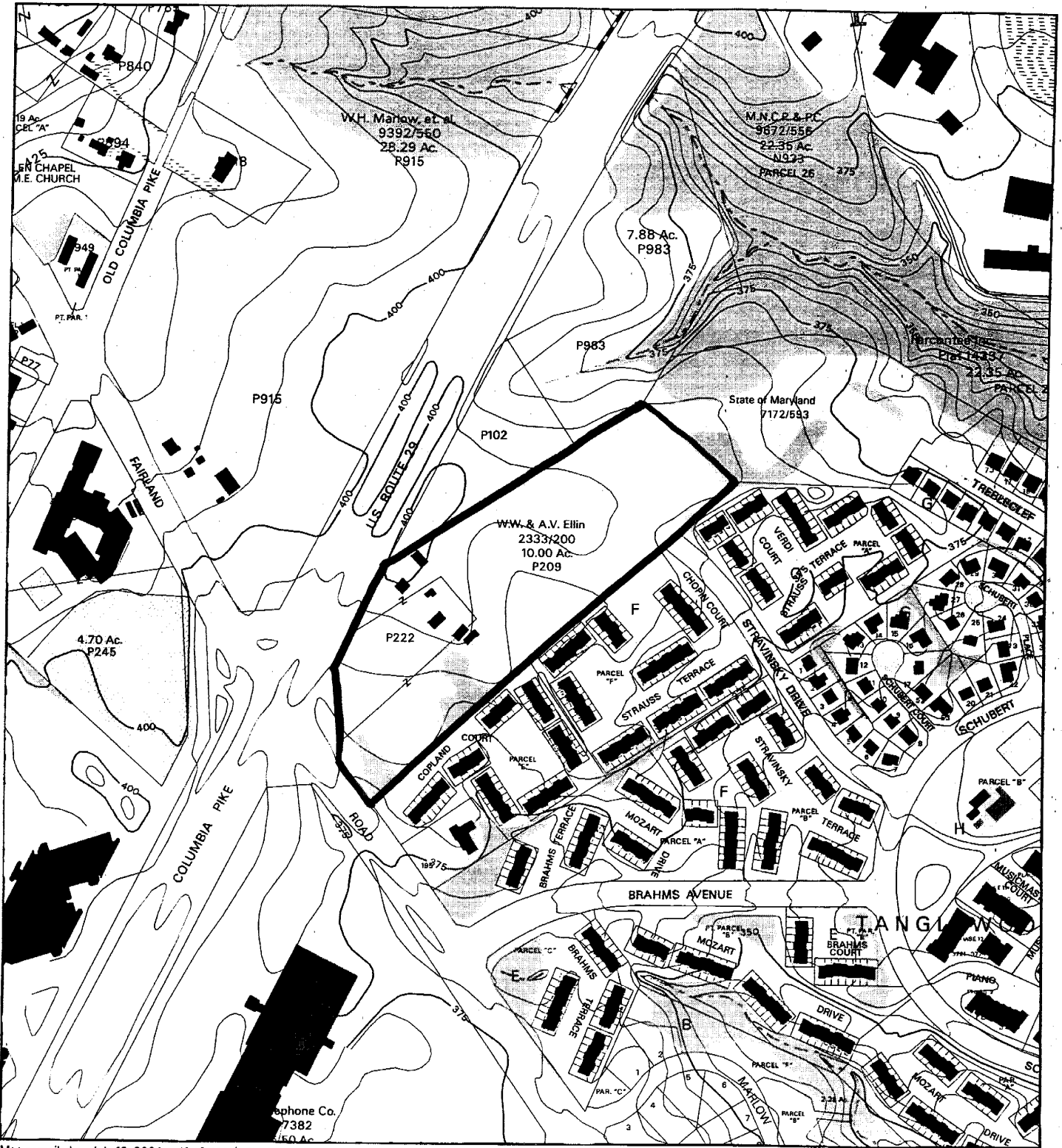

Map compiled on July 19, 2004 at 10:16 AM | Site located on base sheet no - 217NE03

NOTICE

The planimetric, property, and topographic information shown on this map is based on copyrighted Map Products from the Montgomery County Department of Park and Planning of the Maryland-National Capital Park and Planning Commission, and may not be copied or reproduced without written permission from M-NCPPC.

Property lines are compiled by adjusting the property lines to topography created from aerial photography and should not be interpreted as actual field surveys. Planimetric features were compiled from 1:14400 scale aerial photography using stereo photogrammetric methods.

This map is created from a variety of data sources, and may not reflect the most current conditions in any one location and may not be completely accurate or up to date. All map features are approximately within five feet of their true location. This map may not be the same as a map of the same area plotted at an earlier time as the data is continuously updated. Use of this map, other than for general planning purposes is not recommended. - Copyright 1998

Key Map

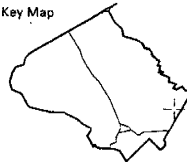

Research & Technology Center

0 400



1 inch = 400 feet

1 : 4800

FAIRLAND VIEW (1-05001)

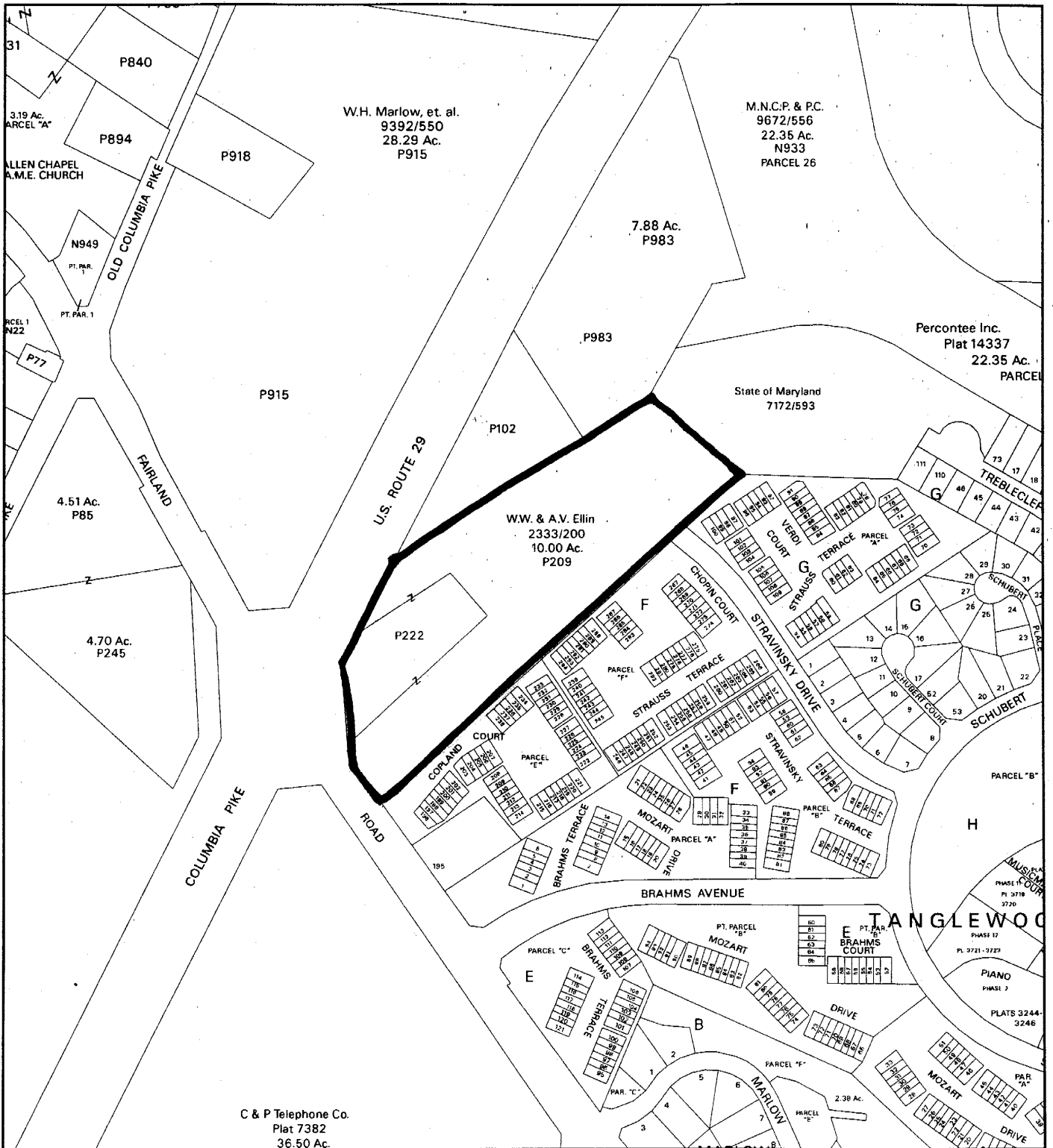

Map compiled on October 21, 2004 at 4:42 PM | Site located on base sheet no - 217NE03

NOTICE

The planimetric, property, and topographic information shown on this map is based on copyrighted Map Products from the Montgomery County Department of Park and Planning of the Maryland -National Capital Park and Planning Commission, and may not be copied or reproduced without written permission from M-NCPPC.

Property lines are compiled by adjusting the property lines to topography created from aerial photography and should not be interpreted as actual field surveys. Planimetric features were compiled from 1:14400 scale aerial photography using stereo photogrammetric methods.

This map is created from a variety of data sources, and may not reflect the most current conditions in any one location and may not be completely accurate or up to date. All map features are approximately within five feet of their true location. This map may not be the same as a map of the same area plotted at an earlier time as the data is continuously updated. Use of this map, other than for general planning purposes is not recommended. - Copyright 1998

Key Map

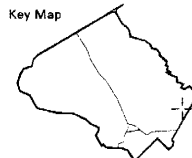

N



Research & Technology Center



1 inch = 400 feet
1 : 4800

MONTGOMERY COUNTY DEPARTMENT OF PARK AND PLANNING
THE MARYLAND-NATIONAL CAPITAL PARK AND PLANNING COMMISSION

8787 Georgia Avenue - Silver Spring, Maryland 20910-3760

