

FARMLAND ELEMENTARY SCHOOL



Map compiled on March 10, 2005 at 2:52 PM | Site located on base sheet no. -215NW07

NOTICE

The planimetric, property, and topographic information shown on this map is based on copyrighted Map Products from the Montgomery County Department of Park and Planning of the Maryland-National Capital Park and Planning Commission, and may not be copied or reproduced without written permission from M-NCPPC.

Property lines are compiled by adjusting the property lines to topography created from aerial photography and should not be interpreted as actual field surveys. Planimetric features were compiled from 1:14400 scale aerial photography using stereo photogrammetric methods.

This map is created from a variety of data sources, and may not reflect the most current conditions in any one location and may not be completely accurate or up to date. All map features are approximately within five feet of their true location. This map may not be the same as a map of the same area plotted at an earlier time as the data is continuously updated. Use of this map, other than for general planning purposes is not recommended. - Copyright 1998

Key Map

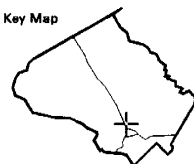

N



Research & Technology Center



1 inch = 400 feet
1 : 4800

MONTGOMERY COUNTY DEPARTMENT OF PARK AND PLANNING
THE MARYLAND-NATIONAL CAPITAL PARK AND PLANNING COMMISSION

8787 Georgia Avenue - Silver Spring, Maryland 20910-3760

7

B. Existing Site Plan

Existing Site Plan

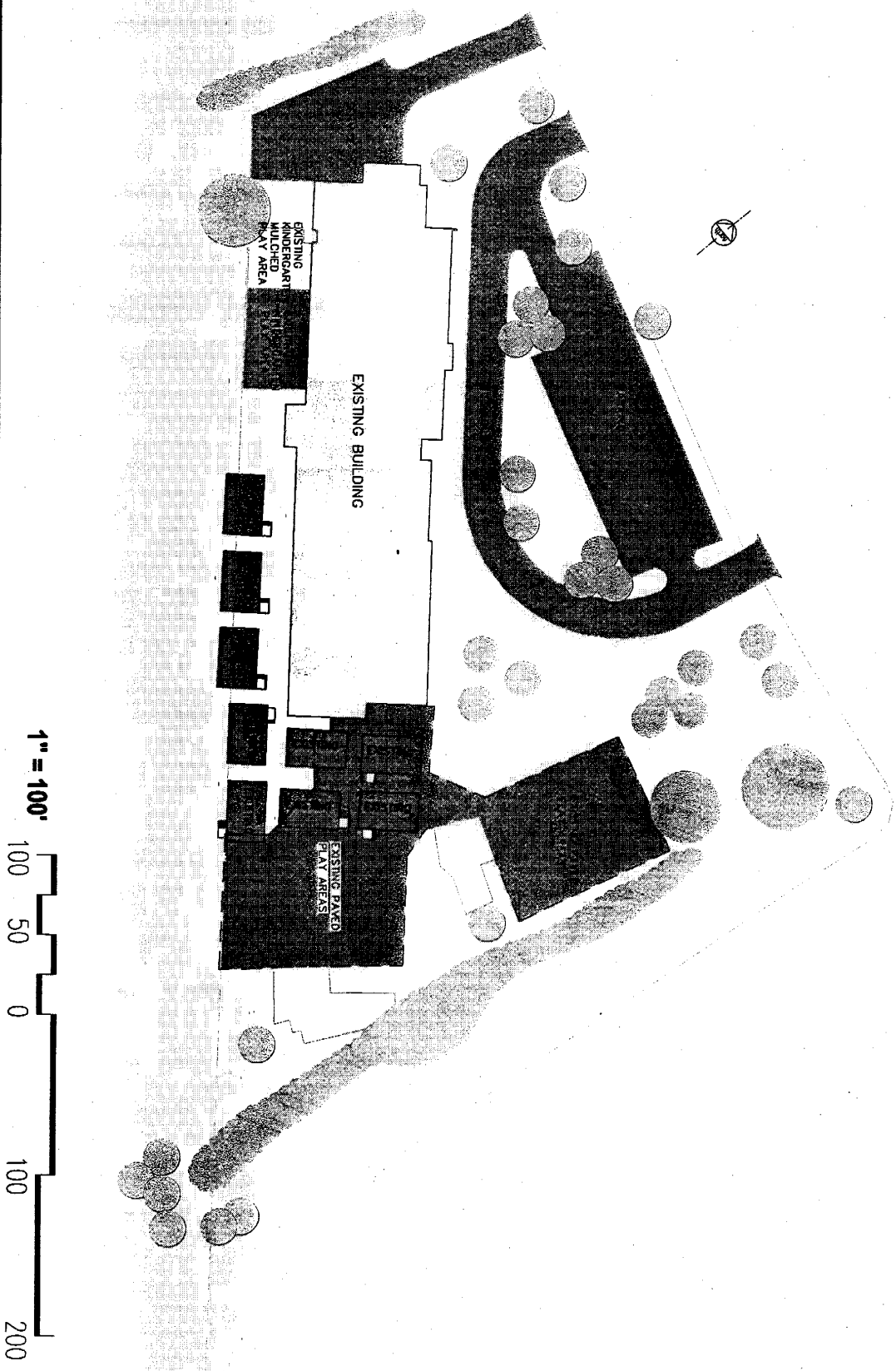

8

C. Proposed Site Plan

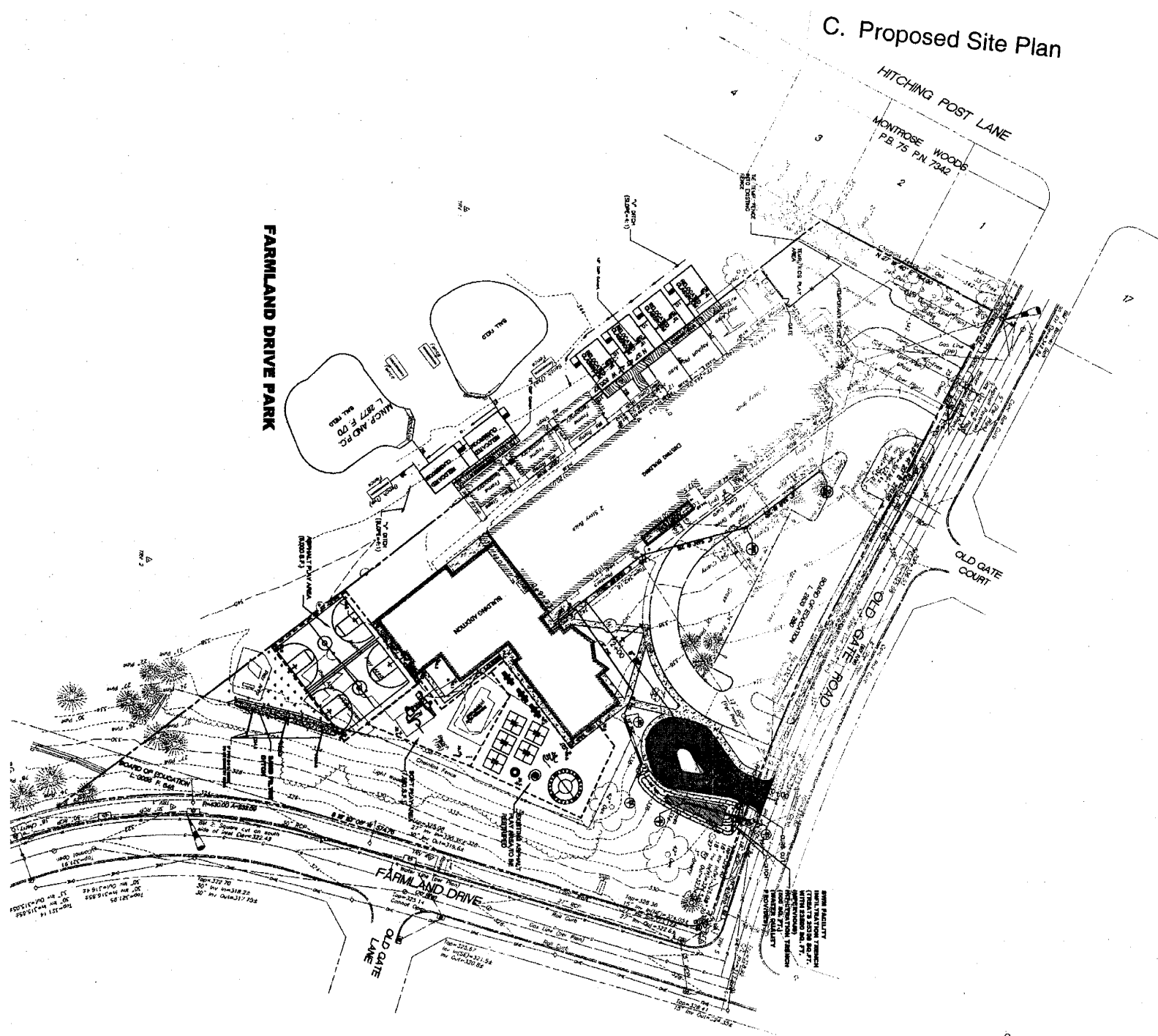

FARMLAND DRIVE PARK

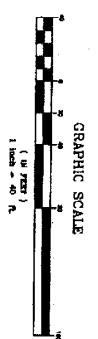

9

- LEGEND**
- NEW BUILDING
 - ASPHALT
 - GRASS
 - PROPOSED STORM DRAIN PIPE
 - PROPOSED SANITARY SEWER PIPE
 - PROPOSED WATER LINE
 - PROPOSED FENCE
 - TYPICAL STRUCTURE (D.# I.E. INLET #) OR MANHOLE (MH)
 - INFILTRATION TRENCH
 - STONE
 - SURFACE SAND FILTER
 - "V" DITCH, 4:1 SIDE SLOPES, 6" DEEP TO BE STABILIZED IMMEDIATELY W/ SOG

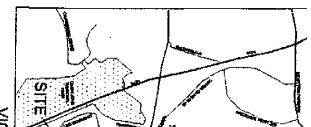

THE TOWN OF FARMINGTON
PLANNING AND ZONING DEPARTMENT
100 STATE STREET, FARMINGTON, CT 06030
PHONE: 860-635-1234
FAX: 860-635-1235

DESIGNED BY: _____
DRAWN BY: _____
CHECKED BY: _____
DATE: _____

THIS IS NOT A RESUB TO
BEING COMPLETED

This drawing is for the proposed site plan and is not to be used for any other purpose without the written consent of the Planning and Zoning Department.