

LOT 17, BLOCK 2  
 PLAT NO. 24503  
 4500 EAST WEST HWY  
 EX. USE: MIXED-USE  
 EX. ZONING: CR-5.0 C4.0 R-4.75 H-100T  
 PENDING ZONING: CR-5.0 C4.0 R-4.75 H-125

PT LOT 7, BLOCK 1  
 PLAT NO. 125  
 4425 MONTGOMERY AVE  
 EX. USE: OFFICE  
 EX. ZONING: CRN-0.5  
 C-0.5 R-0.25 H-35  
 PENDING ZONING: CR-1.5  
 C-1.5, R-1.5, H-145

PARCEL G  
 PLAT NO. 23818  
 4550 MONTGOMERY AVE  
 EX. USE: MIXED USE  
 EX. ZONING: CR-5.0 C4.0 R-4.75 H-145T  
 PENDING ZONING: CR-5.0 C4.0 R-4.75 H-175

PARCEL B  
 PLAT NO. 9443  
 7300 PEARL ST  
 EX. USE: OFFICE  
 EX. ZONING: CR-5.0 C4.0 R-4.75 H-145T  
 PENDING ZONING: CR-5.0 C4.0 R-4.75 H-175

PARCEL B  
 PLAT NO. 14905  
 4400 MONTGOMERY AVE  
 EX. USE: HEALTH CLUB  
 EX. ZONING: CRN-0.5 C0.5 R-0.25 H-35  
 PENDING ZONING: CR-1.5 C1.5 R-1.5 H-120





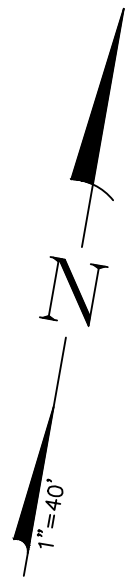

PT LOT 1, BLOCK 6  
 PLAT NO. 125  
 4424 MONTGOMERY AVE  
 EX. USE: BANK  
 EX. ZONING: EOF-3.0 H-100  
 PENDING ZONING: CR-3.0 C3.0, R-3.0 H-145

LOT 2, BLOCK 6  
 PLAT NO. 125  
 EX. USE: SURFACE PARKING  
 EX. ZONING: EOF-3.0 H-100  
 PENDING ZONING: CR-3.0 C3.0, R-3.0 H-145

MONTGOMERY AVE  
 VARIABLE WIDTH R/W  
 MASTER PLAN 80' R/W

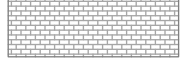
PEARL STREET  
 VARIABLE WIDTH R/W  
 MASTER PLAN 60' R/W

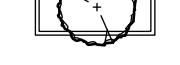

- LEGEND**
-  PROPERTY BOUNDARY
  -  PROPOSED BUILDING
  -  PROPOSED STREETSCAPE
  -  PROPOSED STROMWATER MANAGEMENT FACILITY
  -  PROPOSED STREET TREE PER BETHESDA STREETSCAPE
  -  BUILDING HEIGHT MEASURING POINT
  -  EXISTING STREET TREE

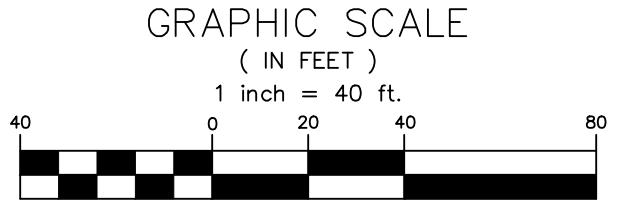

SKETCH PLAN  
**4540 MONTGOMERY AVENUE**