

**SITE DATA**

1. Zoning: RNC
2. Existing Land Use: Golf Course & Club Facilities
3. Gross Tract Area: 197.58 Acres (per Plat # 23986 by Joyce Engineering Corporation)
4. Approximate Area of Existing Forest Cover: 29.8 Acres (1,297,000 sq.ft.)
5. Area Previously Placed in CATEGORY I CONSERVATION EASEMENTS: 29.775 ACRES (1,297,000 SQ.FT.)
6. Area of Existing CATEGORY I CONSERVATION EASEMENTS To Be Removed: 3.90 ACRES (169,600 SQ. FT.)
7. NEW AREA TO BE PLACED IN CATEGORY I CONSERVATION EASEMENTS: 3.90 ACRES (169,800 SQ. FT.)
8. FINAL TOTAL AREA PLACED IN CATEGORY I CONSERVATION EASEMENTS: 29.780 ACRES 1,297,200 SQ.FT.)

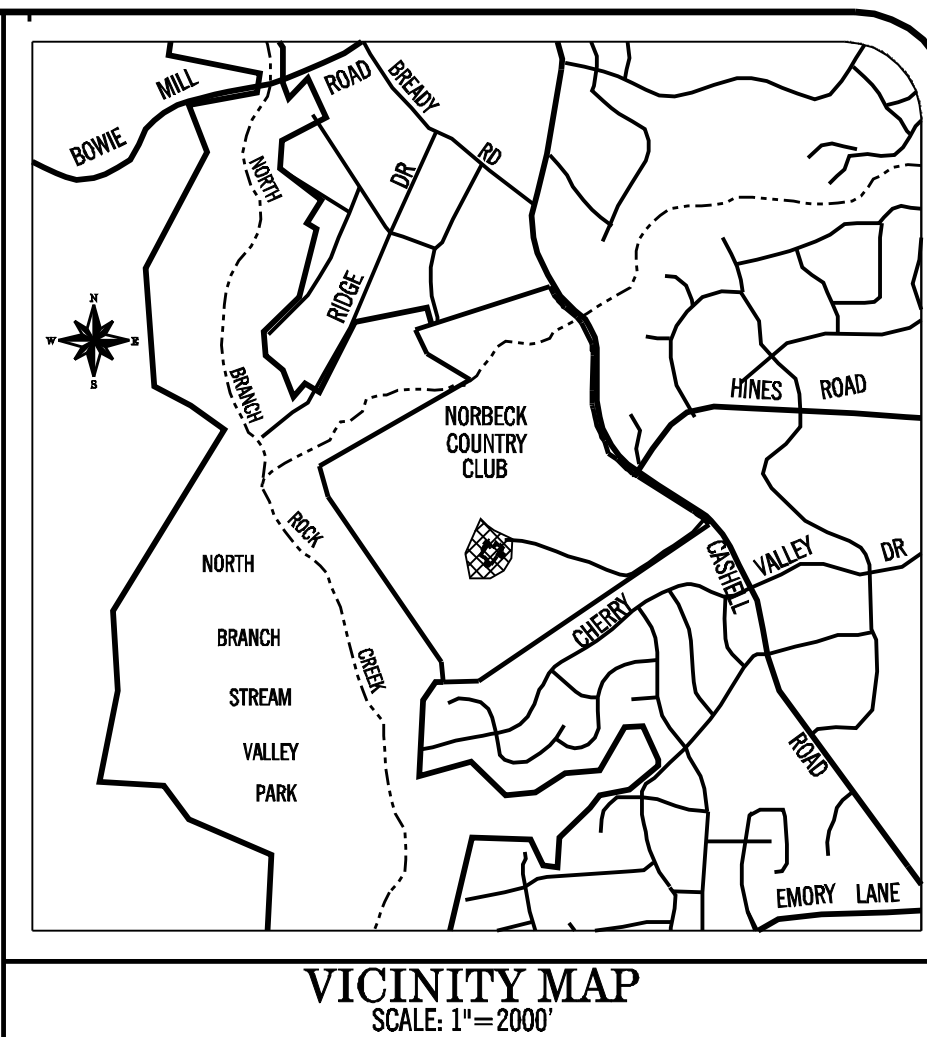

**Legend**

- Existing Category I Conservation Easement Boundary & Area to be Retained
- Existing Category I Conservation Easement Boundary & Area to be Extinguished & Abandoned
- Proposed Category I Conservation Easement Boundary & Area to be Created
- 100-year Floodplain Boundary
- 25' BRL
- Site Boundary

FOREST CONSERVATION WORKSHEET  
Norbeck Country Club 7/23/2018

NET TRACT AREA:

A. Total tract area	197.58
B. Land dedication acres (partly, county facility, etc.)	0.00
C. Land dedication for roads or utilities (not being constructed by this plan)	0.00
D. Area to remain in commercial agricultural production/use	0.00
E. Other deductions (Specialty)	0.00
F. Net Tract Area	197.58

LAND USE CATEGORY: (from Trees Technical Manual)  
Input the number "1" under the appropriate land use, limit to only one entry.

ARA	0	MOR	0	IDA	0	HDR	0	MPD	0	CIA	0
-----	---	-----	---	-----	---	-----	---	-----	---	-----	---

G. Afforestation Threshold ..... 15% x F = 29.64  
H. Conservation Threshold ..... 20% x F = 39.52

EXISTING FOREST COVER:

I. Existing forest cover	29.80
J. Area of forest above afforestation threshold	0.16
K. Area of forest above conservation threshold	0.00

BREAK EVEN POINT:

L. Forest retention above threshold with no mitigation	0.00
M. Clearing permitted without mitigation	0.00

PROPOSED FOREST CLEARING:

N. Total area of forest to be cleared	0.00
O. Total area of forest to be retained	29.80

PLANTING REQUIREMENTS:

P. Reforestation for clearing above conservation threshold	0.00
Q. Reforestation for clearing below conservation threshold	0.00
R. Credit for retention above conservation threshold	0.00
S. Total reforestation required	0.00
T. Total afforestation required	0.00
U. Credit for landscaping (may not exceed 20% of "S")	0.00
V. Total reforestation and afforestation required	0.00

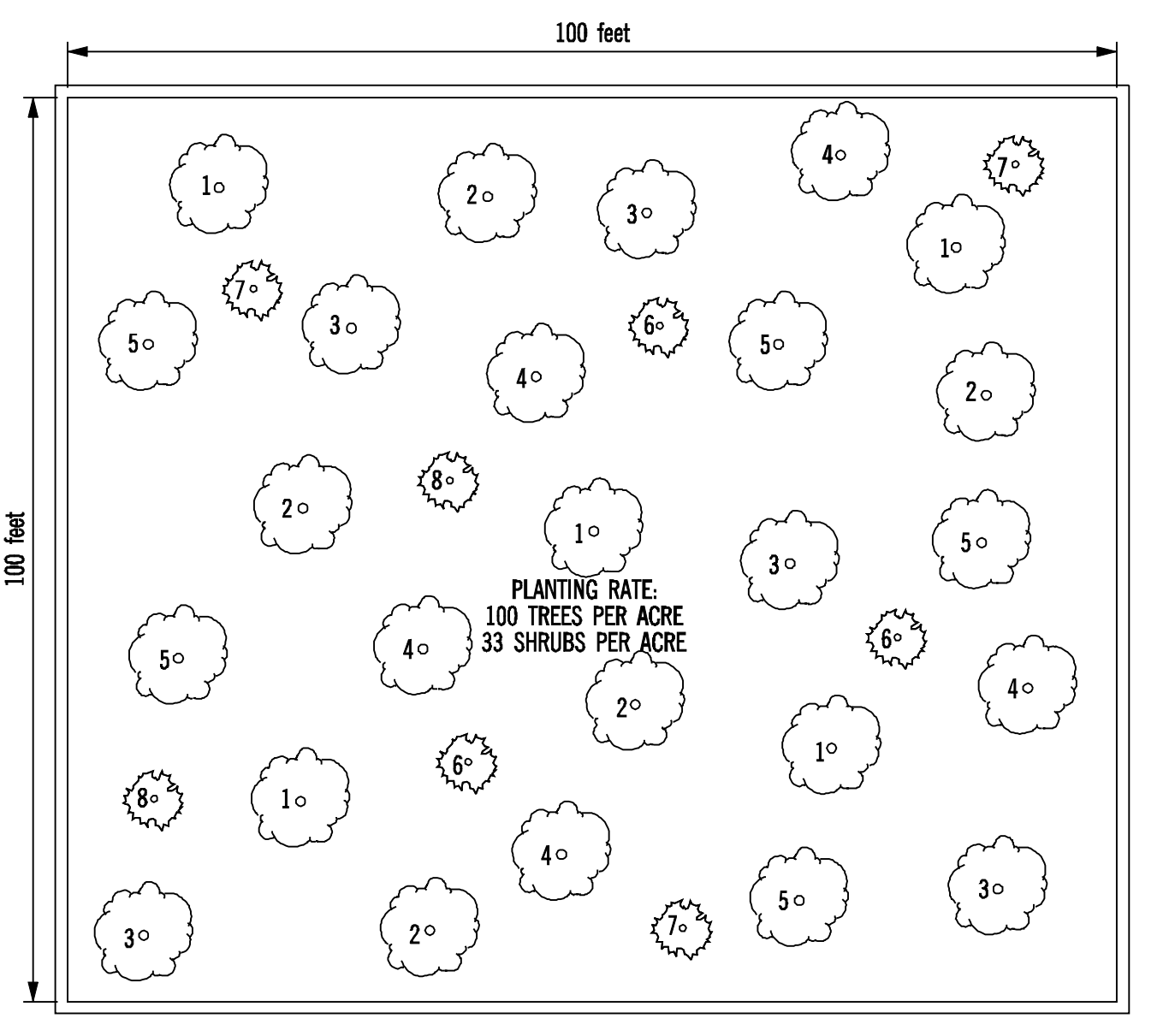
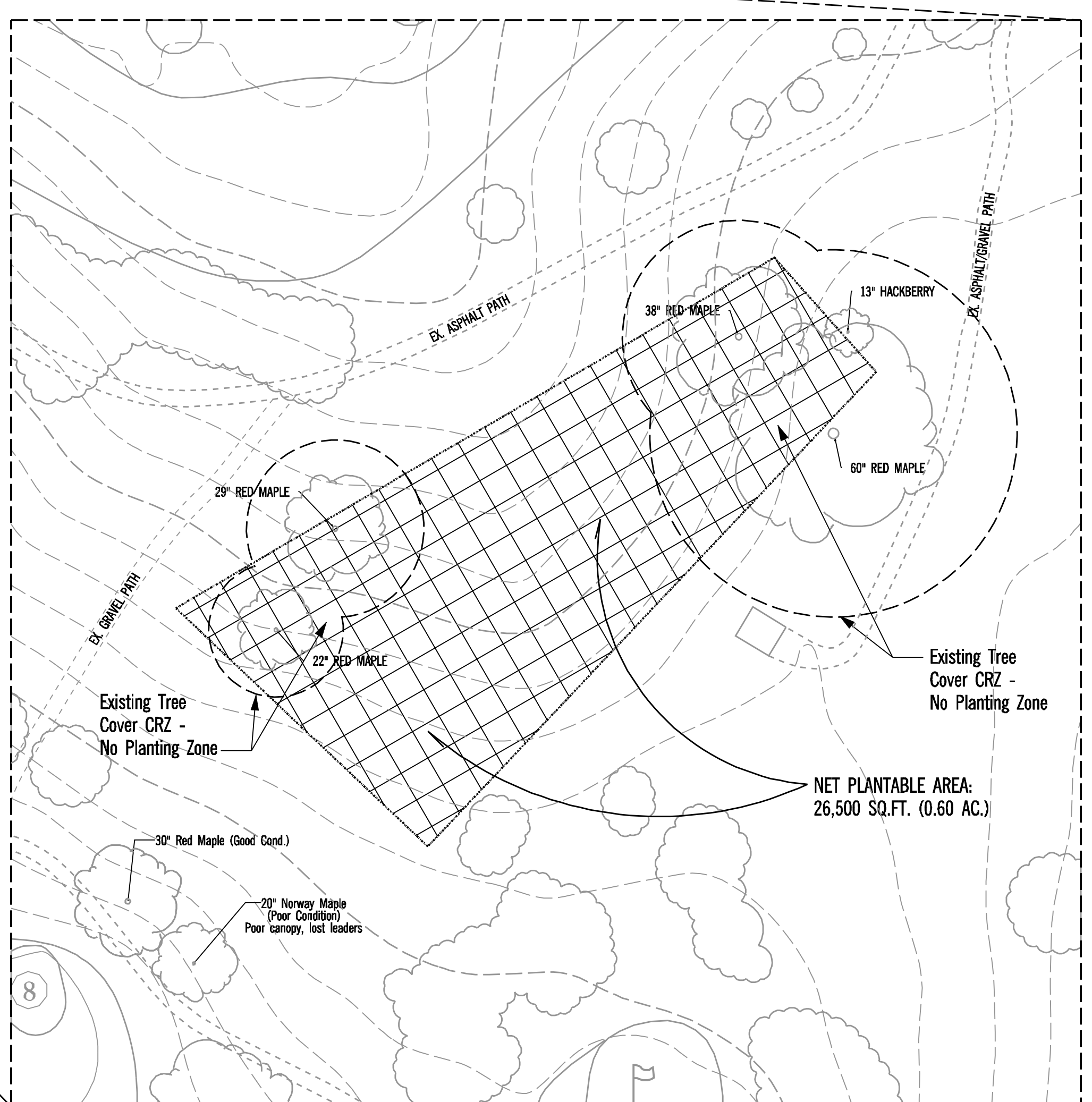

INSET DETAIL OF CONSERVATION EASEMENT C7 FROM ABOVE SHOWING EXISTING TREE COVER AND ADDITIONAL PLANTING REQUIREMENTS (Scale: 1"=50')

**PLANT LIST FOR EASEMENT AREA C7**

FORM	KEY #	BOTANICAL NAME	COMMON NAME	SIZE*	QUANTITY	REMARKS
TREE	1	Acer rubrum	Red Maple	1-1/2" - 2" cal. / 10' - 12' ht.	12	B & B or Container (Min. 15-gal.)
	2	Fraxinus americana	White Ash	1-1/2" - 2" cal. / 10' - 12' ht.	12	B & B or Container (Min. 15-gal.)
	3	Pinus strobus	White Pine	6" - 8" ht.	12	B & B or Container (Min. 15-gal.)
	4	Quercus alba	White Oak	1-1/2" - 2" cal. / 10' - 12' ht.	12	B & B or Container (Min. 15-gal.)
	5	Quercus rubra	Red Oak	1-1/2" - 2" cal. / 10' - 12' ht.	12	B & B or Container (Min. 15-gal.)
SHRUB	6	Hammamelis virginiana	Witch Hazel	18" - 24" ht. & spd.	7	Container grown
	7	Lindera benzoin	Spicebush	18" - 24" ht. & spd.	7	Container grown
	8	Viburnum dentatum	Arrowwood Viburnum	18" - 24" ht. & spd.	6	Container grown

**DEVELOPER'S CERTIFICATE**

The undersigned agrees to execute all the features of the Approved Final Forest Conservation Plan No. CBA-2472-C, including financial bonding, forest planting, maintenance, and all other applicable agreements.

Developer's Name: Norbeck Country Club, c/o Clubcorp NV XIX, LLC  
Printed Company Name: \_\_\_\_\_

Contact Person or Owner: Patrick Ellis  
Printed Name: \_\_\_\_\_

Address: 17200 Cashell Road, Rockville, Maryland 20853  
Phone and Email: (301) 774-7700 patrick.ellis@clubcorp.com

Signature: \_\_\_\_\_

Signature & Seal of Qualified Preparer  
Donald W. Rohrbaugh, II Md. R.L.A. #481  
Date: \_\_\_\_\_

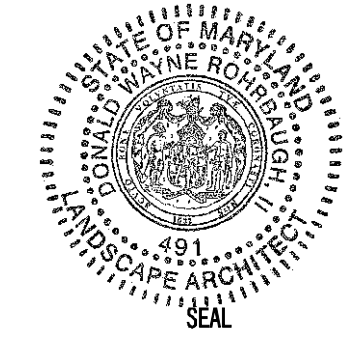

**SITE SOLUTIONS, INC.**  
19508 Amaranth Drive Suite A  
Germantown, Maryland 20874-1211  
(301) 540-7990 • FAX (301) 540-7991  
Planning • Landscape Architecture • Engineering • Surveying

OWNER: CLUBCORP NV XIX, LLC  
c/o NORBECK COUNTRY CLUB  
17200 CASHELL ROAD  
ROCKVILLE, MARYLAND 20853  
PHONE: (301) 774-7700  
ATTN: Patrick Ellis (patrick.ellis@clubcorp.com)

Amendment to Final Forest Conservation Plan #CBA-2724-C  
**NORBECK COUNTRY CLUB**  
PARCEL A, NORBECK COUNTRY CLUB, PLAT # 23986  
PARCEL P400, L. 1811, F. 251  
8th ELECTION DISTRICT  
MONTGOMERY COUNTY, MARYLAND

DWR	SCALE	1" = 200'
DESIGN	MUD	1 of 2
CHECKED	SHEET	
10/11/2018	PROJ. No.	2102
10/11/2018	PLOT DATE	E-

NO	REVISION	DATE

AMENDED FINAL FOREST CONSERVATION PLAN NORBECK COUNTRY CLUB SITE SOLUTIONS, INC.