



MONTGOMERY COUNTY PLANNING DEPARTMENT
THE MARYLAND-NATIONAL CAPITAL PARK AND PLANNING COMMISSION

MCPB
Item # 1B
3-12-2020

MEMORANDUM

DATE: February 28, 2020

TO: Montgomery County Planning Board

FROM: Stephen Smith, Coordinator
Jay Beatty, Senior Planner
D.A.R.C. Division
(301) 495-4522 & (301) 495-2178

SUBJECT: Informational Maps and Summary of Record Plats for the Planning Board
Agenda for March 12, 2020

SS
JEB

The following record plats are recommended for APPROVAL, subject to the appropriate conditions of approval of the preliminary plan and site plan, if applicable, and conditioned on conformance with all requirements of Chapter 50 of the Montgomery County Code. Attached are specific recommendations and copies of plan drawings for the record plat. The following plats are included:

220180990 Kingsview Knolls

220200170 Chestnut Ridge

Plat Name: Kingsview Knolls
Plat #: 220180990

Location: Located on the east side of Schaeffer Road, 200 feet south of Kingshill Road

Master Plan: Germantown Master Plan

Plat Details: R-200 zone; 1 lot

Owner: Tan Ser & Seamy Taing

The subdivision plat has been reviewed by M-NCPPC staff and determined to be in compliance with Administrative Subdivision Plan No. 620190050, as approved by the Planning Director on July 11, 2019, and that any minor modifications reflected on the plat do not alter the intent of the Director's approval of the aforesaid plan.

OWNER:
MR. TAN SER
(202) 486-1036
1 COACHMANS CT
GERMANTOWN, MD 20874

Thany Young & Tan Bar
1 Courtland Court
107-20874
302-486-1036

LOT P1 BLOCK 1
KINGVIEW KNOLLS
PLAT #8970
13908 SCHAEFFER RD
GERMANTOWN, MD 20874
MONTGOMERY COUNTY, MARYLAND

7-15-16
DATE
FOR APPROVAL - ADMIN. PERMISSION
7/29/16
DATE
FOR APPROVAL - ADMIN. PERMISSION
7/29/16
DATE

ADMINISTRATIVE SUBDIVISION PLAN
PLAN NO: 620180050
13908 SCHAEFFER RD.

Sheet No.
C-4
PLAN 1 OF 3
Project No. 16-01-001

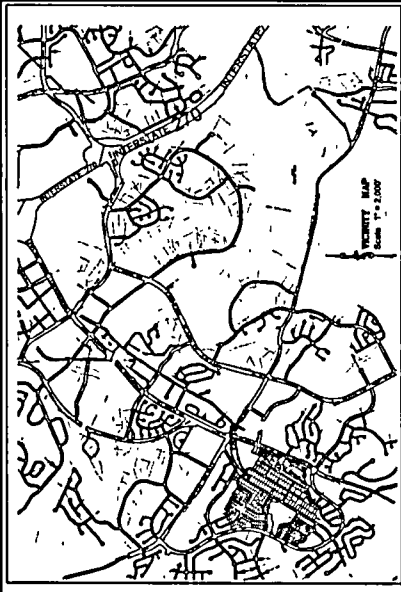

PROFESSIONAL CERTIFICATION
I, THANY YOUNG, a duly Licensed Professional Engineer, do hereby certify that the above described plans were prepared by me or under my direct supervision and that I am a duly Licensed Professional Engineer in the State of Maryland.
LICENSE NUMBER: 3827
EXPIRES: 06/30/2018
COMPLETION DATE: JUNE 21, 2016

PROFESSIONAL SEAL
THANY YOUNG
PRINTED NAME

GENERAL NOTES
1. The Engineer is not responsible for the design of any structure or equipment shown on these plans.
2. The Engineer is not responsible for the design of any structure or equipment shown on these plans.
3. The Engineer is not responsible for the design of any structure or equipment shown on these plans.
4. The Engineer is not responsible for the design of any structure or equipment shown on these plans.
5. The Engineer is not responsible for the design of any structure or equipment shown on these plans.

PERMITS FOR 1908 SCHAEFFER RD.

PERMIT TYPE	PERMIT NO.	DATE
CONSTRUCTION		
PLUMBING		
ELECTRICAL		
Mechanical		
Other		

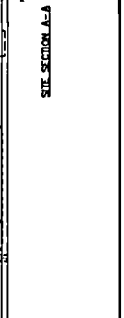
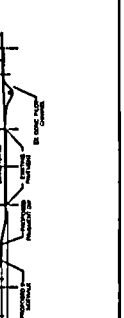
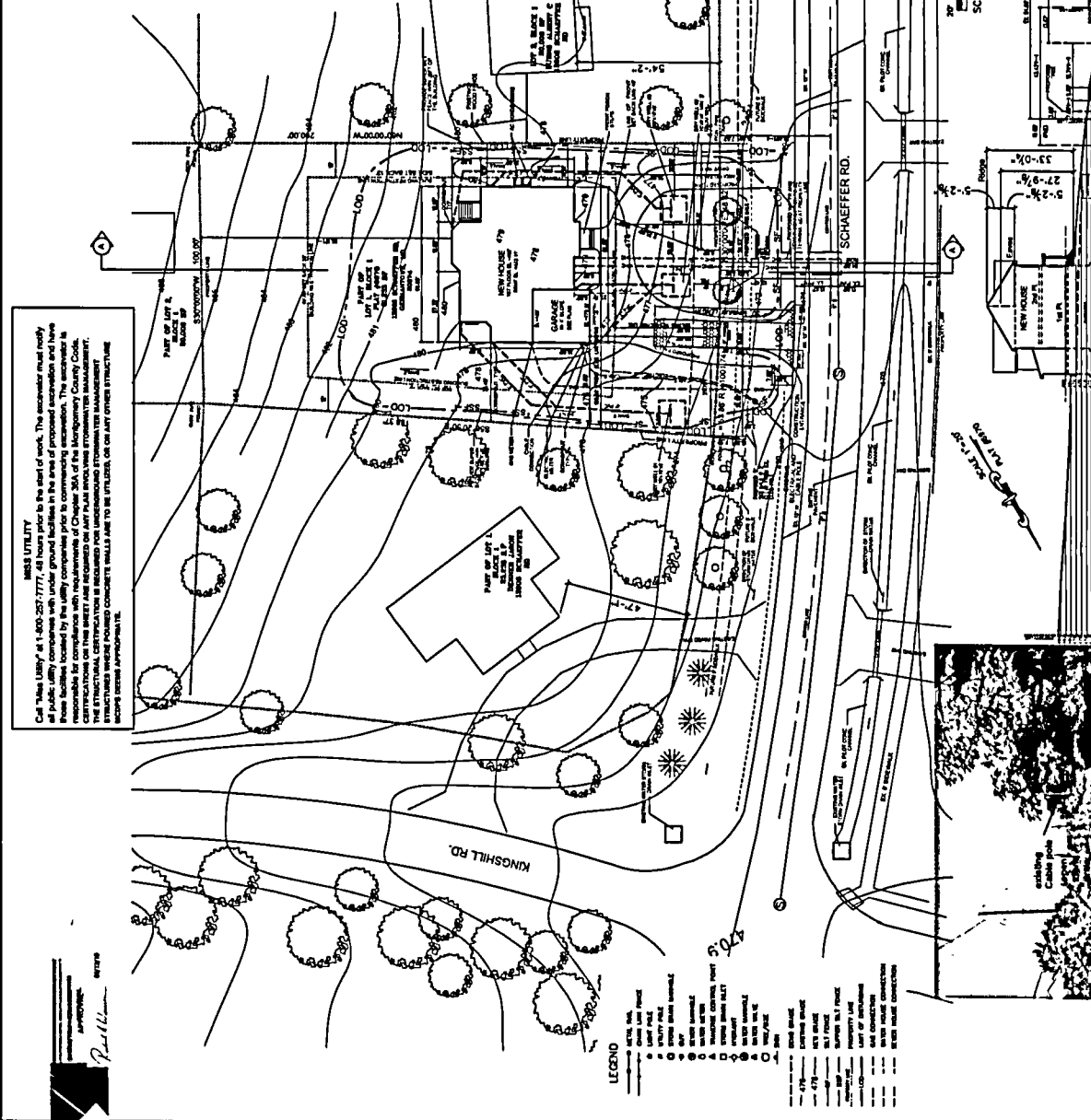

CALL TALK UTILITY AT 1-800-257-7777, 48 hours prior to the start of work. The excavator must notify all public utility companies with underground facilities in the area of proposed excavation and have those facilities located by the utility companies prior to commencing excavation. The excavator is responsible for compliance with requirements of Chapter 30A of the Montgomery County Code. THE STRUCTURAL CERTIFICATION IS REQUIRED FOR UNDERGROUND STRUCTURES AND STRUCTURES BEING FOUND CONCRETE WALLS ARE TO BE UTILIZED, OR ON ANY OTHER STRUCTURE WHICH IS UNDER CONSTRUCTION.