

Plat Name: Clarksburg Town Center
Plat #: 220200100

Location: Located on the east side of Clarksburg Square Road at the intersection of
Harness Point Way

Master Plan Clarksburg Master Plan

Plat Details: CRT zone; 31 lots and 1 parcel

Owner: Third Try, L.C.

The subdivision plat has been reviewed by M-NCPPC staff and determined to be in compliance with Preliminary Plan No. 11995042B (MCPB Resolution No. 15-92) and with Site Plan No. 82007022F (Certified Site Plan dated July 1, 2019), as approved by the Board, and that any minor modifications reflected on the plat do not alter the intent of the Board's previous approval of the aforesaid plans.

CLARKSBURG TOWN CENTER WEST SIDE

SITE PLAN AMENDMENT 82007022F

**LOTS 1-88 BLOCK "BB", LOTS 33-77 BLOCK "GG",
PARCELS A-L BLOCK "BB", PARCEL C BLOCK "EE",
& PARCELS G-J BLOCK "GG"**

**RETAIL CORE
PARCELS K-L BLOCK "GG" & PARCELS A-E BLOCK "CC"**

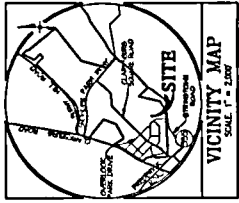

- GENERAL NOTES:**
- The proposed development shall be subject to the Clarksville Road Corridor Study, which shall be prepared by the City of Clarksville, Tennessee.
 - The proposed development shall be subject to the Clarksville Road Corridor Study, which shall be prepared by the City of Clarksville, Tennessee.
 - The proposed development shall be subject to the Clarksville Road Corridor Study, which shall be prepared by the City of Clarksville, Tennessee.
 - The proposed development shall be subject to the Clarksville Road Corridor Study, which shall be prepared by the City of Clarksville, Tennessee.
 - The proposed development shall be subject to the Clarksville Road Corridor Study, which shall be prepared by the City of Clarksville, Tennessee.

MISS UTILITY
Business Operations Center
801 North Main Street, Suite 200
Clarksville, TN 37043
CALL TOLL FREE
1-800-851-7777

DEVELOPER'S REPRESENTATIVE:
Name: GLW
Title: Project Engineer
Address: 100 West Main Street, Suite 200
City: Clarksville, TN 37043
Phone: (615) 442-2000
Fax: (615) 442-2001

APPLICANT'S REPRESENTATIVE:
Name: Clarksville
Title: Project Engineer
Address: 100 West Main Street, Suite 200
City: Clarksville, TN 37043
Phone: (615) 442-2000
Fax: (615) 442-2001

PROJECT TEAM

DEVELOPER:
CFC DEVELOPMENT
100 WEST MAIN STREET
SUITE 200
CLARKSBURG, TENNESSEE 37043

CIVIL ENGINEER:
GUYSON, LITTLE AND NEIDER, P.A.
100 WEST MAIN STREET
SUITE 200
CLARKSBURG, TENNESSEE 37043

UTILITY CONSULTANTS:
BOCHNER & ASSOCIATES
5665 GRANDS BRANCH WAY
ROCKVILLE, MARYLAND 20855

LANDSCAPE ARCHITECTS:
GUYSON, LITTLE AND NEIDER, P.A.
100 WEST MAIN STREET
SUITE 200
CLARKSBURG, MARYLAND 20855

LIST OF AMENDMENT ITEMS

- RESUBMITTING LOTS 33-88 BLOCK
- BLOCK 80 TO ALLOW FOR 376' OF LOTS
- WHOLEY SITE PLAN FOR LOTS 1-17
- BLOCK COLLECTING SYSTEM LAYOUT

SHEET SCHEDULE

SHEET NO.	TITLE
1-88-01	COVER SHEET
1-88-02	RESIDENTIAL BLOCK AA, DD & EE
1-88-03	RESIDENTIAL BLOCK BB & CC
1-88-04	RESIDENTIAL BLOCK EE & FF
1-88-05	RESIDENTIAL BLOCK GG & HH
1-88-06	RESIDENTIAL BLOCK II & JJ
1-88-07	RESIDENTIAL BLOCK LL & MM
1-88-08	RESIDENTIAL BLOCK NN & OO
1-88-09	RESIDENTIAL BLOCK PP & QQ
1-88-10	ALTERNATE BUILDING D, BLOCK CC

* SITE PLAN AMENDMENT NO. 82007022F

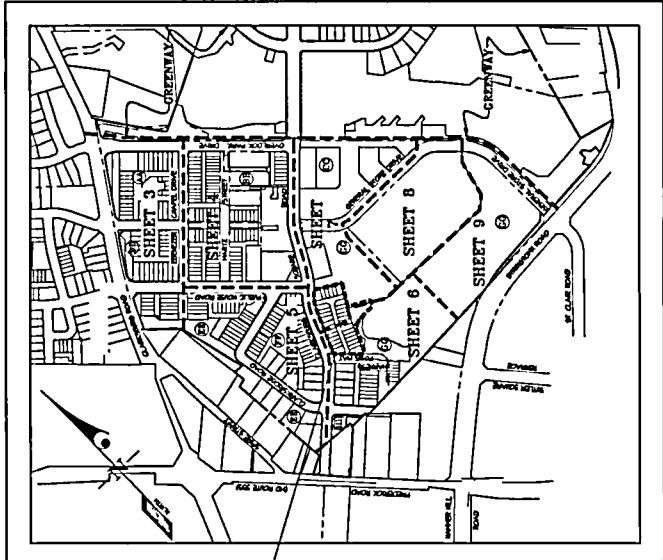

KEY MAP
SCALE: 1" = 250'

LEGEND

LIMITS OF SITE PLAN AMENDMENT

PROPOSED GARD & OTHER

EXISTING LIGHT

PROPOSED LIGHT

PROPOSED HILLOWS

PROPOSED SPOT GRADE

PROPOSED STORM DRAIN, SOAKER & WATER

STEP SLOPES

EXISTING TOPOGRAPHY

PROPOSED TOPOGRAPHY

EXISTING TREE LINE

PROPOSED TREE LINE

EXISTING STRUCTURES

PROPOSED STRUCTURE

MPDA

PROPOSED SIGNALS

FLOOD PLAN

STREAM VALLEY BUFFER

LIMIT OF DISTURBANCE

RELANDSCAPE BUFFER

PAVING LEGEND

GENERAL NOTES:

- FOR ALL DEVELOPMENT
- FOR ALL DEVELOPMENT
- FOR ALL DEVELOPMENT
- FOR ALL DEVELOPMENT
- FOR ALL DEVELOPMENT

GENERAL NOTES:

- FOR ALL DEVELOPMENT
- FOR ALL DEVELOPMENT
- FOR ALL DEVELOPMENT
- FOR ALL DEVELOPMENT
- FOR ALL DEVELOPMENT

GENERAL NOTES:

- FOR ALL DEVELOPMENT
- FOR ALL DEVELOPMENT
- FOR ALL DEVELOPMENT
- FOR ALL DEVELOPMENT
- FOR ALL DEVELOPMENT

REVISIONS

NO.	DATE	DESCRIPTION
1		
2		
3		
4		
5		
6		
7		
8		
9		
10		
11		
12		
13		
14		
15		
16		
17		
18		
19		
20		

GLW CONSULTANTS & ENGINEERS, P.A.
ONE CONVENT LANE, SUITE 200, CLARKSBURG, TENNESSEE 37043
PHONE: (615) 442-2000 FAX: (615) 442-2001
WWW.GLWCONSULTANTS.COM

COVER SHEET

CLARKSBURG TOWN CENTER

WEST SIDE - SITE PLAN

AS SHOWN RUC-2
DATE JUN 2019
SCALE 1" = 100'

PREPARED FOR:
CFC DEVELOPMENT
100 WEST MAIN STREET
SUITE 200
CLARKSBURG, TENNESSEE 37043

DATE: JUN 2019
SCALE: 1" = 100'

PROJECT NO.: 82007022F
SHEET NO.: 1-88-01 OF 10
TITLE: CLARKSBURG TOWN CENTER WEST SIDE - SITE PLAN

REVISIONS

NO.	DATE	DESCRIPTION
1		
2		
3		
4		
5		
6		
7		
8		
9		
10		
11		
12		
13		
14		
15		
16		
17		
18		
19		
20		

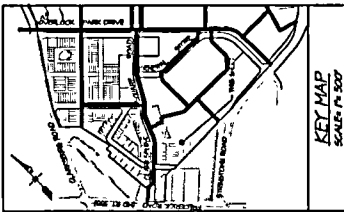

MISS UTILITY
 Before You Dig
 Call
 MISS UTILITY
 1-800-557-5777

CALL TOLL FREE
 1-800-557-5777

- LEGEND**
- Water Main
 - Sanitary Sewer
 - Storm Sewer
 - Electric
 - Gas
 - Telephone
 - Optical Fibre
 - Other
- PAVING LEGEND**
- Asphalt
 - Concrete
 - Gravel
 - Grass
 - Other

THE INFORMATION CONTAINED HEREIN IS FOR THE EXCLUSIVE USE OF THE CLIENT AND IS NOT TO BE REPRODUCED OR TRANSMITTED IN ANY FORM OR BY ANY MEANS, ELECTRONIC OR MECHANICAL, INCLUDING PHOTOCOPYING, RECORDING, OR BY ANY INFORMATION STORAGE AND RETRIEVAL SYSTEM, WITHOUT THE WRITTEN PERMISSION OF THE ENGINEER.

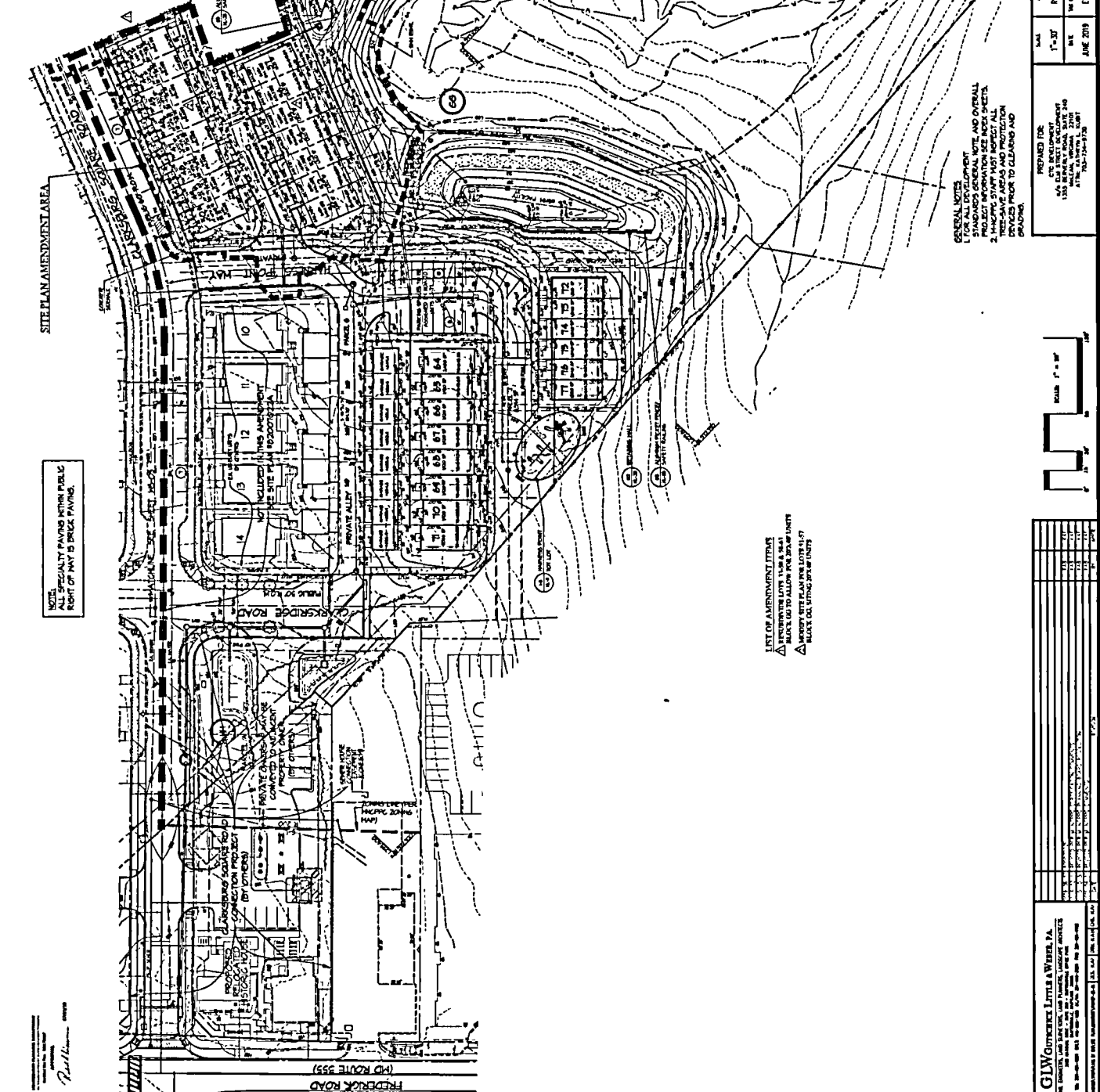

GILWONGERK LITTLE & WHEELER, P.A.
 CIVIL ENGINEERS, LAND SURVEYORS, LANDSCAPE ARCHITECTS
 1000 W. BROADWAY, SUITE 2000, CHARLOTTE, NC 28202
 TEL: 704.375.1234 FAX: 704.375.1235

RESIDENTIAL BLOCK & GARAGE III
 CLARKEBURG TOWNSHIP CENTER
 WEST BRIDGE SITE PLAN

PREPARED FOR:
 GILWONGERK LITTLE & WHEELER, P.A.
 1000 W. BROADWAY, SUITE 2000
 CHARLOTTE, NC 28202
 TEL: 704.375.1234 FAX: 704.375.1235

DATE: JUNE 2019
 SCALE: 1" = 30'

SHEET NO. 11104
 OF 11104

PROJECT NO. 19-02

DRAWN BY: J. WHEELER
 CHECKED BY: J. WHEELER
 DATE: JUNE 2019

PROJECT LOCATION: RESIDENTIAL BLOCK & GARAGE III
 CLARKEBURG TOWNSHIP CENTER
 WEST BRIDGE SITE PLAN

PROJECT NO. 19-02

SHEET NO. 11104

DATE: JUNE 2019

DRAWN BY: J. WHEELER

CHECKED BY: J. WHEELER

DATE: JUNE 2019

PROJECT LOCATION: RESIDENTIAL BLOCK & GARAGE III
 CLARKEBURG TOWNSHIP CENTER
 WEST BRIDGE SITE PLAN

PROJECT NO. 19-02

SHEET NO. 11104

DATE: JUNE 2019

DRAWN BY: J. WHEELER

CHECKED BY: J. WHEELER

DATE: JUNE 2019

- LIST OF AMENDMENT ITEMS**
- △ EXISTING UTILITY UNDER BRICK PAVING TO BE REMOVED
 - △ EXISTING UTILITY UNDER BRICK PAVING TO BE RELOCATED
 - △ BRICK PAVING TO BE REPLACED WITH ASPHALT
 - △ BRICK PAVING TO BE REPLACED WITH GRASS

GENERAL NOTES:
 1. FOR ALL DEVELOPMENT, SEE THE GENERAL NOTES AND OVERALL PROJECT INFORMATION SHEET FOR ALL INFORMATION.
 2. THE ENGINEER'S OFFICE SHALL BE RESPONSIBLE FOR OBTAINING ALL NECESSARY PERMITS AND APPROVALS FROM THE LOCAL AND STATE AGENCIES.
 3. THE ENGINEER'S OFFICE SHALL BE RESPONSIBLE FOR OBTAINING ALL NECESSARY PERMITS AND APPROVALS FROM THE LOCAL AND STATE AGENCIES.
 4. THE ENGINEER'S OFFICE SHALL BE RESPONSIBLE FOR OBTAINING ALL NECESSARY PERMITS AND APPROVALS FROM THE LOCAL AND STATE AGENCIES.

SCALE: 1" = 30'

SHEET NO. 11104

DATE: JUNE 2019

DRAWN BY: J. WHEELER

CHECKED BY: J. WHEELER

DATE: JUNE 2019

PROJECT LOCATION: RESIDENTIAL BLOCK & GARAGE III
 CLARKEBURG TOWNSHIP CENTER
 WEST BRIDGE SITE PLAN

PROJECT NO. 19-02

SHEET NO. 11104

DATE: JUNE 2019

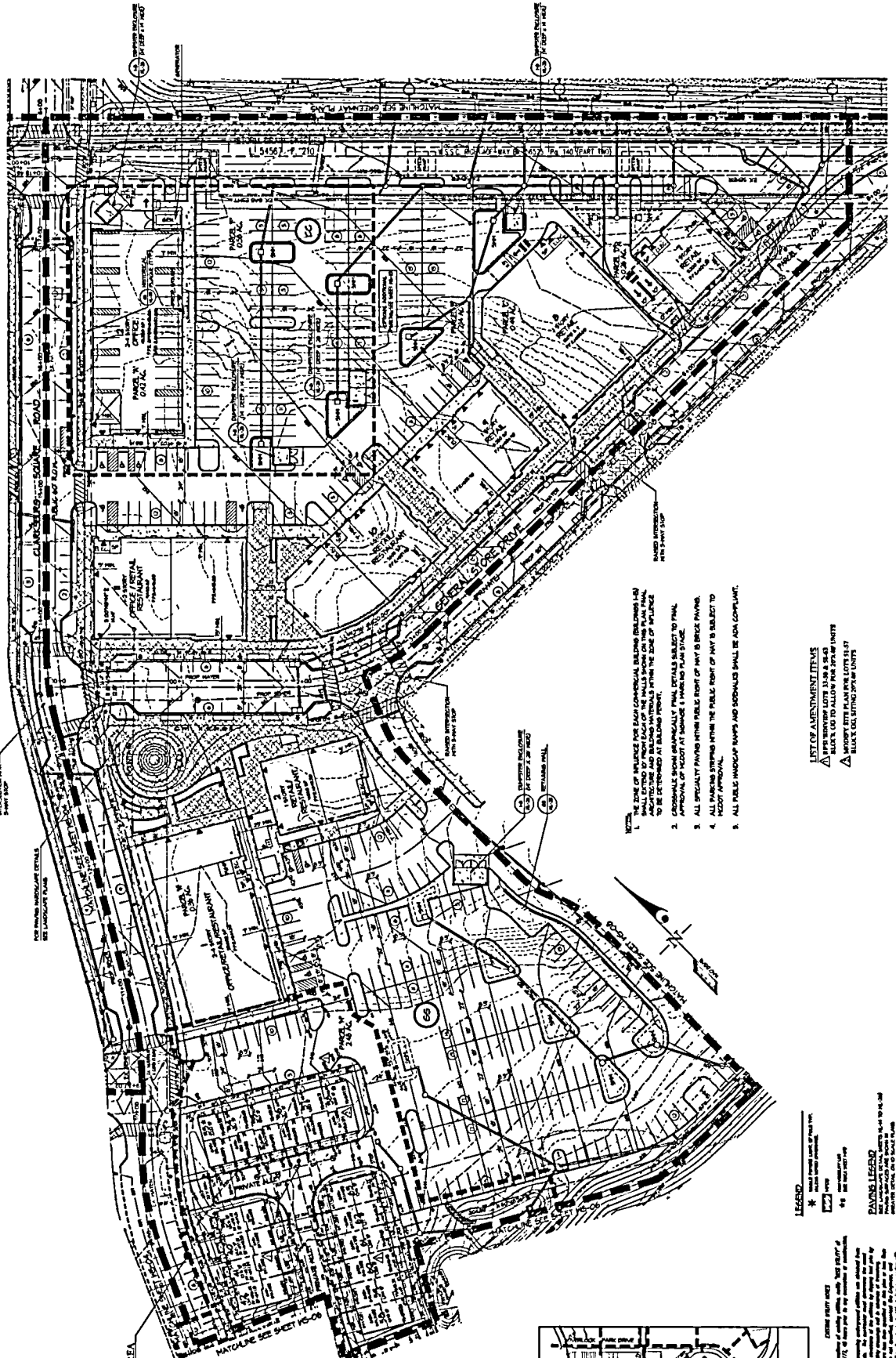

DEVELOPER CERTIFICATE

Developer's Name: CLARKSBURG TOWN CENTER
 Project Name: MIXED USE BLOCK CC & GO
 Date: 06/20/2019

City/County: CLARKSBURG, WEST VIRGINIA

PERMITTED FOR:
 CLARKSBURG TOWN CENTER
 MIXED USE BLOCK CC & GO

Scale: 1" = 30'
 Date: JUNE 2019

Drawn: EM-42
 Checked: EM-42

REVISIONS:

NO.	DATE	DESCRIPTION
1	06/20/19	ISSUED FOR PERMITTING
2	06/20/19	ISSUED FOR PERMITTING
3	06/20/19	ISSUED FOR PERMITTING

LEGEND

- ★ EXISTING PUBLIC UTILITY
- EXISTING PRIVATE UTILITY
- 6" WATER MAIN
- 12" WATER MAIN
- 18" WATER MAIN
- 24" WATER MAIN
- 30" WATER MAIN
- 36" WATER MAIN
- 42" WATER MAIN
- 48" WATER MAIN
- 54" WATER MAIN
- 60" WATER MAIN
- 66" WATER MAIN
- 72" WATER MAIN
- 78" WATER MAIN
- 84" WATER MAIN
- 90" WATER MAIN
- 96" WATER MAIN
- 102" WATER MAIN
- 108" WATER MAIN
- 114" WATER MAIN
- 120" WATER MAIN
- 126" WATER MAIN
- 132" WATER MAIN
- 138" WATER MAIN
- 144" WATER MAIN
- 150" WATER MAIN
- 156" WATER MAIN
- 162" WATER MAIN
- 168" WATER MAIN
- 174" WATER MAIN
- 180" WATER MAIN
- 186" WATER MAIN
- 192" WATER MAIN
- 198" WATER MAIN
- 204" WATER MAIN
- 210" WATER MAIN
- 216" WATER MAIN
- 222" WATER MAIN
- 228" WATER MAIN
- 234" WATER MAIN
- 240" WATER MAIN
- 246" WATER MAIN
- 252" WATER MAIN
- 258" WATER MAIN
- 264" WATER MAIN
- 270" WATER MAIN
- 276" WATER MAIN
- 282" WATER MAIN
- 288" WATER MAIN
- 294" WATER MAIN
- 300" WATER MAIN

PAVING LEGEND

- ASPHALT
- CONCRETE
- GRAVEL
- GRAVEL WITH SAND
- GRAVEL WITH STONE
- GRAVEL WITH SAND AND STONE
- GRAVEL WITH SAND AND STONE WITH CURB
- GRAVEL WITH SAND AND STONE WITH CURB AND SIDEWALK
- GRAVEL WITH SAND AND STONE WITH CURB AND SIDEWALK AND BIKEWAY
- GRAVEL WITH SAND AND STONE WITH CURB AND SIDEWALK AND BIKEWAY AND WALKWAY
- GRAVEL WITH SAND AND STONE WITH CURB AND SIDEWALK AND BIKEWAY AND WALKWAY AND DRIVEWAY
- GRAVEL WITH SAND AND STONE WITH CURB AND SIDEWALK AND BIKEWAY AND WALKWAY AND DRIVEWAY AND BIKEWAY
- GRAVEL WITH SAND AND STONE WITH CURB AND SIDEWALK AND BIKEWAY AND WALKWAY AND DRIVEWAY AND BIKEWAY AND WALKWAY
- GRAVEL WITH SAND AND STONE WITH CURB AND SIDEWALK AND BIKEWAY AND WALKWAY AND DRIVEWAY AND BIKEWAY AND WALKWAY AND BIKEWAY
- GRAVEL WITH SAND AND STONE WITH CURB AND SIDEWALK AND BIKEWAY AND WALKWAY AND DRIVEWAY AND BIKEWAY AND WALKWAY AND BIKEWAY AND WALKWAY
- GRAVEL WITH SAND AND STONE WITH CURB AND SIDEWALK AND BIKEWAY AND WALKWAY AND DRIVEWAY AND BIKEWAY AND WALKWAY AND BIKEWAY AND WALKWAY AND BIKEWAY
- GRAVEL WITH SAND AND STONE WITH CURB AND SIDEWALK AND BIKEWAY AND WALKWAY AND DRIVEWAY AND BIKEWAY AND WALKWAY AND BIKEWAY AND WALKWAY AND BIKEWAY AND WALKWAY
- GRAVEL WITH SAND AND STONE WITH CURB AND SIDEWALK AND BIKEWAY AND WALKWAY AND DRIVEWAY AND BIKEWAY AND WALKWAY AND BIKEWAY AND WALKWAY AND BIKEWAY AND WALKWAY AND BIKEWAY
- GRAVEL WITH SAND AND STONE WITH CURB AND SIDEWALK AND BIKEWAY AND WALKWAY AND DRIVEWAY AND BIKEWAY AND WALKWAY AND BIKEWAY AND WALKWAY AND BIKEWAY AND WALKWAY AND BIKEWAY AND WALKWAY
- GRAVEL WITH SAND AND STONE WITH CURB AND SIDEWALK AND BIKEWAY AND WALKWAY AND DRIVEWAY AND BIKEWAY AND WALKWAY AND BIKEWAY AND WALKWAY AND BIKEWAY AND WALKWAY AND BIKEWAY AND WALKWAY AND BIKEWAY
- GRAVEL WITH SAND AND STONE WITH CURB AND SIDEWALK AND BIKEWAY AND WALKWAY AND DRIVEWAY AND BIKEWAY AND WALKWAY AND BIKEWAY AND WALKWAY AND BIKEWAY AND WALKWAY AND BIKEWAY AND WALKWAY AND BIKEWAY AND WALKWAY
- GRAVEL WITH SAND AND STONE WITH CURB AND SIDEWALK AND BIKEWAY AND WALKWAY AND DRIVEWAY AND BIKEWAY AND WALKWAY AND BIKEWAY AND WALKWAY AND BIKEWAY AND WALKWAY AND BIKEWAY AND WALKWAY AND BIKEWAY AND WALKWAY AND BIKEWAY
- GRAVEL WITH SAND AND STONE WITH CURB AND SIDEWALK AND BIKEWAY AND WALKWAY AND DRIVEWAY AND BIKEWAY AND WALKWAY AND BIKEWAY AND WALKWAY AND BIKEWAY AND WALKWAY AND BIKEWAY AND WALKWAY AND BIKEWAY AND WALKWAY AND BIKEWAY

KEY MAP
 SCALE: 1" = 200'

For a complete list of streets, see the CITY OF CLARKSBURG, WEST VIRGINIA, OFFICIAL STREET DIRECTORY.

1. The site is located in the center of the city.

2. The site is bounded by the following streets:

- North: CLARKSBURG AVENUE
- South: CLARKSBURG AVENUE
- East: CLARKSBURG AVENUE
- West: CLARKSBURG AVENUE

GLW O'NEILL LITTLE & WEBER, P.A.
 CIVIL ENGINEERS, LAND SURVEYORS, AND PLANNERS, INDEPENDENT REGISTERED PROFESSIONALS
 1000 CLARKSBURG AVENUE, SUITE 1000, CLARKSBURG, WEST VIRGINIA 26301-3200
 PHONE: 304-791-1111 FAX: 304-791-1112
 WWW.GLOWEB.COM

CLARKSBURG TOWN CENTER
 MIXED USE BLOCK CC & GO
 SCALE: 1" = 30'
 DATE: JUNE 2019
 DRAWN: EM-42
 CHECKED: EM-42