

SPECIMEN TREE TABLE						
Number	Species	Common Name	Size, DBH (in)	Condition	Notes	
SP-1	<i>Liriodendron tulipifera</i>	Tulip Poplar	24.0	Fair	Heavy vines	
SP-2	<i>Acer rubrum</i>	Red Maple	42.0	Fair	Heavy vines	
SP-3	<i>Liriodendron tulipifera</i>	Tulip Poplar	46.0	Good		
SP-4	<i>Quercus rubra</i>	Northern Red Oak	32.0	Fair	Vines	
SP-5	<i>Quercus palustris</i>	Pin Oak	36.0	Fair	Fallen tree leaning into it	
SP-6	<i>Quercus rubra</i>	Northern Red Oak	24.0	Good		
SP-7	<i>Liriodendron tulipifera</i>	Tulip Poplar	28.0	Good		
SP-8	<i>Liriodendron tulipifera</i>	Tulip Poplar	28.0	Good		
SP-9	<i>Liriodendron tulipifera</i>	Tulip Poplar	28.0	Good		
SP-10	<i>Liriodendron tulipifera</i>	Tulip Poplar	28.0	Good		
SP-11	<i>Liriodendron tulipifera</i>	Tulip Poplar	28.0	Good		
SP-12	<i>Quercus alba</i>	White Oak	28.0	Fair	Small canopy, dead branches	
SP-13	<i>Quercus alba</i>	White Oak	26.0	Good		
SP-14	<i>Liriodendron tulipifera</i>	Tulip Poplar	58.0	Good	A few broken branches	
SP-15	<i>Quercus rubra</i>	Northern Red Oak	30.0	Good		
SP-16	<i>Quercus rubra</i>	Northern Red Oak	40.0	Good		
SP-17	<i>Liriodendron tulipifera</i>	Tulip Poplar	24.0	Poor	Cavity, severe trunk damage, central leader dead	
SP-18	<i>Liriodendron tulipifera</i>	Tulip Poplar	24.0	Good		
SP-19	<i>Liriodendron tulipifera</i>	Tulip Poplar	27.0	Good		
SP-20	<i>Liriodendron tulipifera</i>	Tulip Poplar	24.0	Good		
SP-21	<i>Liriodendron tulipifera</i>	Tulip Poplar	41.0	Good	Minimal vines	
SP-22	<i>Quercus palustris</i>	Pin Oak	25.0	Fair	Missing branches, minimal canopy	
SP-23	<i>Liriodendron tulipifera</i>	Tulip Poplar	24.0	Good		
SP-24	<i>Liriodendron tulipifera</i>	Tulip Poplar	29.0	Good		
SP-25	<i>Paulownia tomentosa</i>	Royal Paulownia	29.0	Fair	Heavy vines	
SP-26	<i>Paulownia tomentosa</i>	Royal Paulownia	33.0	Fair	Heavy vines	
SP-27	<i>Acer rubrum</i>	Red Maple	30.0	Good	Double trunk	
SP-28	<i>Acer rubrum</i>	Red Maple	29.0	Fair	Dead branches	
SP-29	<i>Acer rubrum</i>	Red Maple	26.0	Good	Double trunk	
SP-30	<i>Quercus alba</i>	White Oak	29.0	Good		
SP-31	<i>Celtis occidentalis</i>	Hackberry	31.0	Good		
SP-32	<i>Acer rubrum</i>	Red Maple	24.0	Good		
SP-33	<i>Quercus rubra</i>	Northern Red Oak	63.0	Good	Double trunk	
SP-34	<i>Pinus strobus</i>	Eastern White Pine	25.0	Poor	Missing canopy, cavity, broken branches	
SP-35	<i>Pinus strobus</i>	Eastern White Pine	25.0	Good		
SP-36	<i>Pinus strobus</i>	Eastern White Pine	25.0	Good		
SP-37	<i>Pinus strobus</i>	Eastern White Pine	31.0	Good		
SP-38	<i>Pinus strobus</i>	Eastern White Pine	27.0	Good		
SP-39	<i>Pinus strobus</i>	Eastern White Pine	24.0	Good		
SP-40	<i>Morus alba</i>	White Mulberry	24.0	Poor	Dead branches, vines	
SP-41	<i>Acer rubrum</i>	Red Maple	24.0	Good	Double trunk	
SP-42	<i>Ulmus rubra</i>	Slippery Elm	35.0	Good	Double trunk	
SP-43	<i>Acer saccharum</i>	Sugar Maple	31.0	Good	A few broken branches	
SP-44	<i>Liriodendron tulipifera</i>	Tulip Poplar	30.0	Good		
SP-45	<i>Liriodendron tulipifera</i>	Tulip Poplar	29.0	Good		
SP-46	<i>Platanus occidentalis</i>	Sycamore	40.0	Fair	Vines	
SP-47	<i>Platanus occidentalis</i>	Sycamore	49.0	Good		
SP-48	<i>Platanus occidentalis</i>	Sycamore	27.0	Good		
SP-49	<i>Liriodendron tulipifera</i>	Tulip Poplar	48.0	Fair	Vines	
SP-50	<i>Quercus alba</i>	White Oak	46.0	Fair	Heavy vines	
SP-51	<i>Liriodendron tulipifera</i>	Tulip Poplar	37.0	Fair	Vines	
SP-52	<i>Liriodendron tulipifera</i>	Tulip Poplar	40.0	Poor	Vines, 3/4 dead	
SP-53	<i>Acer rubrum</i>	Red Maple	28.0	Fair	Heavy vines	
SP-54	<i>Quercus palustris</i>	Pin Oak	32.0	Good		
SP-55	<i>Liriodendron tulipifera</i>	Tulip Poplar	60.0	Fair	Vines, limb broken off, triple trunk	
SP-56	<i>Liriodendron tulipifera</i>	Tulip Poplar	28.0	Fair	Heavy vines	
SP-57	<i>Liriodendron tulipifera</i>	Tulip Poplar	30.0	Fair	Heavy vines	
SP-58	<i>Liriodendron tulipifera</i>	Tulip Poplar	34.0	Fair	Heavy vines	
SP-60	<i>Liriodendron tulipifera</i>	Tulip Poplar	47.0	Good		
SP-61	<i>Quercus rubra</i>	Northern Red Oak	53.0	Fair	Vines	
SP-62	<i>Pinus strobus</i>	Eastern White Pine	24.0	Good		

SOILS TABLE				
Soil Symbol	Soil Unit Name	Percent Slope	K _s value	Hydric (Y/N)
1B	Gailla silt loam	3-8	0.43	No
1C	Gailla silt loam	8-15	0.43	No
2B	Glenns silt loam	3-8	0.37	No
16D	Brinklow-Blocktown chamery silt loam	15-25	0.37	No
24C	Montalto silt loam, very stony	8-15	0.43	No

NOTE: 1B, 1C, 2B, AND 16D SOILS ARE HIGHLY ERODIBLE SOILS

RESOURCE DATA	
24.41 AC	TRACT AREA
3.38 AC	EXISTING FOREST
0.44 AC	EXISTING WETLANDS
0.08 AC	FOREST IN EXISTING WETLANDS
0.62 AC	EXISTING FLOODPLAIN
0.44 AC	FOREST IN EXISTING FLOODPLAIN
23.43 AC	EXISTING STREAM BUFFER
3.38 AC	FOREST IN EXISTING STREAM BUFFER
1,130 LF	STREAM BUFFER LENGTH
1,150 FT	AVERAGE STREAM BUFFER WIDTH
*Based on Study area	

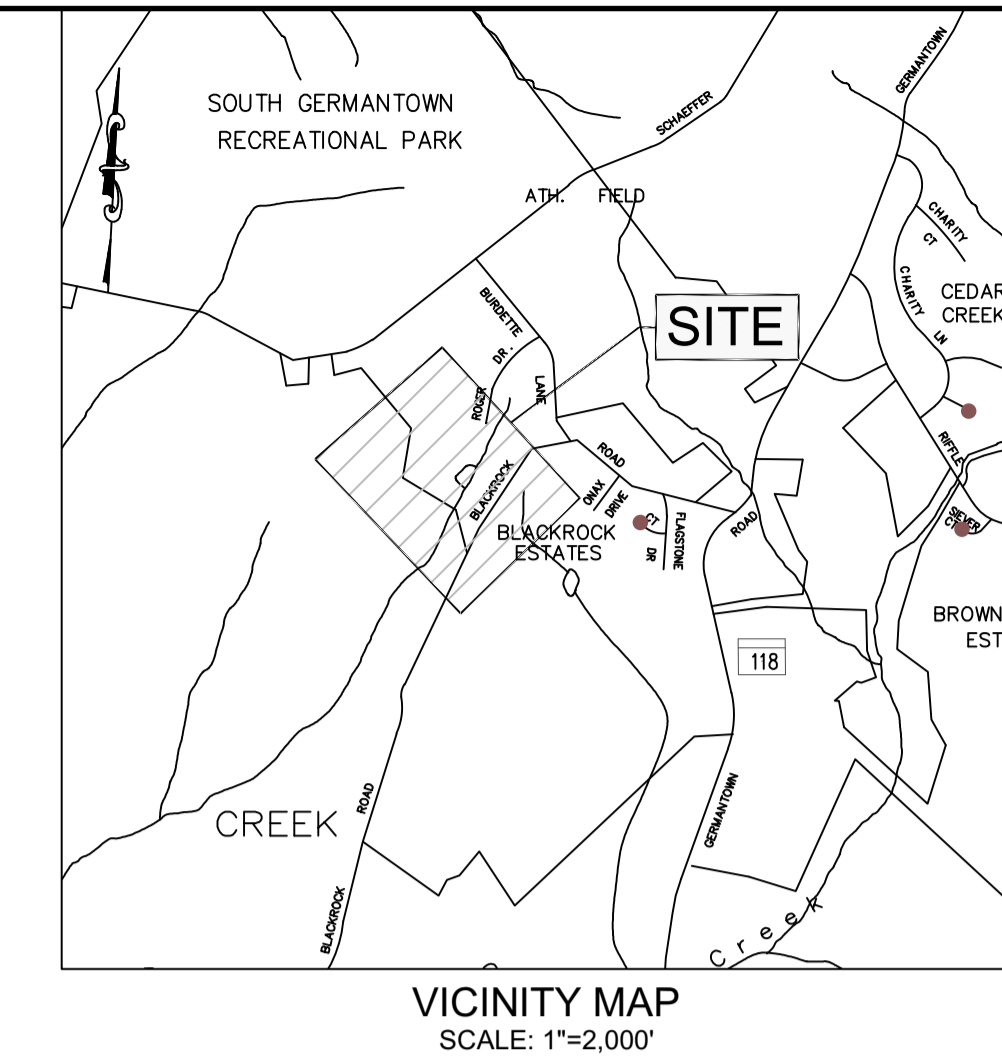
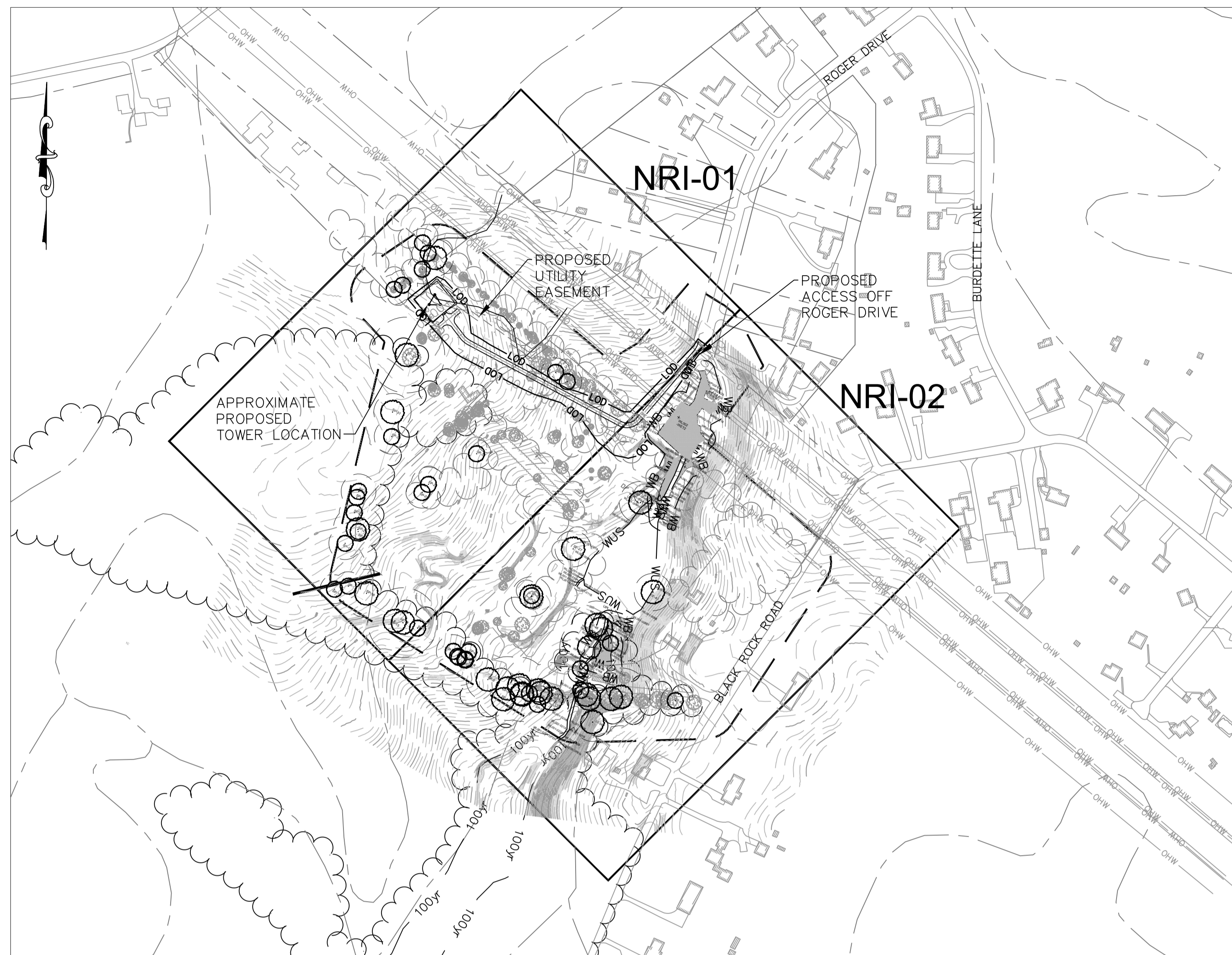

LEGEND

- 400' 2' CONTOUR (SOURCE: COUNTY GIS)
- UTILITY LINE (SOURCE: COUNTY UTILITIES)
- STREAM LINE (SOURCE: FIELD DELINEATED)
- NON-TIDAL WETLAND BOUNDARY (FIELD DELINEATED)
- 25' WETLAND BUFFER
- STREAM BUFFER
- 100 YR FEMA FLOODPLAIN
- VEGETATION LINE
- FOREST LINE
- PROPERTY LINE
- STUDY AREA
- SOILS BOUNDARY
- FOREST STAND BREAK
- SPECIMEN TREE WITH CRITICAL ROOT ZONE
- BUILDING
- STEEP SLOPES 15-25%
- STEEP SLOPES 25% AND GREATER
- PROPOSED EASEMENT
- FENCE
- PROPOSED LIMIT OF DISTURBANCE
- PROPOSED CONTOUR

GENERAL NOTES:

- THIS SITE IS ZONED AR (AGRICULTURAL RESERVE).
- THE SOURCE OF THE PROPERTY BOUNDARIES ON THIS PLAN ARE FROM TAX MAPS AND DEEDS AND MONTGOMERY COUNTY GIS OPEN DATA PORTAL.
- THE TOPOGRAPHY SHOWN ON THIS PLAN IS FROM POTOMAC VALLEY SURVEYS COMPLETED ON JUNE 22, 2018 AND MONTGOMERY COUNTY GIS OPEN DATA PORTAL, 2017.
- THE SOURCE OF THE SOILS INFORMATION ON THIS PLAN IS FROM THE USDA NRCS WEB SOIL SURVEY (WSS) IN A CUSTOM SOIL RESOURCE REPORT FOR AN AREA OF INTEREST (AOI) ESTABLISHED FOR THE SUBJECT SITE ONLY AND GENERATED ON OCTOBER 4, 2018.
- A PORTION OF THE SUBJECT PROPERTY IS WITHIN THE 100-YEAR FEMA FLOODPLAIN. THE SOURCE OF THE FLOODPLAIN LINE SHOWN IS FEMA.
- THE WETLAND AND STREAM INFORMATION ON THIS PLAN IS FROM A WETLAND DELINEATION COMPLETED BY AMANDA WAGONER AND SHARON DORSEY OF KCI TECHNOLOGIES, INC. ON OCTOBER 19, 2018 AND ON JANUARY 13, 2020 BY AMANDA WAGONER AND KATHERINE MYERS. TWO WETLANDS AND ONE PERENNIAL STREAM WERE IDENTIFIED. ALL LOCATIONS OF RESOURCES ARE FIELD SURVEYED BY GLOBAL POSITIONING SYSTEM (GPS), SUBMETER ACCURACY.
- THIS SITE DOES NOT CONTAIN WETLANDS OF SPECIAL STATE CONCERN AS DEFINED IN COMAR 26.23.06.01.
- THIS SITE IS NOT WITHIN A SPECIAL PROTECTION AREA.
- THIS PROJECT IS WITHIN THE SENECA CREEK WATERSHED (02140208).
- THE NEAREST WATERWAY IS AN UNNAMED TRIBUTARY TO GREAT SENECA CREEK AND HAS A USE CLASS OF 1-P.
- THIS SITE IS NOT WITHIN A SENSITIVE SPECIES PROTECTION REVIEW AREA BASED ON A REVIEW OF THE SSPRA GIS LAYER PREPARED BY THE HERITAGE AND WILDLIFE SERVICE, MARYLAND DEPARTMENT OF NATURAL RESOURCES.
- THE SITE DOES NOT INCLUDE FOREST INTERIOR DWELLING SPECIES HABITAT.
- THE SUBJECT PROPERTY IS NOT A HISTORIC PROPERTY OR PLACE.
- NO RARE, THREATENED, OR ENDANGERED SPECIES WERE IDENTIFIED DURING THE FIELD INVESTIGATIONS.
- * DENOTES THAT RESOURCE EXTENDS BEYOND SUBJECT PROPERTY.
- NO FOREST CLEARING IS CURRENTLY PROPOSED. EXISTING ROADWAYS WILL BE USED FOR ACCESS TO THE PROPOSED TOWER LOCATION.
- THE STREAM BUFFER SHOWN IS EXPANDED TO INCLUDE THE HIGHLY ERODIBLE SOILS (1B, 1C, 2B, AND 16D) THAT COVER THE MAJORITY OF THE STUDY AREA.

FOREST NOTES:

- FORESTS WERE DELINEATED BY AMANDA WAGONER AND SHARON DORSEY OF KCI TECHNOLOGIES, INC. ON OCTOBER 19, 2018.
- THERE ARE 61 SPECIMEN, CHAMPION AND/OR HISTORIC TREES LOCATED ON THE PROPERTY. SIZE WAS ESTIMATED FOR THOSE TREES THAT WERE INACCESSIBLE. TREES LOCATED ON THE PROPERTY WERE MEASURED USING A DBH (DIAMETER AT BREAST HEIGHT) TAPE. TREE LOCATIONS WERE FIELD SURVEYED BY GPS. CURRENTLY NO SPECIMEN TREES ARE PROPOSED FOR REMOVAL.
- TWO FOREST STANDS (STANDS A AND B) WERE IDENTIFIED WITHIN THE PROJECT STUDY AREA. BOTH STANDS WERE IDENTIFIED AS A PRIORITY RETENTION AREA DUE TO SPECIMEN TREES. CURRENTLY NO FOREST CLEARING IS PROPOSED.
- STAND A IS A MID OAK-POPLAR FOREST STAND DOMINATED BY *QUERCUS ALBA* AND *LIRIODENDRON TULIPIFERA* IN THE 12-20, 20-30 AND 30+\"

STAND B IS A EARLY-MID OAK-HICKORY FOREST STAND DOMINATED BY *QUERCUS ALBA*, *LIRIODENDRON TULIPIFERA*, *JUGLANS NIGRA*, AND *CARYA* SPECIES IN THE 12-20, 20-30 AND 30+\"

Property Name: Black Rock Rd	
Location: Montgomery County, MD	
Prepared By: AW, SSLD	Date: 10/19/18
Stand Variable	Stand A
1. Dominant/Codominant species	Dominant: <i>Quercus alba</i> , <i>Quercus rubra</i> , <i>Liriodendron tulipifera</i> , <i>Acer rubrum</i> Codominant: <i>Nyssa sylvatica</i> , <i>Carya sp.</i>
2. Successional stage	Mid
3. Basal area in square feet per acre	65
4. Size class of dominant species	12-19.9\", 20-29.9\", 30+\"
5. Percent of canopy closure	77.5%
6. Number of tree species per acre	5
7. Common understory species per acre	<i>Acer rubrum</i> , <i>Celastrus orbiculatus</i> , <i>Ilex opaca</i> , <i>Lonicera japonica</i> , <i>Smilax rotundifolia</i> , <i>Toxicodendron radicans</i> , <i>Hedera helix</i>
8. Percent of understory cover 3' to 10' tall	40%
9. Number of woody plants species 3' to 20' tall	4
10. Common herbaceous species 0' to 3' tall	<i>Hedera helix</i> , <i>Lonicera japonica</i> , <i>Toxicodendron radicans</i> , <i>Viola sororia</i> , <i>Physalacca decandra</i> , <i>Alicostegium vimineum</i>
11. Percent of herbaceous and woody plant cover 0' to 3' tall	72.5%
12. List of major invasive plant species and percent cover	<i>Lonicera japonica</i> , <i>Celastrus orbiculatus</i> , <i>Hedera helix</i> , <i>Alicostegium vimineum</i> - 25%
13. Number of standing dead trees 6\"	3
14. Comments	Downed woody debris, wood pile, fence, trash present, leaf litter 1\", drainage pattern outside subject property
Forest Stand Summary Worksheet Sheet 1 of 1	

Property Name: Black Rock Rd	
Location: Montgomery County, MD	
Prepared By: AW, SSLD	Date: 10/19/18
Stand Variable	Stand B
1. Dominant/Codominant species	Dominant: <i>Quercus alba</i> , <i>Liriodendron tulipifera</i> , <i>Carya sp.</i> , <i>Juglans nigra</i> Codominant: <i>Nyssa sylvatica</i>
2. Successional stage	Early-Mid
3. Basal area in square feet per acre	70
4. Size class of dominant species	12-19.9\", 20-29.9\", 30+\"
5. Percent of canopy closure	87.5%
6. Number of tree species per acre	5
7. Common understory species per acre	<i>Nyssa sylvatica</i> , <i>Carya sp.</i> , <i>Quercus prinus</i>
8. Percent of understory cover 3' to 10' tall	15%
9. Number of woody plants species 3' to 20' tall	5
10. Common herbaceous species 0' to 3' tall	<i>Lonicera japonica</i> , <i>Toxicodendron radicans</i> , <i>Viola sororia</i> , <i>Alliaria petiolata</i> , <i>Rubus sp.</i>
11. Percent of herbaceous and woody plant cover 0' to 3' tall	67.5%
12. List of major invasive plant species and percent cover	<i>Lonicera japonica</i> , <i>Alliaria petiolata</i> - 22.5%
13. Number of standing dead trees 6\"	2
14. Comments	Downed woody debris, 3/2\"
Forest Stand Summary Worksheet Sheet 1 of 1	

THIS PLAN WAS PREPARED BY:
 AMANDA WAGONER
 KCI TECHNOLOGIES, INC.
 MDNR QUALIFIED PROFESSIONAL
 (JUNE 2014)

Amanda Wagoner
 SIGNATURE

FEBRUARY 2020
 DATE

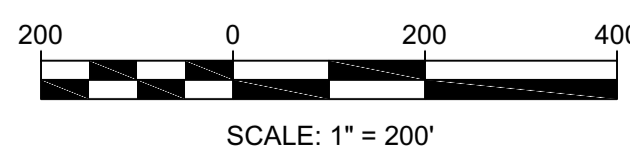

KCI TECHNOLOGIES
 ENGINEERS
 PLANNERS
 SCIENTISTS
 CONSTRUCTION MANAGERS

936 RIDGEBROOK ROAD
 SHARPS, MD 21152
 PHONE: (410) 316-7800
 FAX: (410) 316-7817
 www.kci.com

REVISIONS			
NO.	DATE	DESCRIPTION	BY

DATE: FEBRUARY 2020
 SCALE: _____
 CHECKED BY: _____
 DRAWN BY: _____
 AWW

APPLICANT: RADIO COMMUNICATIONS SERVICES (DEPARTMENT OF TECHNOLOGY SERVICES)
 PLAN NUMBER: 420200570
BLACK ROCK ROAD PROPOSED TOWER
SIMPLIFIED FOREST STAND DELINEATION/ NATURAL RESOURCES INVENTORY MAP
 17410 BLACK ROCK ROAD GERMANTOWN, MARYLAND 20874
 MONTGOMERY COUNTY

DRAWING NO.
NRI-00
 SHEET 1 OF 3
 KCI JOB NUMBER
 011702908.03

- LEGEND**
- - - 400 - - - 2' CONTOUR (SOURCE: COUNTY GIS)
 - - - UTILITY LINE (SOURCE: COUNTY UTILITIES)
 - WUS - - - WUS - - - STREAM LINE (SOURCE: FIELD DELINEATED)
 - WL - - - WL - - - NON-TIDAL WETLAND BOUNDARY (FIELD DELINEATED)
 - WB - - - WB - - - 25' WETLAND BUFFER
 - SB - - - SB - - - STREAM BUFFER
 - 100yr - - - 100 YEAR FEMA FLOODPLAIN
 - VEGETATION LINE
 - FOREST LINE
 - PROPERTY LINE
 - STUDY AREA
 - 16B - - - 16B - - - SOILS BOUNDARY
 - 9C - - - 9C - - - FOREST STAND BREAK
 - SP-1 - - - SP-1 - - - SPECIMEN TREE WITH CRITICAL ROOT ZONE
 - BUILDING
 - STEEP SLOPES 15-25%
 - STEEP SLOPES 25% AND GREATER
 - PROPOSED EASEMENT
 - FENCE
 - LOD - - - LOD - - - PROPOSED LIMIT OF DISTURBANCE
 - PROPOSED CONTOUR

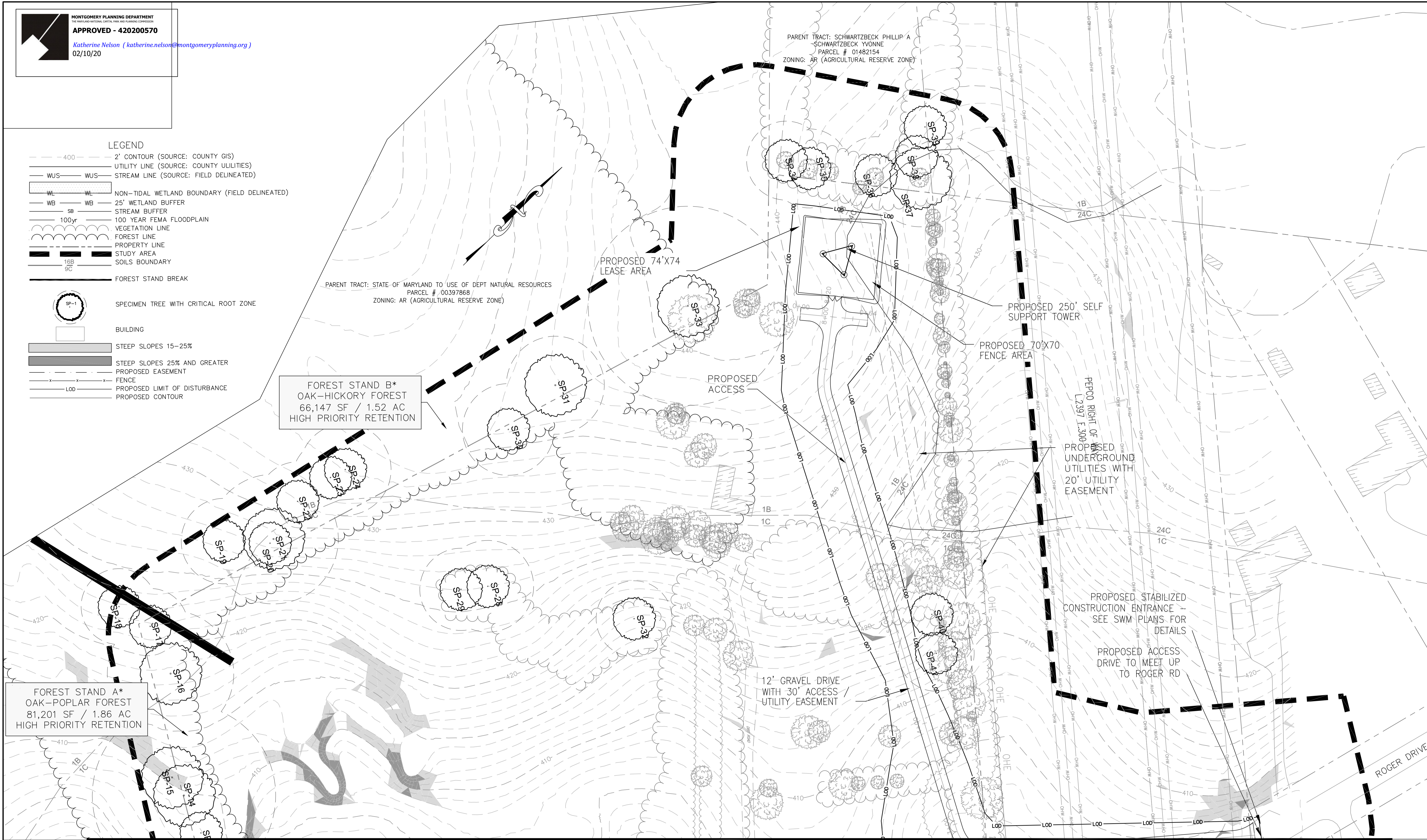

FOREST STAND A*
 OAK-POPLAR FOREST
 81,201 SF / 1.86 AC
 HIGH PRIORITY RETENTION

FOREST STAND B*
 OAK-HICKORY FOREST
 66,147 SF / 1.52 AC
 HIGH PRIORITY RETENTION

PARENT TRACT: SCHWARTZBECK PHILLIP A
 SCHWARTZBECK YVONNE
 PARCEL # 01482154
 ZONING: AR (AGRICULTURAL RESERVE ZONE)

PARENT TRACT: STATE OF MARYLAND TO USE OF DEPT NATURAL RESOURCES
 PARCEL # 00397868
 ZONING: AR (AGRICULTURAL RESERVE ZONE)

MATCHLINE - SEE SHEET 3 OF 3

THIS PLAN WAS PREPARED BY:
 AMANDA WAGONER
 KCI TECHNOLOGIES, INC.
 MDNR QUALIFIED PROFESSIONAL
 (JUNE 2014)
 Signature: Amanda Wagoner
 DATE: FEBRUARY 2020

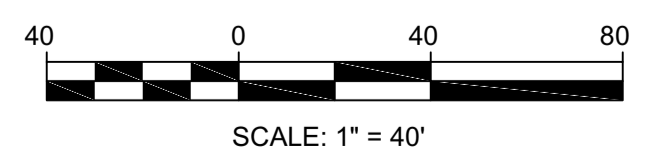

KCI TECHNOLOGIES
 ENGINEERS
 PLANNERS
 SCIENTISTS
 CONSTRUCTION MANAGERS
 936 RIDGEBROOK ROAD
 SHARPS, MD 21152
 PHONE: (410) 316-7800
 FAX: (410) 316-7817
 WWW.KCI.COM

NO.		DATE		REVISIONS	DESCRIPTION	BY	DATE

DATE: FEBRUARY 2020
 SCALE:
 CHECKED BY:
 DRAWN BY:
 AAW

APPLICANT: RADIO COMMUNICATIONS SERVICES (DEPARTMENT OF TECHNOLOGY SERVICES)
 PLAN NUMBER: 420200570
BLACK ROCK ROAD PROPOSED TOWER
 SIMPLIFIED FOREST STAND DELINEATION/
 NATURAL RESOURCES INVENTORY MAP
 17410 BLACK ROCK ROAD GERMANTOWN, MARYLAND 20874
 MONTGOMERY COUNTY

DRAWING NO.
NRI-01
 SHEET 2 OF 3
 KCI JOB NUMBER
 011702908.03

FOREST STAND A*
 OAK-POPLAR FOREST
 81,201 SF / 1.86 AC
 HIGH PRIORITY RETENTION

WETLAND WP002
 PEM1B
 15,581 SF / 0.36 AC

WUS WL001*
 R2UB1/2/3
 853 LF

WETLAND WP005
 PEM1F
 3,643 SF / 0.08 AC

PROPOSED 16' DOUBLE
 GATE TO BE ADDED
 TO EXISTING FENCE
 LINE WITH LOCK

PROPOSED GRAVEL ROAD
 A-3 REINFORCED
 GRAVEL - SEE SWM
 PLANS FOR DETAILS

PARENT TRACT: POTOMAC ELECTRIC POWER CO
 PARCEL # 00401197
 ZONING: AR (AGRICULTURAL RESERVE ZONE)

PARENT TRACT: MEJIA GEORGE
 PARCEL # 00388396
 ZONING: AR (AGRICULTURAL RESERVE ZONE)

LEGEND

- - - 400 - 2' CONTOUR (SOURCE: COUNTY GIS)
- UTILITY LINE (SOURCE: COUNTY UTILITIES)
- WUS — WUS — STREAM LINE (SOURCE: FIELD DELINEATED)
- WL — NON-TIDAL WETLAND BOUNDARY (FIELD DELINEATED)
- WB — 25' WETLAND BUFFER
- SB — STREAM BUFFER
- 100yr — 100 YEAR FEMA FLOODPLAIN
- VEGETATION LINE
- FOREST LINE
- PROPERTY LINE
- STUDY AREA
- 16B 9C1 — SOILS BOUNDARY
- FOREST STAND BREAK
- SP-1 — SPECIMEN TREE WITH CRITICAL ROOT ZONE
- — BUILDING
- STEEP SLOPES 15-25%
- STEEP SLOPES 25% AND GREATER
- PROPOSED EASEMENT
- FENCE
- LOD — PROPOSED LIMIT OF DISTURBANCE
- PROPOSED CONTOUR

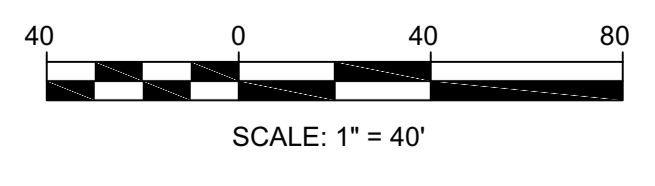

THIS PLAN WAS PREPARED BY:
 AMANDA WAGONER
 KCI TECHNOLOGIES, INC.
 MDNR QUALIFIED PROFESSIONAL
 (JUNE 2014)

Amanda Wagoner
 SIGNATURE

FEBRUARY 2020
 DATE

KCI TECHNOLOGIES
 ENGINEERS
 PLANNERS
 SCIENTISTS
 CONSTRUCTION MANAGERS
 936 RIDGEBOOR ROAD
 SHARPS, MD 21152
 PHONE: (410) 316-7800
 FAX: (410) 316-7817
 WWW.KCI.COM

NO.		DATE		REVISIONS	DESCRIPTION	BY	DATE

DATE: FEBRUARY 2020
 SCALE: 1" = 40'
 CHECKED BY: []
 DRAWN BY: []
 AAW

APPLICANT: RADIO COMMUNICATIONS SERVICES (DEPARTMENT OF TECHNOLOGY SERVICES)
 PLAN NUMBER: 420200570
BLACK ROCK ROAD PROPOSED TOWER
**SIMPLIFIED FOREST STAND DELINEATION/
 NATURAL RESOURCES INVENTORY MAP**
 17410 BLACK ROCK ROAD GERMANTOWN, MARYLAND 20874
 MONTGOMERY COUNTY

DRAWING NO.
NRI-02
 SHEET 3 OF 3
 KCI JOB NUMBER
 011702908.03