



Montgomery Planning Fall 2020 Semiannual

Thrive Montgomery 2050

A dialogue with diverse voices about how we will guide our county through the next 30 years.

- African Affairs Advisory Group
- Audubon Naturalist Society
- Arts on the Block
- Burtonsville Placemaking participants
- CASA
- First Lego League
- Gandhi Brigade
- Long Branch Week participants
- Latin American Youth Center
- Street Outreach Network
- Middle Eastern American Advisory Group
- Students (USG, MC, Middle School and High School)
- Wheaton Arts Parade participants



I-495 & I-270 Managed Lanes Study













Introducing

M-NCPPC's Wheaton Headquarters

The first LEED Platinum
Government Building in Maryland

Engagement During COVID-19

-  41,797 Planning Board Meeting Views
-  1,056 New eLetter Subscribers
-  30+ Events
-  1,100+ Virtual Meeting Participants

*From March 26 to November 9, 2020

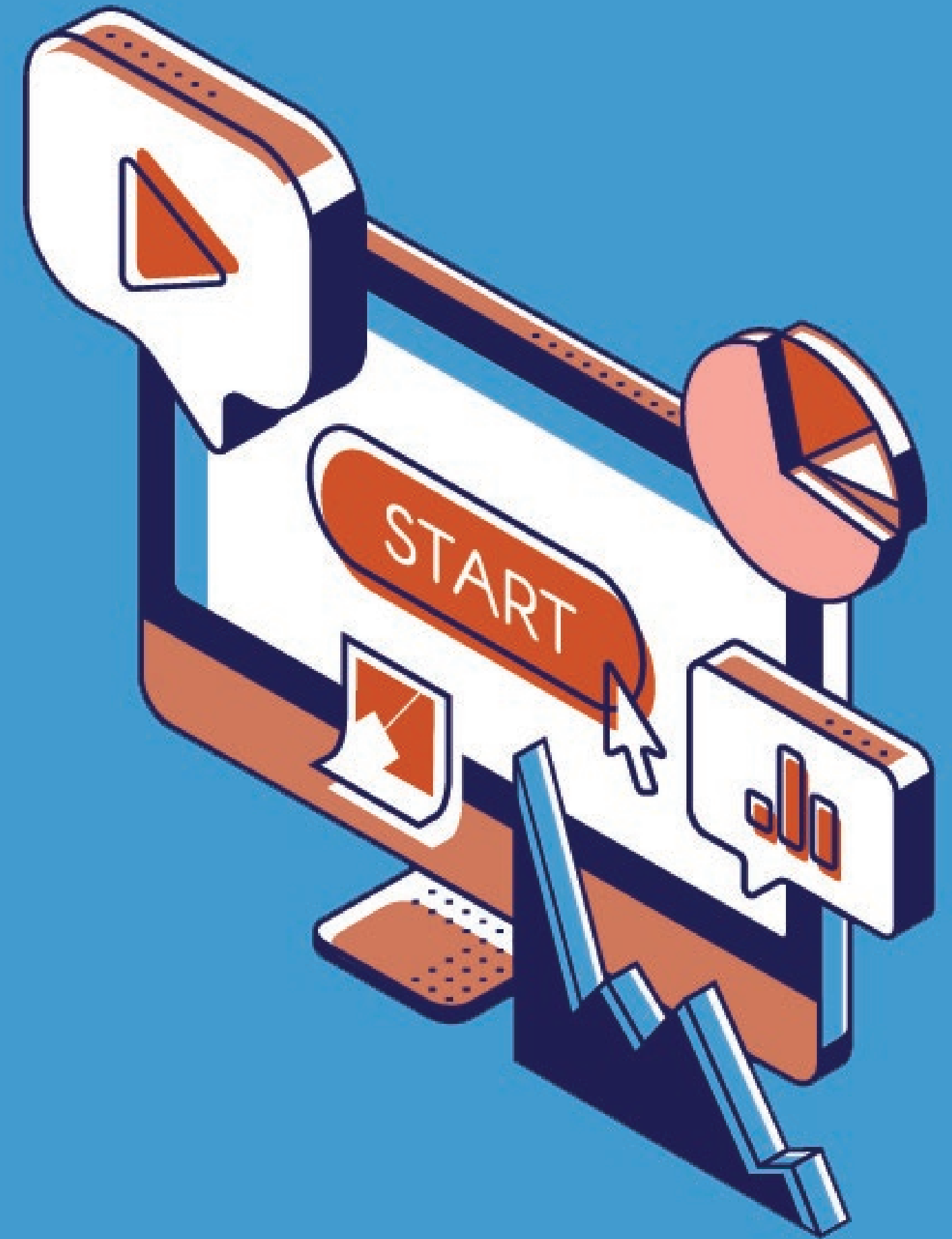

ADVANCING
THE PIKE DISTRICT

Community Kickoff Meeting

May 19, 2020

CORRIDOR FORWARD
I-270 Transit Plan

09.30.2020

Montgomery Planning

PINTS with a PLANNER
Online Happy Hour

THRIVE
MONTGOMERY 2050
Let's Plan Our Future, Together

Montgomery Planning
@montgomeryplans

Join us today starting at 10 a.m. for [#ThriveHousingDay](#)! Housing Planner Lisa Govoni is taking over our twitter to answer your questions on housing in Montgomery County and how the Thrive Montgomery 2050 plan will address housing.

HOUSING DAY
#THRIVEHOUSINGDAY

COMMUNITY CHAT

THRIVE
MONTGOMERY 2050
Let's Plan Our Future, Together

WHY DO THIS PLAN NOW?

- Purple Line impact to downtown Silver Spring
- Change in Silver Spring downtown since 2000:
 - Numerous civic/community resources built
 - 10 million sf of development built
 - Downtown transformation over last 20 years
 - Diversity of small businesses
 - Growth of arts, entertainment and culture
- Planning is important during a pandemic in order to address impact from public health crisis.



Silver Spring Downtown and Adjacent Communities Plan

07/29/2020 8

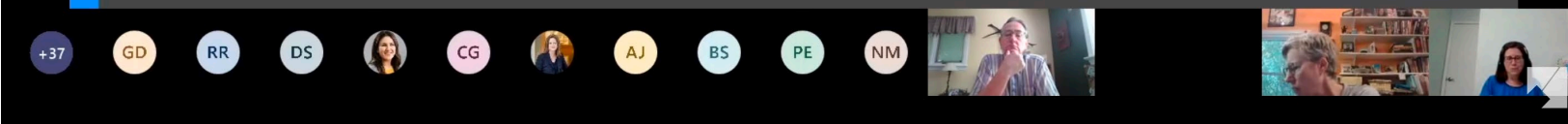

“ Silver Spring Downtown & Adjacent Communities Plan Listening Sessions

I just completed the survey but wanted to also thank you for a well-done and engaging session. I've been trying to attend more of these and more public meetings that impact Silver Spring and housing across MoCo, and as virtual experiences, they can be hit-or-miss; this was a hit. If there is an upside to all-virtual meetings, it's the breakout rooms feature. I think small group discussions now feel more intimate and make it more appealing to speak in a casual and conversational way that facilitates back-and-forth discussion. Mine was really well facilitated.

- Community Member

Development Applications Submitted During COVID-19

Type	Amount
Preliminary Plans	29
Plats	48
Sketch Plans	6
NRI/FSD	41
FCP Exemptions	99
Concept Plans	11
Administrative Subdivisions	13
Site Plans	44
Project Plans	1
ROW Abandonments	1
Forest Banks	3
Map Amendments	3
Mandatory Referrals	21
Sediment Control FCPs	15

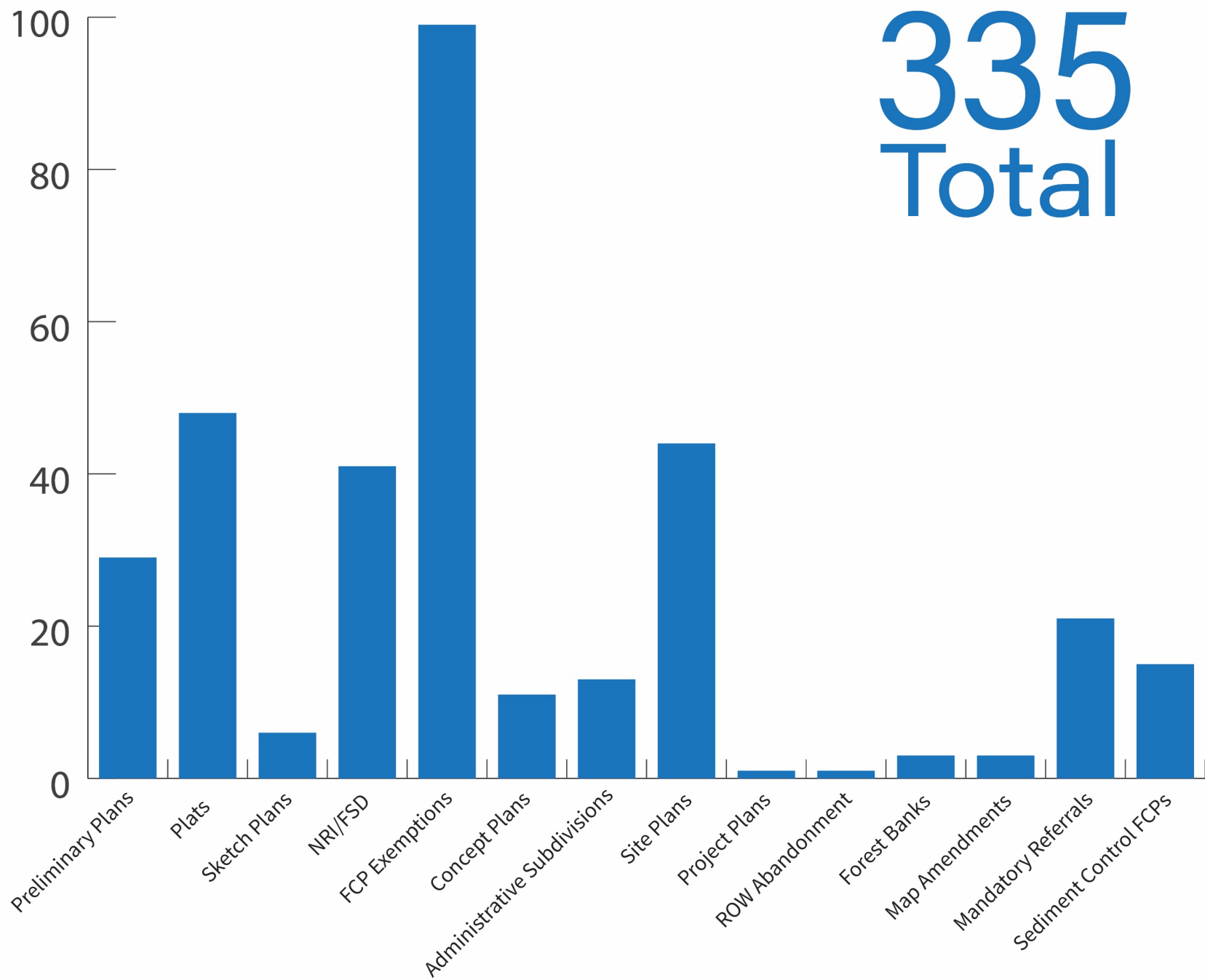

*From March 26 to October 14, 2020

Focus on Equity

- Planning Board briefing
- Staff training
- Street + Parks Facilities Renaming Project
- Equitable engagement
- Vision Zero
- Equity in Master Planning Framework/ Action Agenda

EQUITY

PLANNING WITH AN EQUITY LENS:
BUILDING AN EQUITY TOOL

How are residents who have been historically excluded from planning processes being authentically included in this effort?

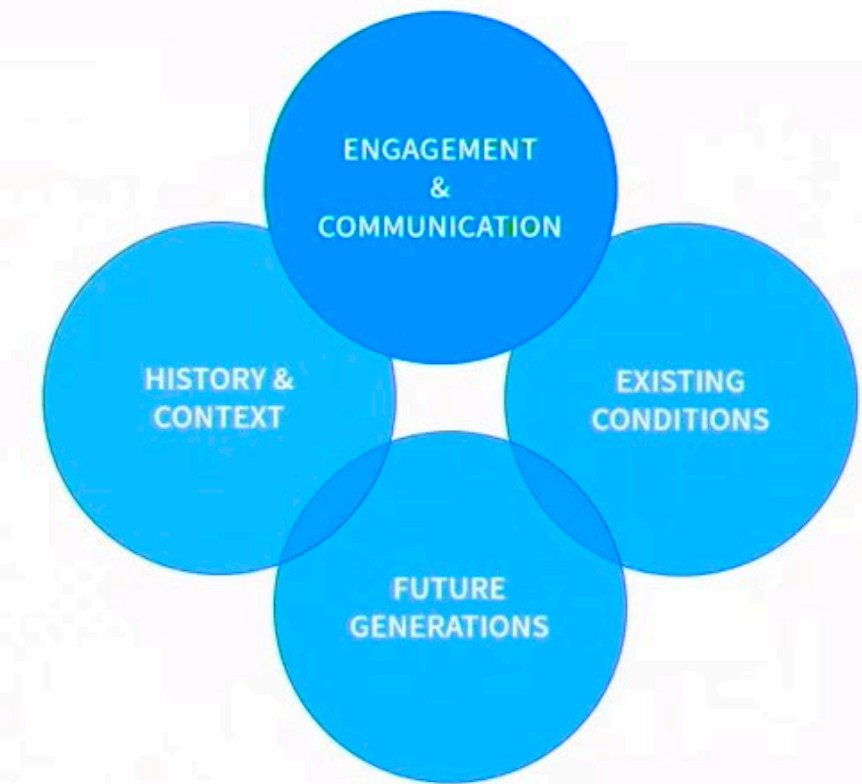

Thrive Montgomery 2050

Upcoming Schedule:

- **Public Hearing**
November 19, 2020
- **Planning Board Work Sessions**
December 2020 through January 2021
- **Planning Board Review and Transmittal**
October 2020-March 2021
- **Council Transmittal and Review**
April 2021

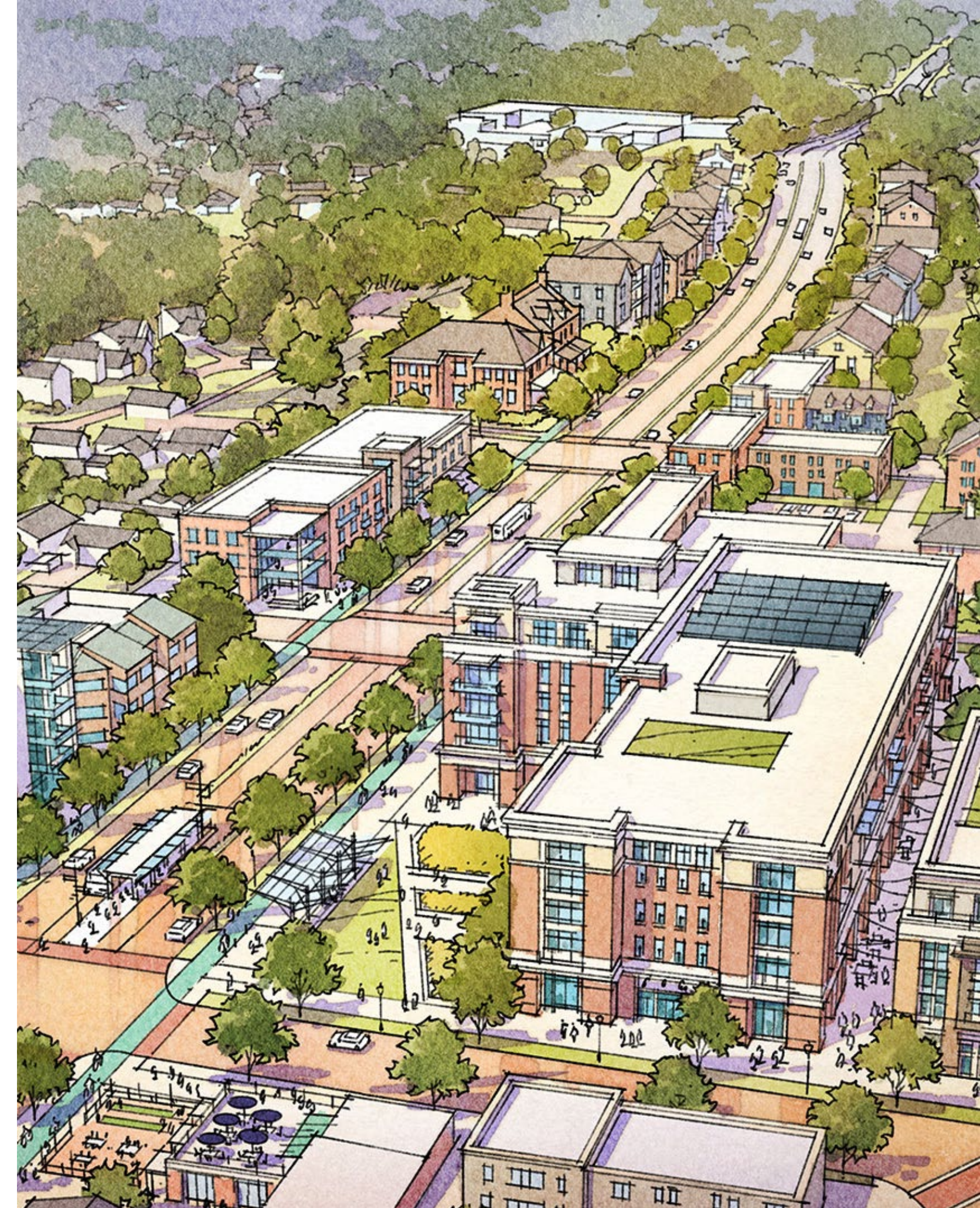



Growth and Infrastructure Policy

- Eliminating the Housing Moratorium
- Utilization Premium Payments (UPP)
- School Impact Areas
- Updated Transportation Policy Areas
- Vision Zero-enhanced Transportation Adequacy Tests
- Updated Impact Tax Calculations and Exemptions
- Recordation Tax Changes

Regulatory Projects



St. Elmo Apartments

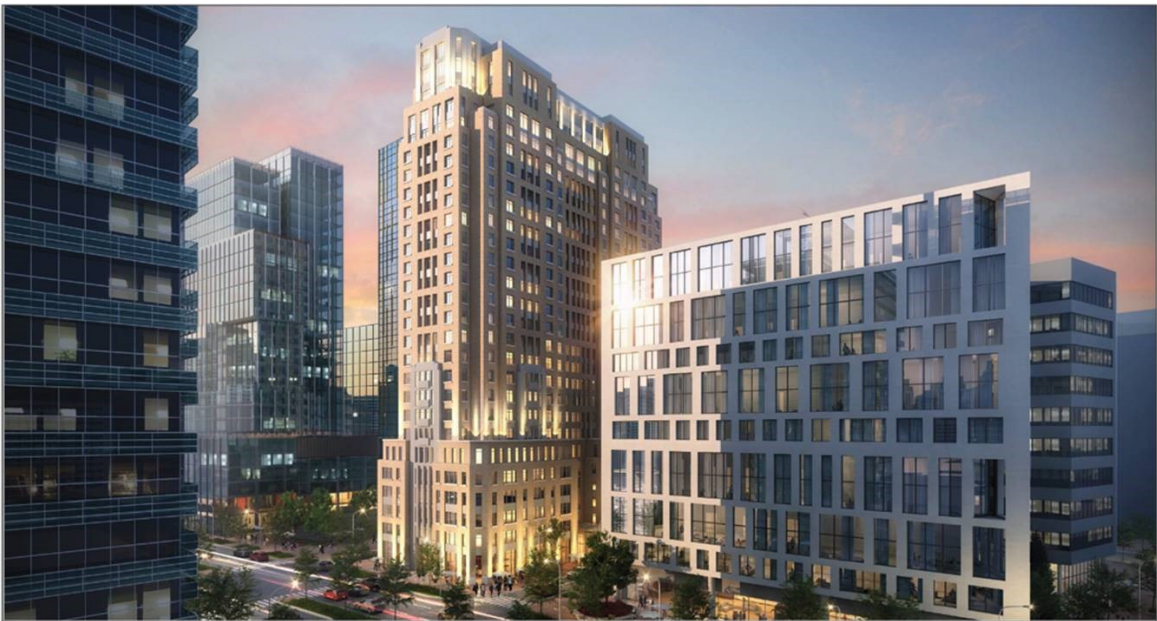

Metro Tower



Wilgus

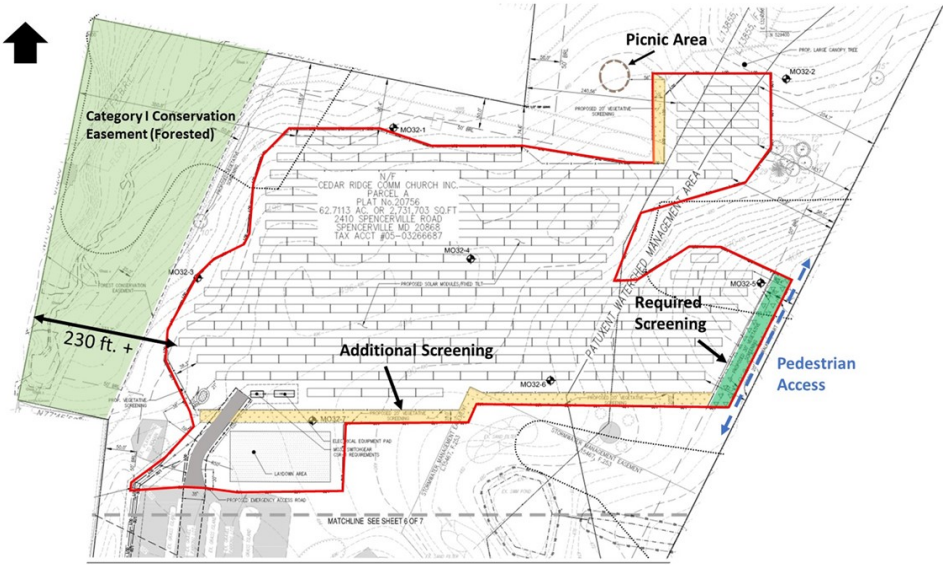

Cedar Ridge Solar Project

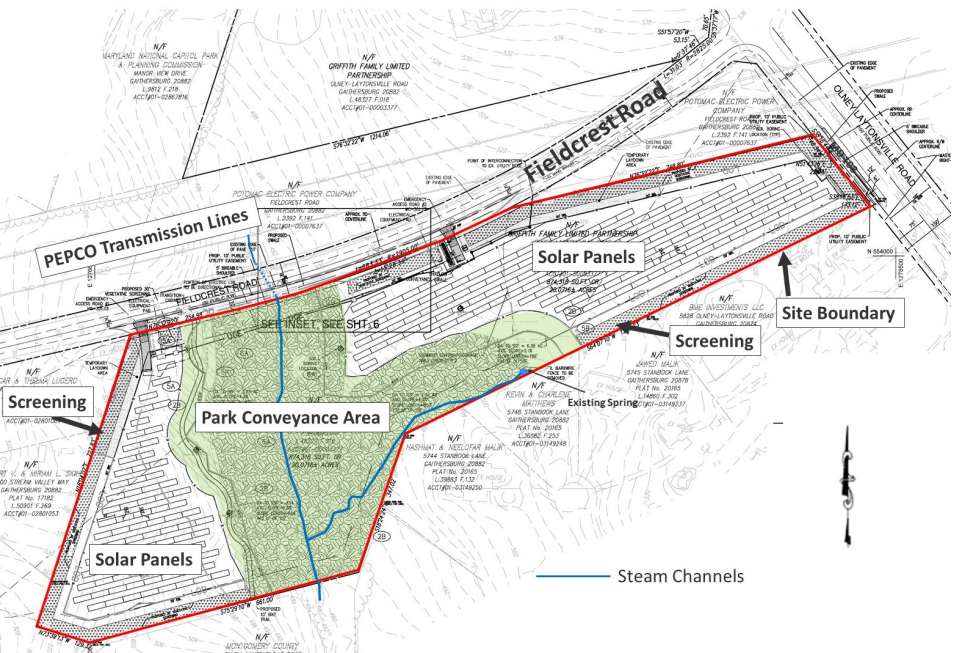

Fieldcrest Community Solar Project

Regulatory Projects



Westfield Montgomery – Before and After



Plans and Projects

- Complete Streets Design Guidelines
- Corridor Forward: I-270 Transit Plan
- Pedestrian Master Plan
- Rustic Roads Functional Master Plan
- Ashton Village Center Sector Plan
- Shady Grove Minor Master Plan Amendment
- Silver Spring Downtown & Adjacent Communities Plan
- Takoma Park Minor Master Plan Amendment
- GSSC Minor Master Plan Amendment
- Fairland/Briggs Chaney Minor Master Plan Amendment
- Advancing the Pike District Study
- Mixed-Use Development Study
- Retail in Diverse Communities Study

FY22 Proposed Master Plan and Major Projects Schedule

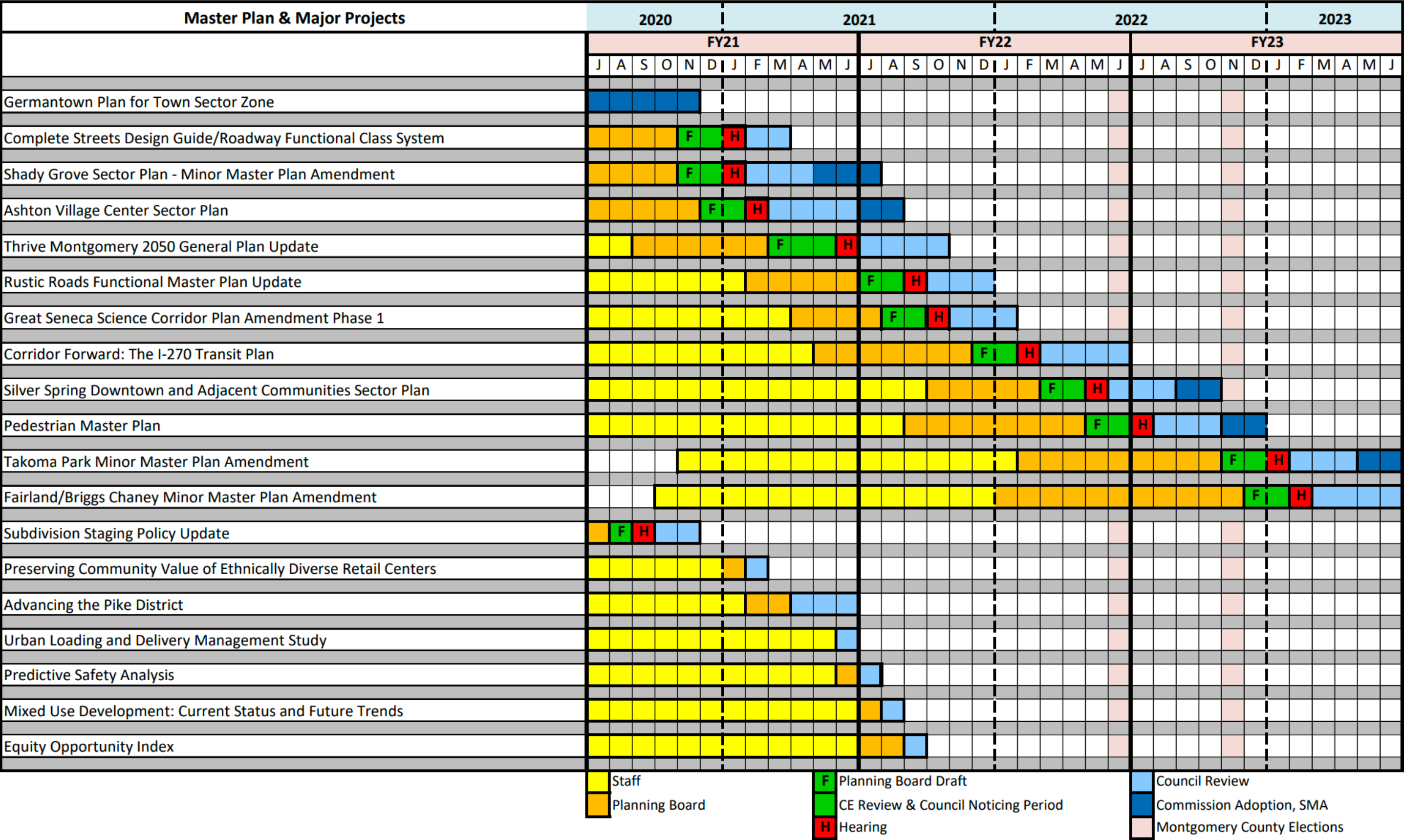



Parks Fall 2020 Semiannual Report

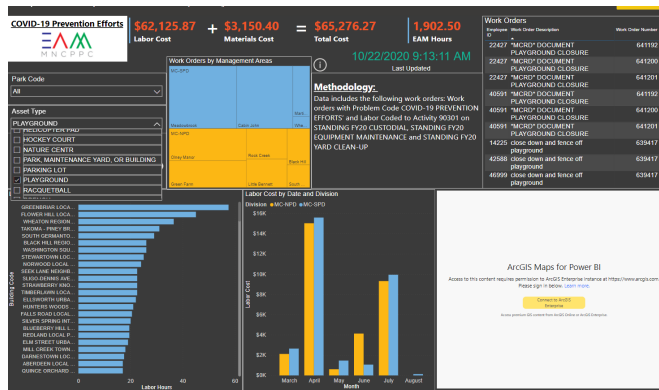

Re-Opening Facilities & Programs



What's Open



Archery



Brookside Gardens
Visitor Center
(10 am–2pm daily)



Campsites,
Cabins & Yurts



Dog Parks



Driving Range



Event Centers
Booking Now



Gardens



Ice Rinks for
Athlete Training



Inline Skating Rinks
With Permit



Nature Center
Programs



Online Programs



Outdoor In-Person
Programs



Parks & Trails



Permitting Athletic
Fields for Low &
Medium risk Sports



"Picnic in the Park"
Order Takeout
@ Select Locations



Picnic Shelters
With Permit



Playgrounds



Skate Parks



Stand-alone
Restrooms



Tennis Centers,
Tennis &
Pickleball Courts



Mon-Fri
8am-5pm
Customer Service
301.495.2595

November 13, 2020

What's Closed

Basketball Courts

Carousel

Nature Center
Facilities

Park Activity
Buildings

Trains

MontgomeryParks.org



Re-Opening Facilities



**Stand Here
Párese aquí**



Thank you for practicing safe physical distancing.
Le agradecemos por practicar
el distanciamiento social de manera segura.



**Stand Here
Párese aquí**

Thank you for practicing safe physical distancing.
Le agradecemos por practicar
el distanciamiento social de manera segura.



COVID-19: Be Smart. Do Your Part.

Playgrounds Are Opening

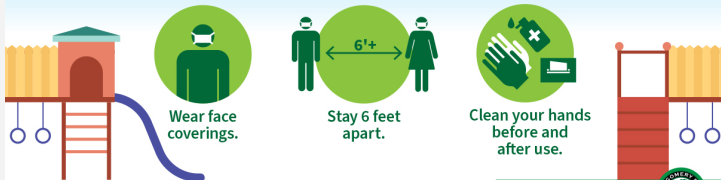

June 26, 2020

MontgomeryParks.org



COVID-19: Be Smart. Do Your Part.

Boating is Open

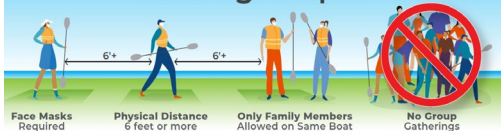

May 20, 2020

MontgomeryParks.org



COVID-19: Be Smart. Do Your Part.

**Cabin John Ice Rink
Wheaton Ice Arena**

Limited Opening July 6



July 6, 2020



Be Smart. Do Your Part.

Wear Face Coverings



September 23, 2020

MontgomeryParks.org



**COVID-19:
Be Smart.
Do Your Part.**

**COVID-19: Sean listos.
Hagan su parte.**



Montgomery Parks' facilities and programs are taking precautionary measures which are in accordance with the Center for Disease Control and Prevention as well as state and county guidelines.

Las instalaciones y programas de Montgomery Parks han adoptado medidas de precaución conforme a las directrices de los Centros de Control y Prevención de Enfermedades, así como a las del estado y del condado.

<https://www.montgomerycountymd.gov/covid19/>



MontgomeryParks.org
Park Police | Policía del Parque: 301-949.8010
Customer Service | Servicio al Cliente: 301.495.2595

By Authority of M-NCPPC
Por Autoridad de M-NCPPC

Adaptable Programming



Weddings



Movie Nights



Haunted Hustle



Adaptable Programming



Active Aging Week



Acorn Park / Newell Street Closure

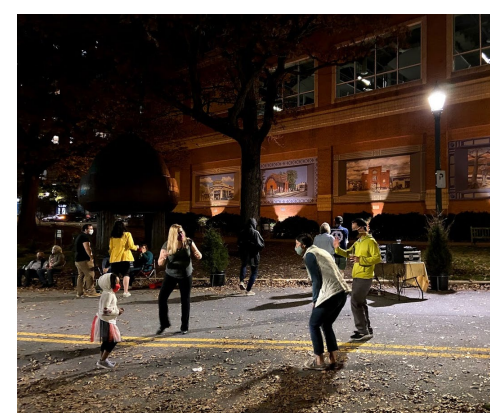



“

My family and I are very excited about the new Playstreet on Newell Street in Silver Spring. I live nearby and am always looking for space for my toddler to play. I walk by the Playstreet every day and love seeing people using the space. Eating meals at the picnic tables, playing frisbee, kids riding bikes and scooters. **I've never seen the community come together like this to celebrate a space and it makes me really happy to live in Downtown Silver Spring.**

—Marnay Meyer



Adaptable Programming



Halloween Walk & Chalk



COVID Corps



Discover Montgomery



Online Programming

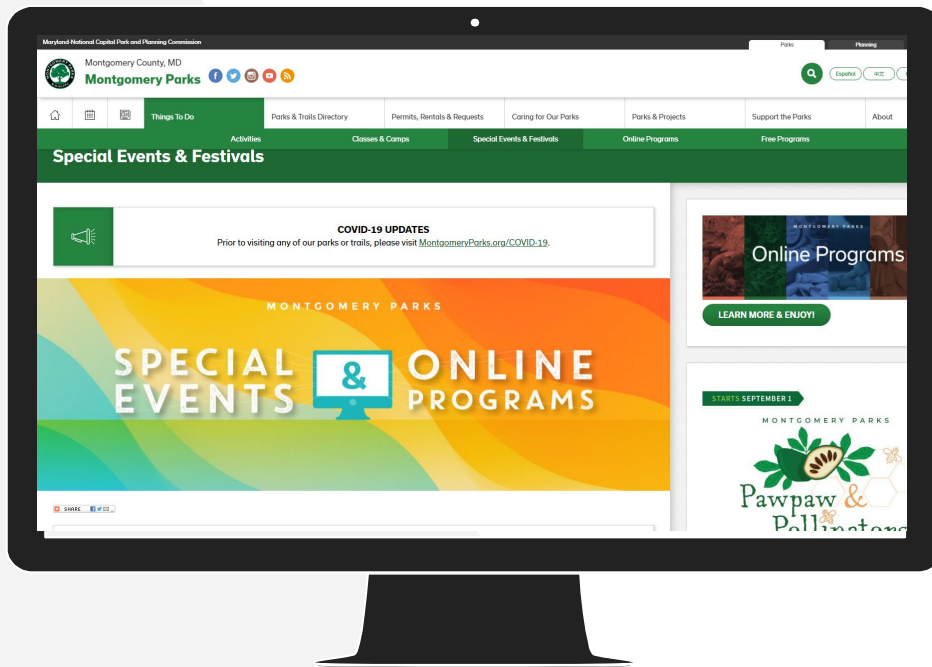

Pawpaw and Pollinators Festival
Plant Sales

Urban Tree Summit

GreenScapes Symposium

Parks Speaker Series

Mindful Mondays

Yoga at Brookside Gardens

Summer Camps

Maryland Emancipation Day
Celebration

Virtual Storytime with Councilmember
Jawando



I want to compliment you and your team and instructors and special guests. This has been a fabulous class. Honestly, my daughter's two summer Montgomery County Parks classes **have been the most interactive, interesting and engaging classes she has taken in the online era.**

You are all creative and deliver wonderful content.

Thanks for all you do!
Stephanie Flack



HarvestShare





Rent Abatement

COVID-19 Forbearance Amount by Type

April–November 3, 2020

18 Tenants/Partners

Total \$240,547

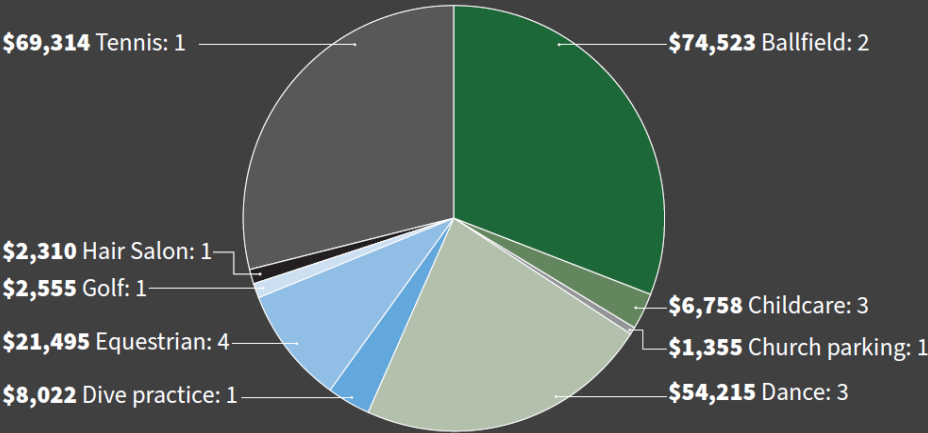

Supporting Local Businesses



Picnic in the Park

- ▶ Partnership with Visit Montgomery / MoCo Eats
- ▶ Support local restaurants
- ▶ Nine park locations
- ▶ Close proximity to restaurants
- ▶ Delivery and alcohol zones



Racial Equity Lens



- Used in prioritization of FY 21-26 Parks CIP
- Added prioritization of investment high deficit areas w/ highest non-white lower income residents.
- Studying Park & Recreation equity plans in major cities across the U.S.
- Parks play a major role in advancing the County's Racial Equity & Social Justice Policy

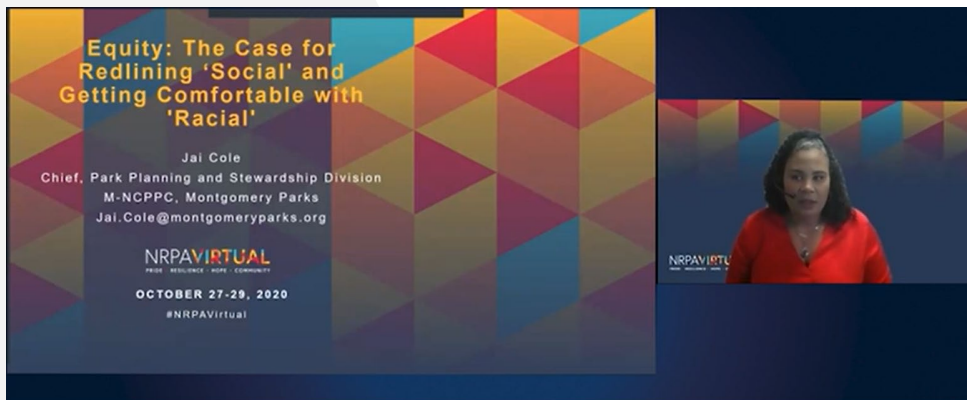

EPS DEFICITS + RACE/INCOME AREAS

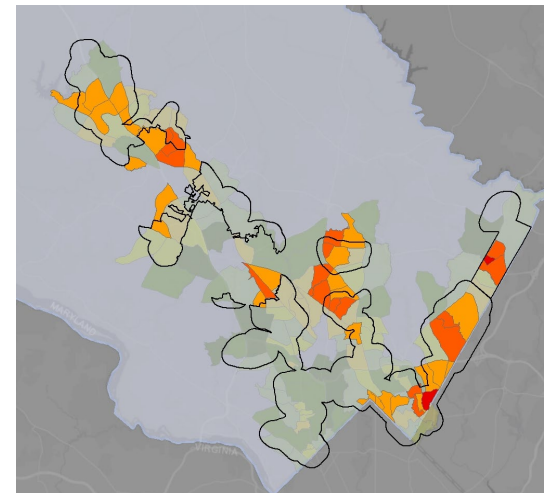

- High Deficit + Fewest Non-White Lower Income Residents
- Higher + Fewest Non-White Lower Income Residents
- Highest + Fewest Non-White Lower Income Residents

Major Park Systems Across the Country Have Developed Equity Plans



DEPARTMENT of RECREATION and PARKS

Athletic Field Improvements



Infield Maintenance

Greenwood Local Park - Before and After



Field Renovation

White Oak Rec Center



Bermuda Grass Conversion

Buck Branch Neighborhood Park – Before and After



Athletic Field Improvements



Bowie Mill Local Park
Before and After



Rock Creek Forest Elementary
Before and After



Athletic Field Improvements



Glen Haven Elementary School
Before and After



Lois P Rockwell Elementary School
Before and After



Martin Luther King, Jr. Local Park
Before and After



Project Delivery

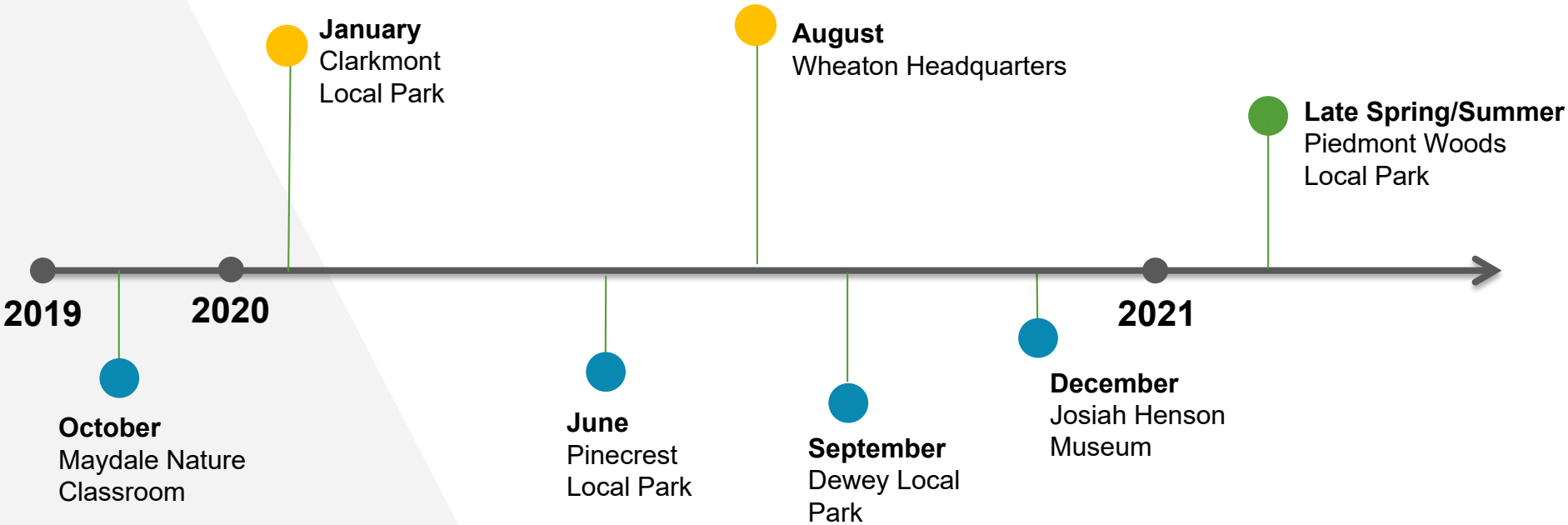

Maydale Nature Classroom



Dewey Local Park Refresher



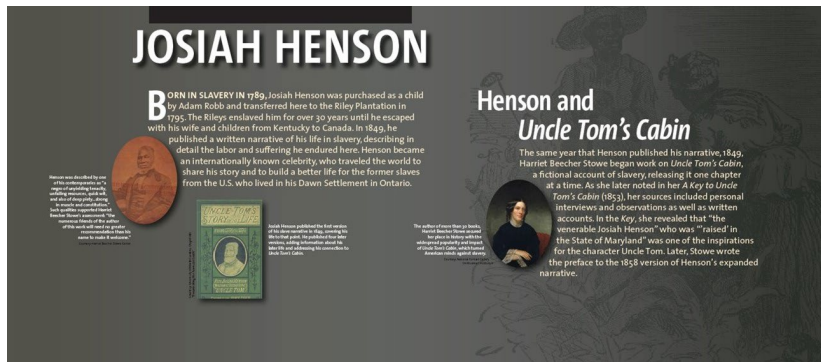

Boat Launch at Seneca Landing



- ▶ Fully ADA accessible gangway and floating kayak/canoe launch
- ▶ accessible and expanded picnic area, new walkways and drop off lane, and accessible parking
- ▶ Only fully accessible launch on the upper reaches of the upper Potomac River
- ▶ Improves safety and capacity



Wheaton Regional Park Master Plan

Community Engagement: Shape the Future of Wheaton Regional Park

FALL 2020 – WINTER 2021	SPRING 2021	SUMMER 2021
<p>Targeted outreach to broader diversity of stakeholders</p> <p>Focus on communities within 1 mile of the park</p>	<p>Staff Draft Plan to the Planning Board</p> <p>Planning Board Public Hearing</p>	<p>Work Session(s) and Plan Adoption</p>



Public Input Opportunities



Pickleball

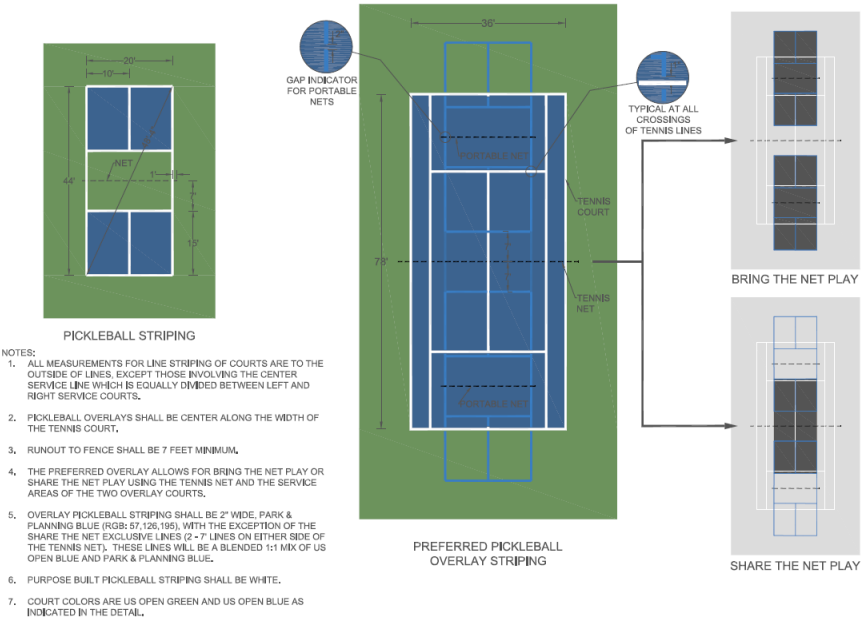

Pickleball Court Overlay Specification on Tennis Court



Temporary Pickleball Court at Bauer Drive Park

Pickleball



Temporary Pickleball Court at East Norbeck Local Park



Staff Installing Tape to Create Temporary Court in East Norbeck Local Park

Trails Program Update

Built or renovated trails in:

- ▶ Lower Paint Branch Stream Valley Park
- ▶ Cabin John Stream Valley Park
- ▶ Little Bennett Regional Park
- ▶ Lois Y Green Community Park
- ▶ Woodstock Special Park trail

Major Trail Projects Underway:

- ▶ Paint Branch Bridge
- ▶ Upper Paint Branch Trails

Upcoming:

- ▶ Provide trails enhancements
- ▶ Bike rack need assessments and implementation

Trail-Use Increases

2019 vs 2020

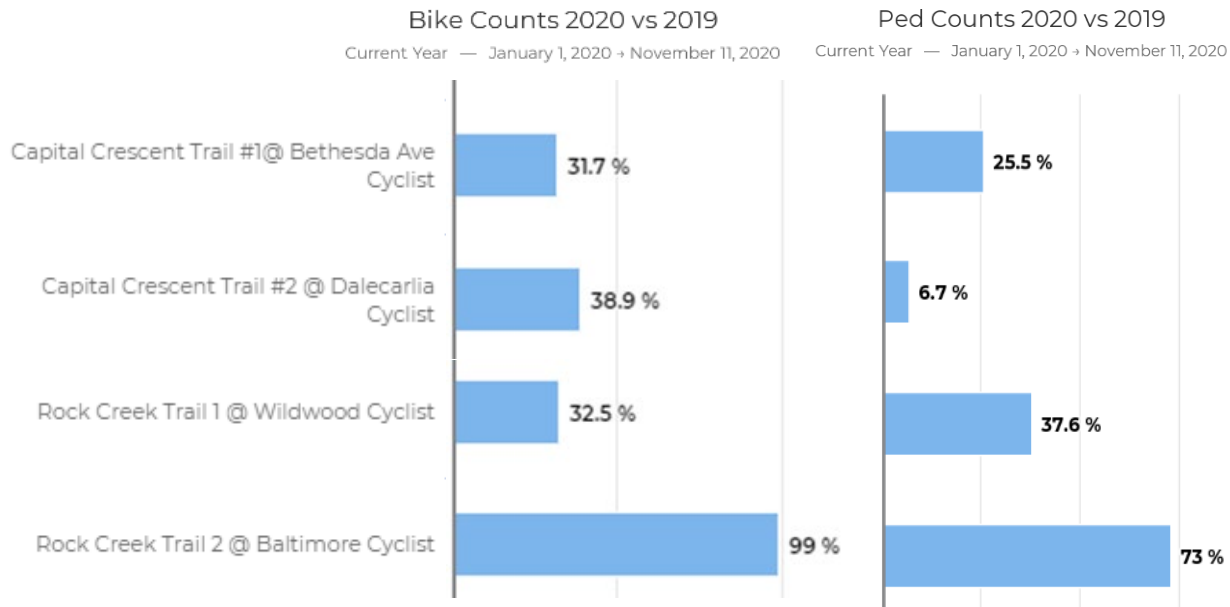

Cabin John Stream Valley Trail



Parks converted a hiking-only trail that was in a floodplain into a multi-use trail that will stay drier and require less maintenance.

Open Parkways

480,000

visits to Open Parkways
April – early November 2020

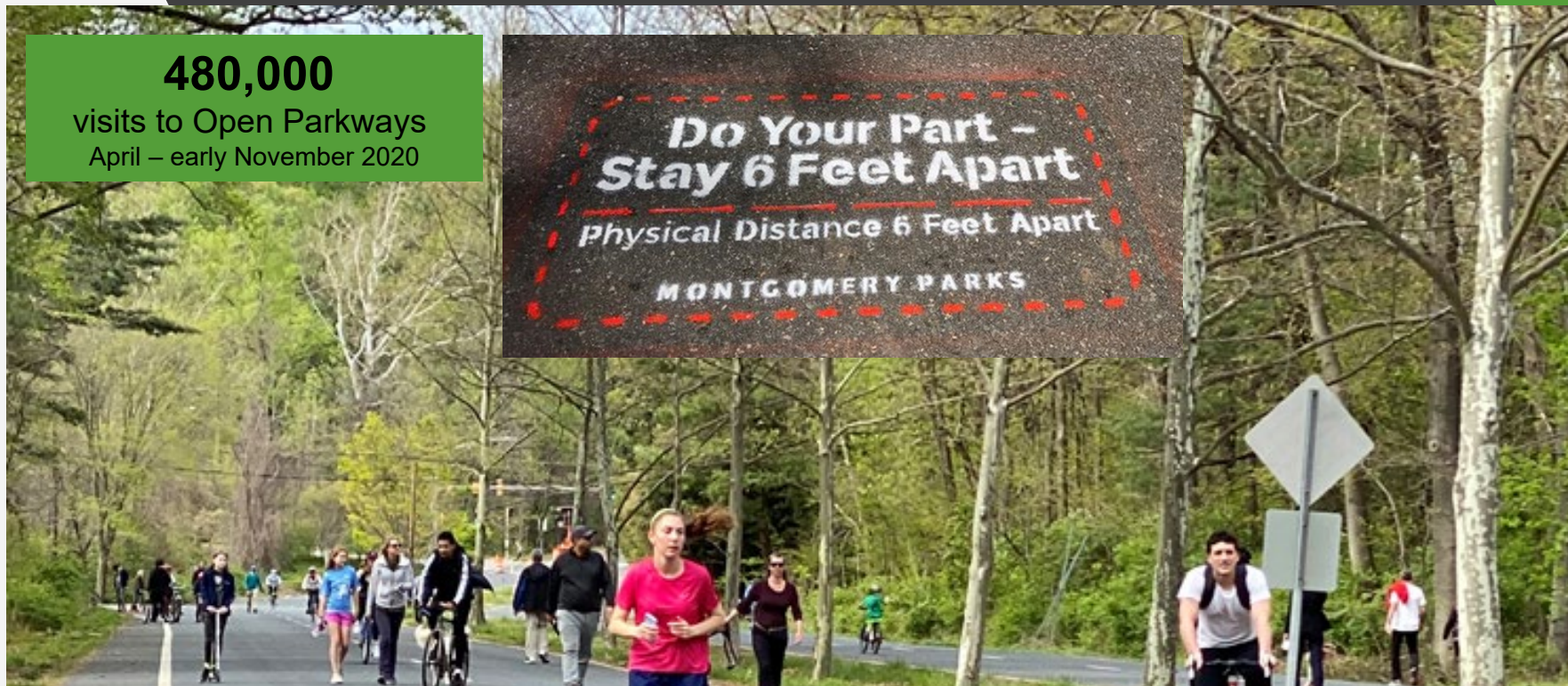

Little Falls Parkway, April 19, 2020

Gates: Old Carroll Before



Gates: Old Carroll After





THANK YOU!