

VICINITY MAP

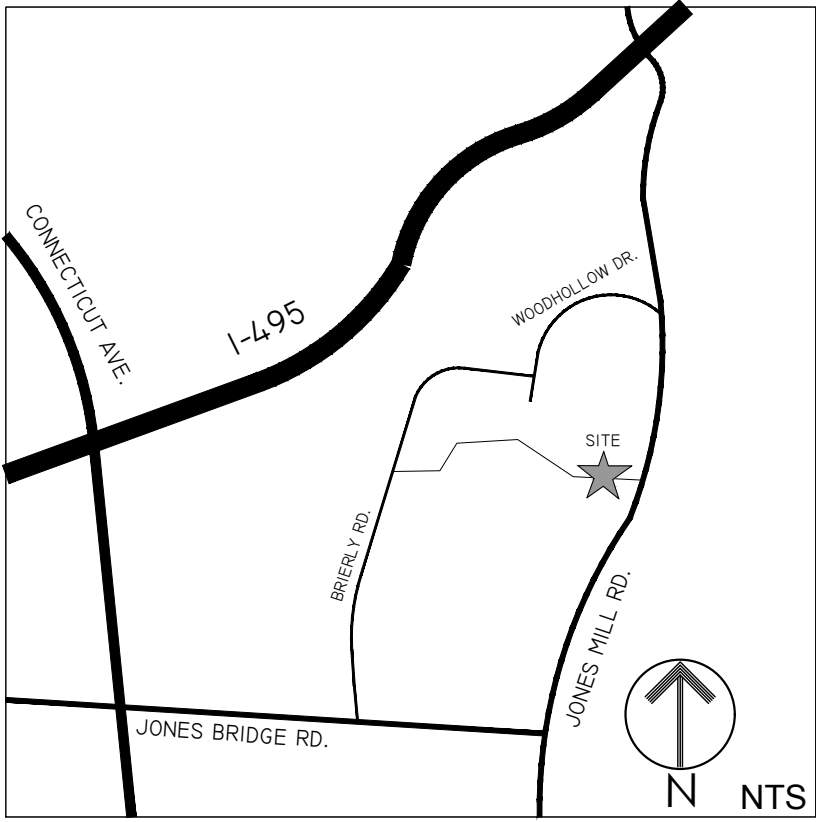

PROJECT INFORMATION

OWNER
AUDUBON NATURALIST SOCIETY
8940 JONES MILL RD., CHEVY CHASE, MD 20815
(301) 652-9188
CONTACT: LISA ALEXANDER
LISA.ALEXANDER@ANSHOME.ORG

LANDSCAPE ARCHITECT
JESSE TURNER
3124 HOPE VALLEY ROAD, DURHAM, NC 27707
(919) 886-4440
JESSE@LIFTEDLANDSCAPE.COM

CONSULTANT
GENERAL CONTRACTOR

SITE SUMMARY

- 1. PARCEL I.D. - 00416781
- 2. NO FEMA FLOODPLAIN
- 3. ONLY ABOVE GROUND, VISIBLE UTILITIES WERE LOCATED AND OTHERS MAY EXIST BELOW GROUND.
- 4. WETLANDS, FLOOD PLAIN SOILS, AND ENVIRONMENTAL HAZARDS WERE NOT LOCATED WITH THE SURVEY
- 5. ZONING FOR THIS SITE IS R-90
- 6. MAJOR AND MEDIUM-SIZED TREES ON THE PROPERTY WERE LOCATED

DRAWING INDEX

- L-0.0 COVER
- L-0.1 SECTION
- L-2.0 SITE PLAN
- L-5.0 PLANTING PLAN
- L-6.0 DETAILS
- L-6.1 DETAILS
- L-6.2 DETAILS
- L-6.3 DETAILS

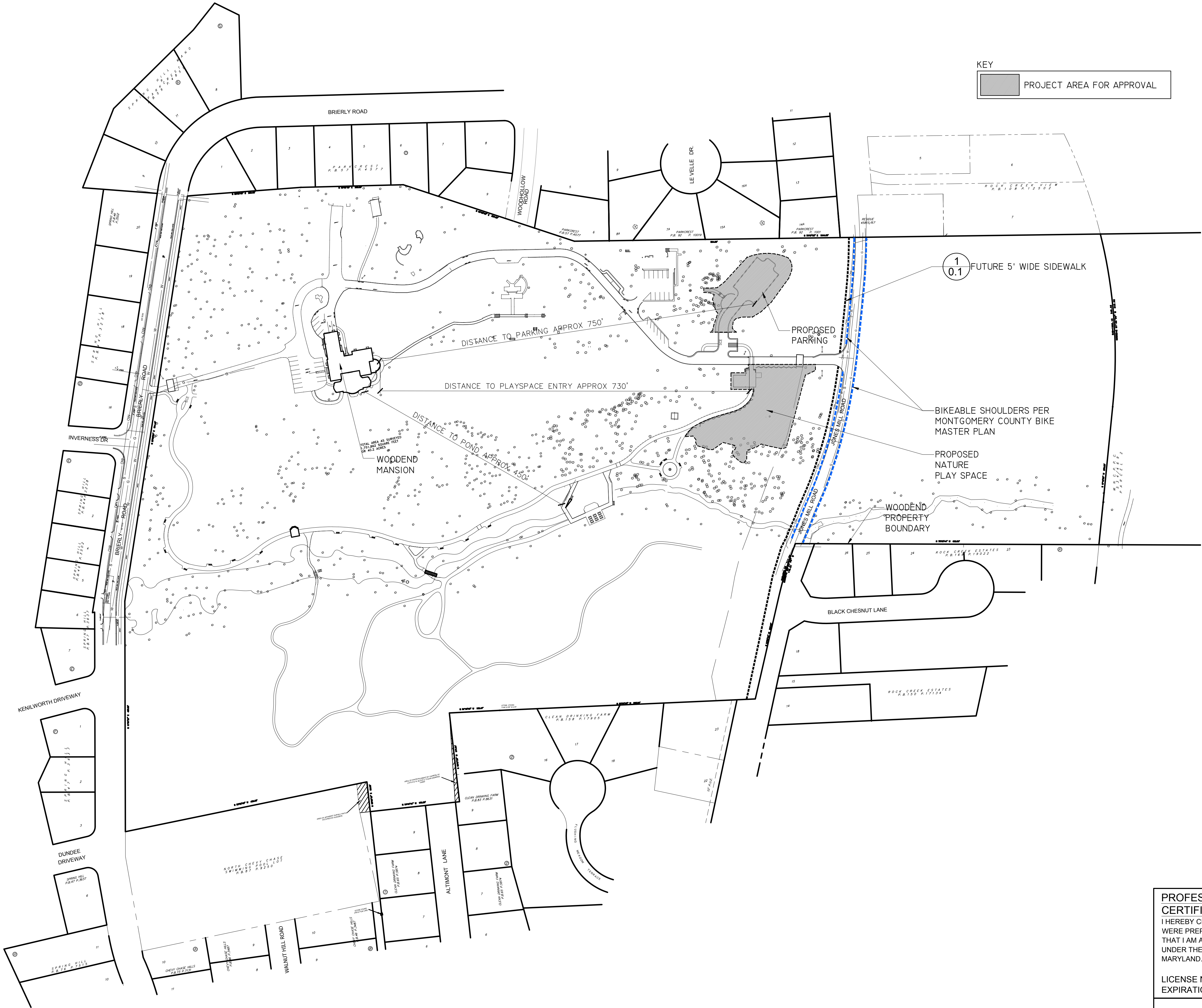

PROFESSIONAL
CERTIFICATION

I HEREBY CERTIFY THAT THESE DOCUMENTS
WERE PREPARED OR APPROVED BY ME, AND
THAT I AM A DULY LICENSED PROFESSIONAL
UNDER THE LAWS OF THE STATE OF
MARYLAND.

LICENSE NO. 3987
EXPIRATION DATE: 6/22/2021

8/20/2020

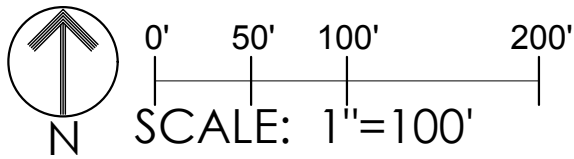

APPROVAL DRAWINGS

DRAWN	JT, ZW
REVISED	12/11/2020

3124 HOPE VALLEY RD.
DURHAM, NC 27707
919 823 7896
www.liftedlandscape.com

JOB No	###
DATE	8/20/2020
SCALE	See Plans
FILE	

NATURE PLAYSPACE
AUDUBON NATURALIST SOCIETY

COVER

L0.0

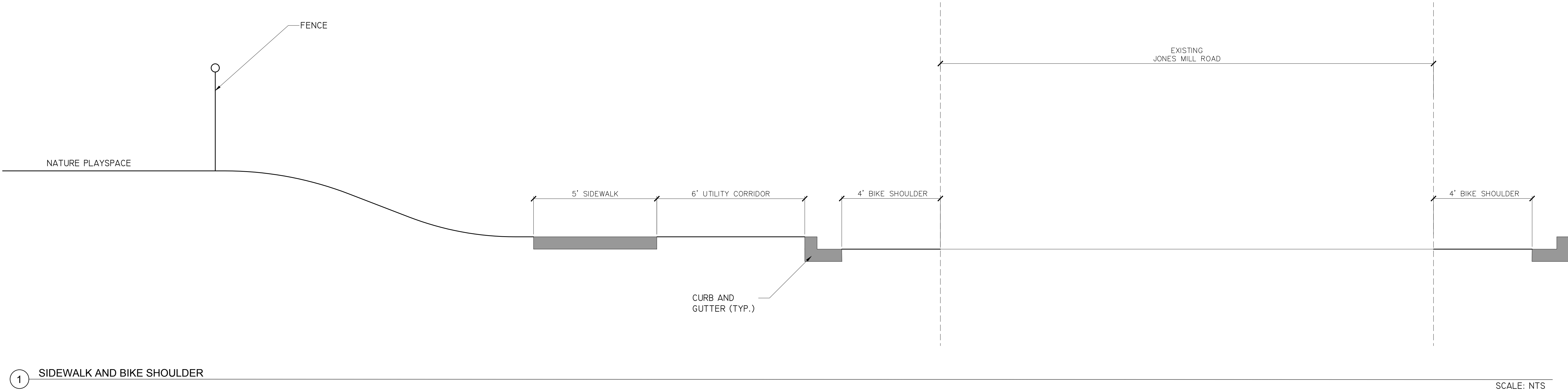

PROFESSIONAL
CERTIFICATION

I HEREBY CERTIFY THAT THESE DOCUMENTS
WERE PREPARED OR APPROVED BY ME, AND
THAT I AM A DULY LICENSED PROFESSIONAL
UNDER THE LAWS OF THE STATE OF
MARYLAND.

LICENSE NO. 3987 ,
EXPIRATION DATE: 6/22/2021

8/20/2020

JOB No	###
DATE	8/20/2020
SCALE	See Plans
FILE	FILE

NATURE PLAYSPACE
AUDUBON NATURALIST SOCIETY

DRAWN	JT, ZW
REVISED	12/11/2020

3734 FORT VALLEY RD.
DURHAM NC 27707
919 623 7896
www.litlandscape.com

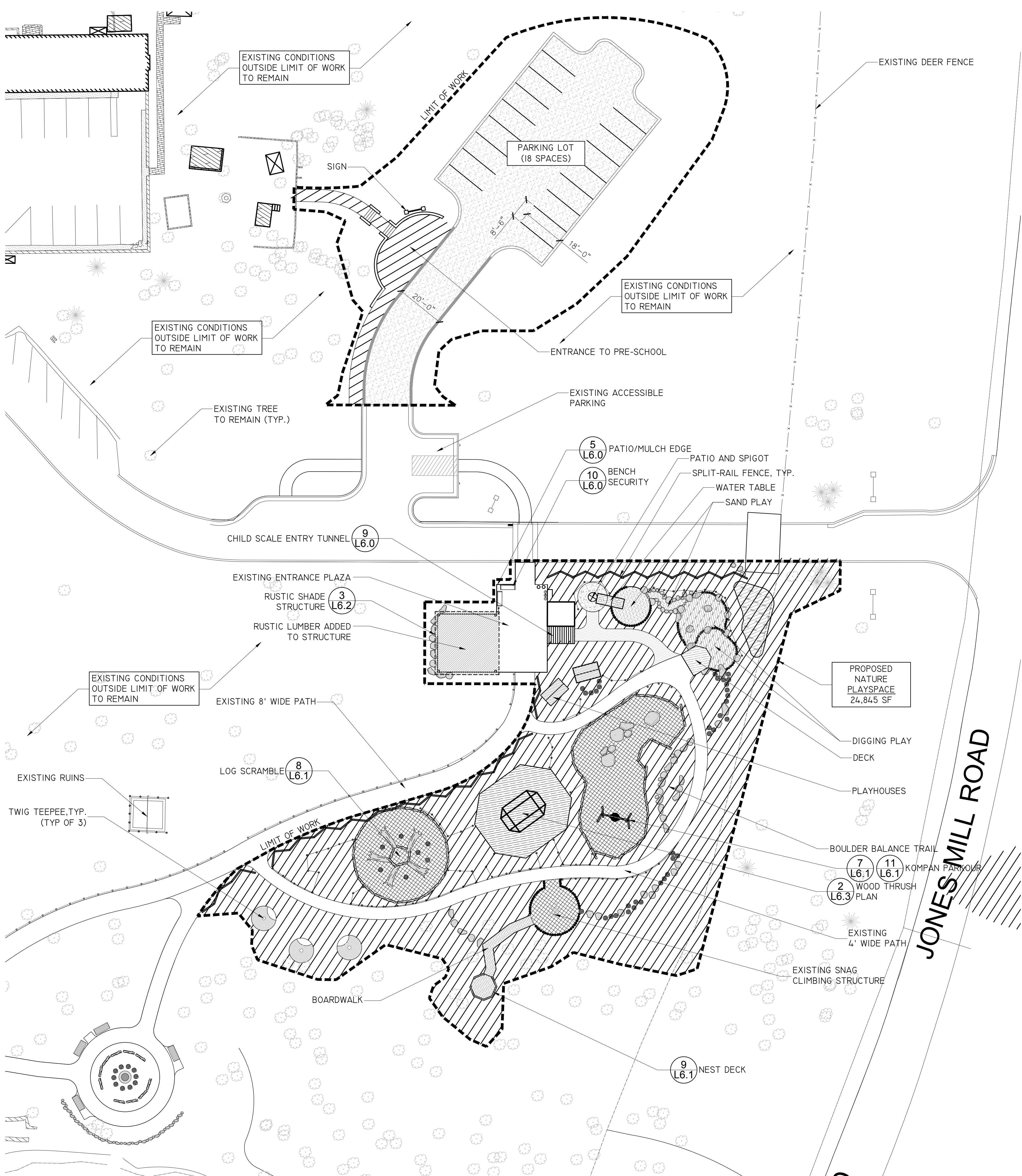

	DESCRIPTION	QUANTITY	NOTES	
	TRIPLE GROUND HARDWOOD MULCH	16,000 SF		
	GRAVEL PARKING	6,350 SF		
	CONCRETE ON STONE BASE	423 SF		
	PLAYGROUND SAFETY MULCH (24" DEEP)	2,987 SF	24" DEPTH	3 L6.0
	PLAYGROUND SAND (24" DEEP)	251 SF	SILICA-FREE QUARTZ SAND	3 L6.0
	DIGGING MEDIA (EARTH PLAY MEDIA)	479 SF		3 L6.0
	TREX DECKING	1,368 SF		
	BONDED GRAVEL	2,318 SF		2 L6.0
	CONCRETE CURBING	407 SF		
	BOULDERS	21 TONS		6 L6.0
	LOCUST LOG	540 LF		7 L6.0
	LOCUST LOG	50 LF		7 L6.0
	LOCUST STUMPS	73		13 L6.0
	LOCUST STUMP EDGERS	500		8 L6.0
	FORT POSTS	15	POSTS WITH BRAILLE MESSAGING ALONG MAIN PATH	12 L6.0
	BRAILLE TRAIL	290 LF		
	POST & ROPE PLANT PROTECTION	417 LF		2 L6.1
	STEPPING STONES	312 LF		1 L6.0
	BENCH	7	6' LONG WINDEMERE BENCH BY COUNTRY CASUAL	2 L6.0
	NEST SWING	2	KOMPAN	6 L6.1
	WATER PUMP AND TABLE	1		5 L6.1
	CHALKBOARD	1		3 L6.1
	SPLIT RAIL FENCE	270 LF		
	TWIG TEEPEE	3		10 L6.1
	PRESCHOOL ENTRANCE SIGN	1		
	WEAVING WALL	1		

LEGEND

LIMIT OF WORK

EXISTING DEER FENCE

EXISTING TREE

BOULDERS

BENCH

STUMPS

LOGS

POST & ROPE

STEPPING STONES

POSTS

BRAILLE TRAIL

SPLIT RAIL LOCUST FENCE

KEY

FEATURES TO BE REVIEWED

PROFESSIONAL CERTIFICATION

I HEREBY CERTIFY THAT THESE DOCUMENTS WERE PREPARED OR APPROVED BY ME, AND THAT I AM A DULY LICENSED PROFESSIONAL UNDER THE LAWS OF THE STATE OF MARYLAND.

LICENSE NO. 3987
EXPIRATION DATE: 6/22/2021

8/20/2020

N

0' 10' 20' 40'
SCALE: 1"=20'

APPROVAL DRAWINGS

DRAWN	JT, ZW
REVISED	12/11/2020

3124 NORTH VALLEY RD.
DURHAM, NC 27707
919.623.7896
www.litlandscape.com

JOB No	###
DATE	8/20/2020
SCALE	See Plans
FILE	

NATURE PLAYSPACE
AUDUBON NATURALIST SOCIETY

L SITE PLAN
2.0



PLANTING SCHEDULE							
CODE	QTY	SCIENTIFIC NAME	COMMON NAME	SIZE	MIN HT	MIN WD	NOTES AND MINIMUM SPACING
CANOPY TREES							
AR	8	ACER RUBRUM	RED MAPLE	7GAL	6'	3'	SEE PLAN
BN	1	BETULA NIGRA	RIVER BIRCH	5GAL	5'	3'	SEE PLAN
MV	4	MAGNOLIA VIRGINIANA	SWEETBAY MAGNOLIA	7GAL	6'	3'	SEE PLAN
PO	3	PLATANUS OCCIDENTALIS	SYCAMORE	BB	5'	3'	SEE PLAN
UAP	5	ULMUS AMERICANA 'PRINCETON'	PRINCETON ELM	BB	8'	4'	SEE PLAN
UNDERSTORY TREES							
AL	9	AMELANCHIER LAEVIS	SERVICEBERRY	7GAL	5'	3'	SEE PLAN
CC	7	CERCIS CANADENSIS	REDBUD	7GAL	5'	3'	SEE PLAN
IO	10	ILEX OPACA	AMERICAN HOLLY	5GAL	5'	3'	SEE PLAN
JV	6	JUNIPERUS VIRGINIANA	RED CEDAR	7GAL	5'	3'	10' O.C.
SHRUBS							
CF	26	CALYCANTHUS FLORIDUS	SWEETSHRUB	1 GAL	1'	N/A	7' O.C.
IG	45	ILEX GLABRA	INKBERRY	3GAL	1'	1'	5' O.C.
ILH	134	ITEA VIRGINICA 'LITTLE HENRY'	LITTLE HENRY ITEA	3GAL	18"	1'	2' O.C.
HA	45	HYDRANGEA ARBORESCENS	SMOOTH HYDRANGEA	3GAL	2'	1'	5' O.C.
VD	4	VIBURNUM DENTATUM	SOUTHERN ARROWWOOD	3GAL	3'	1'	10' O.C.
HERBACEOUS							
CP	83	CAREX PENSYLVANICA	PENNSYLVANIA SEDGE	72 PLUG	N/A	N/A	2' O.C.
PVS	42	PANICUM VIRGATUM 'SHENANDOAH'	SHENANDOAH SWITCHGRASS	72 PLUG	N/A	N/A	3' O.C.
MIX							
AC	65	AQUILEGIA CANADENSIS	COLUMBINE	50 PLUG	N/A	N/A	3' O.C.
ASL	65	ASTER LAEVIS	SMOOTH ASTER				
COV	65	COREOPSIS VERTICILATA	TICKSEED	SEED	N/A	N/A	N/A
RF	65	RUDBECKIA FULGIDA	BLACK-EYED SUSAN	50 PLUG	N/A	N/A	3' O.C.

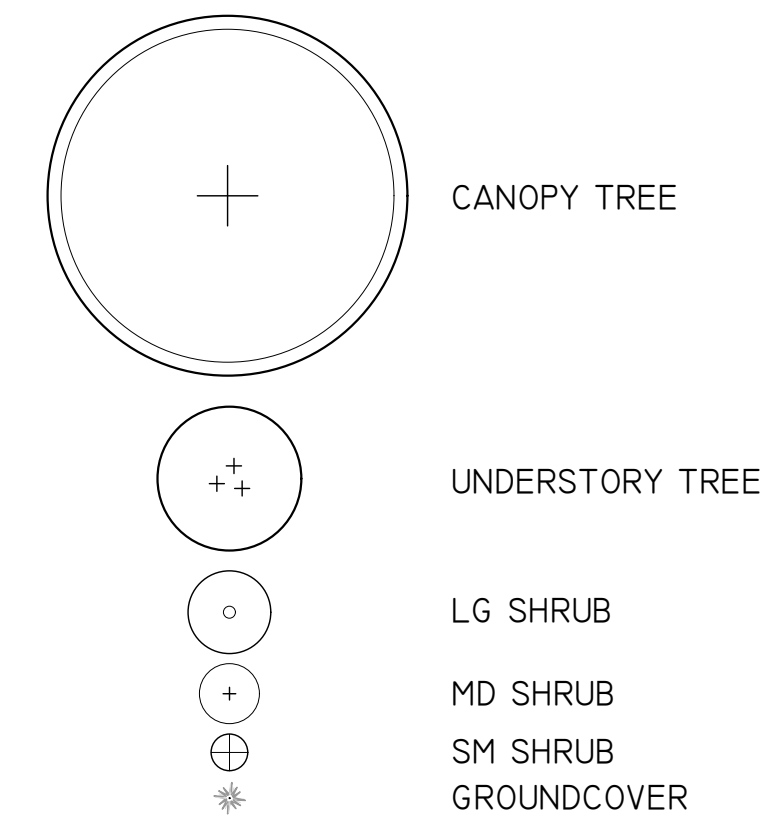

JONES MILL

PROFESSIONAL CERTIFICATION

I HEREBY CERTIFY THAT THESE DOCUMENTS
WERE PREPARED OR APPROVED BY ME, AND
THAT I AM A DULY LICENSED PROFESSIONAL
UNDER THE LAWS OF THE STATE OF
MARYLAND.

LICENSE NO. 3987

EXPIRATION DATE: 6/22/2021

The seal is circular with a double-lined border. The outer ring contains the text "STATE OF MARYLAND" at the top and "INCORPORATED ARCHITECTS" at the bottom. Inside this ring is a smaller circle containing a globe. Overlaid on the globe is a large, stylized compass needle pointing towards the upper right. The year "1827" is inscribed at the bottom of the inner circle.

8/20/2020

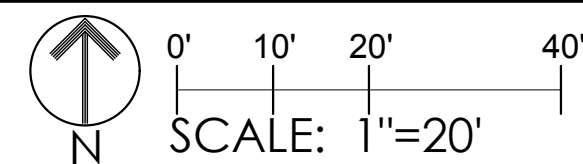

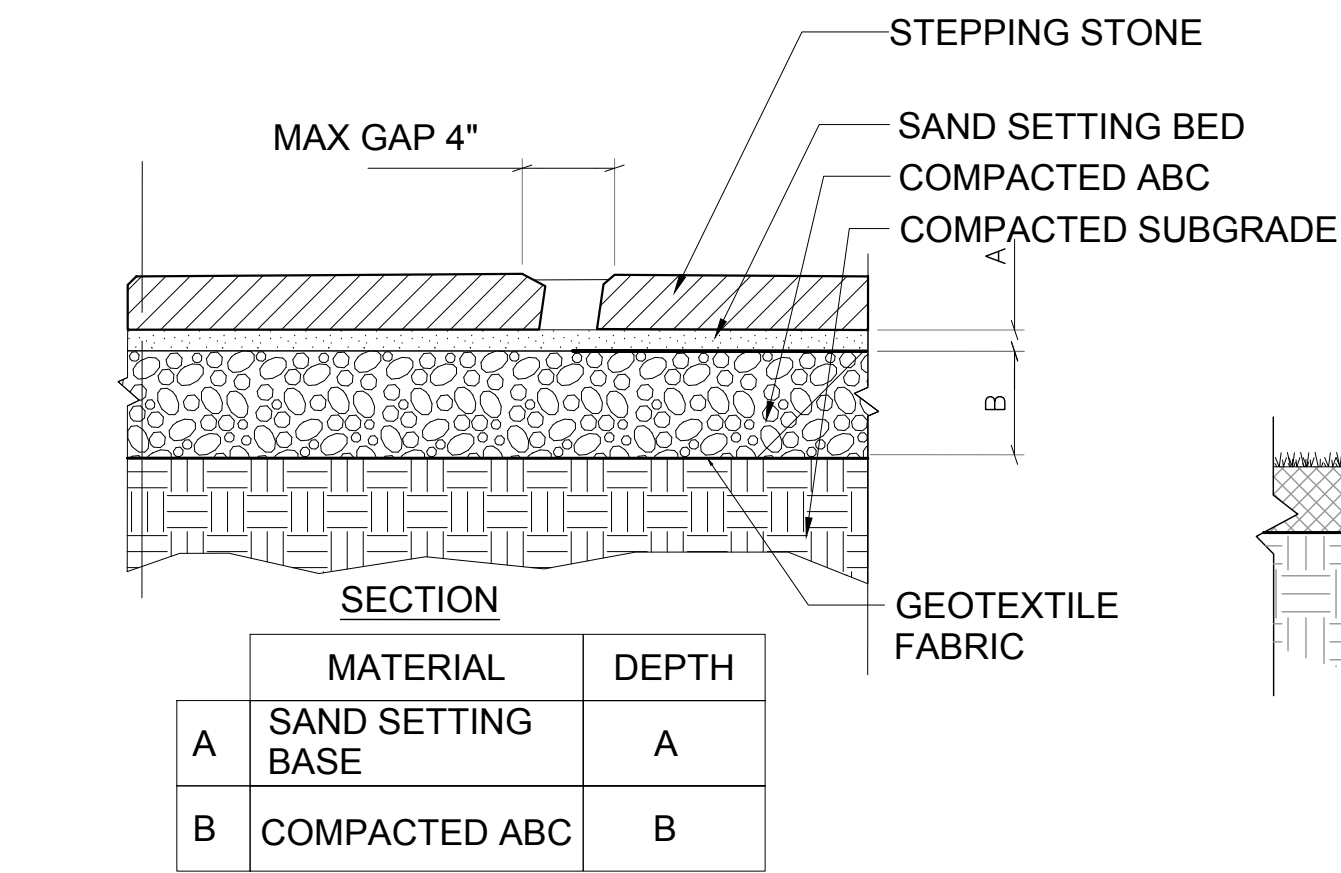

1 STEPPING STONE NTS

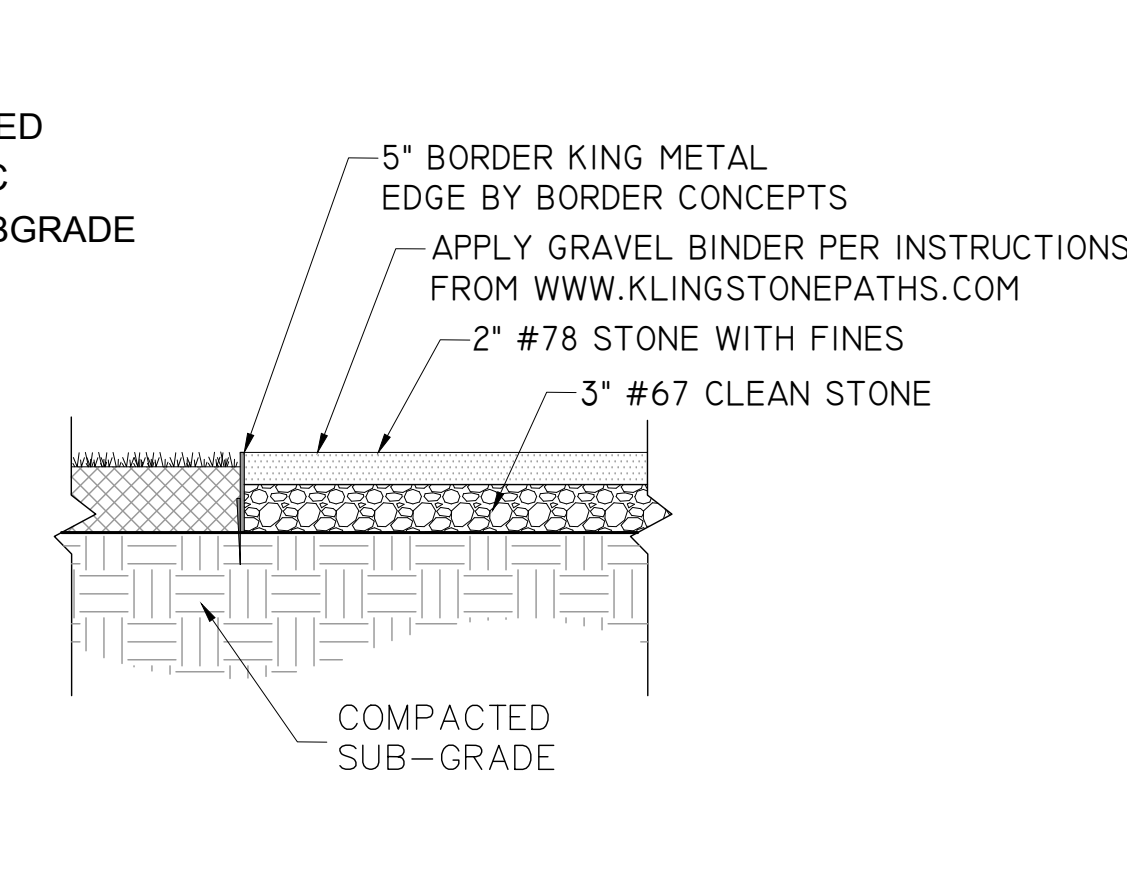

2 BONDED GRAVEL WITH METAL EDGING SCALE: 1" = 1'

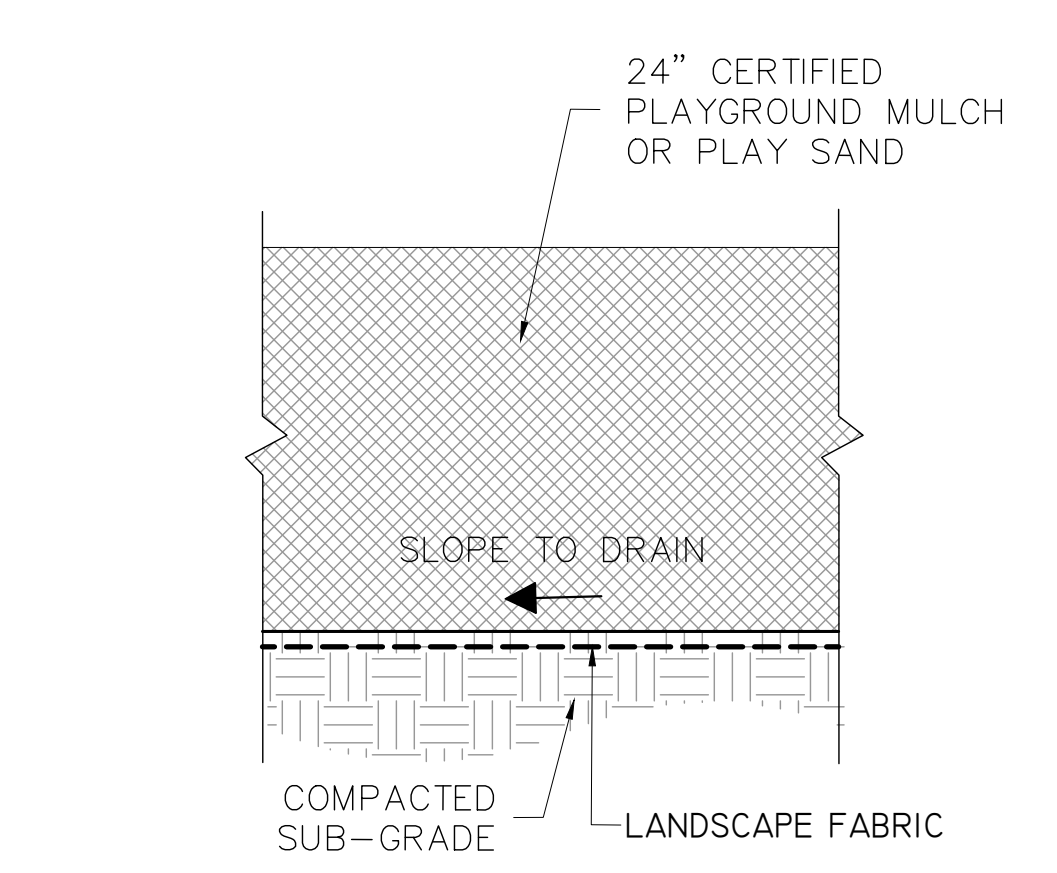

3 CERTIFIED PLAYGROUND MULCH OR PLAY SAND SCALE: 1" = 1'

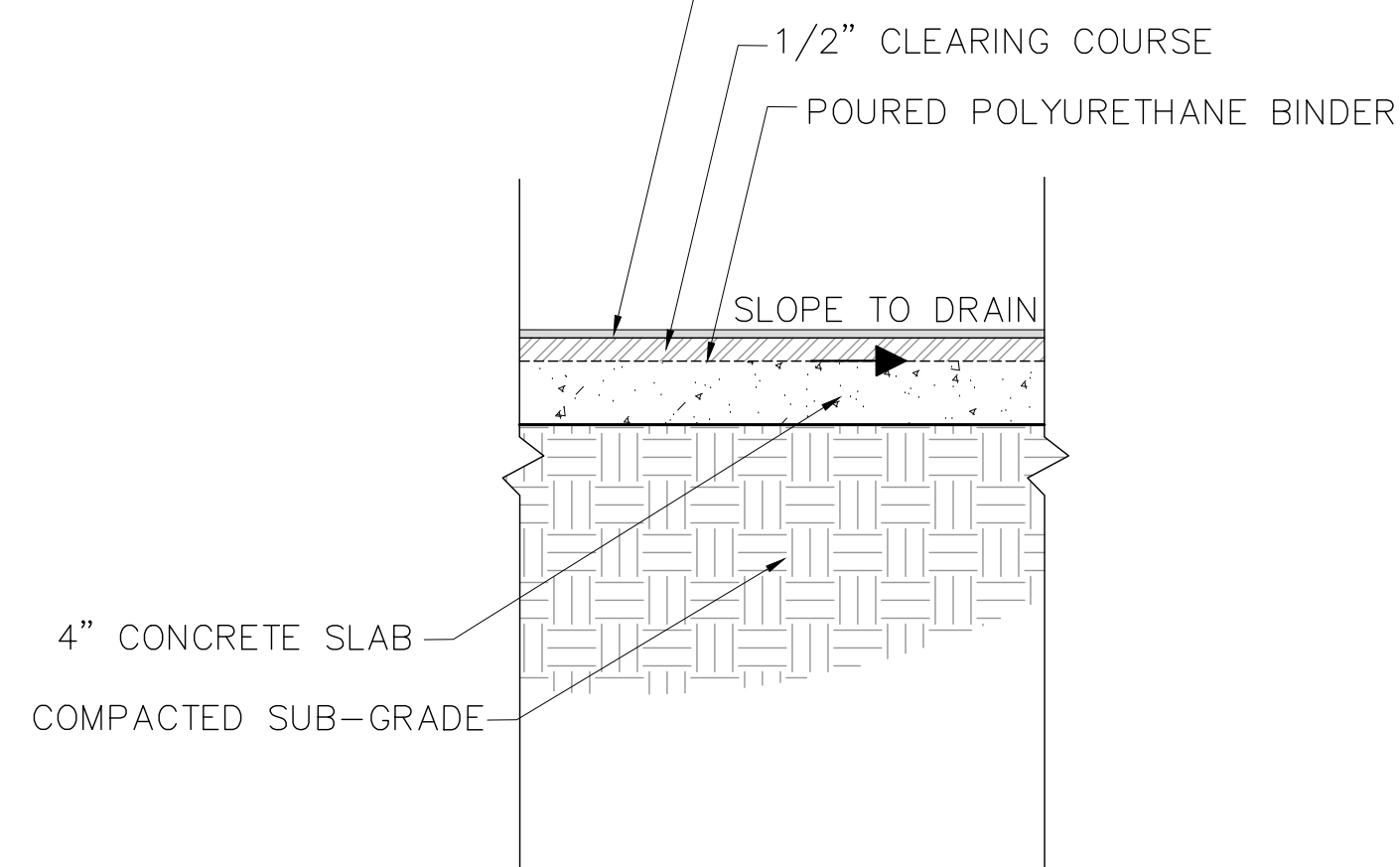

4 POURED IN PLACE RUBBER SAFETY SURFACE SCALE: 1" = 1'

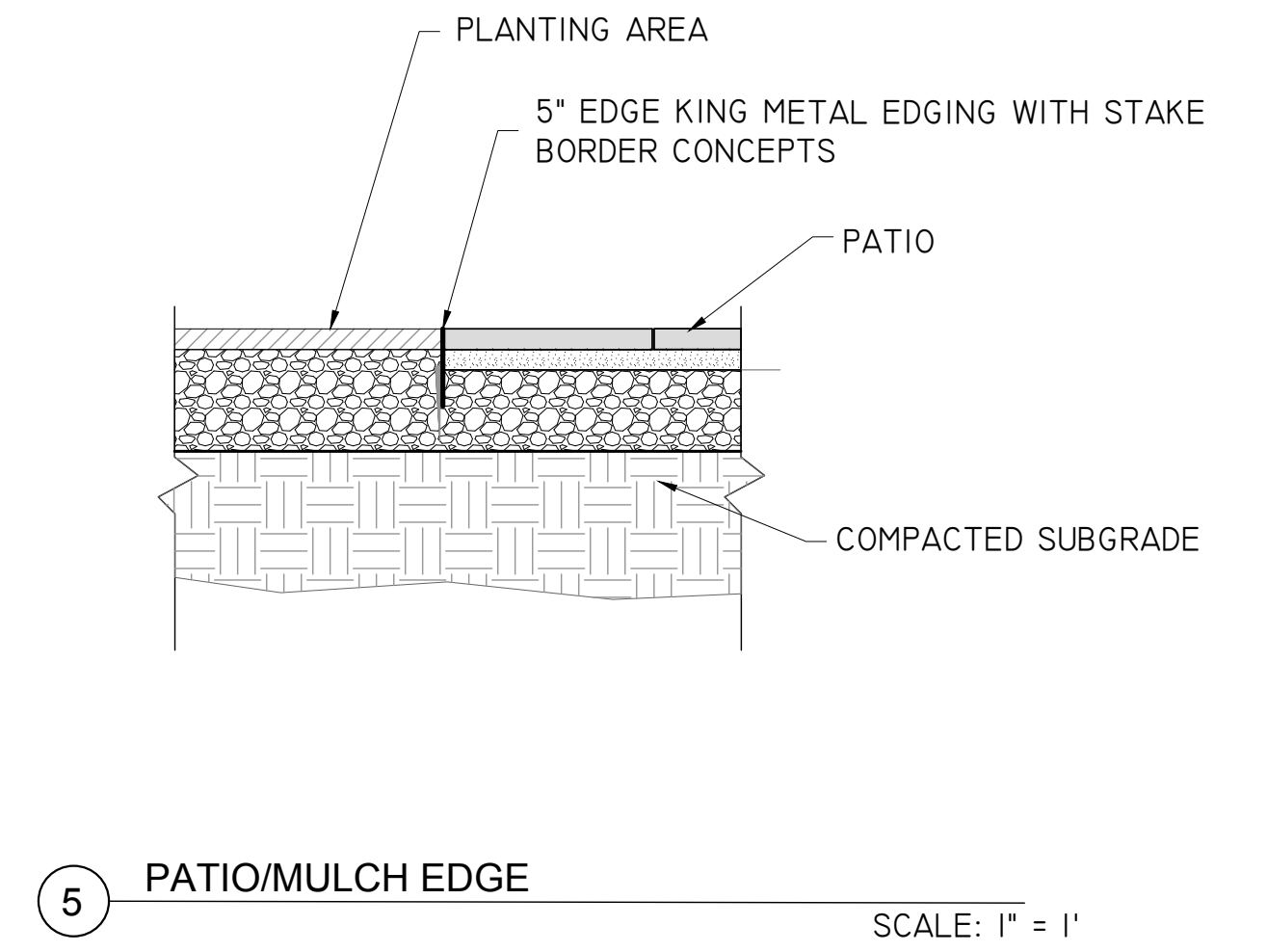

5 PATIO/MULCH EDGE SCALE: 1" = 1'

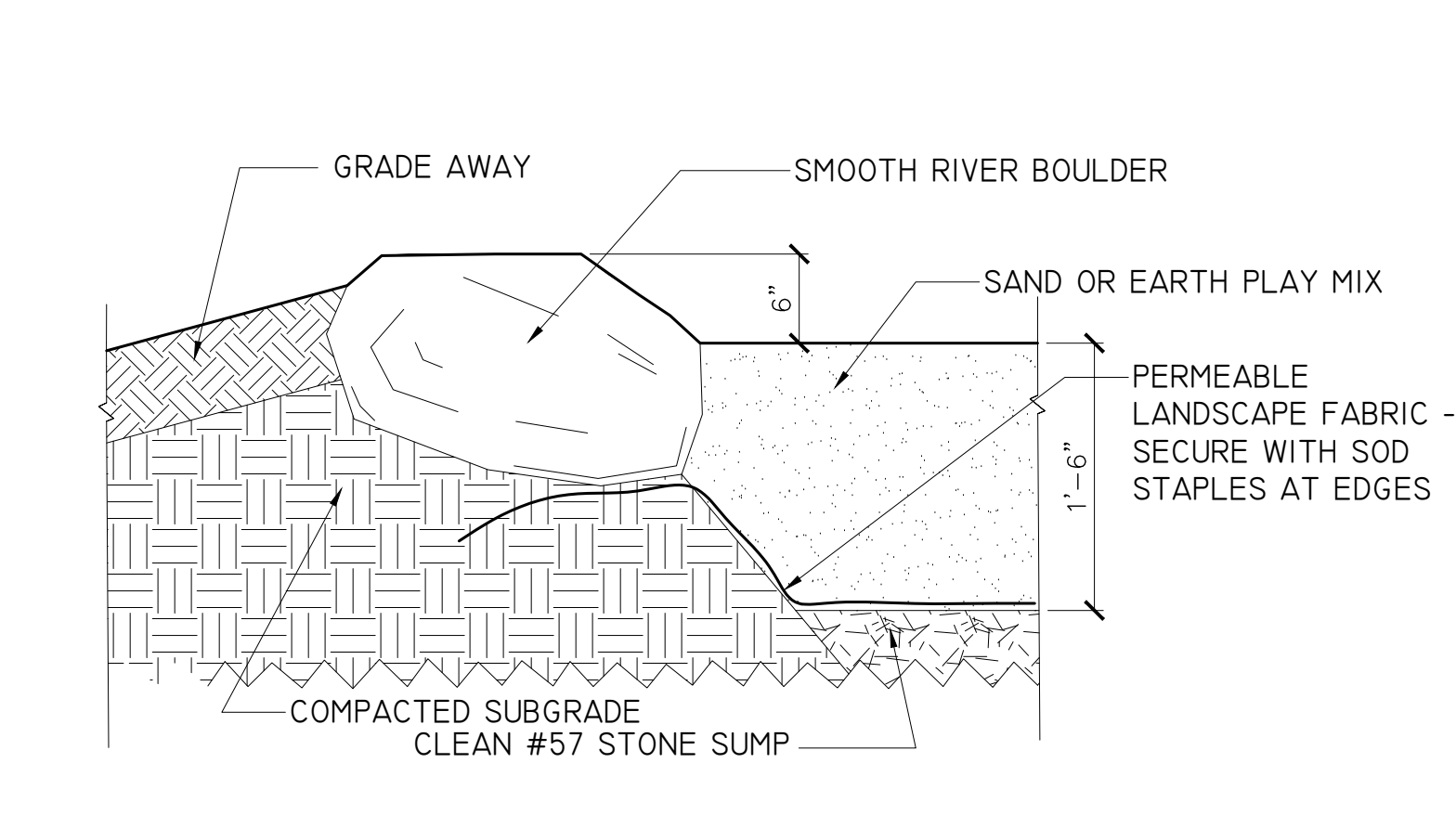

6 BOULDER EDGING SCALE: 1" = 1'

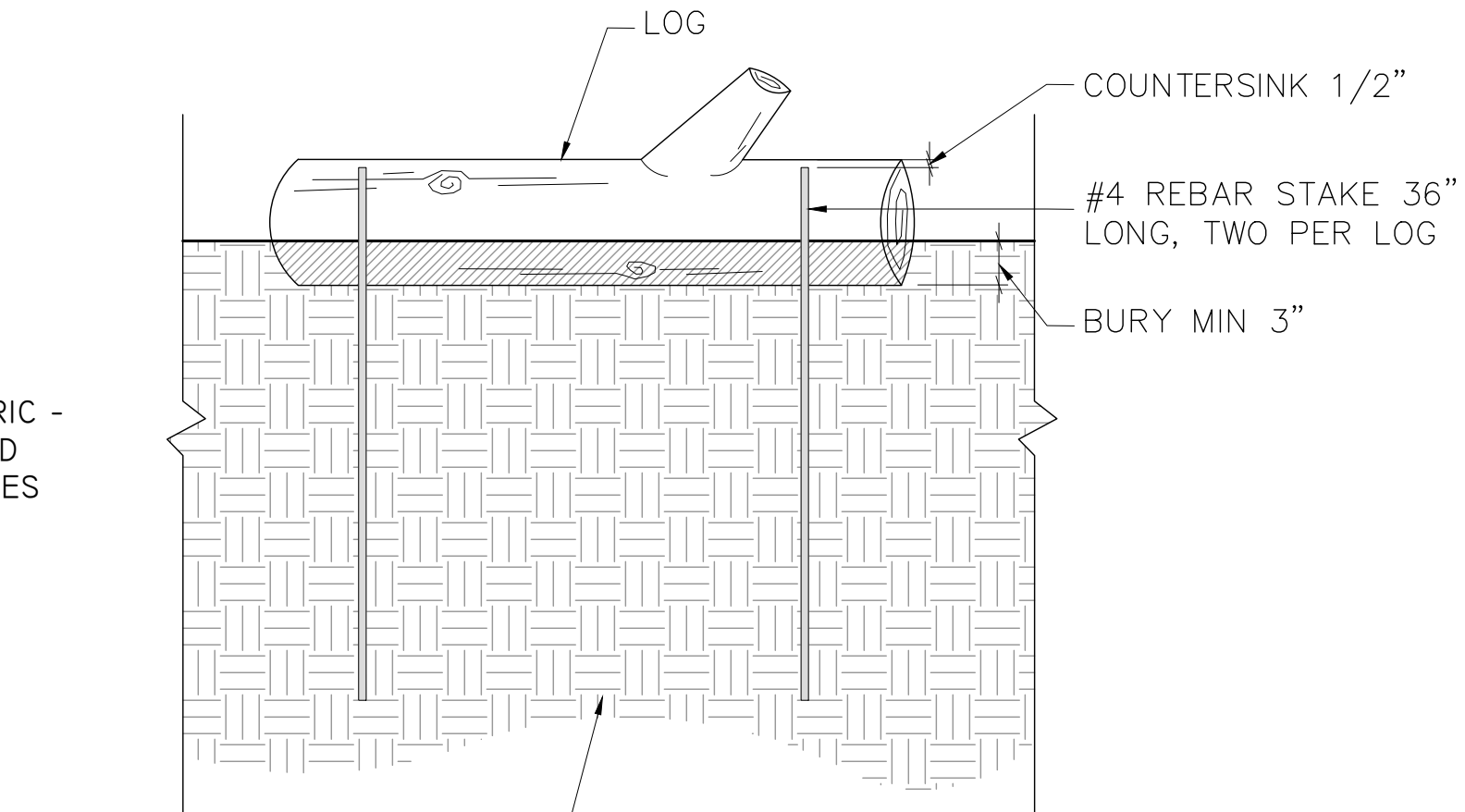

7 LOG EDGING SCALE: 1" = 1'

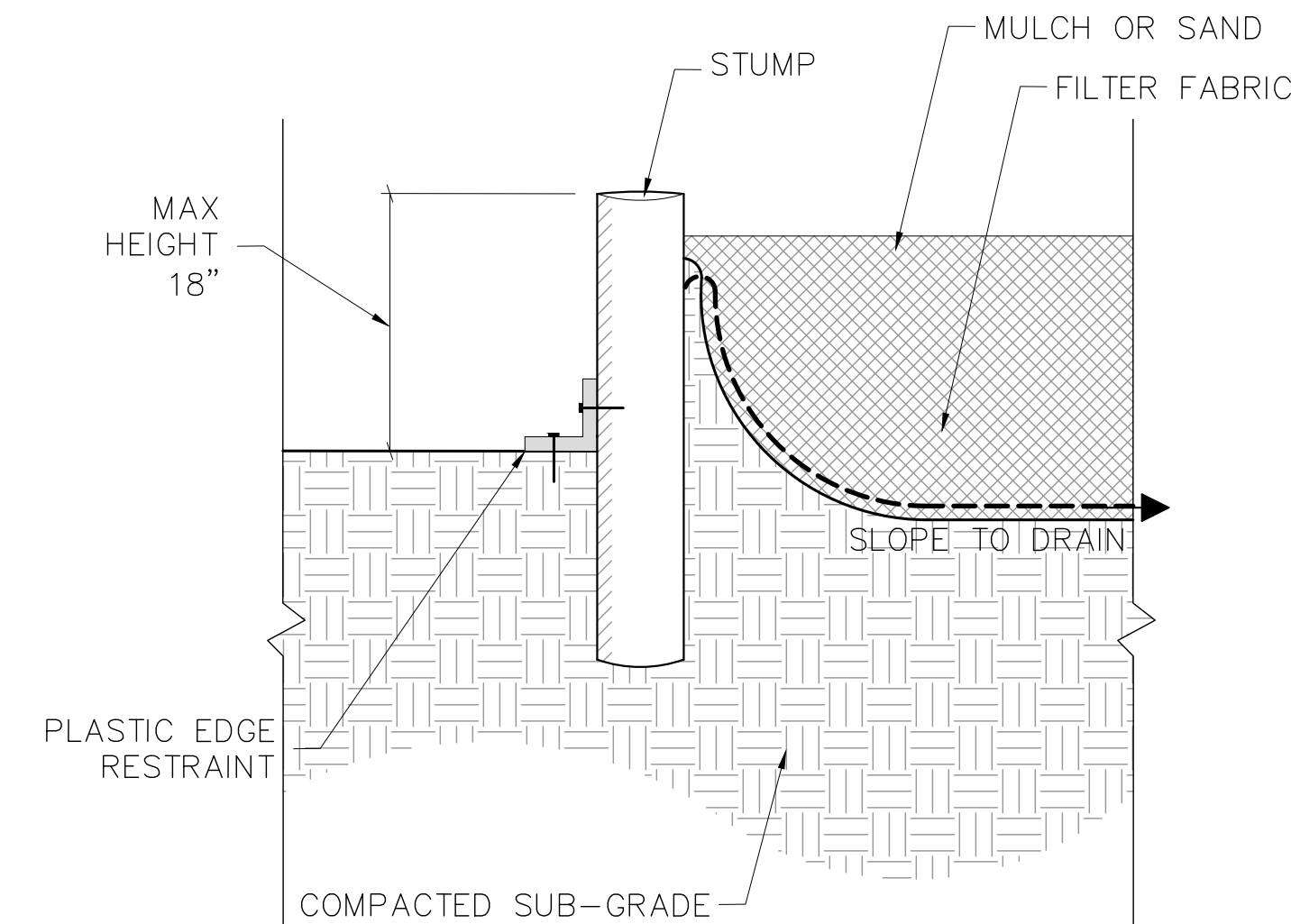

8 STUMP EDGING SCALE: 1" = 1'

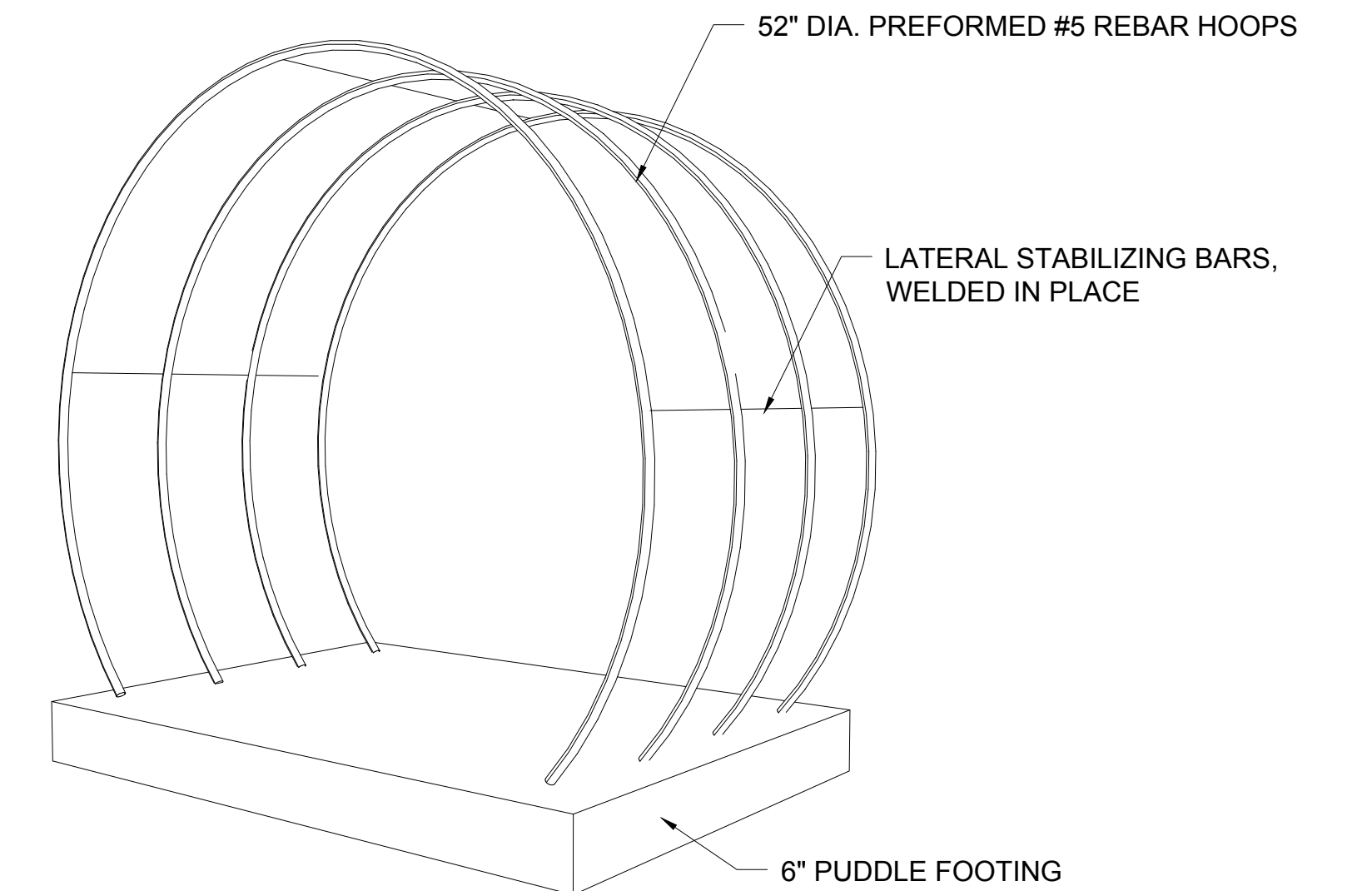

9 CHILD SCALE ENTRY TUNNEL SCALE: 1" = 1'

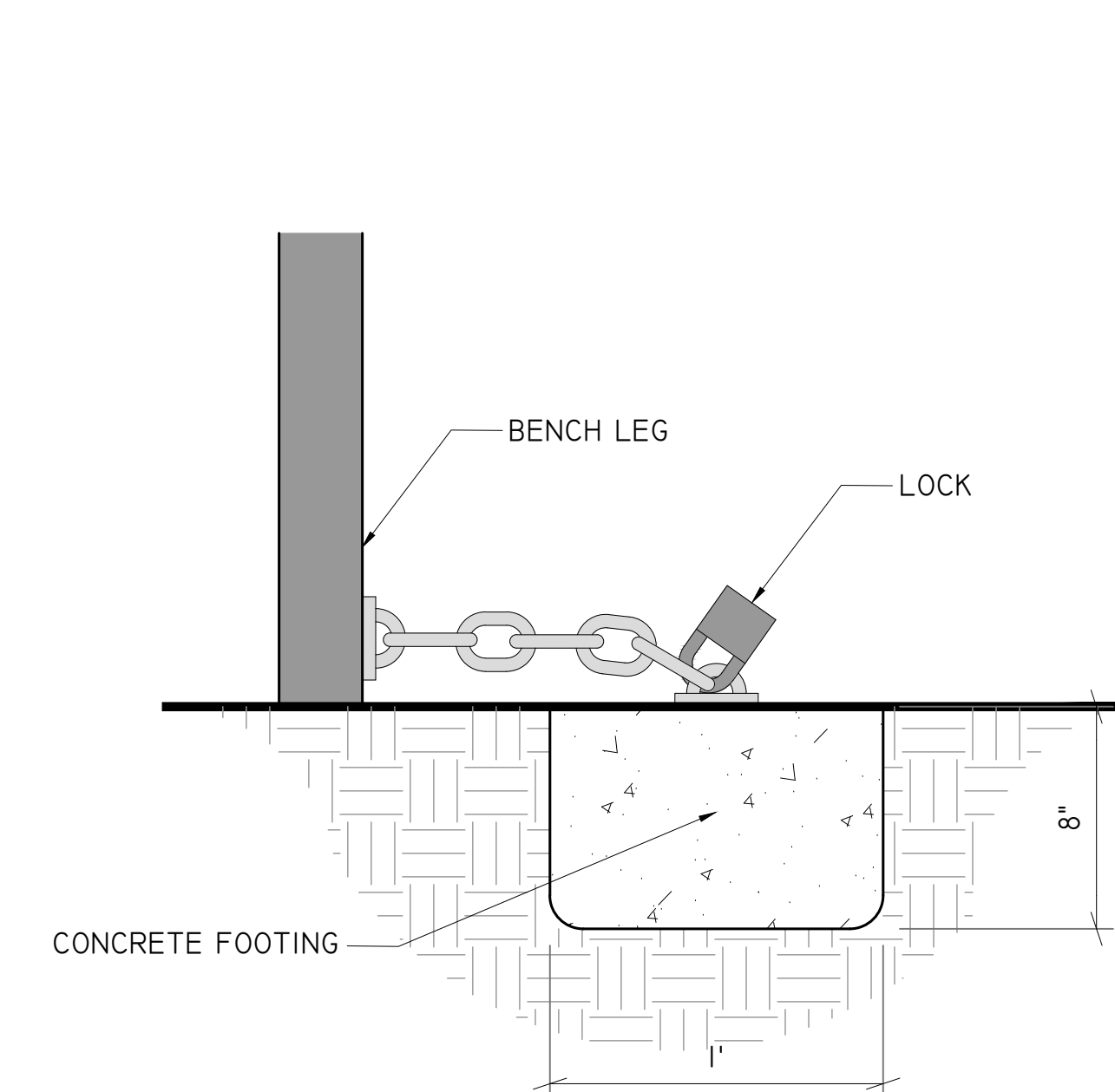

10 BENCH SECURITY SCALE: 1/2" = 1'

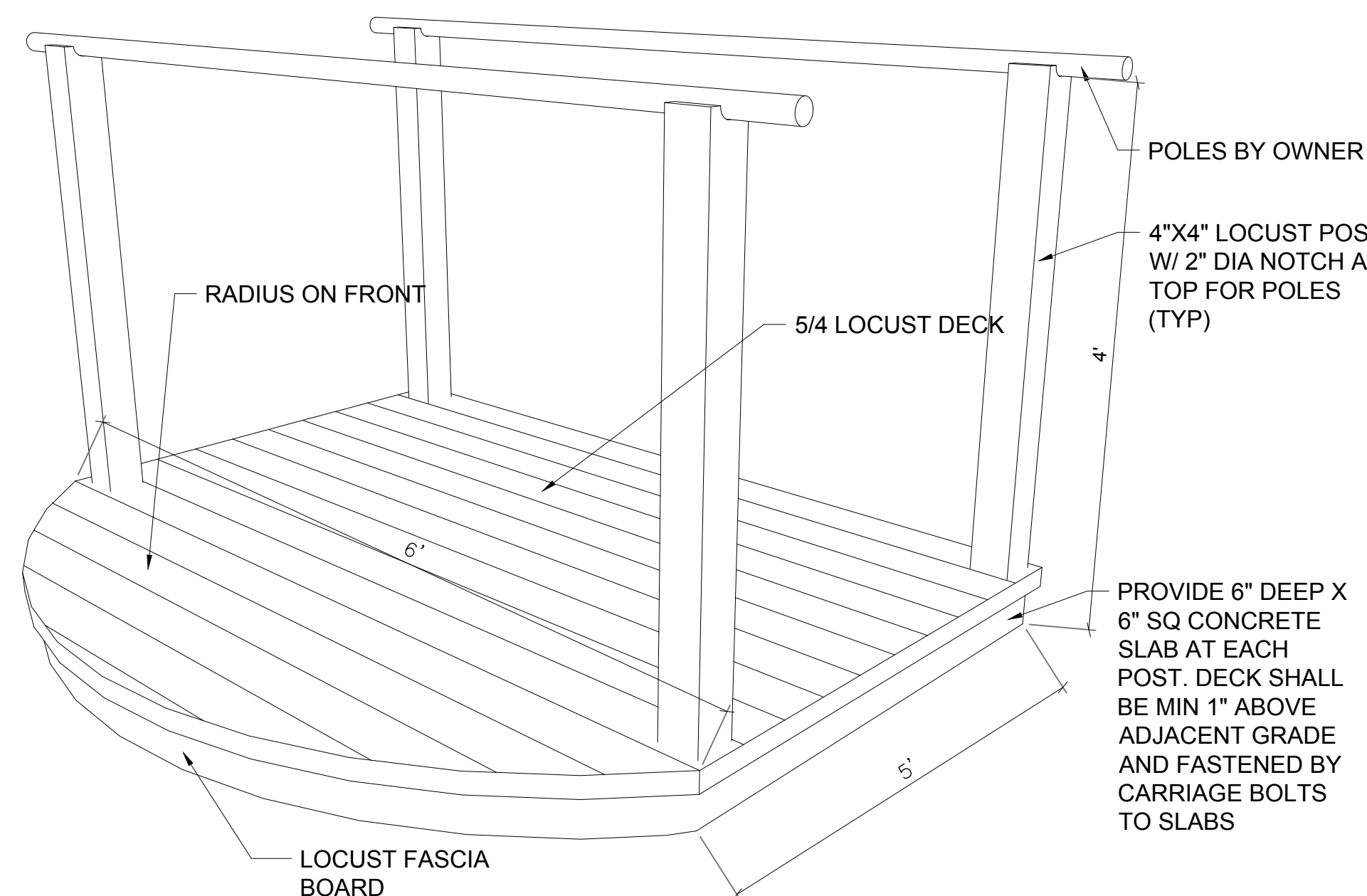

11 PLAY DECK NTS

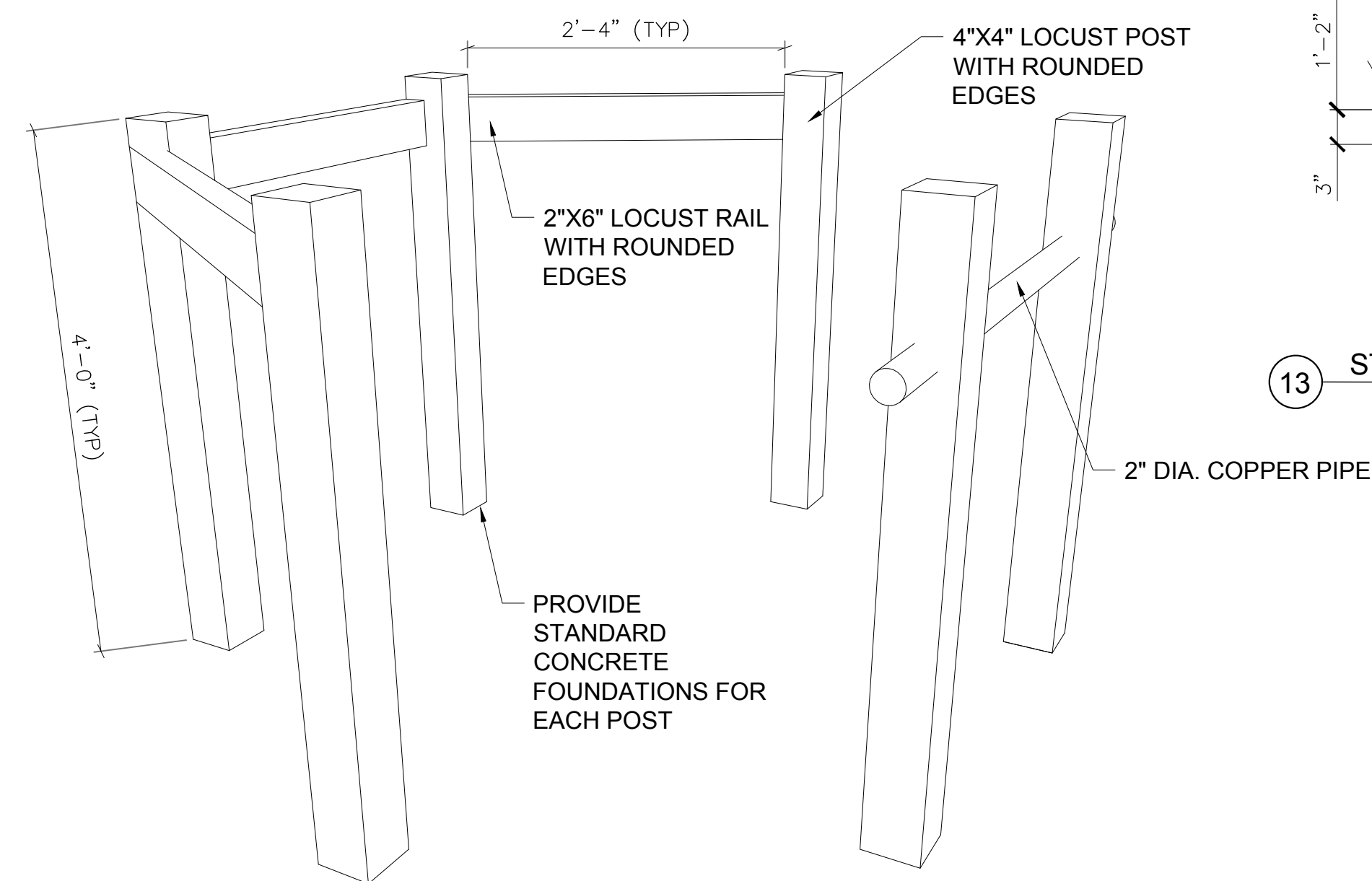

12 FORT START SCAFFOLDING NTS

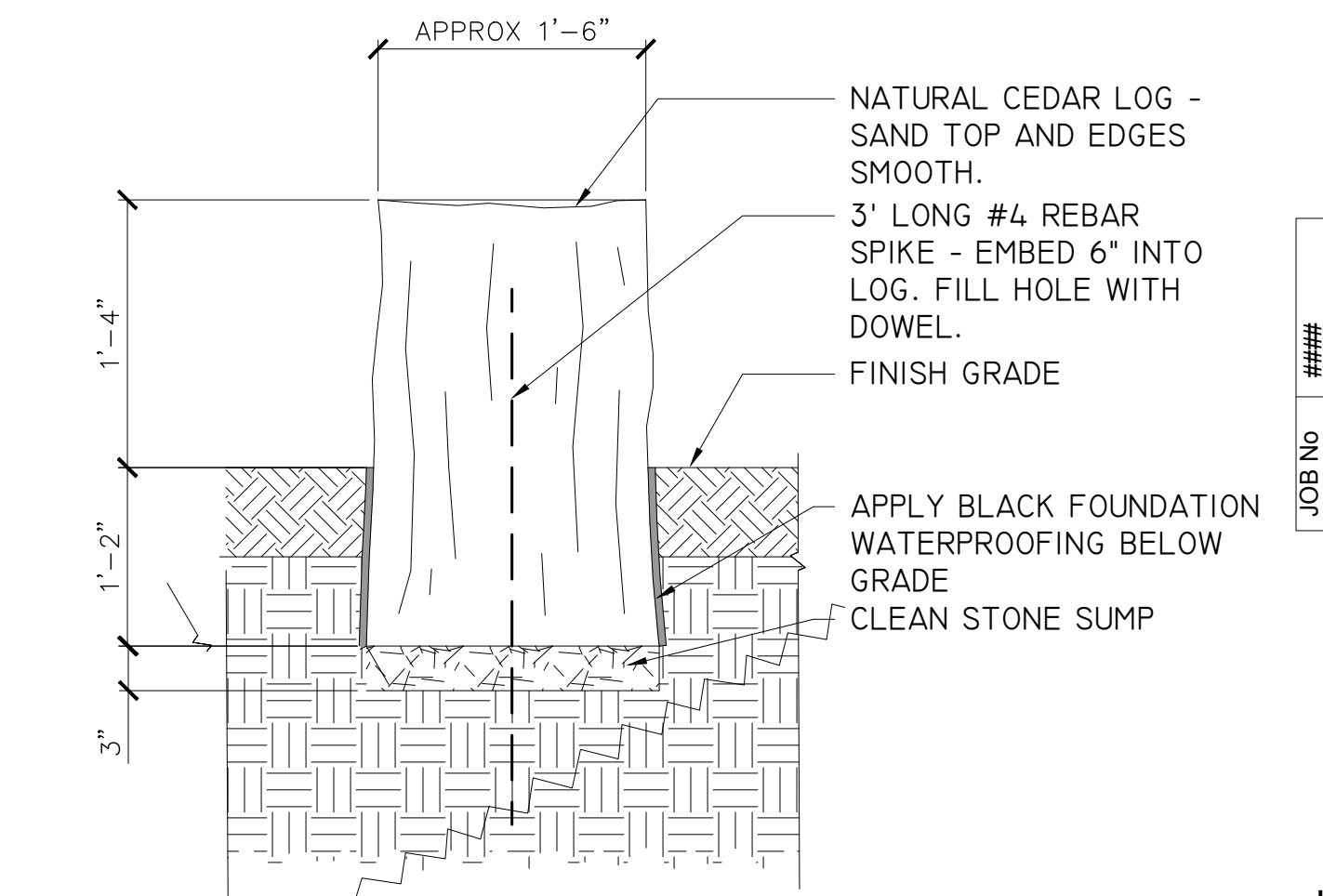

13 STUMP SEAT NTS

PROFESSIONAL CERTIFICATION
 I HEREBY CERTIFY THAT THESE DOCUMENTS WERE PREPARED OR APPROVED BY ME, AND THAT I AM A DULY LICENSED PROFESSIONAL UNDER THE LAWS OF THE STATE OF MARYLAND.

LICENSE NO. 3987
 EXPIRATION DATE: 6/22/2021

8/20/2020

APPROVAL DRAWINGS

DRAWN	JT, ZW
REvised	12/11/2020

3128 HOPKINS VALLEY RD.
 DUNELAND, NC 27027
 918.827.7886
 www.thelandscaper.com

JOB No	###	DATE	SCALE	FILE
		8/20/2020		See Plans

NATURE PLAYSPACE
 AUDUBON NATURALIST SOCIETY

DETAILS
 6.0



1 PLAYHOUSE NTS



2 POST AND ROPE PLANT PROTECTION NTS



3 RUSTIC CHALKBOARD NTS



4 LOG CIRCLE NTS



5 WATER PLAY PUMP, TABLE, AND SLUICEWAY NTS



8 LOG SCRAMBLE NTS



9 NEST DECK NTS



10 VINE TEEPEE NTS



11 BOULDER SCRAMBLE ALTERNATE NTS

NRO854
Parkour 004

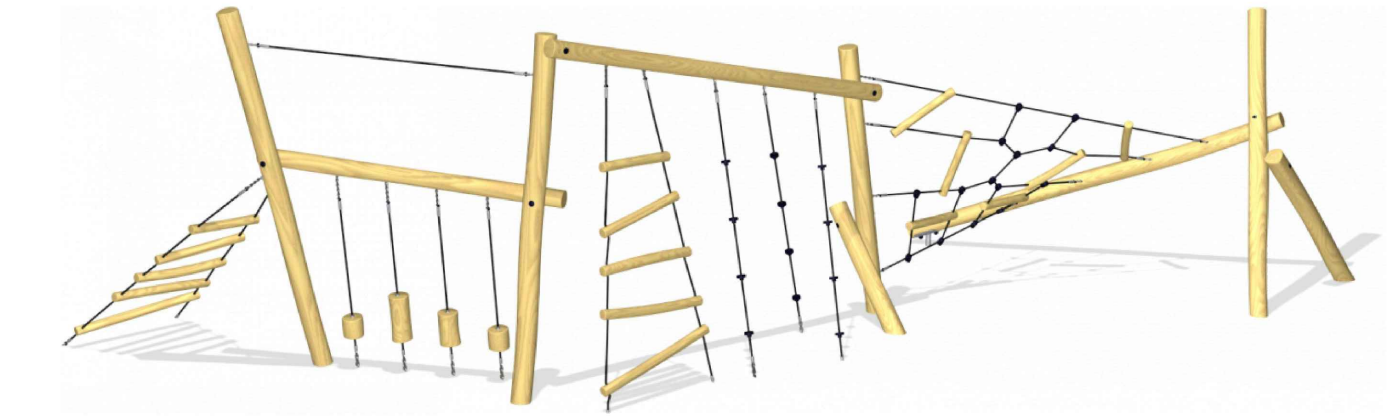

Elevated Activities: 0	Accessible Elevated Activities	Accessible Ground Level Activities	Accessible Ground Level Play Types
Present	0	4	2
Required	0	2	2

Product line	Organic Robinia
Product category	Traditional play, Sand and water play
Best user age	5 - 12
Max. fall height (Feet)	257
Total height (Feet)	273
Safety zone area	64.6 m2

This play structure provides many challenges for the children climbing up to the platform overlooking the playground. All the additional play equipment such as Parcours posts on ropes, Twisted climbing net, Parcours climbing knots, ladder are focused on climbing in general, there we have a climbing ropes and climbing nets and ladder. This structure also offers a lot of climbing challenges thus altering the rhythm of the climbing movement and training balance and coordination skills.



BALANCING CLIMBING

KOMPAN INC., 821 Grand Avenue Parkway
Pflugerville, TX 78660 | Phone: 1 (800) 426-9788 |
USSales@KOMPAN.COM | www.KOMPAN.us

KOMPAN FSC License No. FSC-C023002 / www.fsc.org
The mark of responsible forestry

7 KOMPAN PARKOUR 004 NTS

PROFESSIONAL
CERTIFICATION
I HEREBY CERTIFY THAT THESE DOCUMENTS
WERE PREPARED OR APPROVED BY ME, AND
THAT I AM A DULY LICENSED PROFESSIONAL
UNDER THE LAWS OF THE STATE OF
MARYLAND.

LICENSE NO. 3987
EXPIRATION DATE: 6/22/2021

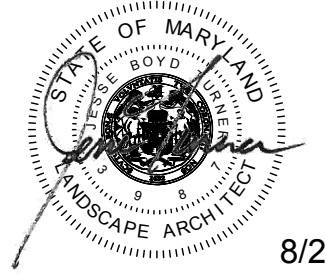

8/20/2020

APPROVAL DRAWINGS

DRAWN	JT, ZW
REVISD	12/11/2020

3134 NORTH VALLEY RD.
DURHAM, NC 27707
919 623 7886
www.liftedlandscape.com

JOB No	DATE	SCALE	FILE
###	8/20/2020	SCALE	See Plans

NATURE PLAYSPACE
AUDUBON NATURALIST SOCIETY

DETAILS

6.1



1 PERSPECTIVE 1
NTS

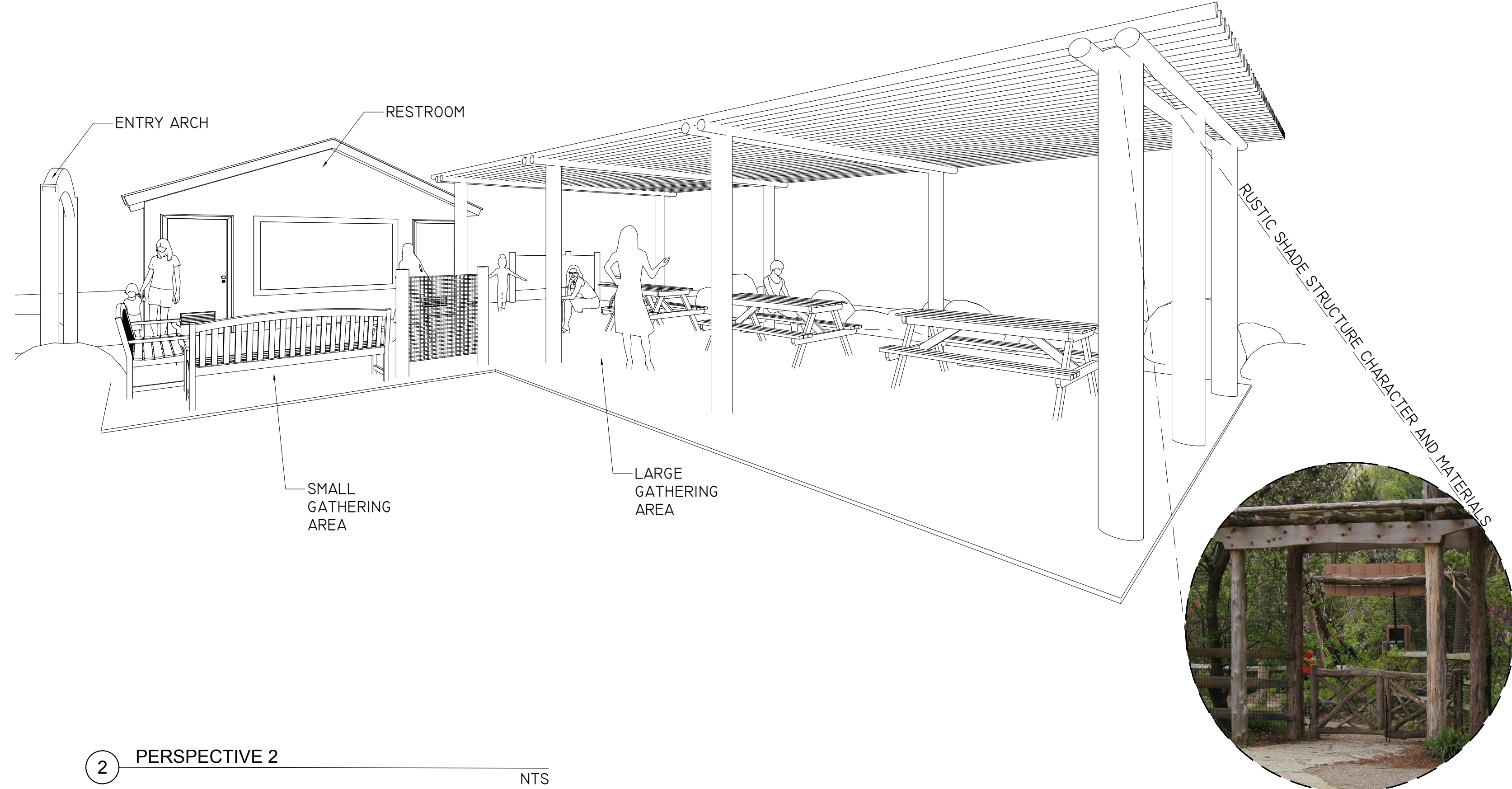

2 PERSPECTIVE 2
NTS

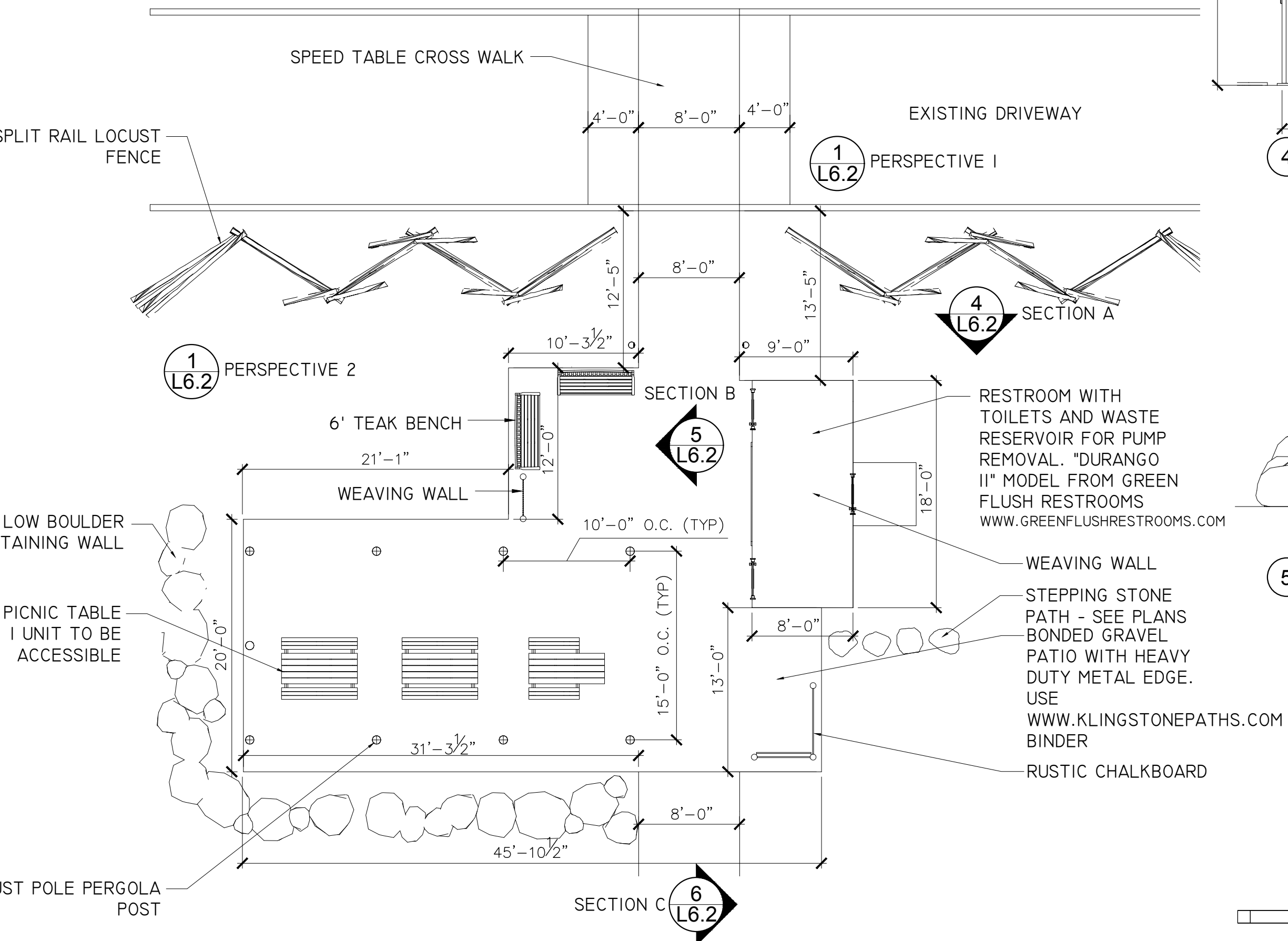

3 ENTRANCE PLAN
NTS

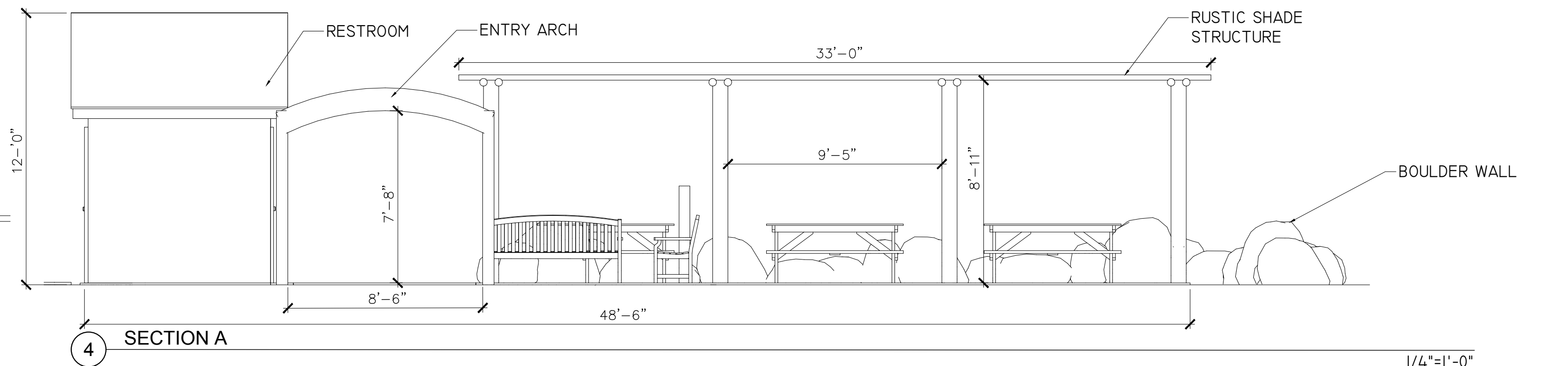

4 SECTION A

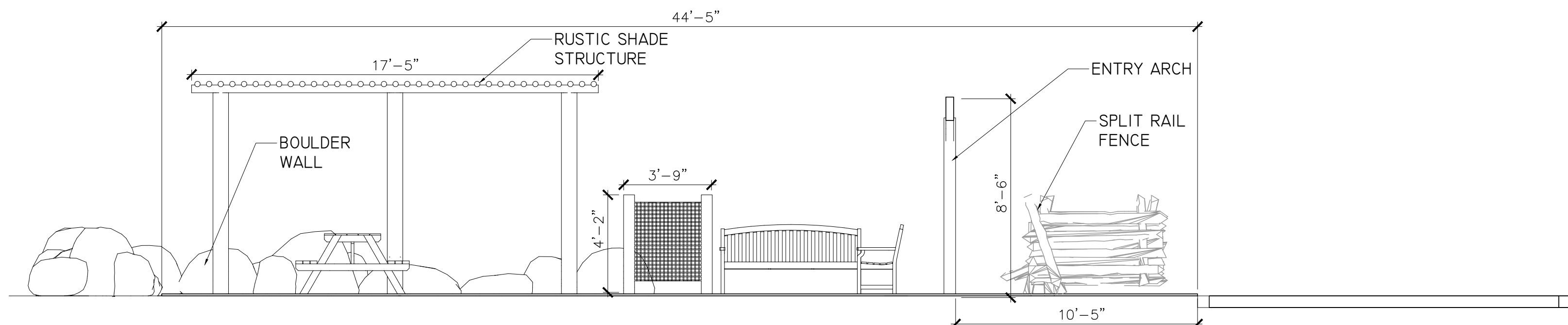

5 SECTION B

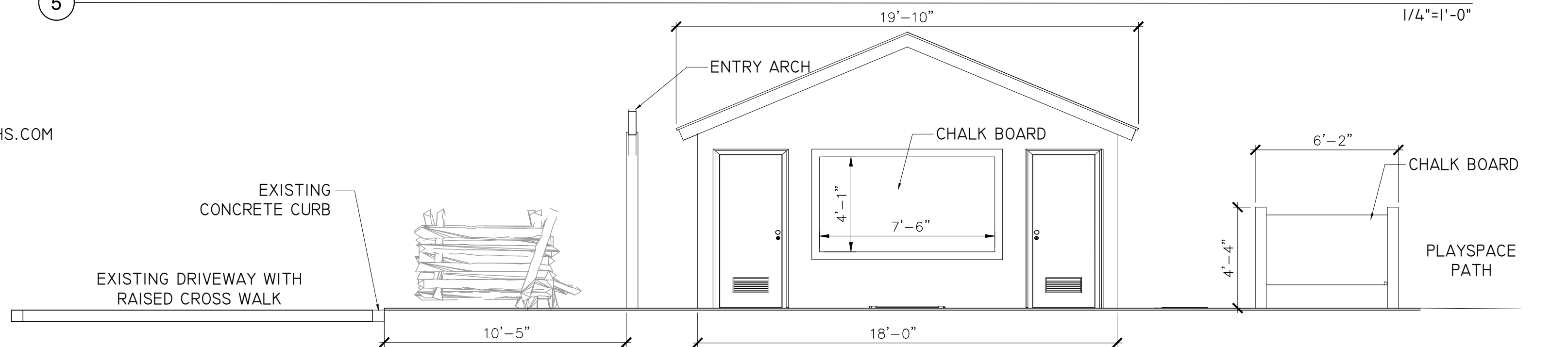

6 SECTION C

PROFESSIONAL CERTIFICATION
I HEREBY CERTIFY THAT THESE DOCUMENTS WERE PREPARED OR APPROVED BY ME, AND THAT I AM A DULY LICENSED PROFESSIONAL UNDER THE LAWS OF THE STATE OF MARYLAND.

LICENSE NO. 3987
EXPIRATION DATE: 6/22/2021

 8/20/2020

APPROVAL DRAWINGS

DRAWN	JT, ZW
REVISED	12/11/2020

3734 HOPKINS VALLEY RD.
DURHAM, NC 27707
919.623.7896
www.landscape.com

JOB No	###	DATE	SCALE	FILE
		8/20/2020		See Plans

NATURE PLAYSPACE
AUDUBON NATURALIST SOCIETY

DETAILS
6.2

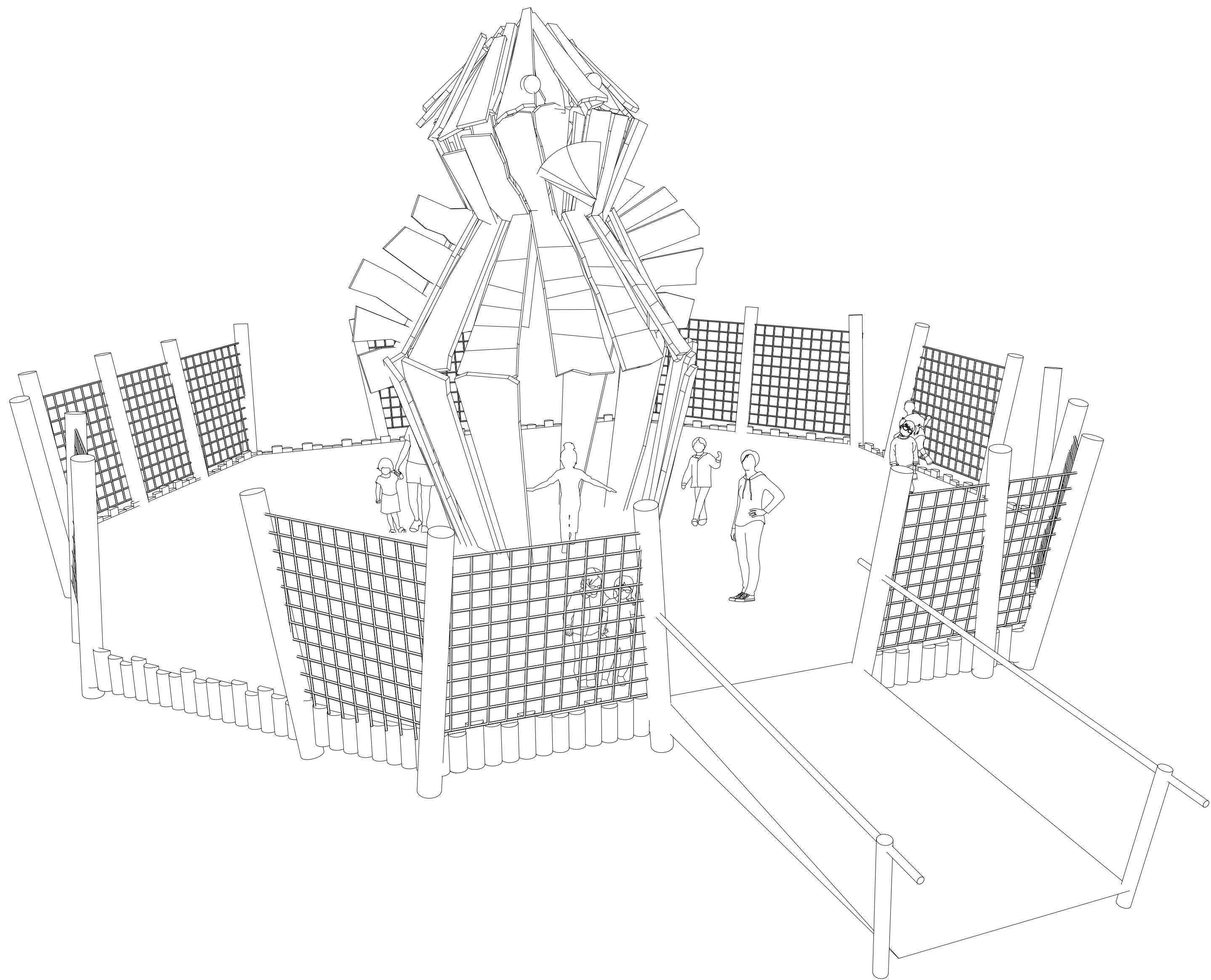

1 PERSPECTIVE NTS

SIDE ELEVATION 3 L6.3

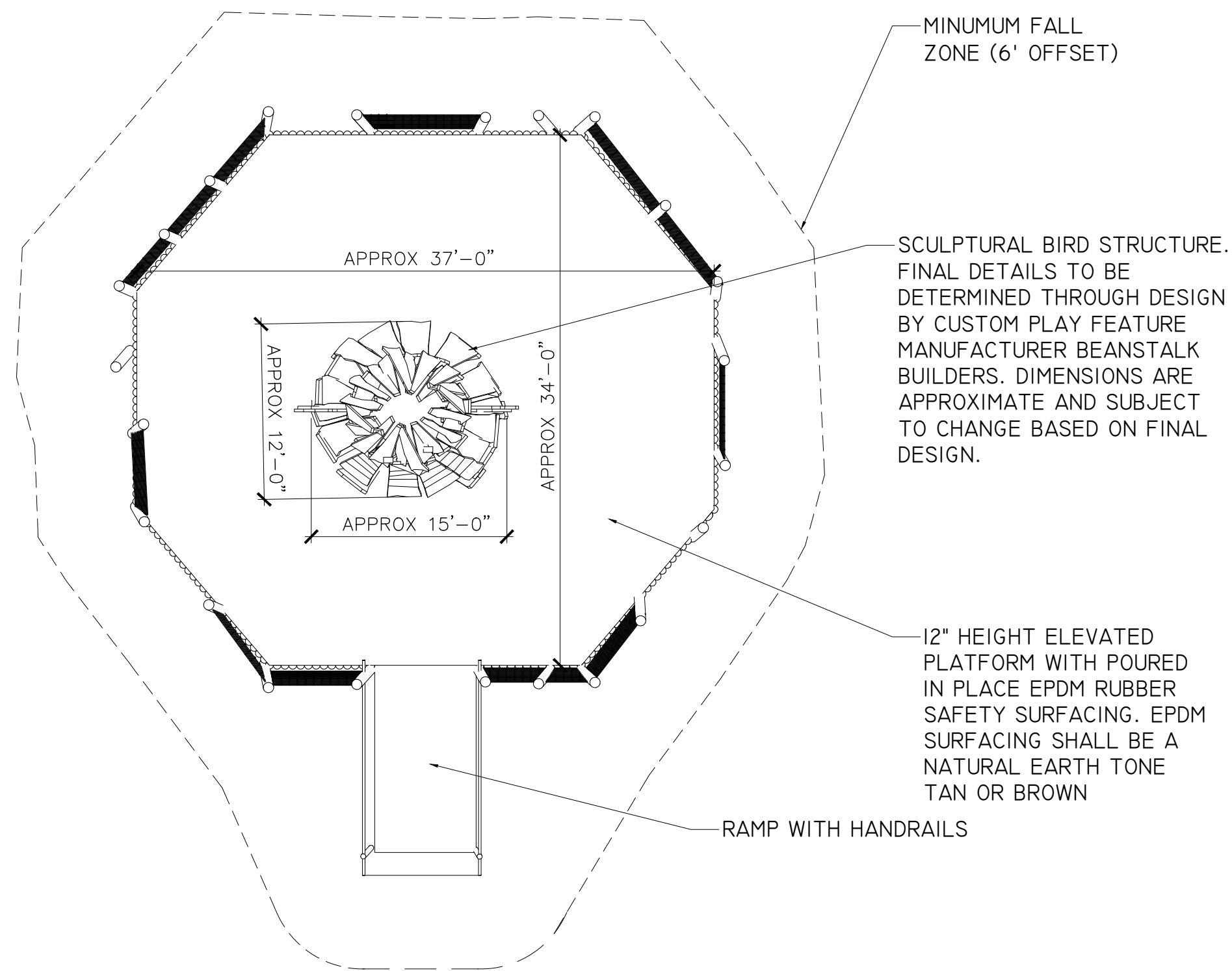

1 PERSPECTIVE 3 L6.3 FRONT ELEVATION

2 WOOD THRUSH PLAN 1/8"=1'-0"

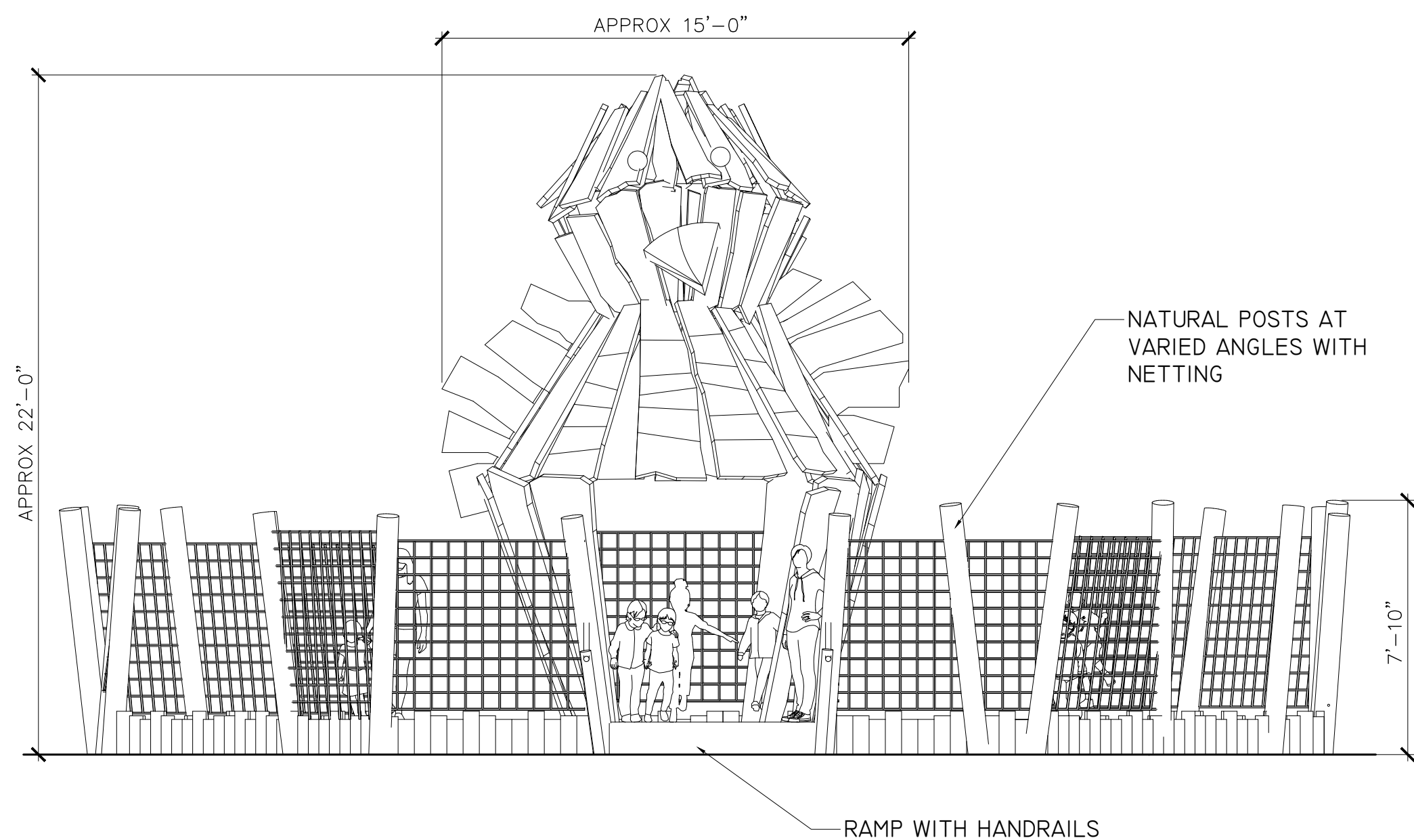

3 FRONT ELEVATION 1/4"=1'-0"

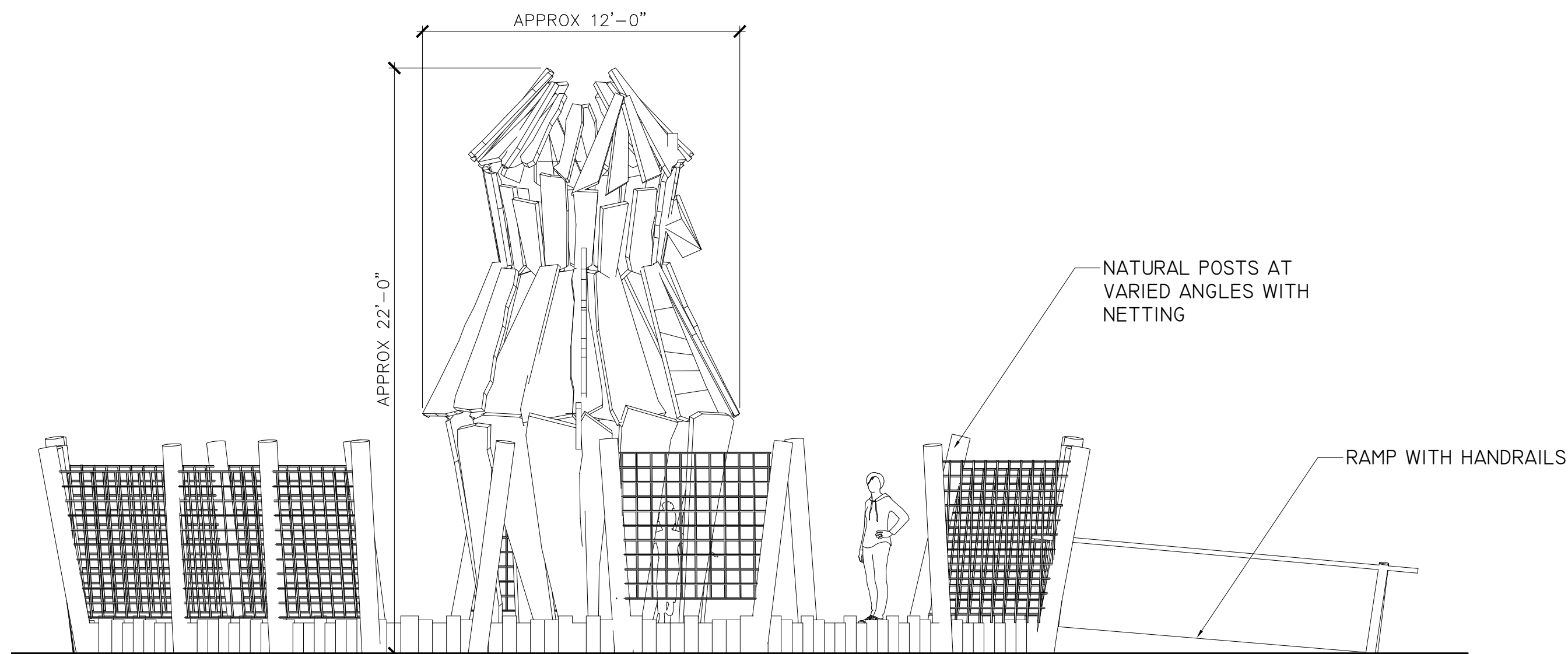

4 SIDE ELEVATION 1/4"=1'-0"

APPROVAL DRAWINGS

DRAWN	JT, ZW
REVISED	12/11/2020

3124 LITTLE VALLEY RD.
DURHAM, NC 27707
919 623 7886
www.landscape.com

JOB No	###
DATE	8/20/2020
SCALE	See Plans
FILE	

NATURE PLAYSPACE
AUDUBON NATURALIST SOCIETY

DETAILS

6.3

PROFESSIONAL CERTIFICATION
I HEREBY CERTIFY THAT THESE DOCUMENTS WERE PREPARED OR APPROVED BY ME, AND THAT I AM A DULY LICENSED PROFESSIONAL UNDER THE LAWS OF THE STATE OF MARYLAND.

LICENSE NO. 3987
EXPIRATION DATE: 6/22/2021

STATE OF MARYLAND
LANDSCAPE ARCHITECT
8/20/2020