

The Conservation Management areas will allow the new development to meet the performance goals of protecting natural resources within the Ten Mile Creek special protection area.

- Conservation Management Area: 30.95 acres +/-
- 1) Management
 - a) Minimize Erosion and Sediment Transport
 - i) Establish vegetative cover over the entire Conservation Management Plan (CMP) area.
 - ii) Provide Urban to Woodland transect between the developed area and the forested area.
 - (1) Establish mow areas within the CMP area surrounding the development.
 - (2) The remainder of the CMP area shall be designated as a no mow area and be planted with a native pollinator/friendly seed mix.
 - b) Maintain existing drainage patterns.
 - i) Stormwater from development is treated using ESD BMP's prior to discharging.
 - ii) Minimize use of herbicides and fertilizers in the CMP area after establishment, in accordance with the invasive species management plan.
 - iii) Reestablish forest within the expanded riparian stream buffers adjacent to CMP area.
 - iv) A community swimming pool will be installed as part of the new development. Water discharge is subject to the Maryland General Discharge Permit No. 1251.
 - (1) All water discharge will be treated before being discharged to any stream or will be trucked off-site for disposal.
 - c) Forest Management
 - i) Identify trees impacted by disease or pests such as Emerald Ash Borer (EAB) and remove if located near a trail or other area of potential hazard.
 - ii) Develop and implement invasive species management plan.
 - 2) Preservation of PerVIOUS Land Cover
 - a) No new impervious pavement allowed within CMP area.
 - i) All trails shall be natural surface.
 - b) Removal and revegetation of impervious areas within CMP area previously used for agricultural activities.
 - 3) Compatibility with All Adjacent Land Uses
 - a) Develop Urban to Woodland Transect Between Developed Area and Forested Areas
 - i) Developed Area – Lawn – Meadow - Edge Woodlands - Dense Woodlands

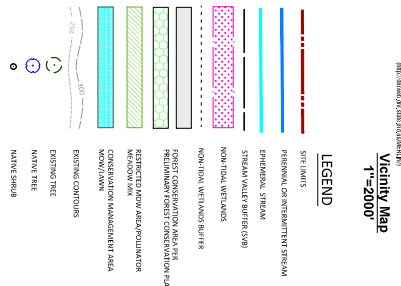

- Notes:**
1. Trees and shrubs shall be provided with deer protection.
 2. See sheet 2 for enlarged plans of the CMP Area.
 3. See sheet 3 for Conservation Management Plan Sheet Mx (or appropriate alternative) and notes pertaining to establishment for long term maintenance.

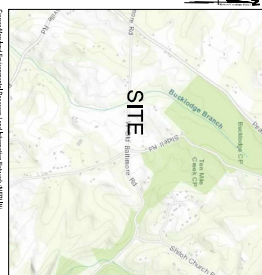
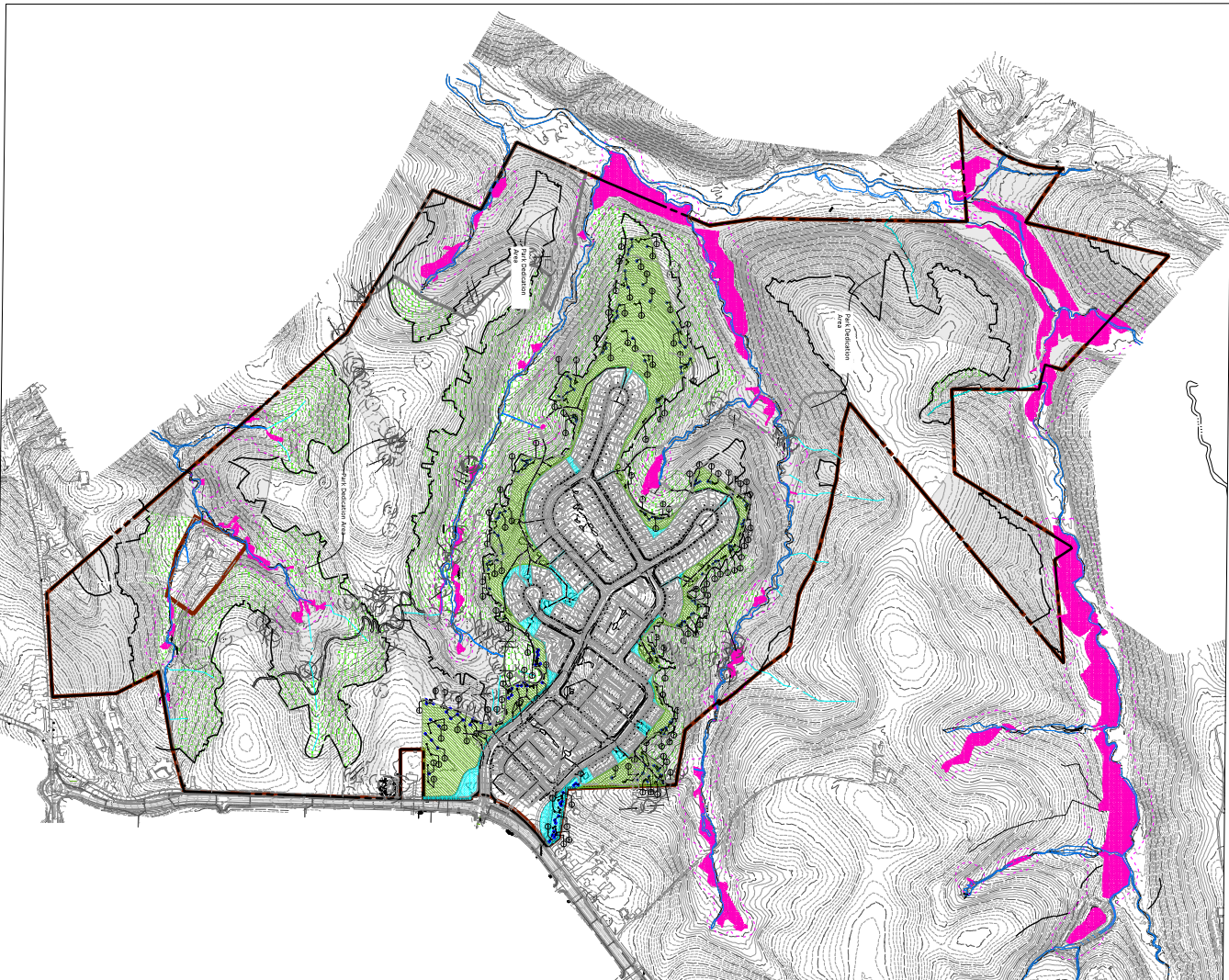

REVISION	DATE	REVISION	DATE	REVISION	DATE

Developer / Applicant:
Pulte Homes
 10600 Arrowhead Drive, Suite 225
 Afton, David Delmarco

CONSERVATION MANAGEMENT AREA EXHIBIT

RODGERS CONSULTING
 11817 Green Ridge Road, Suite 200, Gaithersburg, Maryland 20878
 P: 301.948.0700 F: 301.948.0724 www.rodgers.com

DATE: _____
 DRAWN BY: _____
 CHECKED BY: _____
 RELEASE FOR: _____

CREEKSIDE AT CABIN BRANCH
 ELECTION DISTRICT NO. 2
 MONTGOMERY COUNTY, MARYLAND

SCALE: 1" = 2000'
 DATE: 04/2021
 SHEET NO. 1 OF 2