

**PETRA ENGINEERING LLC**  
 2000 W. 10th Street, Suite 100  
 Denver, CO 80202  
 (303) 733-1000

ALL CORRECTIONS, CONNECTIONS, REVISIONS, OR ADJUSTMENTS TO THIS PLAN AND ASSOCIATED COMPUTATIONS MADE AFTER APRIL 1, 2011 ARE BY PETRA ENGINEERING, LLC.

**LOEDERMAN ASSOCIATES, INC.**  
 1000 17th Street, Suite 100  
 Denver, CO 80202  
 (303) 733-1000

NO. 1	DATE	DESCRIPTION
1	10/1/10	PRELIMINARY PLAN
2	10/1/10	REVISED PLAN
3	10/1/10	REVISED PLAN
4	10/1/10	REVISED PLAN
5	10/1/10	REVISED PLAN
6	10/1/10	REVISED PLAN
7	10/1/10	REVISED PLAN
8	10/1/10	REVISED PLAN
9	10/1/10	REVISED PLAN
10	10/1/10	REVISED PLAN

**FINAL FOREST CONSERVATION PLAN**



THIS PLAN IS A FINAL PLAN FOR THE FOREST CONSERVATION PLAN FOR THE OLBG COMMUNITY PARK QUANTILE ELECTION TRACT, MONTEVERDE COUNTY, COLORADO. THE PLAN IS SUBJECT TO THE FOREST CONSERVATION ACT, C.R.S. 30-10-101 THROUGH 30-10-109. THE PLAN IS SUBJECT TO THE FOREST CONSERVATION ACT, C.R.S. 30-10-101 THROUGH 30-10-109. THE PLAN IS SUBJECT TO THE FOREST CONSERVATION ACT, C.R.S. 30-10-101 THROUGH 30-10-109.

**OLBG COMMUNITY PARK**  
 QUANTILE ELECTION TRACT  
 MONTEVERDE COUNTY, COLORADO

**LEGEND**

	Contour Lines
	Road
	Trail
	Condo
	Free Saidanges
	Forest Conservation
	Other

**APPENDIX**

**L-1**



**PETRA ENGINEERING LLC**  
 10000 W. 10th Avenue, Suite 100  
 Greenwood Village, CO 80120  
 Phone: 303.751.1000  
 Fax: 303.751.1001  
 www.petraeng.com

ALL CORRECTIONS, CONNECTIONS, REVISIONS, OR ADDITIONS TO THIS PLAN AND ASSOCIATED COMPUTATIONS MADE AFTER APRIL 1, 2011 ARE BY PETRA ENGINEERING, LLC.

**LOIEDERMAN ASSOCIATES, INC.**  
 10000 W. 10th Avenue, Suite 100  
 Greenwood Village, CO 80120  
 Phone: 303.751.1000  
 Fax: 303.751.1001  
 www.loiederma.com

NO.	DATE	DESCRIPTION	BY	CHECKED
1	04/11/11	ISSUED FOR PERMITS	APR	APR
2	04/11/11	ISSUED FOR PERMITS	APR	APR
3	04/11/11	ISSUED FOR PERMITS	APR	APR
4	04/11/11	ISSUED FOR PERMITS	APR	APR
5	04/11/11	ISSUED FOR PERMITS	APR	APR
6	04/11/11	ISSUED FOR PERMITS	APR	APR
7	04/11/11	ISSUED FOR PERMITS	APR	APR
8	04/11/11	ISSUED FOR PERMITS	APR	APR
9	04/11/11	ISSUED FOR PERMITS	APR	APR
10	04/11/11	ISSUED FOR PERMITS	APR	APR

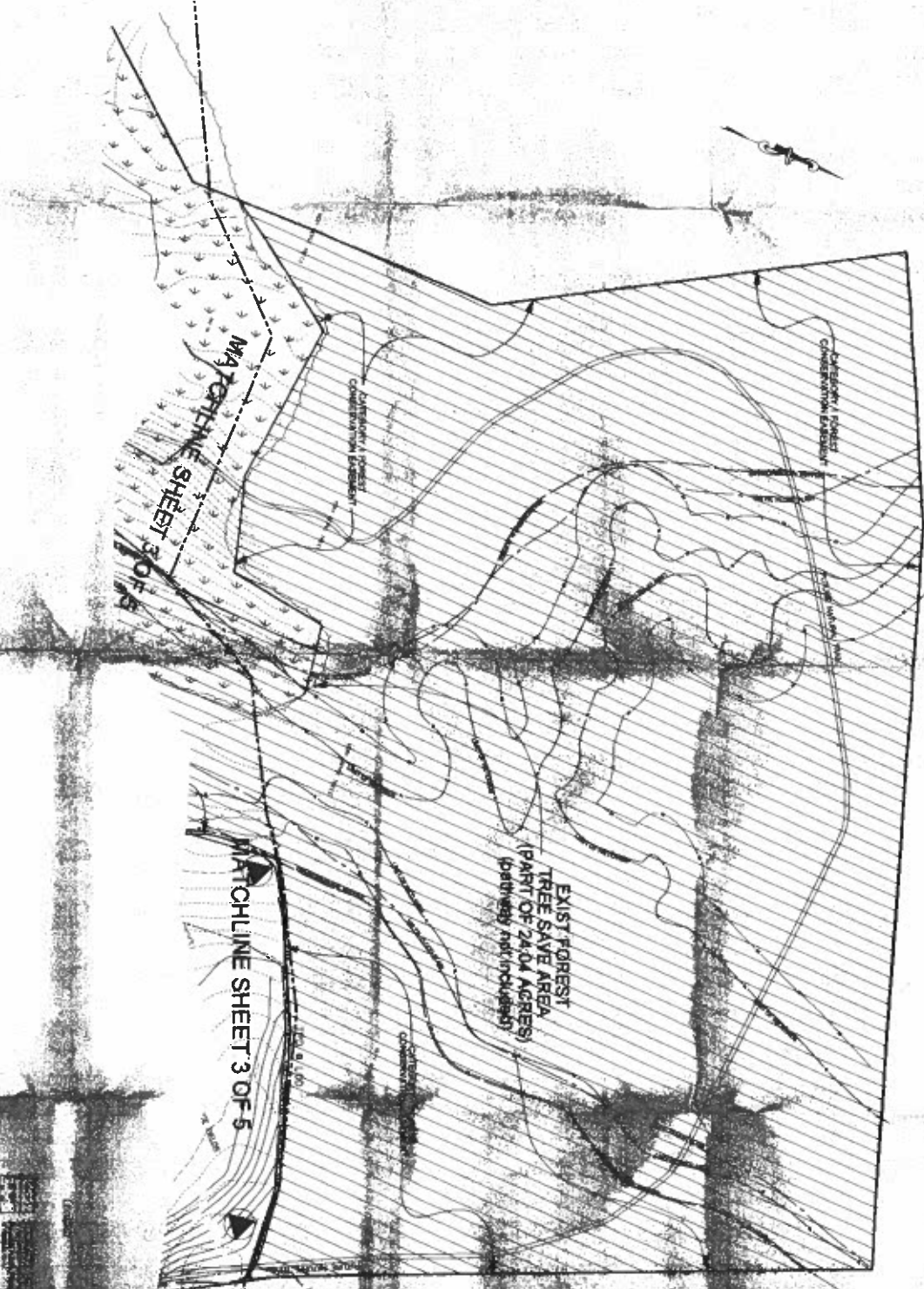

**FINAL FOREST CONSERVATION PLAN**



**UTILITY FILE DOCUMENT**  
 This document is a utility file document for the project. It contains information regarding the location and depth of all utilities within the project area. The information was obtained from utility companies and field surveys. The utility file document is to be used for the design and construction of the project. It is the responsibility of the engineer to verify the accuracy of the utility information and to update the utility file document as more information becomes available.

**FOREST CONSERVATION**

- Final Forest Conservation Plan
- Final Forest Management Plan
- Final Forest Inventory
- Final Forest Site Plan
- Final Forest Design
- Final Forest Construction
- Final Forest Maintenance
- Final Forest Monitoring
- Final Forest Evaluation
- Final Forest Report

**OBAC COMMUNITY PARK**  
**OLNEY BOYS AND GIRLS CLUB**  
 L. 800 F. 42  
 CLAYTON ELECTRIC DISTRICT  
 MONTESSUMO COUNTY, ARIZONA



NOTICE: This plan is prepared in accordance with the provisions of the Forest Practice Act, Chapter 29A, RCW, and the Forest Practice Rules, Chapter 365, WAC. The Forest Practice Act requires that a forest management plan be developed for all forest land. This plan is intended to guide the landowner in the management of the forest and to ensure that the forest is managed in a sustainable manner. The landowner is responsible for ensuring that the forest is managed in accordance with the provisions of the Forest Practice Act and the Forest Practice Rules. The landowner is also responsible for ensuring that the forest is managed in a manner that is consistent with the public interest. The landowner is also responsible for ensuring that the forest is managed in a manner that is consistent with the public interest. The landowner is also responsible for ensuring that the forest is managed in a manner that is consistent with the public interest.

**THE PROTECTION OF FOREST RESOURCES AND THE PREVENTION OF SOIL EROSION AND SEDIMENTATION**

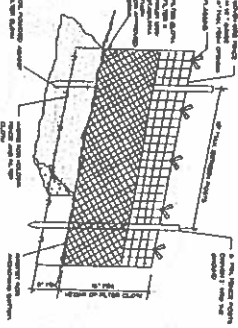

**NOTE:**  
 1. Filter cloth shall be made of a non-woven polypropylene fabric with a minimum opening of 1/8 inch.  
 2. The filter cloth shall be supported by a wire mesh structure.  
 3. The filter cloth shall be installed in a manner that allows water to flow through the mesh while trapping sediment.  
 4. The filter cloth shall be replaced or repaired as needed to maintain its effectiveness.

**PREVENT THE FOLLOWING PRACTICES**

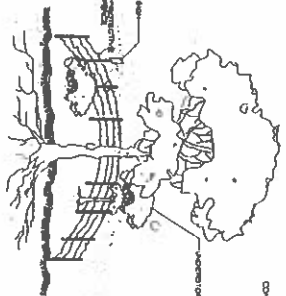

**PROHIBITED PRACTICES:**  
 1. Clearing of forest land for non-forest uses.  
 2. Alteration of stream channels or banks.  
 3. Construction of roads or structures that cause soil erosion or sedimentation.  
 4. Cutting of trees in a manner that causes soil erosion or sedimentation.

**EARTHEN DICE AND SWALE**

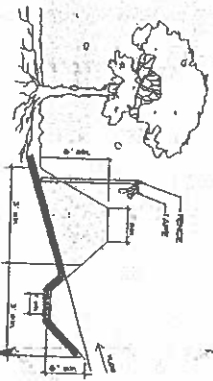

**NOTE:**  
 1. The dice and swale shall be constructed of earth.  
 2. The dice shall be 12 inches wide and 4 inches deep.  
 3. The swale shall be 12 inches wide and 4 inches deep.  
 4. The dice and swale shall be spaced at 10-foot intervals.

**THREE STRAND BARBED WIRE**

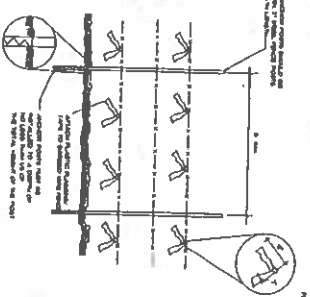

**NOTE:**  
 1. The wire shall be made of galvanized steel.  
 2. The wire shall be 14-gauge.  
 3. The wire shall be installed in a manner that allows water to flow through the strands while preventing soil erosion.

Item	Description	Quantity	Unit
1	Filter Cloth	100	sq. yds.
2	Wire Mesh	100	sq. yds.
3	Three Strand Barbed Wire	100	sq. yds.
4	Earthen Dice and Swale	100	sq. yds.

Site Area	Existing & Retained Forest
19.30 AC.	26.21 AC.
10.1 AC.	5.1 AC.
13.3 AC.	19.8 AC.
100 Ln. Ft.	100 Ln. Ft.
17.4 AC.	14.8 AC.

**PETRA ENGINEERING LLC**  
 3840 BAINBRIDGE ROAD, SUITE 300  
 COLUMBIA, MARYLAND 21044  
 FAX: (410) 326-0800

ALL COMPLETIONS, CORRECTIONS, REVISIONS, OR ADDITIONS TO THIS PLAN AND ASSOCIATED COMPUTATIONS MADE AFTER APRIL 1, 2011 ARE BY PETRA ENGINEERING, LLC.

**FINAL FOREST CONSERVATION PLAN**



**OBGC COMMUNITY PARK**  
 OLNEY BOYS AND GIRLS CLUB  
 QUANTICO DISTRICT  
 MONTGOMERY COUNTY, MARYLAND

**FOREST CONSERVATION**

**APPROVAL**

**LOEDERMAN ASSOCIATES, INC.**  
 Consulting Land Planning Land Surveying Environmental Design  
 10000 Old Columbia Road, Suite 200  
 Columbia, MD 21046  
 Phone: (410) 326-0800  
 Fax: (410) 326-0801  
 Website: www.loederman.com