

Plat Name: Creekside at Cabin Branch

Plat #: 220230560 - 220230580

Location: Located on the west side of Clarksburg Road (MD 121), opposite Dowitcher Way

Master Plan: Clarksburg Ten Mile Creak Amendment Area

Plat Details: RNC zone; 59 lots, 9 parcels

Owner: Shiloh Farm Investments, LLC

The subdivision plats have been reviewed by M-NCPPC staff and determined to be in compliance with Preliminary Plan No. 12020005A (MCPB Resolution No. 21-067) and Site Plan No. 820200160 (Certified Site Plan dated December 13, 2022), as approved by the Board, and that any minor modifications reflected on the plats do not alter the intent of the Board's approval of the aforesaid plans.

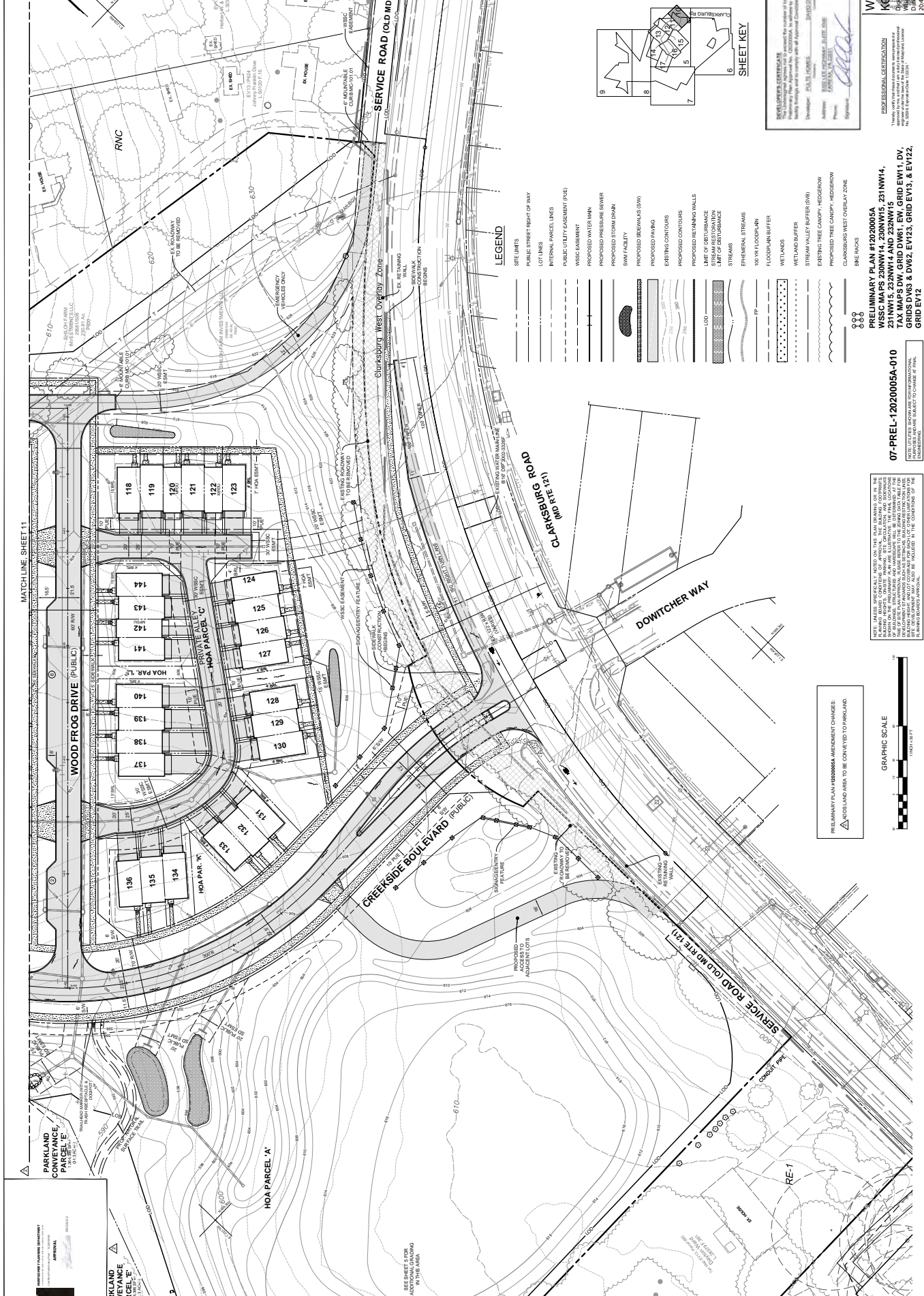

REVISION	DATE	REVISION	DATE	REVISION	DATE

DEVELOPER/APPLICANT:	DATE:
PULTE HOMES	
1000 ARROWHEAD DRIVE, SUITE 225	
ATLANTA, GA 30338	
ATTN: DAVID DEMARCO	

DATE:	

SCALE:	1" = 50'
DATE:	03/27/2022
DATE:	02/22/2022
DATE:	02/22/2022
DATE:	02/22/2022
DATE:	02/22/2022

PROJECT:	07-PREL-12020005A-010
PROJECT:	07-PREL-12020005A-010
PROJECT:	07-PREL-12020005A-010
PROJECT:	07-PREL-12020005A-010
PROJECT:	07-PREL-12020005A-010

PROJECT:	07-PREL-12020005A-010
PROJECT:	07-PREL-12020005A-010
PROJECT:	07-PREL-12020005A-010
PROJECT:	07-PREL-12020005A-010
PROJECT:	07-PREL-12020005A-010

PROJECT:	07-PREL-12020005A-010
PROJECT:	07-PREL-12020005A-010
PROJECT:	07-PREL-12020005A-010
PROJECT:	07-PREL-12020005A-010
PROJECT:	07-PREL-12020005A-010

PRELIMINARY PLAN
 PRELIMINARY PLAN #12020005A

RODGERS CONSULTING
 1840 Casey Industrial Site SW, Gaithersburg, Maryland 20878
 P: 301.946.4300 F: 301.946.2258 www.rodgers.com

WILLIAM KC REED
 PROFESSIONAL ENGINEER
 LICENSE NO. 12022
 EXPIRES 12/31/2024

PROJECT: 07-PREL-12020005A-010
DATE: 03/27/2022
DATE: 02/22/2022
DATE: 02/22/2022
DATE: 02/22/2022

