

VKA
VKA MARYLAND, LLC
 20251 Century Blvd., Suite 400
 Germantown, MD 20874
 301.916.4100 | vka.com
Our Site Set on the Future.

PREPARED FOR:
JLB REALTY, LLC
 8120 WOODMONT AVE
 SUITE 850
 BETHESDA, MD 20814
 240.223.5350
 CONTACT: GRAHAM BROCK
 gbrock@jlbpartners.com

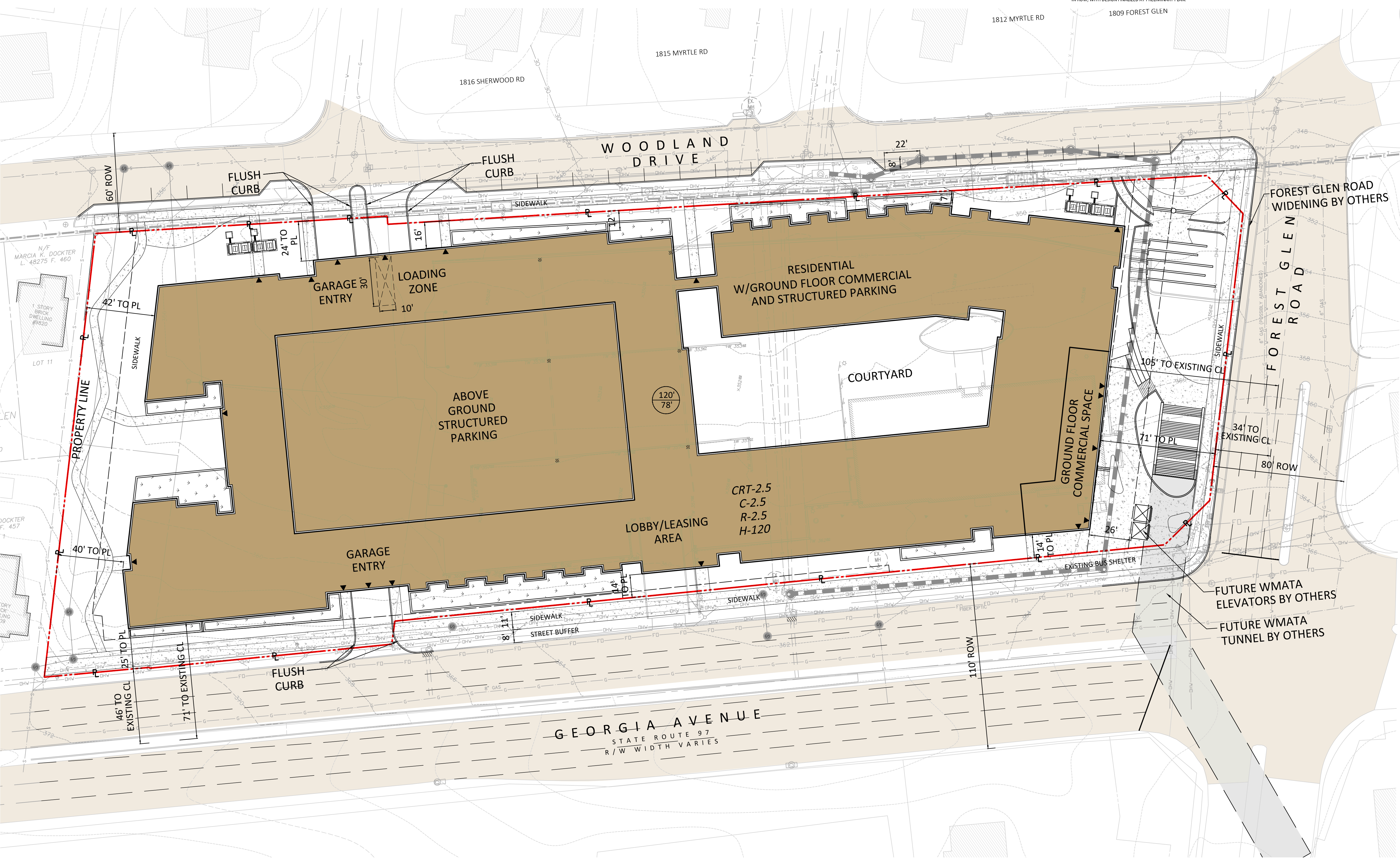

VICINITY MAP
 SCALE: 1" = 2000'

- The Sketch Plan drawings are conceptual only and represent proposed development in an illustrative manner. Final building locations, dimensions, heights, uses, phasing, density, parking, unit mix, development standards and programs shall be determined at time of site plan applications.

DESIGN CONSULTANTS

PLANNER, CIVIL ENGINEER
VKA MARYLAND, LLC
 20251 CENTURY BOULEVARD
 SUITE 400
 GERMANTOWN MD, 20874
 301.916.4100
 CONTACT: MICHAEL GOODMAN, PE

ARCHITECT
MOYA DESIGN PARTNERS
 1308 19TH ST. NW
 WASHINGTON, DC 20036
 202.816.MOYA
 CONTACT: FEDERICO OLIVERA-SALA

LANDSCAPE ARCHITECT
LANDDESIGN
 200 SOUTH PEYTON STREET
 ALEXANDRIA, VA 22314
 703.549.7784
 CONTACT: MATT CLARK

ATTORNEY
MILES & STOCKBRIDGE
 11 N WASHINGTON STREET
 SUITE 700
 ROCKVILLE, MD 20850
 301.517.4804
 CONTACT: ERIN GIRARD

TRAFFIC ENGINEER
LENHART TRAFFIC CONSULTING
 645 BALTIMORE ANNAPOLIS BLVD
 SUITE 214
 SEVERNA PARK, MD 21146
 410.216.3333
 CONTACT: NICK DRIBAN

9801 Georgia Avenue
 WHEATON ELECTION DISTRICT
 NO. 13
 MONTGOMERY COUNTY,
 MARYLAND
 WSSC GRID: 212NW02
 TAX MAP: JP12

SKETCH PLAN

- LEGEND**
- Sketch Plan Limits
 - Surrounding Buildings
 - Proposed Building
 - Existing Road
 - Building Height Allowed
 - Building Height Illustrated
 - Conceptual Doorway Location



I HEREBY CERTIFY THAT THESE DOCUMENTS WERE PREPARED OR SUPERVISED BY ME, AND THAT I AM A DULY LICENSED PROFESSIONAL ENGINEER UNDER THE LAWS OF THE STATE OF MARYLAND. ENGINEER'S NAME: MICHAEL B. GOODMAN, P.E. LICENSE NO.: 27721 EXPIRATION DATE: JULY 19, 2024

THE INFORMATION, DESIGN AND CONTENT OF THESE DRAWINGS OR DOCUMENTS ARE PROPRIETARY TO VKA MARYLAND, LLC AND CONSTITUTE ITS PROPRIETARY INTELLECTUAL PROPERTY. THESE DRAWINGS AND/OR DOCUMENTS MUST NOT BE REPRODUCED, COPIED, DIGITALLY CONVERTED, MODIFIED OR USED FOR ANY PURPOSE, IN ANY FORMAT, WITHOUT PRIOR WRITTEN AUTHORIZATION FROM VKA MARYLAND, LLC. VIOLATIONS MAY RESULT IN PROSECUTION. ONLY APPROVED, SIGNED AND SEALED PLANS OR DRAWINGS MAY BE UTILIZED FOR CONSTRUCTION PURPOSES.

© 2018 VKA MARYLAND, LLC

DRAWN BY: EJS
 DESIGNED BY: MBG
 DATE ISSUED: 08/30/22

VKA PROJECT: VM50562C
 DRAWING NO.: 320230020
 SHEET NO.: **SK-100**

FOR LOCATION OF UTILITIES CALL 8-1-1 or 1-800-257-7777 OR LOG ON TO www.call811.com or http://www.missutility.net 48 HOURS IN ADVANCE OF ANY WORK IN THIS VICINITY

The excavator must notify all public utility companies with underground facilities in the area of proposed excavation and have those facilities located by the utility companies prior to commencing excavation. The excavator is responsible for compliance with requirements of Chapter 36A of the Montgomery County Code.

Attachment E - Prior Approvals (Sketch Plan)

SCALE: 1" = 30'