



## MEMORANDUM

DATE: February 16, 2024

TO: Montgomery County Planning Board

FROM: Stephen Smith, Intake & Regulatory Coordination Division (301)-495-4522  
Jay Beatty, Intake & Regulatory Coordination Division (301)-495-2178

*SS*  
*JCB*

SUBJECT: Item No. 2 - Summary of Record Plats for the Planning Board  
Agenda for February 29, 2024

---

The following record plats are recommended for APPROVAL, subject to the appropriate conditions of approval of the preliminary plan and site plan, if applicable, and conditioned on conformance with all requirements of Chapter 50 of the Montgomery County Code. Attached are specific recommendations and copies of plan drawings for the record plat. The following plats are included:

**220231030 Har Tzeon Property**

**220231050 & 220231060 Preston Place and Lake Apartments**

**220240040 Kensington Park**

**220240210 thru 220240240 Creekside at Cabin Branch**

**Plat Name: Har Tzeon Property**

**Plat #: 220231030**

Location: Located on the south side of University Boulevard (MD 193), 1400 feet east of Amherst Avenue

Master Plan: Wheaton CBD and Vicinity Sector Plan

Plat Details: R-60 zone; 2 lots

Owner: Congregation Har Tzeon-Agudath Achim

This subdivision plat has been reviewed by M-NCPPC staff and determined to be in compliance with Preliminary Plan No. 120210230 (MCPB Resolution No. 22-120), as approved by the Board, and that any minor modifications reflected on the plat do not alter the intent of the Board's approval of the aforesaid plan.

**PLAT NO.**

**NOTES:**

1. THE SUBJECT PROPERTY IS LOCATED ON TAX ASSESSMENT MAP NO. 0371 AND IS ZONED R-200 AS SHOWN ON THE MONTGOMERY COUNTY ZONING GIS WEBSITE.
2. THE HORIZONTAL DATUM OF THIS PLAT IS BASED ON MARYLAND STATE PLANE NAD 83/2011.
3. THIS SUBDIVISION RECORD PLAT IS NOT EVERY-WAY RESERVING MATTER AFFECTING THE OWNERSHIP AND USE OF ANY WATER RESOURCES. THE OWNERSHIP OF ANY WATER RESOURCES IS NOT INTENDED TO BE EXTINGUISHED BY THE RECORDATION OF THIS PLAT. ANY SUCH EXTINGUISHMENT CAN BE MAINTAINED BY THE PLANNING BOARD AND AVAILABLE FOR PUBLIC REVIEW DURING NORMAL BUSINESS HOURS.
4. ALL TERMS, CONDITIONS, AGREEMENTS, LIMITATIONS, AND REQUIREMENTS ASSOCIATED WITH THIS PROPERTY ARE SHOWN ON THE MONTGOMERY COUNTY PLANNING BOARD APPLICABLE TO THIS PROPERTY. ANY SUCH EXTINGUISHMENT CAN BE MAINTAINED BY THE PLANNING BOARD AND AVAILABLE FOR PUBLIC REVIEW DURING NORMAL BUSINESS HOURS.
5. THIS PROPERTY IS SERVED BY PUBLIC WATER AND SEWER SERVICES OWNED BY THE MONTGOMERY COUNTY WATER AND SEWER SERVICES DEPARTMENT. THIS PLAT IS SUBJECT TO THE LINES AND CONDITIONS WITHIN THE M.A.O.P. & P.C. DEPARTMENT PLAN #10010030 ENTITLED "1910 UNIVERSITY SENIOR HOUSING", AS MAY BE AMENDED.
6. THE PROPERTY IMAGED ON THIS PLAT IS SUBJECT TO A "RESERVATION OF EASE" FOR THE OPERATION AND MAINTENANCE OF PRIVATE PARKS AND DRIVEWAYS, OPEN SPACES, AND INCLUDING ANY PRIVATE STREET AND DRAINAGE SYSTEM AS SHOWN IN BOOK 38088 AT PAGE 42.
7. ALL THE PROPERTY SHOWN HEREON IS SUBJECT TO A DECLARATION OF COVENANTS FOR MONTGOMERY COUNTY SENIOR HOUSING, AS SHOWN IN BOOK 38088 AT PAGE 42.
8. THE PROPERTY SHOWN HEREON IS SUBJECT TO THE "EASE" PARKING AND ACCESS EASEMENTS OF MONTGOMERY COUNTY, MARYLAND, AS SHOWN IN BOOK 38088 AT PAGE 42.

UNIVERSITY BLVD. MARYLAND 193 SRC PLAT NOS. 23618 & 13906 LIBER 2853 FOLIO 461 LIBER 2880 FOLIO 376

CONGREGATION HAR TZEON-AGUDATH ACHIM LIBER 8840 FOLIO 410

CONGREGATION HAR TZEON-AGUDATH ACHIM LIBER 20566 FOLIO 738

CONGREGATION HAR TZEON-AGUDATH ACHIM LIBER 20566 FOLIO 738

CONGREGATION HAR TZEON-AGUDATH ACHIM LIBER 20566 FOLIO 738

CONGREGATION HAR TZEON-AGUDATH ACHIM LIBER 20566 FOLIO 738

CONGREGATION HAR TZEON-AGUDATH ACHIM LIBER 20566 FOLIO 738

CONGREGATION HAR TZEON-AGUDATH ACHIM LIBER 20566 FOLIO 738

CONGREGATION HAR TZEON-AGUDATH ACHIM LIBER 20566 FOLIO 738

CONGREGATION HAR TZEON-AGUDATH ACHIM LIBER 20566 FOLIO 738

CONGREGATION HAR TZEON-AGUDATH ACHIM LIBER 20566 FOLIO 738

CONGREGATION HAR TZEON-AGUDATH ACHIM LIBER 20566 FOLIO 738

CONGREGATION HAR TZEON-AGUDATH ACHIM LIBER 20566 FOLIO 738

CONGREGATION HAR TZEON-AGUDATH ACHIM LIBER 20566 FOLIO 738

CONGREGATION HAR TZEON-AGUDATH ACHIM LIBER 20566 FOLIO 738

CONGREGATION HAR TZEON-AGUDATH ACHIM LIBER 20566 FOLIO 738

CONGREGATION HAR TZEON-AGUDATH ACHIM LIBER 20566 FOLIO 738

CONGREGATION HAR TZEON-AGUDATH ACHIM LIBER 20566 FOLIO 738

CONGREGATION HAR TZEON-AGUDATH ACHIM LIBER 20566 FOLIO 738

CONGREGATION HAR TZEON-AGUDATH ACHIM LIBER 20566 FOLIO 738

CONGREGATION HAR TZEON-AGUDATH ACHIM LIBER 20566 FOLIO 738

CONGREGATION HAR TZEON-AGUDATH ACHIM LIBER 20566 FOLIO 738

CONGREGATION HAR TZEON-AGUDATH ACHIM LIBER 20566 FOLIO 738

CONGREGATION HAR TZEON-AGUDATH ACHIM LIBER 20566 FOLIO 738

CONGREGATION HAR TZEON-AGUDATH ACHIM LIBER 20566 FOLIO 738

CONGREGATION HAR TZEON-AGUDATH ACHIM LIBER 20566 FOLIO 738

CONGREGATION HAR TZEON-AGUDATH ACHIM LIBER 20566 FOLIO 738

CONGREGATION HAR TZEON-AGUDATH ACHIM LIBER 20566 FOLIO 738

CONGREGATION HAR TZEON-AGUDATH ACHIM LIBER 20566 FOLIO 738

CONGREGATION HAR TZEON-AGUDATH ACHIM LIBER 20566 FOLIO 738

CONGREGATION HAR TZEON-AGUDATH ACHIM LIBER 20566 FOLIO 738

CONGREGATION HAR TZEON-AGUDATH ACHIM LIBER 20566 FOLIO 738

CONGREGATION HAR TZEON-AGUDATH ACHIM LIBER 20566 FOLIO 738

CONGREGATION HAR TZEON-AGUDATH ACHIM LIBER 20566 FOLIO 738

CONGREGATION HAR TZEON-AGUDATH ACHIM LIBER 20566 FOLIO 738

CONGREGATION HAR TZEON-AGUDATH ACHIM LIBER 20566 FOLIO 738

CONGREGATION HAR TZEON-AGUDATH ACHIM LIBER 20566 FOLIO 738

CONGREGATION HAR TZEON-AGUDATH ACHIM LIBER 20566 FOLIO 738

**LEGEND**

- S.F. SQUARE FEET
- N. NORTHING
- E. EASTING
- L.P.F. IRON PIPE FOUND
- R.B.F. REBAR FOUND

**CURVE TABLE**

NO	RADIUS	LENGTH	TANGENT	CHORD BEARING	CHORD	DELTA
C1	1,527.69'	403.37'	203.18'	553°41'00"E	401.90'	17°01'22"
C2	1,527.69'	326.58'	164.08'	553°18'13"E	325.80'	13°46'56"
C3	1,527.69'	78.79'	38.41'	546°47'52"E	77.76'	0°37'42"
C4	225.35'	184.79'	97.95'	58°44'53"W	176.65'	46°58'59"
C5	1,582.69'	127.85'	63.93'	553°04'28"E	127.80'	0°57'52"
C6	1,372.69'	128.58'	63.33'	547°47'58"E	128.53'	05°17'00"

**SURVEYOR'S CERTIFICATE**

I HEREBY CERTIFY THAT THE PLAT SHOWN HEREON IS CORRECT TO THE BEST OF MY PROFESSIONAL ABILITY. THAT IT IS A PLAT OF ALL OF THE PROPERTY ACQUIRED BY CONGREGATION HAR TZEON-AGUDATH ACHIM, A MARYLAND RESIDUAL CORPORATION, IN THE FOLLOWING COUNTY RECORDS: BOOK 38088 AT PAGE 42, FROM EDWARD S. KESSLER, ESQ., CONVEYED BY DEED DATED NOVEMBER 7, 1983 AND RECORDED IN LIBER 1880 AT FOLIO 271, FROM EDWARD S. KESSLER, ESQ., CONVEYED BY DEED DATED NOVEMBER 7, 1983 AND RECORDED IN LIBER 1880 AT FOLIO 271, FROM EDWARD S. KESSLER, ESQ., CONVEYED BY DEED DATED AUGUST 27, 1986 AND RECORDED IN LIBER 8840 AT FOLIO 410, AND ALSO BEING PART OF PARCEL B, HAR TZEON PROPERTY, RECORDED AS PLAT NO. 15759, ALL AMONG THE LAND RECORDS OF MONTGOMERY COUNTY, MARYLAND. THE TOTAL AREA OF THIS PLAT IS 154,000 SQUARE FEET OR 3.5354 ACRES OF LAND, OF WHICH 8,828 SQUARE FEET OR 0.2027 ACRES IS DEDICATED TO PUBLIC USE.



*Joseph G. Price*  
 JOSEPH G. PRICE  
 PROFESSIONAL SURVEYOR  
 LICENSE NO. 15848  
 EXPIRES: MAY 31, 2024

**AREA TABULATION**

LOT 1	72,834 SQ. FT. OR 1.6720 ACRES
LOT 2	72,338 SQ. FT. OR 1.6607 ACRES
STREET DEDICATION	8,828 SQ. FT. OR 0.2027 ACRES
TOTAL AREA OF THIS PLAT	154,000 SQ. FT. OR 3.5354 ACRES

**GRAPHIC SCALE**



**OWNER'S CERTIFICATE**

WE, THE UNDERSIGNED, OWNERS OF THE PROPERTY SHOWN AND RECORDED HEREON, HEREBY ACCEPT THE PLAT OF SUBDIVISION, ESTABLISH THE UNLAWFUL BUILDING RESTRICTION LINES, AND DEDICATE PUBLIC STREET FOR PUBLIC STREET FURTHERMORE, WE AS OWNERS OF THIS SUBDIVISION, OUR SUCCESSORS AND ASSIGNS, WILL CAUSE ALL PROPERTY CORNER MARKERS TO BE PLACED AT THE CORNERS OF THE SUBDIVISION, AND WE WILL MAINTAIN THEM IN ACCORDANCE WITH SECTION 30-4-1.0 OF THE MONTGOMERY COUNTY CODE. FURTHERMORE, WE GRANT TO PEOPCO, WASHINGTON GAS AND LIGHT COMPANY, AND TO THEIR RESPECTIVE SUCCESSORS, AGENTS AND ASSIGNS, AN EASEMENT IN, ON AND OVER THE LAND HEREON DESCRIBED AS PUBLIC UTILITIES IN A CERTAIN DOCUMENT "DECLARATION OF PUBLIC UTILITIES EASEMENTS" AND RECORDED AMONG THE LAND RECORDS OF MONTGOMERY COUNTY, MARYLAND IN LIBER 3854 AT FOLIO 457, SAID TERMS BEING INCORPORATED HEREIN BY THIS REFERENCE. THERE ARE NO SITS, ACTIONS-AT-LAW, LEASES, LIENS, OR TRUSTS ON THE PROPERTY.

CONGREGATION HAR TZEON-AGUDATH ACHIM

*John Blewies*  
 NAME: JOHN BLEWIES  
 TITLE: PRESIDENT  
 DATE: 1/20/24

MARYLAND NATIONAL CAPITAL PARK & PLANNING COMMISSION MONTGOMERY COUNTY PLANNING BOARD	APPROVED: <i>John Blewies</i> CHAIR	MONTGOMERY PLAT SIGNATORY FOR SECRETARY-TREASURER
DEPARTMENT OF PERMITTING SERVICES MONTGOMERY COUNTY, MARYLAND	APPROVED: <i>John Blewies</i> DIRECTOR	
	PLAT NO. _____	DATE: _____
M.N.C.P. & P.C. RECORD FILE NO. _____		



**W&A MARYLAND, LLC**  
 1000 EASTERN AVENUE, SUITE 400  
 ANNAPOLIS, MD 20704  
 TEL: 410-261-1400  
 FAX: 410-261-1401  
 WWW.WAMARYLAND.COM

**OUR SITE IS ON THE PLANS**

**PROPOSED:**  
 1910 UNIVERSITY LLC/O  
 MASON FIRST BLDG  
 1910 UNIVERSITY BLVD  
 ANNAPOLIS, MD 20704  
 SRC PLAT NOS. 23618 & 13906

**LEGISLATION:**  
 WILEY, WITLER & CANBY  
 1000 VERMONT AVENUE, NW  
 WASHINGTON, DC 20005  
 TEL: 202-331-1500  
 WWW.WWCA-DC.COM

**WENKEL & ASSOCIATES**  
 1000 VERMONT AVENUE, NW  
 WASHINGTON, DC 20005  
 TEL: 202-331-1500  
 WWW.WENKEL.COM

**W&A MARYLAND, LLC**  
 1000 EASTERN AVENUE, SUITE 400  
 ANNAPOLIS, MD 20704  
 TEL: 410-261-1400  
 FAX: 410-261-1401  
 WWW.WAMARYLAND.COM

**WESTCHESTER**  
 HINWORTH LLC  
 1000 EASTERN AVENUE, SUITE 400  
 ANNAPOLIS, MD 20704  
 TEL: 410-261-1400  
 FAX: 410-261-1401  
 WWW.WESTCHESTERHINWORTH.COM

**WESTCHESTER**  
 HINWORTH LLC  
 1000 EASTERN AVENUE, SUITE 400  
 ANNAPOLIS, MD 20704  
 TEL: 410-261-1400  
 FAX: 410-261-1401  
 WWW.WESTCHESTERHINWORTH.COM

**WESTCHESTER**  
 HINWORTH LLC  
 1000 EASTERN AVENUE, SUITE 400  
 ANNAPOLIS, MD 20704  
 TEL: 410-261-1400  
 FAX: 410-261-1401  
 WWW.WESTCHESTERHINWORTH.COM

**WESTCHESTER**  
 HINWORTH LLC  
 1000 EASTERN AVENUE, SUITE 400  
 ANNAPOLIS, MD 20704  
 TEL: 410-261-1400  
 FAX: 410-261-1401  
 WWW.WESTCHESTERHINWORTH.COM

**WESTCHESTER**  
 HINWORTH LLC  
 1000 EASTERN AVENUE, SUITE 400  
 ANNAPOLIS, MD 20704  
 TEL: 410-261-1400  
 FAX: 410-261-1401  
 WWW.WESTCHESTERHINWORTH.COM

**WESTCHESTER**  
 HINWORTH LLC  
 1000 EASTERN AVENUE, SUITE 400  
 ANNAPOLIS, MD 20704  
 TEL: 410-261-1400  
 FAX: 410-261-1401  
 WWW.WESTCHESTERHINWORTH.COM

**WESTCHESTER**  
 HINWORTH LLC  
 1000 EASTERN AVENUE, SUITE 400  
 ANNAPOLIS, MD 20704  
 TEL: 410-261-1400  
 FAX: 410-261-1401  
 WWW.WESTCHESTERHINWORTH.COM

**WESTCHESTER**  
 HINWORTH LLC  
 1000 EASTERN AVENUE, SUITE 400  
 ANNAPOLIS, MD 20704  
 TEL: 410-261-1400  
 FAX: 410-261-1401  
 WWW.WESTCHESTERHINWORTH.COM

**WESTCHESTER**  
 HINWORTH LLC  
 1000 EASTERN AVENUE, SUITE 400  
 ANNAPOLIS, MD 20704  
 TEL: 410-261-1400  
 FAX: 410-261-1401  
 WWW.WESTCHESTERHINWORTH.COM

**WESTCHESTER**  
 HINWORTH LLC  
 1000 EASTERN AVENUE, SUITE 400  
 ANNAPOLIS, MD 20704  
 TEL: 410-261-1400  
 FAX: 410-261-1401  
 WWW.WESTCHESTERHINWORTH.COM

**WESTCHESTER**  
 HINWORTH LLC  
 1000 EASTERN AVENUE, SUITE 400  
 ANNAPOLIS, MD 20704  
 TEL: 410-261-1400  
 FAX: 410-261-1401  
 WWW.WESTCHESTERHINWORTH.COM

**WESTCHESTER**  
 HINWORTH LLC  
 1000 EASTERN AVENUE, SUITE 400  
 ANNAPOLIS, MD 20704  
 TEL: 410-261-1400  
 FAX: 410-261-1401  
 WWW.WESTCHESTERHINWORTH.COM

**WESTCHESTER**  
 HINWORTH LLC  
 1000 EASTERN AVENUE, SUITE 400  
 ANNAPOLIS, MD 20704  
 TEL: 410-261-1400  
 FAX: 410-261-1401  
 WWW.WESTCHESTERHINWORTH.COM

**WESTCHESTER**  
 HINWORTH LLC  
 1000 EASTERN AVENUE, SUITE 400  
 ANNAPOLIS, MD 20704  
 TEL: 410-261-1400  
 FAX: 410-261-1401  
 WWW.WESTCHESTERHINWORTH.COM

**WESTCHESTER**  
 HINWORTH LLC  
 1000 EASTERN AVENUE, SUITE 400  
 ANNAPOLIS, MD 20704  
 TEL: 410-261-1400  
 FAX: 410-261-1401  
 WWW.WESTCHESTERHINWORTH.COM

**WESTCHESTER**  
 HINWORTH LLC  
 1000 EASTERN AVENUE, SUITE 400  
 ANNAPOLIS, MD 20704  
 TEL: 410-261-1400  
 FAX: 410-261-1401  
 WWW.WESTCHESTERHINWORTH.COM

**WESTCHESTER**  
 HINWORTH LLC  
 1000 EASTERN AVENUE, SUITE 400  
 ANNAPOLIS, MD 20704  
 TEL: 410-261-1400  
 FAX: 410-261-1401  
 WWW.WESTCHESTERHINWORTH.COM

**WESTCHESTER**  
 HINWORTH LLC  
 1000 EASTERN AVENUE, SUITE 400  
 ANNAPOLIS, MD 20704  
 TEL: 410-261-1400  
 FAX: 410-261-1401  
 WWW.WESTCHESTERHINWORTH.COM

**WESTCHESTER**  
 HINWORTH LLC  
 1000 EASTERN AVENUE, SUITE 400  
 ANNAPOLIS, MD 20704  
 TEL: 410-261-1400  
 FAX: 410-261-1401  
 WWW.WESTCHESTERHINWORTH.COM

**WESTCHESTER**  
 HINWORTH LLC  
 1000 EASTERN AVENUE, SUITE 400  
 ANNAPOLIS, MD 20704  
 TEL: 410-261-1400  
 FAX: 410-261-1401  
 WWW.WESTCHESTERHINWORTH.COM

**WESTCHESTER**  
 HINWORTH LLC  
 1000 EASTERN AVENUE, SUITE 400  
 ANNAPOLIS, MD 20704  
 TEL: 410-261-1400  
 FAX: 410-261-1401  
 WWW.WESTCHESTERHINWORTH.COM

**WESTCHESTER**  
 HINWORTH LLC  
 1000 EASTERN AVENUE, SUITE 400  
 ANNAPOLIS, MD 20704  
 TEL: 410-261-1400  
 FAX: 410-261-1401  
 WWW.WESTCHESTERHINWORTH.COM

**WESTCHESTER**  
 HINWORTH LLC  
 1000 EASTERN AVENUE, SUITE 400  
 ANNAPOLIS, MD 20704  
 TEL: 410-261-1400  
 FAX: 410-261-1401  
 WWW.WESTCHESTERHINWORTH.COM

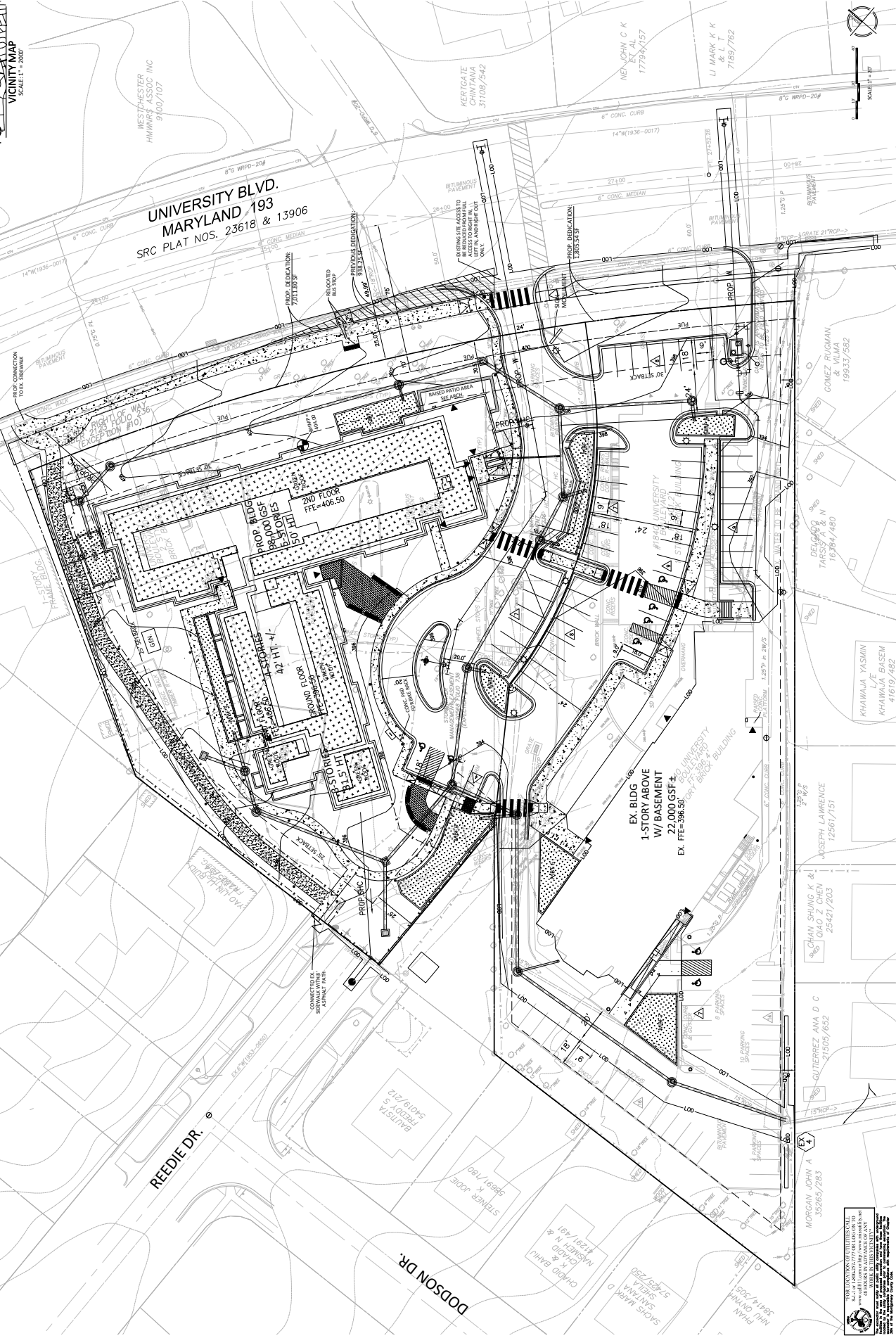

**PLAN LEGEND**

	PROPOSED WATER LINE
	PROPOSED SEWER LINE
	PROPOSED STORM SEWER LINE
	PROPOSED GAS LINE
	PROPOSED ELECTRICAL CONDUIT
	PROPOSED FIRE ALARM CONDUIT
	PROPOSED CABLE TV CONDUIT
	PROPOSED DATA CONDUIT
	PROPOSED FIBER OPTIC CONDUIT
	PROPOSED TELEPHONE CONDUIT
	PROPOSED FIRE ALARM CABLE
	PROPOSED CABLE TV CABLE
	PROPOSED DATA CABLE
	PROPOSED FIBER OPTIC CABLE
	PROPOSED TELEPHONE CABLE
	PROPOSED FIRE ALARM PANEL
	PROPOSED CABLE TV PANEL
	PROPOSED DATA PANEL
	PROPOSED FIBER OPTIC PANEL
	PROPOSED TELEPHONE PANEL
	PROPOSED FIRE ALARM CABINET
	PROPOSED CABLE TV CABINET
	PROPOSED DATA CABINET
	PROPOSED FIBER OPTIC CABINET
	PROPOSED TELEPHONE CABINET
	PROPOSED FIRE ALARM CONTROL PANEL
	PROPOSED CABLE TV CONTROL PANEL
	PROPOSED DATA CONTROL PANEL
	PROPOSED FIBER OPTIC CONTROL PANEL
	PROPOSED TELEPHONE CONTROL PANEL
	PROPOSED FIRE ALARM CONTROL UNIT
	PROPOSED CABLE TV CONTROL UNIT
	PROPOSED DATA CONTROL UNIT
	PROPOSED FIBER OPTIC CONTROL UNIT
	PROPOSED TELEPHONE CONTROL UNIT
	PROPOSED FIRE ALARM CONTROL PANEL
	PROPOSED CABLE TV CONTROL PANEL
	PROPOSED DATA CONTROL PANEL
	PROPOSED FIBER OPTIC CONTROL PANEL
	PROPOSED TELEPHONE CONTROL PANEL
	PROPOSED FIRE ALARM CONTROL UNIT
	PROPOSED CABLE TV CONTROL UNIT
	PROPOSED DATA CONTROL UNIT
	PROPOSED FIBER OPTIC CONTROL UNIT
	PROPOSED TELEPHONE CONTROL UNIT
	PROPOSED FIRE ALARM CONTROL PANEL
	PROPOSED CABLE TV CONTROL PANEL
	PROPOSED DATA CONTROL PANEL
	PROPOSED FIBER OPTIC CONTROL PANEL
	PROPOSED TELEPHONE CONTROL PANEL
	PROPOSED FIRE ALARM CONTROL UNIT
	PROPOSED CABLE TV CONTROL UNIT
	PROPOSED DATA CONTROL UNIT
	PROPOSED FIBER OPTIC CONTROL UNIT
	PROPOSED TELEPHONE CONTROL UNIT

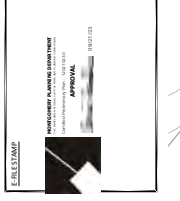

**1910 UNIVERSITY SENIOR HOUSING PRELIMINARY PLAN**  
 1.2021.02.30  
 1.2021.02.30  
 1.2021.02.30  
 MONTGOMERY COUNTY, MARYLAND  
 WASHINGTON, DC 20704  
 TEL: 410-261-1400  
 FAX: 410-261-1401  
 WWW.WAMARYLAND.COM

**PRELIMINARY PLAN**



**DESIGNED BY:** W&A MARYLAND, LLC  
**PROJECT:** 1910 UNIVERSITY SENIOR HOUSING  
**DATE:** 1.2021.02.30  
**SCALE:** 1" = 20'  
**PROJECT NO.:** W&A1910  
**DATE:** 1.2021.02.30

**DATE:** 1.2021.02.30