

**MONTGOMERY COUNTY
DEPARTMENT OF TRANSPORTATION
ZION ROAD BRIDGE REPLACEMENT
BRIDGE NO. M-0121
FOREST CONSERVATION PLAN
F20240870**

INDEX OF SHEETS

1. COVER SHEET
2. APPROVAL SHEET
3. FOREST CONSERVATION PLAN
4. NOTES AND DETAILS SHEET

DEVELOPER'S CERTIFICATE

The Undersigned agrees to execute all the features of the Approved Final Forest Conservation Plan No. F20240870 including, financial bonding, forest planting, maintenance, and all other applicable agreements.

Developer's Name: Montgomery County DOT
Printed Company Name

Contact Person or Owner: Joseph Moges
Printed Name

Address: 100 EDISON PARK DRIVE

Phone and Email: 227-251-1268 joseph.moges@montgomerycountymd.gov

Signature: Joseph Moges

CERTIFICATION OF QUALIFIED PROFESSIONAL
 I HEREBY CERTIFY THAT THE PLAN SHOWN HEREON HAS BEEN PREPARED IN ACCORDANCE WITH THE REQUIREMENTS OF THE MARYLAND STATE PROFESSIONAL LANDSCAPE ARCHITECTS ACT, MONTGOMERY COUNTY FOREST CONSERVATION ACT, AND THE MONTGOMERY COUNTY ZONING ORDINANCES.

08/14/2025
DATE

JOANNA HIEBLER

JOANNA HIEBLER
MDNR /COMAR 08.19.06.01
QUALIFIED PROFESSIONAL

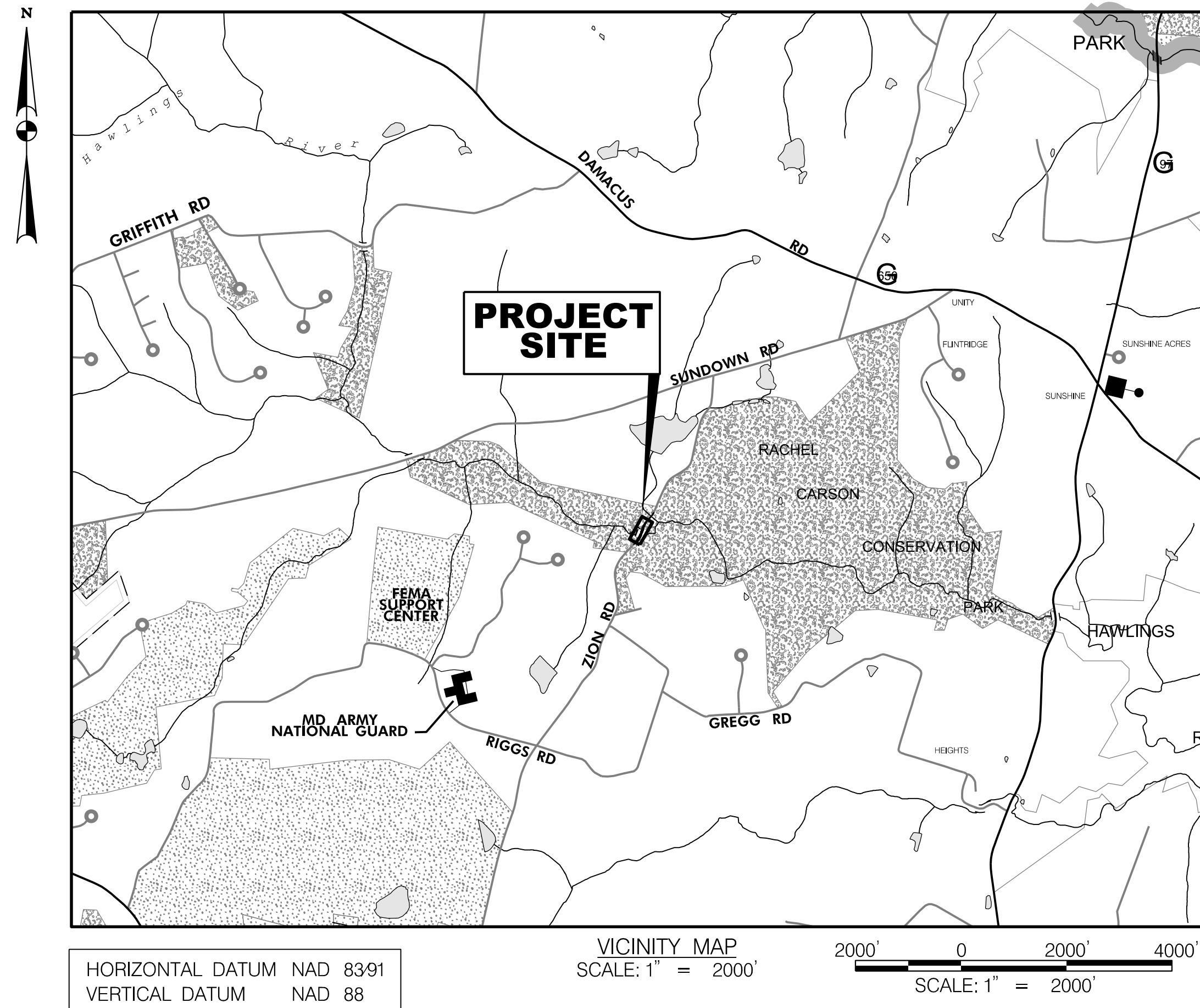

FOREST CONSERVATION WORKSHEET

OUTSIDE Same Priority Watershed - Zion Road Bridge Replacement Project

NET TRACT AREA:

- A. Total tract area ...
B. Additions to tract area (Off-Site Work, etc.; construction required by this plan) ...
C. Land dedication acres (parks, county facility, etc.) ...
D. Land dedication for roads or utilities (construction not required by this plan) ...
E. Area to remain in commercial agricultural production/use ...
F. Other deductions (specify)
G. Net Tract Area =

LAND USE CATEGORY: (from Chapter 22A-3. Definitions)

Input the number "1" under the appropriate land use, limit to only one entry.

ARA	CDR	MDR	IDA	HDR	MPD	CIA
1	0	0	0	0	0	0

- | | | | |
|--------------------------------|-----|-------|------|
| G. Afforestation Threshold ... | 20% | x G = | 0.38 |
| H. Conservation Threshold ... | 55% | x G = | 1.05 |

EXISTING FOREST COVER:

- I. Existing forest cover=
- J. Area of forest above afforestation threshold=
- K. Area of forest above conservation threshold=

BREAK EVEN POINT:

- L. Forest retention above threshold with no mitigation=
- M. Clearing permitted without mitigation=

PROPOSED FOREST CLEARING:

- N. Total area of forest to be cleared=
- O. Total area of forest to be retained=

PLANTING REQUIREMENTS:

- | | | | |
|---|------|---|------|
| P. Reforestation for clearing above conservation threshold= | 0.06 | P. Reforestation for clearing above conservation threshold= | 0.06 |
| Q. Reforestation for clearing below conservation threshold= | 0.91 | Q. Reforestation for clearing below conservation threshold= | 0.91 |
| R. Credit for retention above conservation threshold= | 0.00 | R. Credit for retention above conservation threshold= | 0.00 |
| S. Total reforestation required= | 0.97 | S. Total reforestation required= | 0.97 |
| T. Total afforestation required= | 0.00 | T. Total afforestation required= | 0.00 |
| U. Credit for landscaping (may not be used to meet reforestation requirement if project is located outside an Equity Focus Area (EFA). For projects within EFA, may not exceed 20% of "S")= | 0.00 | U. Credit for landscaping (may not be used to meet reforestation requirement if project is located outside an Equity Focus Area (EFA). For projects within EFA, may not exceed 20% of "S")= | 0.00 |

- | | | | |
|---|-------------|---|-------------|
| V. Total reforestation and afforestation required = | 0.97 | V. Total reforestation and afforestation required = | 0.76 |
| worksheet date | 4/3/2023 | worksheet date | 4/3/2023 |

APPLICANT:

MONTGOMERY COUNTY
DEPARTMENT OF TRANSPORTATION
100 EDISON PARK DRIVE
GAITHERSBURG, MD 20878
JOSE MOGES
227-251-1268

PREPARED BY:

AECOM
4 NORTH PARK DRIVE, SUITE 300
HUNT VALLEY, MD 21030
410-785-7220

				MONTGOMERY COUNTY DEPARTMENT OF TRANSPORTATION ROCKVILLE, MARYLAND		ZION ROAD BRIDGE REPLACEMENT MONTGOMERY COUNTY BRIDGE NO. M-0121					
				RECOMMENDED FOR APPROVAL		COVER SHEET ELECTION DIST: 101-01 TAX MAP: HV32 WSSC GRID NO.: 230NW04 PROJECT NO. : M0187ZM1 SHEET 1 OF 4 DATE: 08/14/2025					
				CHIEF, TRANSPORTATION PLANNING AND DESIGN SECTION						DATE	
				APPROVED							
				<i>Joseph Magos</i>						8/15/2025	
				CHIEF, DIVISION OF TRANSPORTATION ENGINEERING						DATE	
NO.	REVISION	DATE	BY	DESIGNED BY: JH	DRAWN BY: LY	CHECKED BY: JH					

02-FCP-F20240870-001

L:\DCS\Projects\TRN\60637252_MDSHA_M0121\900_CAD_GIS\917_LANDSCAPE\917_8-FCP\02-FCP-F20240870-001.dgn

THIS SHEET RESERVED FOR FUTURE APPROVALS

APPLICANT:
MONTGOMERY COUNTY
DEPARTMENT OF TRANSPORTATION
100 EDISON PARK DRIVE
GAITHERSBURG, MD 20878
JOSEPH MOGES
227-251-1268

PREPARED BY:
AECOM
4 NORTH PARK DRIVE, SUITE 300
HUNT VALLEY, MD 21030
410-785-7220

NO.	REVISION	DATE	BY
-----	----------	------	----

MONTGOMERY COUNTY DEPARTMENT OF TRANSPORTATION ROCKVILLE, MARYLAND
RECOMMENDED FOR APPROVAL
CHIEF, TRANSPORTATION PLANNING AND DESIGN SECTION APPROVED
8/15/2025 DATE

DESIGNED BY: JH	DRAWN BY: LY	CHECKED BY: JH
-----------------	--------------	----------------

ZION ROAD BRIDGE REPLACEMENT MONTGOMERY COUNTY BRIDGE NO. M-0121
APPROVAL SHEET
ELECTION DIST. 101-01 TAX MAP: HV32
WSSC GRID NO.: 230NW04

PROJECT NO. : M0187ZM1	SHEET 2 OF 4	DATE: 08/14/2025
------------------------	--------------	------------------

DEVELOPER'S CERTIFICATE

The Undersigned agrees to execute all the features of the Approved Final Forest Conservation Plan No. F20240870 including, financial bonding, forest planting, maintenance, and all other applicable agreements.

Developer's Name: Montgomery County DOT
Printed Company Name

Contact Person or Owner: Joseph Moges
Printed Name

Address: 100 EDISON PARK DRIVE

Phone and Email: 227-251-1268 joseph.moges@montgomerycountymd.gov

Signature: Joseph Moges

CERTIFICATION OF QUALIFIED PROFESSIONAL

THE UNDERSIGNED CERTIFY THAT THE PLAN SHOWN HEREON HAS BEEN PREPARED IN ACCORDANCE WITH MARYLAND STATE, INCORPORATED AND MONTGOMERY COUNTY FOREST CONSERVATION LAWS.

08/14/2025
DATE

Joanna Hiebler
JOANNA HIEBLER
MDNR /COMAR 08.19.06.01
QUALIFIED PROFESSIONAL

FCP # F20240870

Attachment B: Preliminary/Final Forest Conservation Plan

SOIL SUMMARY- ENTIRE MAP AREA							
Map Unit Symbol	Map Unit Name	K Factor	Hydric Status	Hydrologic Soil Group	Drainage Class	Highly Erodible	Prime Agriculture
53A	CODORUS SILT LOAM, 0 TO 3 PERCENT SLOPES, OCCASIONALLY FLOODED	0.32	NO	C	MODERATELY WELL DRAINED	YES	NO

FCP NOTES:

1. APPLICANT: MONTGOMERY COUNTY DEPARTMENT OF TRANSPORTATION (MCDOT), 100 EDISON PARK DRIVE, GAITHERSBURG, MD 20878.
2. PROJECT LOD - 1.9 ACRES.
3. TOPOGRAPHIC INFORMATION WAS GENERATED BY A FIELD RUN SURVEY BY AECOM IN OCTOBER 2020 AND SUPPLEMENTED WITH MONTGOMERY COUNTY GIS.
4. FOREST STAND DELINEATION WAS CONDUCTED BY AECOM - JOANNA HIEBLER, QUALIFIED PROFESSIONAL, JUNE 11, 2024. NRI/FSD 420242780 APPROVED 7/25/2024. TREE SURVEY UPDATED JULY 31, 2025.
5. A DIAMETER TAPE WAS USED TO MEASURE THE DIAMETER AT BREAST HEIGHT (DBH) OF INDIVIDUAL TREES.
6. WETLANDS AND STREAMS WERE DELINEATED BY AECOM OCTOBER 17, 2020, AND REVIEWED/REVISED BY JOANNA HIEBLER, JUNE 11, 2024.
7. THE PROJECT SITE IS WITHIN THE UPPER PATUXENT RIVER BASIN AND HAWLINGS RIVER SUBBASIN.
8. HAWLINGS RIVER WATER USE DESIGNATION IS IV/IV-P.
9. THE PROJECT SITE IS LOCATED WITHIN THE RACHEL CARSON CONSERVATION PARK.
10. THIS SITE IS NOT WITHIN IN A SPECIAL PROTECTION AREA (SPA).
11. THE SITE IS LOCATED WITHIN THE PATUXENT RIVER WATERSHED PRIMARY MANAGEMENT AREA (PMA).
12. THE ENTIRE SITE IS LOCATED WITHIN THE 100-YR FLOODPLAIN PER A FLOODPLAIN STUDY CONDUCTED BY M-NCPPC. (1967) AND BY GREENHORNE & O' MARA INC., (1986). THE 100-YR FLOODPLAIN EXTENDS OFF THE SHEET.
13. THE ENTIRE TRACT AREA (LOD) IS LOCATED WITHIN THE EXPANDED 125' STREAM BUFFER.
14. THE SOIL CLASSIFICATION FOR THE ENTIRE SITE IS 53A - CODORUS SILT LOAM.
15. ACCORDING TO THE MARYLAND DEPARTMENT OF NATURAL RESOURCES (MD-DNR) WILDLIFE AND HERITAGE SERVICE AND MD-DNR ENVIRONMENTAL REVIEW PROGRAM THERE ARE TWO SENSITIVE AQUATIC SPECIES (SHIELD DARTER AND YELLOW LANCE) THAT HAVE BEEN DOCUMENTED IN THE VICINITY OF THE PROJECT SITE.
16. ACCORDING TO THE U.S. FISH AND WILDLIFE SERVICE THERE ARE 4 THREATENED, ENDANGERED OR CANDIDATE SPECIES (NORTHERN LONG-EARED BAT, TRICOLORED BAT, MONARCH BUTTERFLY AND YELLOW LANCE) THAT HAVE BEEN DOCUMENTED IN THE VICINITY OF THE PROJECT SITE.
17. THE PROJECT SITE DOES NOT CONTAIN ANY HISTORICAL OR CULTURAL RESOURCES OF SIGNIFICANCE.
18. THERE ARE SLOPES 25% AND GREATER WITHIN THE PROJECT SITE.
19. THERE ARE HIGHLY ERODIBLE SOILS WITHIN THE PROJECT SITE.
20. THERE ARE SIGNIFICANT / SPECIMEN TREES LOCATED WITHIN AND ADJACENT TO THE PROJECT SITE.
21. THIS SITE DOES NOT CONTAIN ANY NATIONAL, STATE OR COUNTY CHAMPIONS TREES OR TREES THAT ARE AT LEAST 75 PERCENT OF THE CURRENT STATE CHAMPION.
22. SITE ZONING IS AR - AGRICULTURAL RURAL.
23. THE SOURCE OF THE PROPERTY LINES IS FROM MONTGOMERY COUNTY GIS.
24. ZION ROAD IS CLASSIFIED AS A RUSTIC ROAD BY M-NCPPC.
25. SIGNIFICANT TREES AND SPECIMEN TREES ARE IDENTIFIED IN THE TREE INVENTORY BELOW. 53 TREES IDENTIFIED AS 6"-23" DBH WITHIN THE LOD WILL BE REMOVED. THESE CONSIST OF BLACK WALNUT, BOXELDER, TULIP POPLAR, WHITE OAK, PIN OAK, AMERICAN SYCAMORE, RED MAPLE, BLACK CHERRY, AND RIVER BIRCH.
26. STOCKPILES SHALL BE PLACED WITHIN EXISTING CLOSED ROADWAY PAVEMENT AREA. NO STOCKPILES WILL NOT BE PLACED WITHIN STREAM BUFFER, FLOODPLAIN OR PARKLAND.
27. ONE 35" DBH TULIP POPLAR SPECIMEN TREE TO BE REMOVED WILL BE REPLACED WITH THREE 3" DBH TREES AS NOTED ON PLAN.

FOREST IMPACT SUMMARY	
MOCO	9,807 SF/0.23 AC
MNCPPC	8,260 SF/0.19 AC
TOTAL	18,067 SF/0.42 AC

RESOURCE DATA TABLE		
TYPE	QUANTITY	UNIT
TRACT AREA (AREA OF LOD)	1.9	AC
FOREST	1.1	AC
WETLANDS	0.003	AC
FOREST IN WETLANDS	0.003	AC
FLOODPLAINS	1.9	AC
FOREST IN FLOODPLAINS	1.1	AC
STREAM BUFFERS	1.9	AC
FOREST IN STREAM BUFFERS	1.1	AC
STREAM LENGTH	672	FT
AVERAGE STREAM WIDTH	30	FT

Significant Tree Inventory				
Trees $\geq 24\text{-}29\text{'}$ DBH				
Tree ID	Scientific Name	Common Name	DBH	Condition
ST-25	<i>Quercus alba</i>	White oak	28	Good
ST-34	<i>Acer rubrum</i>	Red maple	25	Good
ST-35	<i>Liriodendron tulipifera</i>	Tulip poplar	24	Good
ST-56	<i>Liriodendron tulipifera</i>	Tulip poplar	24	Good
ST-67	<i>Juglans nigra</i>	Black walnut	26	Good
ST-98	<i>Acer rubrum</i>	Red maple	27	Good
ST-100	<i>Platanus occidentalis</i>	American sycamore	27	Good
ST-117	<i>Platanus occidentalis</i>	American sycamore	24	Good
ST-118	<i>Platanus occidentalis</i>	American sycamore	27	Good

Specimen Tree Inventory				
Trees ≥ 30" DBH				
Tree ID	Scientific Name	Common Name	DBH	Condition
SP-3	<i>Liriodendron tulipifera</i>	Tulip poplar	40	Good
SP-4	<i>Liriodendron tulipifera</i>	Tulip poplar	40	Fair/Good
SP-11	<i>Liriodendron tulipifera</i>	Tulip poplar	52	Poor
SP-16	<i>Liriodendron tulipifera</i>	Tulip poplar	40	Good
SP-33	<i>Quercus alba</i>	White oak	44	Good
SP-37	<i>Quercus alba</i>	White oak	34	Good
SP-38	<i>Liriodendron tulipifera</i>	Tulip poplar	34	Good
SP-55	<i>Acer rubrum</i>	Red maple	33	Good
SP-104	<i>Liriodendron tulipifera</i>	Tulip poplar	32	Good
SP-149	<i>Liriodendron tulipifera</i>	Tulip poplar	35	Good

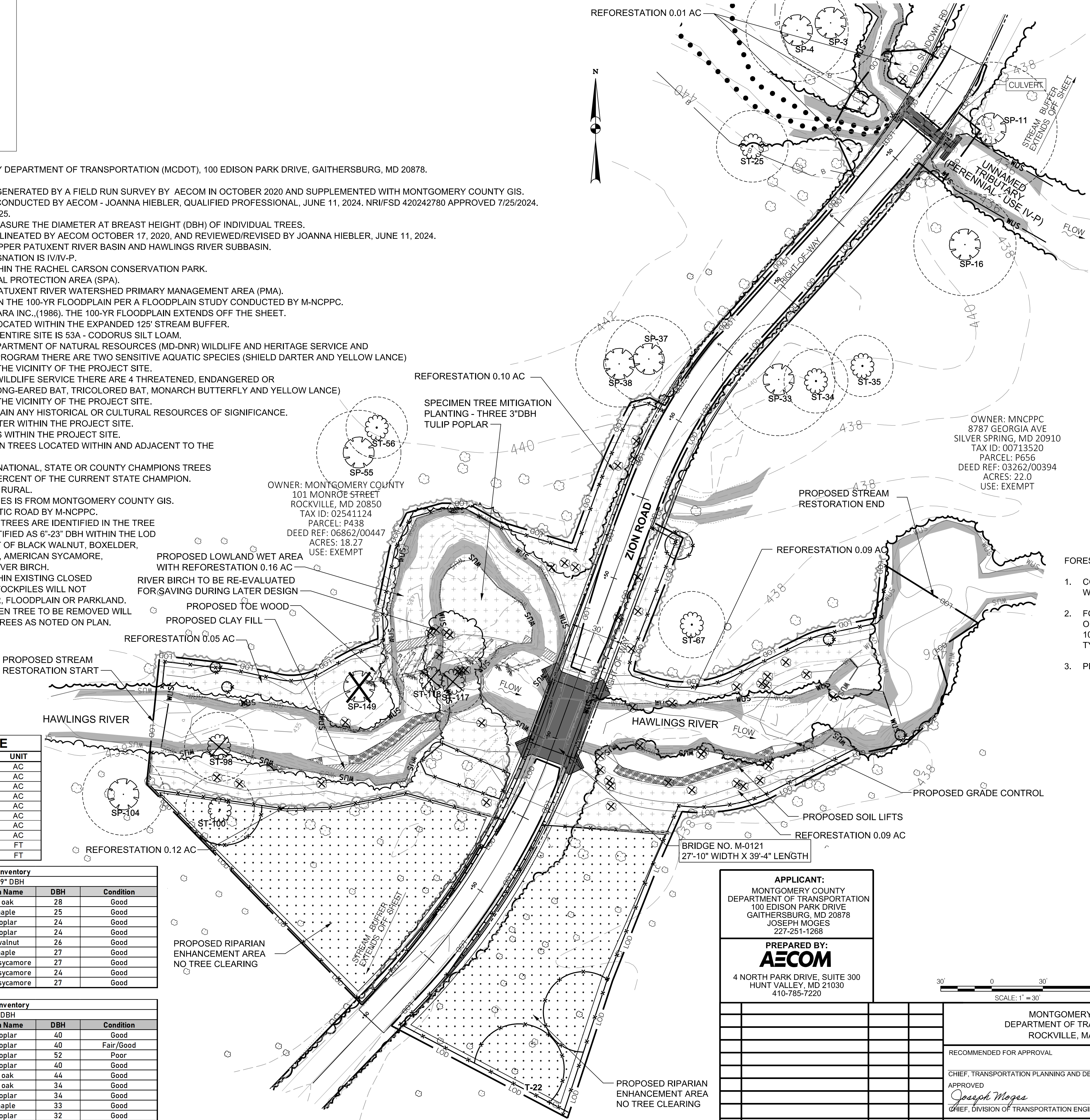

- FOREST PROTECTION NOTES:**
1. CONTRACTOR SHALL USE LOW PRESSURE EQUIPMENT OR HAND GRADING WHEN GRADING WITHIN CRITICAL ROOT ZONES OF TREES THAT ARE NOT MARKED AS REMOVAL.
 2. FOREST RETENTION SIGNAGE SHALL BE STAKED ALONG THE TREE PROTECTION FENCE OR SILT FENCE ALONG PORTIONS OF THE LOD. SIGNS SHALL BE SPACED APPROXIMATELY 100 FEET APART WHERE POSSIBLE, WITH A MAXIMUM OF 150 FEET APART. SEE SHEET 04 FOR TYPICAL SIGNAGE DETAIL.
 3. PERFORM TREE ROOT PRUNING AT LOD ADJACENT TO EXISTING FOREST TO REMAIN.

<u>DEVELOPER'S CERTIFICATE</u>	
The Undersigned agrees to execute all the features of the Approved Final Forest Conservation Plan No. <u>F20240870</u> including, financial bonding, forest planting, maintenance, and all other applicable agreements.	
Developer's Name:	<u>Montgomery County DOT</u> <small>Printed Company Name</small>
Contact Person or Owner:	<u>Joseph Moges</u> <small>Printed Name</small>
Address:	<u>100 EDISON PARK DRIVE</u>
Phone and Email:	<u>227-251-1268 joseph.moges@montgomerycountymd.gov</u>
Signature:	<u>Joseph Moges</u>

CERTIFICATION OF QUALIFIED PROFESSIONAL
I HEREBY CERTIFY THAT THE PLAN SHOWN HEREON HAS BEEN PREPARED IN ACCORDANCE
WITH MARYLAND STATE, MNCPP&C AND MONTGOMERY COUNTY FOREST CONSERVATION LAWS.

08/14/2025
DATE

JOANNA HIEBLER
MDNR / COMAR 08.19.06.01
QUALIFIED PROFESSIONAL

FCP # F20240870

APPLICANT:
MONTGOMERY COUNTY
DEPARTMENT OF TRANSPORTATION
100 EDISON PARK DRIVE
GAITHERSBURG, MD 20878
JOSEPH MOGES
227-251-1268

PREPARED BY:
AECOM
4 NORTH PARK DRIVE, SUITE 300
HUNT VALLEY, MD 21030
410-785-7220

[illegible]

<p align="center">MONTGOMERY COUNTY DEPARTMENT OF TRANSPORTATION ROCKVILLE, MARYLAND</p>	
<p>RECOMMENDED FOR APPROVAL</p>	
<p>CHIEF, TRANSPORTATION PLANNING AND DESIGN SECTION</p>	<p>DATE</p>
<p>APPROVED</p> <p><i>Joseph Moges</i></p>	<p>8/15/2025</p>
<p>CHIEF, DIVISION OF TRANSPORTATION ENGINEERING</p>	<p>DATE</p>
<p>DESIGNED BY: <u>JH</u></p>	<p>DRAWN BY: <u>LY</u></p>
<p>CHECKED BY: <u>JH</u></p>	

ZION ROAD BRIDGE REPLACEMENT
MONTGOMERY COUNTY BRIDGE NO. M-0121

FOREST CONSERVATION PLAN

FCP

ELECTION DIST. 101-01
TAX MAP: HV32

WSSC GRID NO.: 230NW04

PROJECT NO.: MO187ZM1 SHEET 3 OF 4 DATE: 08/14/2025

Attachment B: Preliminary/Final Forest Conservation Plan

Sequence of Events for Properties Required to Comply With Forest Conservation Plans, Exemptions from Submitting Forest Conservation Plans, and Tree Save Plans

The property owner is responsible for ensuring all tree protection measures are performed in accordance with the approved final forest conservation plan or tree save plan, and as modified in the field by a Planning Department Forest Conservation Inspector. The measures must meet or exceed the most recent standards published by the American National Standards Institute (ANSI A300).

Pre-Construction

- 1. An on-site pre-construction meeting is required after the limits of disturbance have been staked and flagged and before any land disturbance.
- 2. The property owner must arrange for the meeting and following people should must participate at the pre-construction meeting: the property owner or their representative, construction superintendent, International Society of Arboriculture (ISA) certified arborist/Maryland Licensed Tree Expert (representing owner) that will implement the tree protection measures, The Planning Department Forest Conservation Inspector, and Montgomery County Department of Permitting Services (DPS) Sediment Control Inspector. The purpose of this meeting is verify the limits of disturbance and discuss specific tree protection and tree care measures shown on the approved plan. No land disturbance shall begin before tree protection and stress-reduction measures have been implemented and approved by the Planning Department's Forest Conservation Inspector.
 - a. Typical tree protection devices include:
 - i. Chain link fence (four feet high)
 - ii. Super silt fence with wire strung between the support poles (minimum 4 feet high) with high visibility flagging.
 - iii. 14 gauge, 2 inch x 4 inch welded wire fencing supported by steel T-bar posts (minimum 4 feet high) with high visibility flagging.
 - b. Typical stress reduction measures may include, but are not limited to:
 - i. Root pruning with a root cutter or vibratory plow designed for that purpose. Trenchers are not allowed, unless approved by the Forest Conservation Inspector
 - ii. Crown Reduction or pruning
 - iii. Watering
 - iv. Fertilizing
 - v. Vertical mulching
 - vi. Root aeration systemsMeasures not specified on the Forest Conservation Plan may be required as determined by the Forest Conservation Inspector in coordination with the property owner's arborist.
- 3. A Maryland Licensed Tree expert must perform, or directly supervise, the implementation of all stress reduction measures. Documentation of the process (including photographs) may be required by the Forest Conservation Inspector, and will be determined at the pre-construction meeting.
- 4. Temporary tree protection devices must be installed per the approved Forest Conservation Plan, Exemption Plan, or Tree Save Plan and prior to any land disturbance. The Forest Conservation Inspector, in coordination with the DPS Sediment Control Inspector, may make field adjustments to increase the survivability of trees and forest shown as saved on the approved plan.
- 5. Tree protection fencing must be installed and maintained by the property owner for the duration of construction project and must not be altered without prior approval from the Forest Conservation Inspector. All construction activity within protected tree and forest areas is prohibited. This includes the following activities:
 - a. Parking or driving of equipment, machinery or vehicles of any type.
 - b. Storage of any construction materials, equipment, stockpiling, fill, debris, etc.
 - c. Dumping of any chemicals (i.e., paint thinner), mortar or concrete remainder, trash, garbage, or debris of any kind.
 - d. Felling of trees into a protected area.
 - e. Trenching or grading for utilities, irrigation, drainage, etc.
- 6. Forest and tree protection signs must be installed as required by the Forest Conservation Inspector. The signs must be waterproof and wording provided in both English and Spanish.

During Construction

- 7. Periodic inspections will be made by the Forest Conservation Inspector. Corrections and repairs to tree protection devices must be completed within the timeframe given by the Inspector.
- 8. The property owner must immediately notify the Forest Conservation Inspector of any damage to trees, forests, understory, ground cover, and any other undisturbed areas shown on the approved plan. Remedial actions, and the relative timeframes to restore these areas, will be determined by the Forest Conservation Inspector.

Post-Construction

- 9. After construction is completed, but before tree protection devices have been removed, the property owner must request a final inspection with the Forest Conservation Inspector. At the final inspection, the Forest Conservation Inspector may require additional corrective measures, which may include:
 - a. Removal, and possible replacement, of dead, dying, or hazardous trees
 - b. Pruning of dead or declining limbs
 - c. Soil aeration
 - d. Fertilization
 - e. Watering
 - f. Wound repair
 - g. Clean up of retention areas, including trash removal
- 10. After the final inspection and completion of all corrective measures the Forest Conservation Inspector will request all temporary tree and forest protection devices be removed from the site. Removal of tree protection devices that also operate for erosion and sediment control must be coordinated with both DPS and the Forest Conservation Inspector and cannot be removed without permission of the Forest Conservation Inspector. No additional grading, sodding, or burial may take place after the tree protection fencing is removed.
- 11. Long-term protection measures, including permanent signage, must be installed per the approved plan. Installation will occur at the appropriate time during the construction project. Reference to the approved plan drawing for the long-term protection measures to be installed.

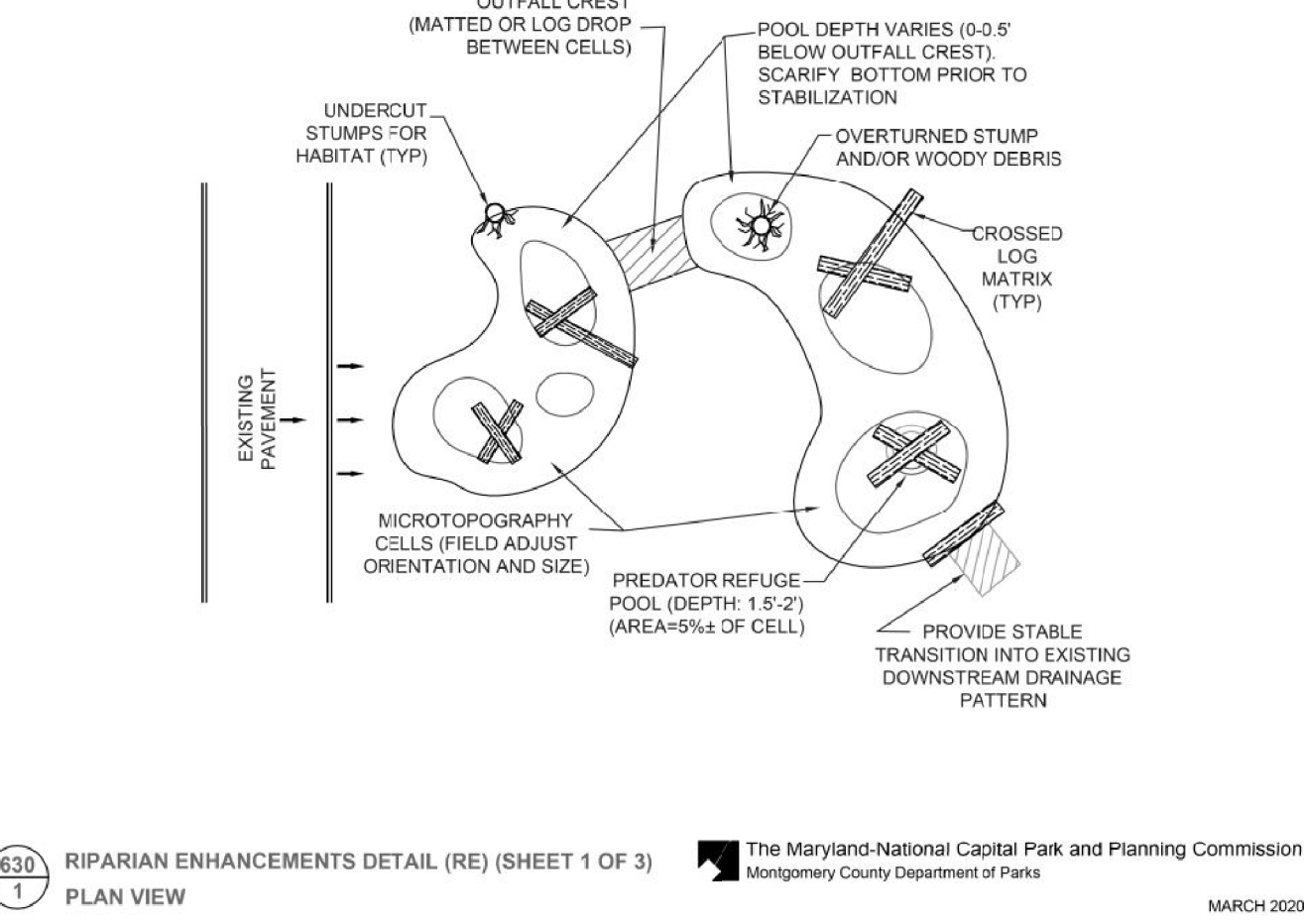

RE NOTES:

- 1. CONTRACTOR SHALL LAY OUT CRITICAL POINTS OF STRUCTURE TO REVIEW WITH CONSTRUCTION MANAGER PRIOR TO CONSTRUCTION. ALL DIMENSIONS AND ELEVATIONS SHALL BE FIELD ADJUSTED IN COORDINATION WITH THE CONSTRUCTION MANAGER TO ENSURE PROPER DIMENSIONS, STABLE INSTALLATION, MINIMIZATION OF NATURAL RESOURCE IMPACTS, AND SMOOTH TIE-IN TO ADJACENT FEATURES.
- 2. INSTALL TOPSOIL AND NATIVE RIPARIAN SEED MIX (WITH ANNUAL RYE) WITH WHEED-FREE STRAW MULCH. IF SEED MIX IS UNSUCCESSFUL IN TAKING FROM INITIAL APPLICATION, SEED MIX TO BE REAPPLIED UNTIL SUCCESSFUL (GERMINATION) TAKES PLACE.
- 3. COORDINATE PLANTINGS WITH CONSTRUCTION MANAGER AND GRADE PLANTING AREAS TO VARYING DEPTHS.
- 4. FIELD ADJUST CELL GRADING AND WOODY MATERIAL PLACEMENT TO ENHANCE HABITAT VALUE AS DIRECTED BY THE CONSTRUCTION MANAGER.
- 5. UTILIZE ON-SITE WOODY MATERIAL TO CREATE LOG MATRIX.
- 6. LOCATE PREDATOR REFUGE POOL AS FAR FROM ACTIVE USE AREAS AS FEASIBLE.
- 7. WHEN ROCKS (LARGER THAN 6" ACROSS) ARE AVAILABLE ONSITE, INCORPORATE INTO SURFACE AND IN SMALL PILES.

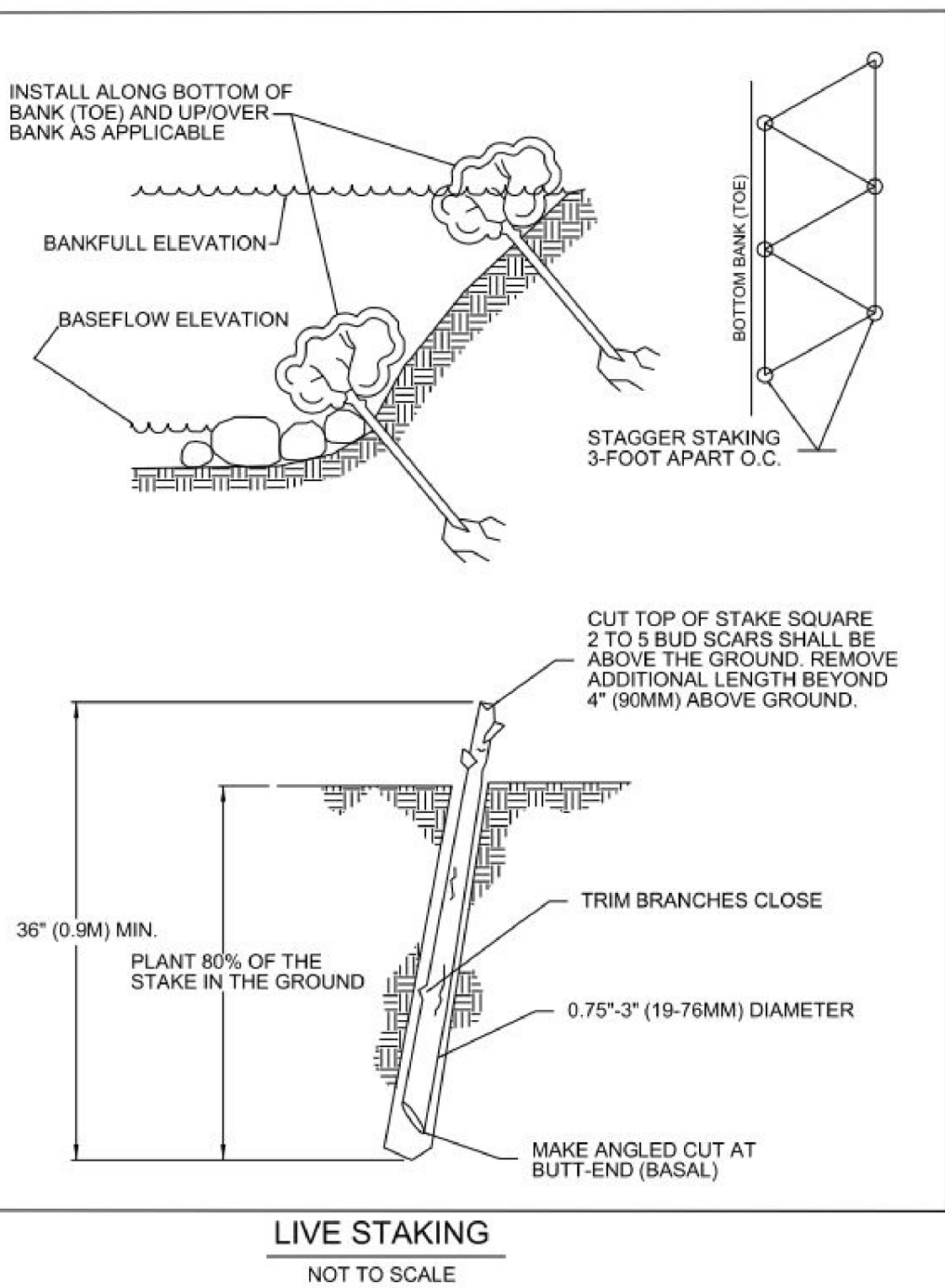
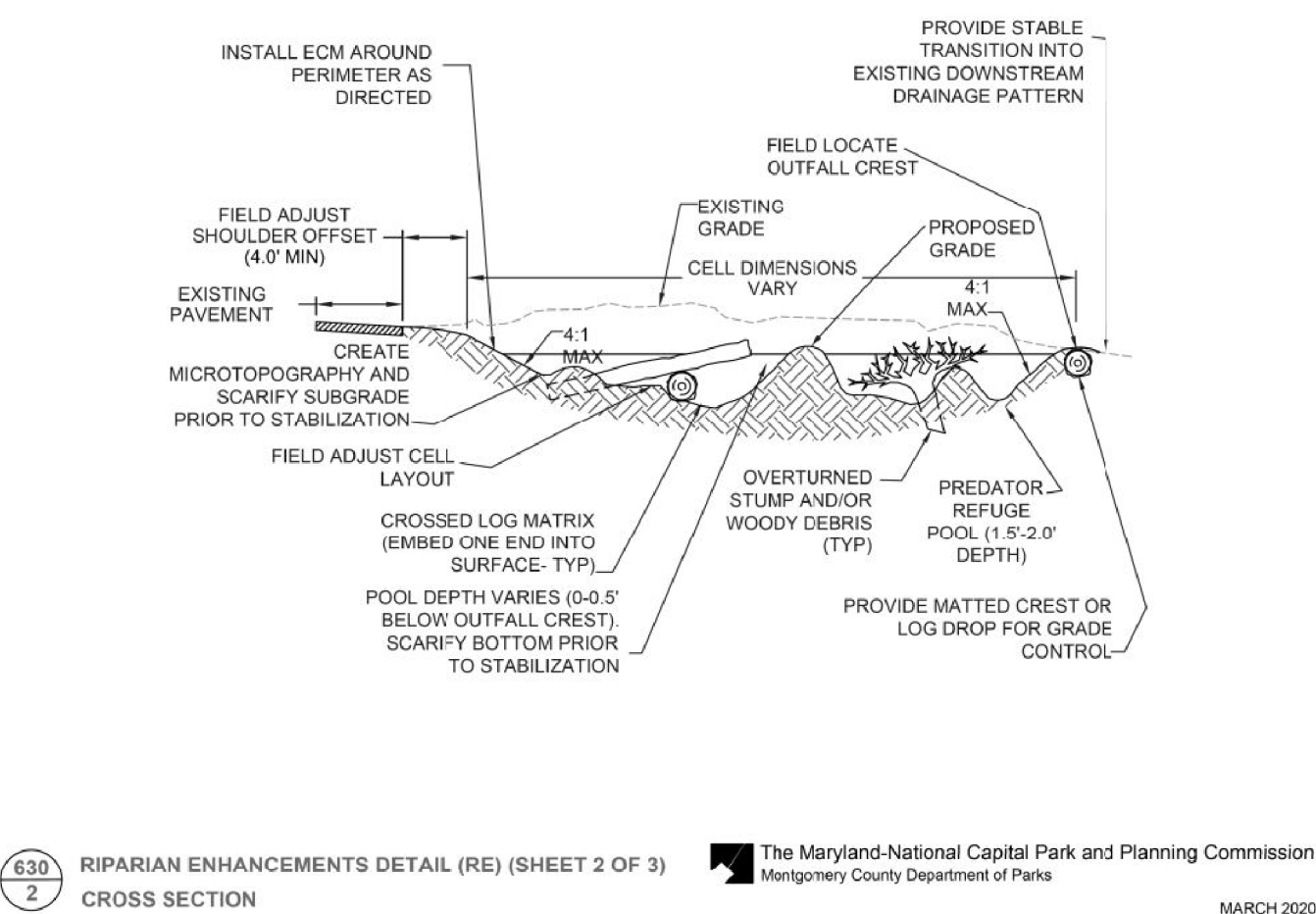

REFORESTATION SUMMARY			
REFORESTATION PROVIDED	0.62 AC	0.62 AC X 100 STEMS / ACRE = 62 TREES	TREES PROVIDED: 62 NATIVE CANOPY TREES

NOTE: AN ADDITIONAL 66 NATIVE UNDERSTORY TREES PROVIDED

PLANT SCHEDULE						
TOTAL QUANTITY	BOTANICAL NAME	COMMON NAME	SIZE	CONDITION	SPACING	REMARKS
REFORESTATION CANOPY TREES						
12	ACER RUBRUM	RED MAPLE	1.5" CAL.	B&B OR 15 GAL. CONT.	20' O.C.	
18	PLATANUS OCCIDENTALIS	AMERICAN SYCAMORE	1.5" CAL.	B&B OR 15 GAL. CONT.	20' O.C.	
8	QUERCUS PALUSTRIS	PIN OAK	1.5" CAL.	B&B OR 15 GAL. CONT.	20' O.C.	
12	ACER NEGUNDO	BOX ELDER	1.5" CAL.	B&B OR 15 GAL. CONT.	20' O.C.	
12	BETULA NIGRA	RIVER BIRCH	8' HT.	B&B OR 15 GAL. CONT.	20' O.C.	MULTI-STEM, 3 STEMS MIN.
REFORESTATION UNDERSTORY TREES						
25	AMELANCHIER 'AUTUMN BRILLIANCE'	AUTUMN BRILLIANCE SERVICEBERRY	6' HT.	B&B OR 7 GAL. CONT.	15' O.C.	MULTI-STEM, 3 STEMS MIN.
41	MAGNOLIA VIRGINIANA	SWEETBAY MAGNOLIA	6' HT.	B&B OR 7 GAL. CONT.	15' O.C.	
WETLAND HERBACEOUS PERENNIAL PLUGS						
250	POLYSTICHUM ACROSTICHOIDES	CHRISTMAS FERN	2 IN. DIAM. 5 IN. DEPTH	CELLS	24" O.C.	
540	ONOCLEA SENSIBILIS	SENSITIVE FERN	2 IN. DIAM. 5 IN. DEPTH	CELLS	24" O.C.	
540	CAREX STRICTA	TUSsock SEDGE	2 IN. DIAM. 5 IN. DEPTH	CELLS	24" O.C.	
540	EUPATORIUM PURPUREUM	JOE-PYE WEED	2 IN. DIAM. 5 IN. DEPTH	CELLS	24" O.C.	
540	JUNCUS EFFUSUS	SOFT RUSH	2 IN. DIAM. 5 IN. DEPTH	CELLS	24" O.C.	
STREAM BANK LIVE STAKES						
225	CORNUS AMOMUM	SILKY DOGWOOD	0.75" TO 3.0" X 36"	LS	3' O.C.	
225	CORNUS SERICEA	RED OSIER DOGWOOD	0.75" TO 3.0" X 36"	LS	3' O.C.	
225	SALIX SERICEA	SILKY WILLOW	0.75" TO 3.0" X 36"	LS	3' O.C.	
SEEDING						
917 SY	WET MEADOW ESTABLISHMENT					
2279 SY	LOWLAND MEADOW ESTABLISHMENT					
533 SY	TURFGRASS ESTABLISHMENT					
533 SY	TYPE D SOIL STABILIZATION MATTING					

DEVELOPER'S CERTIFICATE

The Undersigned agrees to execute all the features of the Approved Final Forest Conservation Plan No. **F20240870** including, financial bonding, forest planting, maintenance, and all other applicable agreements.

Developer's Name: **Montgomery County DOT**
Printed Company Name
Contact Person or Owner: **Joseph Moges**
Printed Name
Address: **100 EDISON PARK DRIVE**
Phone and Email: **227-251-1268 joseph.moges@montgomerycountymd.gov**
Signature: *Joseph Moges*

CERTIFICATION OF QUALIFIED PROFESSIONAL

I HEREBY CERTIFY THAT THE PLAN SHOWN HEREON HAS BEEN PREPARED IN ACCORDANCE WITH MARYLAND STATE, MNCPP&C AND MONTGOMERY COUNTY FOREST CONSERVATION LAWS.

08/14/2025
DATE
JOANNA HIEBLER
MD014 (COMAR 08.18.06.01)
QUALIFIED PROFESSIONAL

FCP # F20240870

APPLICANT: MONTGOMERY COUNTY DEPARTMENT OF TRANSPORTATION 100 EDISON PARK DRIVE GAITHERSBURG, MD 20878 JOSEPH MOGES 227-251-1268							MONTGOMERY COUNTY DEPARTMENT OF TRANSPORTATION ROCKVILLE, MARYLAND			ZION ROAD BRIDGE REPLACEMENT MONTGOMERY COUNTY BRIDGE NO. M-0121					
PREPARED BY: AECOM 4 NORTH PARK DRIVE, SUITE 300 HUNT VALLEY, MD 21030 410-785-7220							RECOMMENDED FOR APPROVAL			NOTES AND DETAILS SHEET FCP ELECTION DIST. 101-01 TAX MAP: H/32 WSSC GRID NO.: 230NW04					
							CHIEF, TRANSPORTATION PLANNING AND DESIGN SECTION						DATE		
							APPROVED								
							<i>Joseph Moges</i>								
							CHIEF, DIVISION OF TRANSPORTATION ENGINEERING						DATE		
NO.	REVISION	DATE	BY	DESIGNED BY: <u>JH</u>	DRAWN BY: <u>LY</u>	CHECKED BY: <u>JH</u>	PROJECT NO.: <u>MO187ZM1</u>			SHEET <u>4</u> OF <u>4</u>	DATE: <u>08/14/2025</u>				

ZION ROAD BRIDGE REPLACEMENT
MONTGOMERY COUNTY BRIDGE NO. M-0121

NOTES AND DETAILS SHEET

FCP

ELECTION DIST. 101-01
TAX MAP: HV32
PROJECT NO.: **M0187ZM1** SHEET **4** OF **4** DATE: **08/14/2025**
WSSC GRID NO.: 230NW04